

FILE PATH: P:\2013\147\Hyatt Place\REV 3\CAD\FA-112.dwg

LAST PRINTED: 2/10/2014 8:55:07 AM LAST SAVED BY: GLORION

24" x 36"

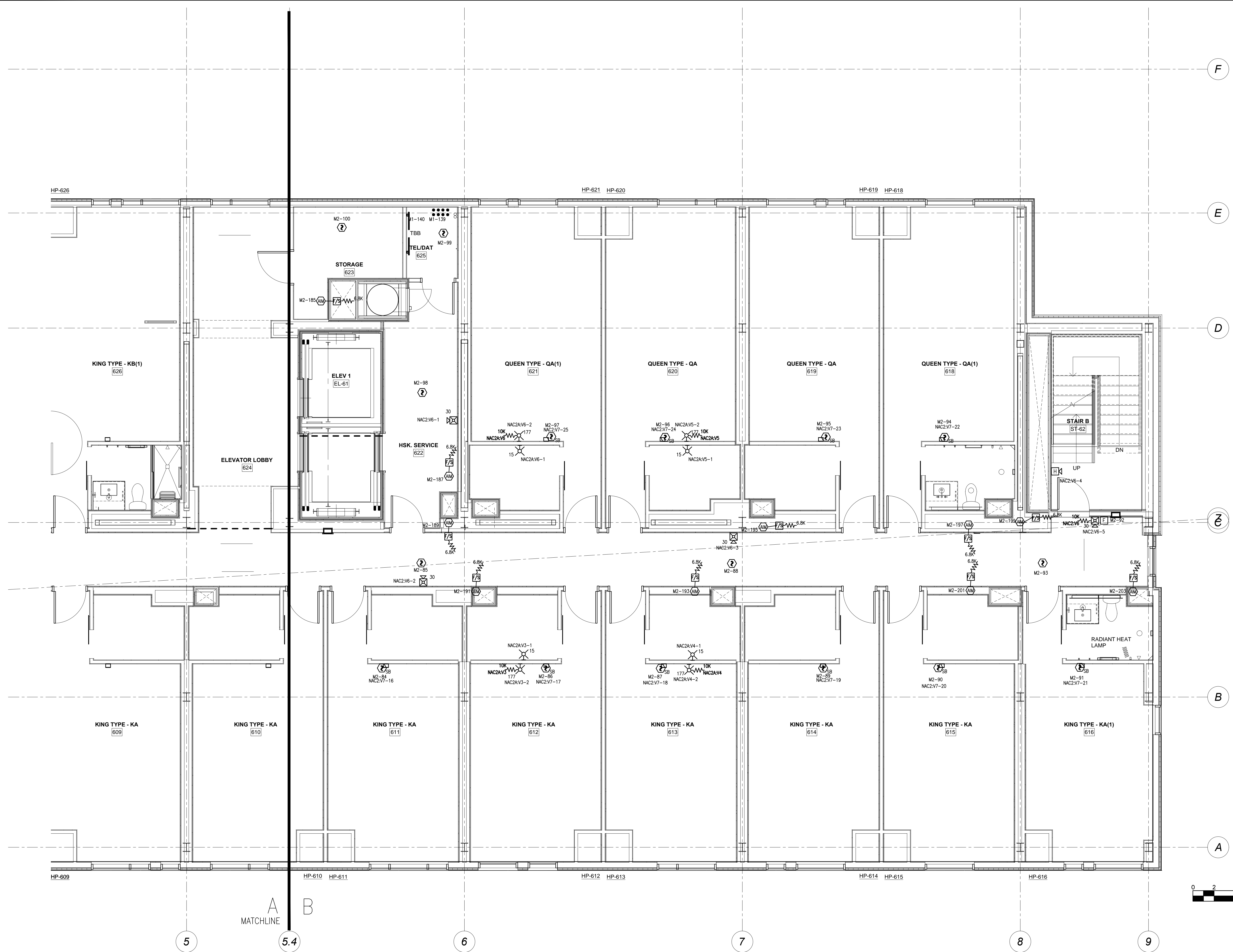

tyco
SimplexGrinnell

20 THOMAS DRIVE
WESTBROOK, ME 04092
SALES: 207-842-6440
SERVICE: 207-842-6440
FAX: 207-842-6439

CHG BY: JS
DATE: 8/14/13
NO. 1

REVISION DESCRIPTION:
REVISED PER ENGINEERS REVIEW COMMENTS DATED 7/19/13 & 8/5/13

NO. 2
DATE: 9/10/13
REVISOR: JS
DESCRIPTION: REVISED PER SUBMITTAL REVIEW DATED 8/29/13

NO. 3
DATE: 10/07/13
REVISOR: SK
DESCRIPTION: REVISED PER SUBMITTAL REVIEW DATED 10/1/13

FIRE ALARM & AREA OF REFUGE SYSTEMS
SIXTH FLOOR PLAN PART B
HYATT PLACE PORTLAND-OLD PORT
433 FORE STREET
PORTLAND, ME

DRAWN BY: LORION
DATE: 6/14/13

CHECKED BY: KALAFARSKI
DATE: 7/12/13

PROJECT NUMBER:
971237001

SHEET TITLE:
FIRE ALARM SYSTEM
SIXTH FLR PLAN PART B

SHEET NUMBER:
FA-112
FA-112.dwg