

NOTES:
1) EXITS AND BATTERY UNITS ON LIGHTING CIRCUIT

First Floor Foodservice Equipment Plan
SCALE - 1/4" = 1' - 0"

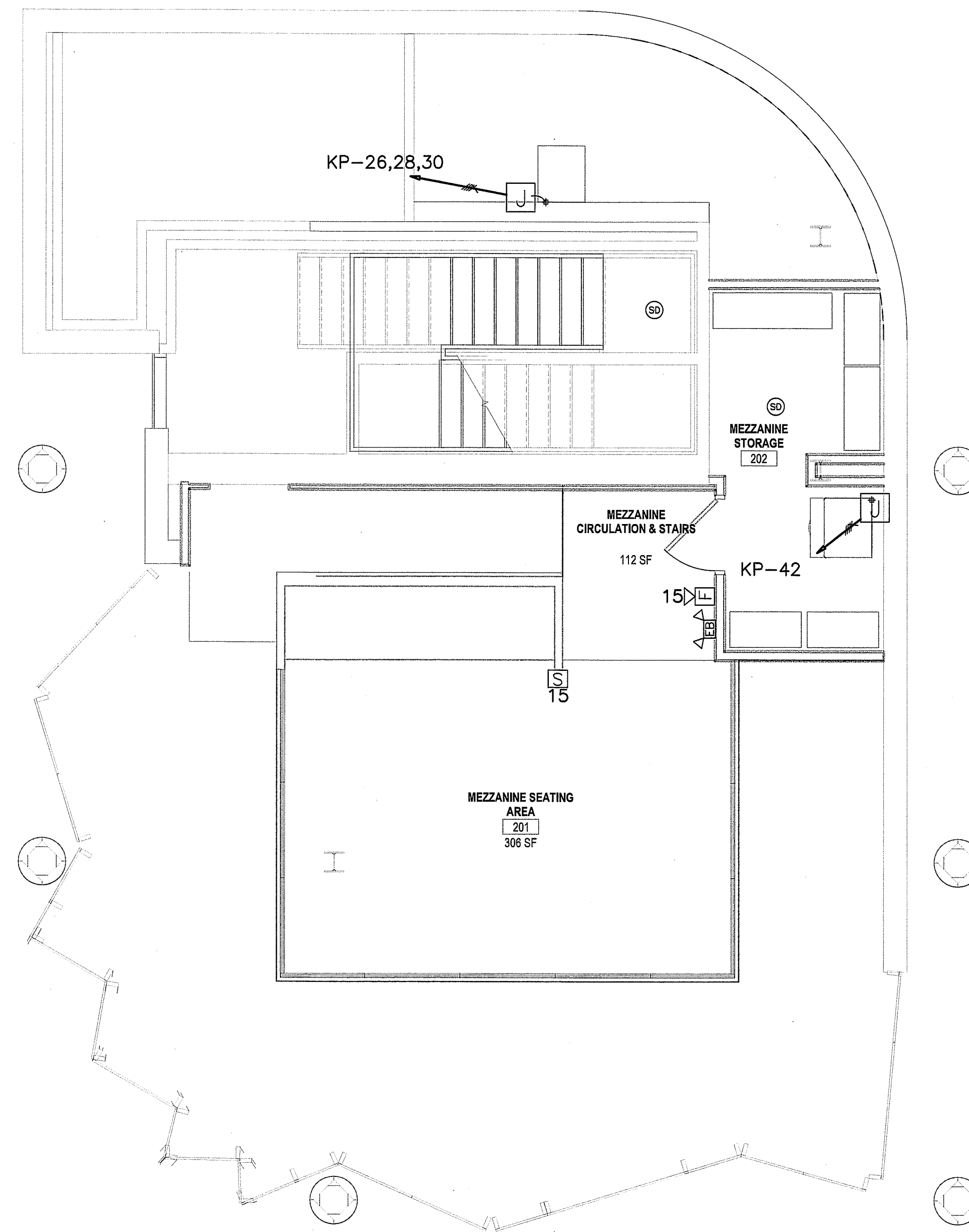

Mezzanine Foodservice Equipment Plan
SCALE - 1/4" = 1' - 0"

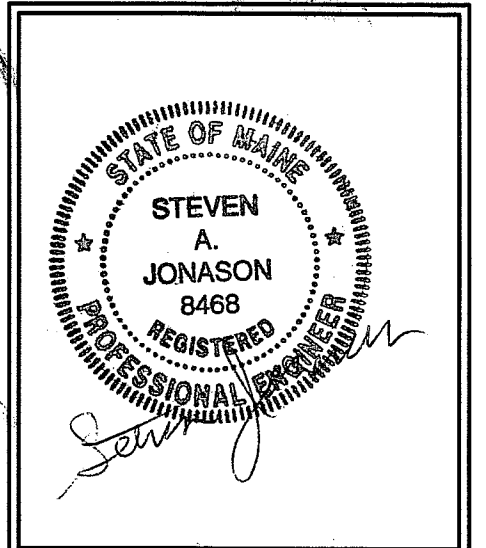

BH Milliken
ELECTRICAL CONTRACTORS
175 ANDERSON STREET
PORTLAND, MAINE 04101
PHONE 879-1877
FAX: 774-1492

443 Fore St,

443 FORE ST.
PORTLAND, ME.

TITLE
POWER
REVISION 1 - 12-3-14
SCALE: 1/8"=1'
DATE: 11-20-14
SHEET
E400