

PROFILE STA. 0+00 TO STA. 1+60
 HORIZONTAL SCALE: 1" = 20'
 VERTICAL SCALE: 1" = 4'

STRUCTURE TABLE				
NAME	DIA.	RIM	INV IN./SIZE/FROM	INV OUT./SIZE/TO
BOX FILTER	6'x4'	30.90*		28.23/4"PVC/CB-6
CB-5	4'	26.60	16.11/8"PVC/	16.01/10"PVC/DMH-6
CB-6**	4'	30.80	27.88/4"PVC/BOX FILTER	26.93/8"PVC/CB-7
CB-7	4'	30.75	26.80/8"PVC/CB-6	26.70/8"PVC/EXIST. PIPE
DMH-4	4'	24.07	15.50/10"PVC/DMH-5 19.62/15"PVC/DMH	15.50/15"PVC/DMH-3
DMH-5	4'	24.99	15.57/10"PVC/DMH-6	15.57/10"PVC/DMH-4
DMH-6	4'	26.97	15.73/10"PVC/CB-5	15.73/10"PVC/DMH-5

*THROAT OPENING OF BOX FILTER
 **DRAINAGE TO ENTER BOX FILTER AND OVERFLOW TO ENTER CATCH BASIN

PIPE TABLE			
PIPE NAME	SIZE	LENGTH	SLOPE
PIPE 1	8" PVC	29'	0.0100
PIPE 2	8" PVC	13'	0.0100
PIPE 3	4" PVC	5'	0.0723

PLAN NOTES

- THE CORE DRILLING REQUIRED IN DMH SHALL BE COMPLETED AND APPROVED UNDER THE DIRECTION OF JOHN EMERSON OF THE SEWER OPERATIONS DEPARTMENT, CELL 318-0239.
- CONTRACTOR SHALL COORDINATE LOCATION OF EXISTING DMH-1 WITH THE CITY PRIOR TO RESETTING FRAME AND COVER.
- FIELD VERIFY LOCATIONS OF EXISTING UTILITIES IN FORE AND UNION STREET PRIOR TO ORDERING DRAINAGE STRUCTURES. COORDINATE FINAL CONNECTION CONFIGURATION WITH CITY OF PORTLAND.
- FOR SPOT GRADES SHOWN ON PLAN "BC" EQUALS BOTTOM OF CURB AND "TC" EQUALS TOP OF CURB.

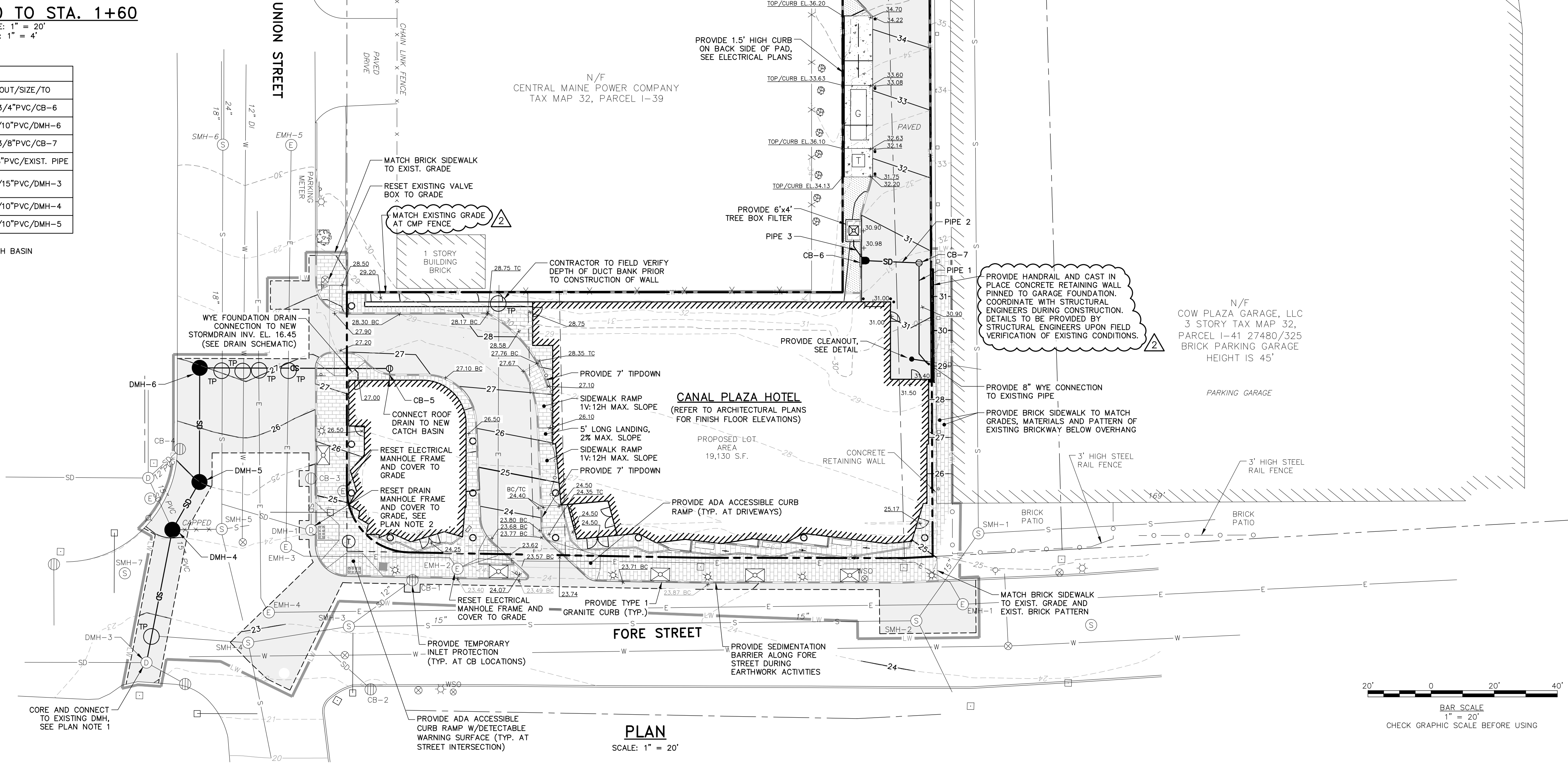

PLAN
 SCALE: 1" = 20'

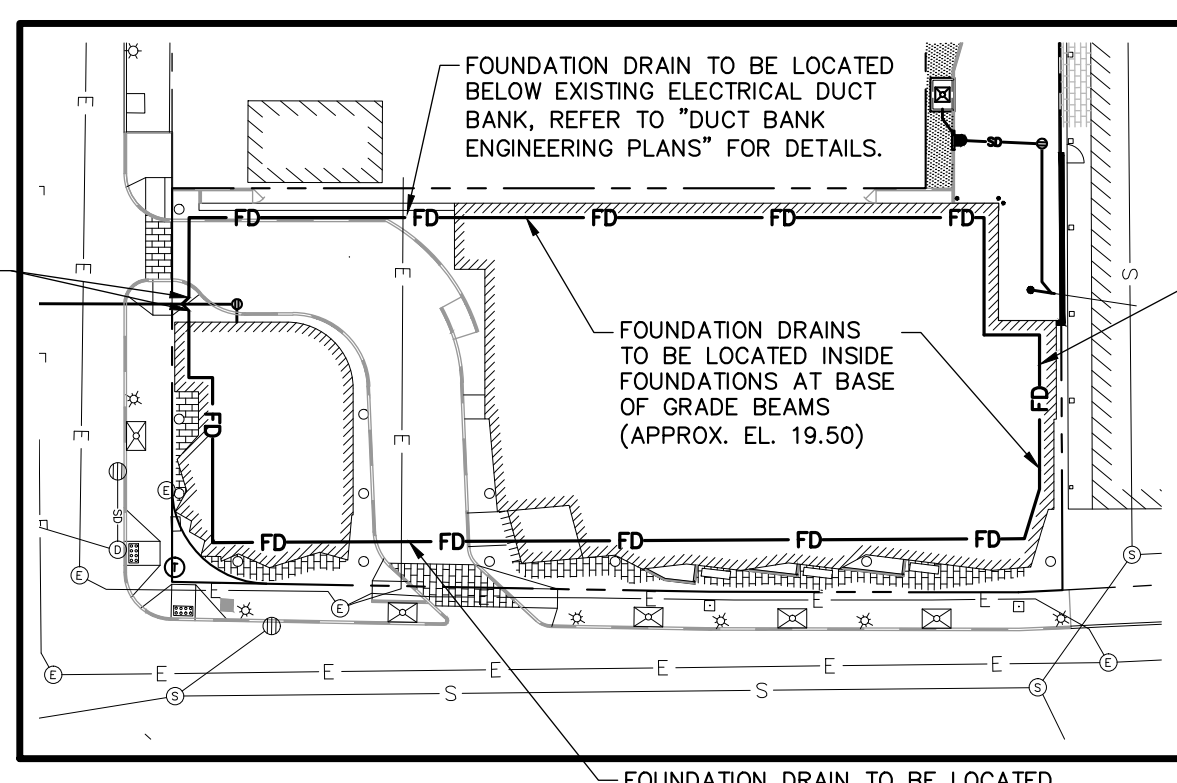

PROPOSED FOUNDATION DRAIN SCHEMATIC

CONTRACTOR TO FIELD VERIFY LEDGE ELEVATIONS IN BACK ALLEY FOUNDATION DRAIN TO BE LOCATED ON TOP OF LEDGE AND SLOPED AS REQUIRED TO MEET EL. 19.50

41 Hutchins Drive
 Portland, Maine 04102
 800.426.4262 | www.woodardcurran.com

WOODARD CURRAN

COMMITMENT & INTEGRITY DRIVE RESULTS

REPRODUCTION OF THIS DRAWING FOR ANY PURPOSES WITHOUT WRITTEN PERMISSION IS PROHIBITED.

STATE OF MAINE
 PROFESSIONAL ENGINEER
 DENISE COLESON
 No. 11279

01/25/2013

REV	DESCRIPTION	DATE
3	ADDENDUM 3	1/25/13
2	ADDENDUM 2	12/06/2012
1	ISSUED FOR CONSTRUCTION	11/16/2012

CHECKED BY: DJC
 DESIGNED BY: MDM
 DRAWN BY: JBC

GRADING, DRAINAGE, AND EROSION CONTROL PLAN

COW PLAZA HOTEL, LLC
 100 COMMERCIAL STREET, SUITE 306
 PORTLAND, MAINE, C/O TIM SOLEY

HYATT PLACE
 PORTLAND - OLD PORT
 433 FORE STREET
 PORTLAND, ME

JOB NO.: 225869.01
 DATE: NOVEMBER 2012
 SCALE: 1" = 20'
 SHEET: 4 OF 12

C-202

C:\portland\projects\225869_camal 5 - fore & union hotel\wp Drawings\22586901-C200A.dwg, Jan 24, 2013 - 2:42pm