

**GENERAL NOTES**

1. GC TO DEMO EXISTING SPACE AS REQUIRED TO ACCOMMODATE ALL NEW CONSTRUCTION.
2. IT IS THE GENERAL CONTRACTOR'S RESPONSIBILITY TO INSPECT THE ENTIRE PROJECT SPACE PRIOR TO BID TO BECOME AWARE OF ALL THE TYPES OF MATERIALS AND QUANTITIES OF SUCH THAT WILL HAVE TO BE REMOVED.
3. THE GC IS TO PROVIDE ADEQUATE PROTECTION FOR ALL EXISTING ELEMENTS (PUBLIC HALLWAYS, SURROUNDING TENANTS, ETC.) WHICH ARE ADJACENT TO THE CONSTRUCTION AREA.
4. THE GC IS RESPONSIBLE FOR THE HANDLING AND DUMPING COSTS FOR THE REMOVAL OF ALL DEMOLISHED MATERIAL, TRASH AND REFUSE ACCUMULATED ON THE JOB SITE BY ALL SUBCONTRACTORS. THE G.C. IS RESPONSIBLE TO INSURE THAT THE SPACE AND ALL SURFACES ARE DISPOSED OF IN A SAFE AND LEGAL MANNER.
5. GENERAL CONTRACTOR IS RESPONSIBLE FOR VERIFYING LOCATION OF ALL EXISTING LIGHTING, HVAC EQUIPMENT, SPEAKERS, FIRE PROTECTION SYSTEMS, ELECTRICAL SYSTEMS, SECURITY SYSTEMS AND ALL OTHER EQUIPMENT. G.C. TO RELOCATE IF IN CONFLICT WITH NEW CONSTRUCTION.
6. GENERAL CONTRACTOR IS TO CONTACT LINGLE DESIGN GROUP INC. FOR THE RESOLUTION OF ANY CONFLICTS OF INFORMATION ON DRAWINGS DURING DEMOLITION OR CONSTRUCTION DUE TO UNFORSEEN ELEMENTS.
7. GENERAL CONTRACTOR IS RESPONSIBLE FOR ANY PATCHING REQUIRED INSIDE & OUTSIDE OF THE CONSTRUCTION AREA, WHERE AFFECTED BY DEMOLITION.
8. COORDINATION OF THE LOCATION OF DUMPSTER USED FOR REMOVAL OR DEMOLISHED MATERIAL WITH BUILDING MANAGEMENT IS THE RESPONSIBILITY OF THE LANDLORD.

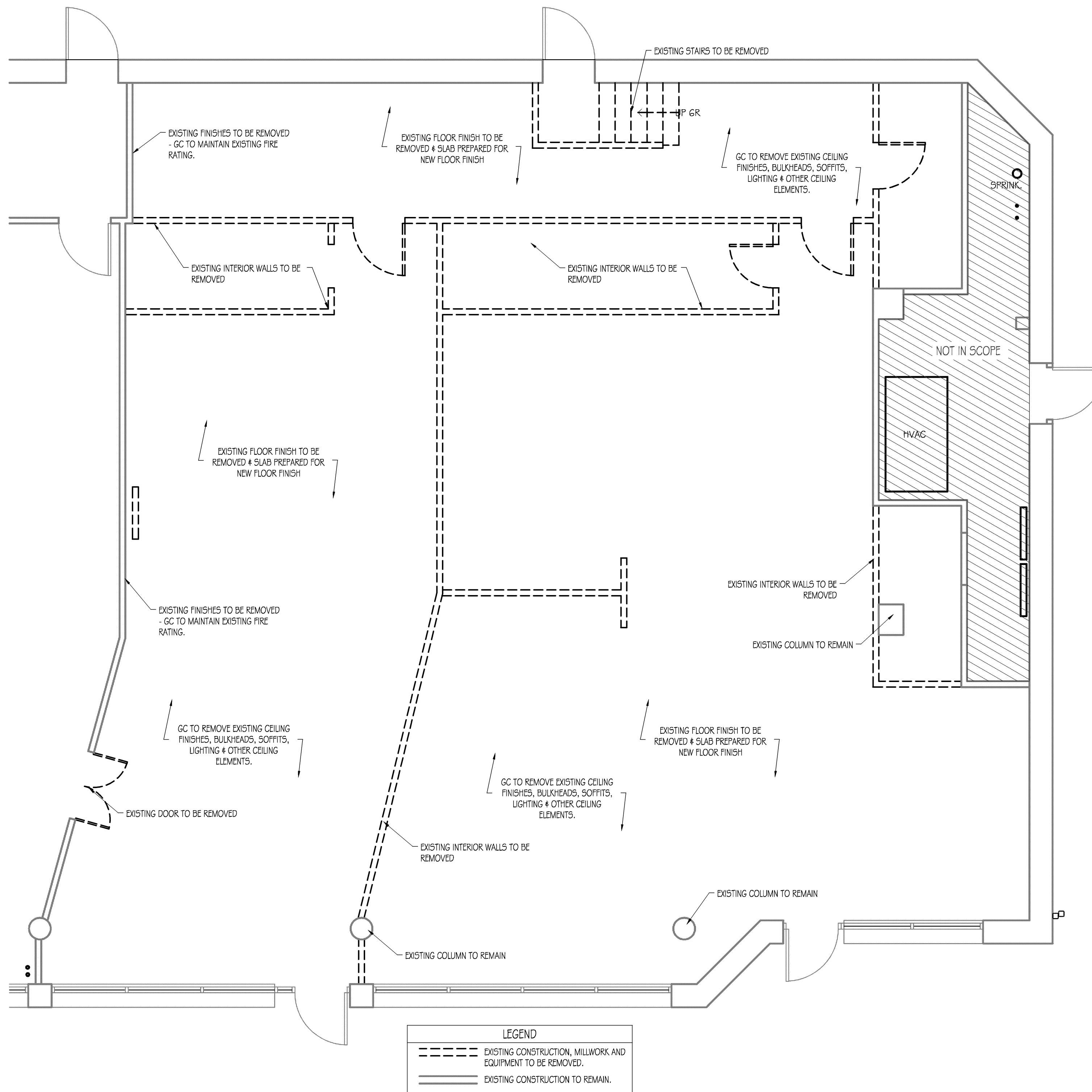

**LEGEND**  
 - - - - - EXISTING CONSTRUCTION, MILLWORK, AND EQUIPMENT TO BE REMOVED.  
 \_\_\_\_\_ EXISTING CONSTRUCTION TO REMAIN.

**DEMOLITION PLAN**

Scale: 1/4"=1'-0"

LINGLEDESIGNGROUP, INC.  
 158 WEST MAIN STREET  
 LENA, IL 61048  
 PHONE: 815-369-9155  
 FAX: 815-369-4495  
 WWW.LINGLEDESIGN.COM

LINGLE DESIGN GROUP, INC.

© ALL DRAWINGS AND WRITTEN MATERIAL CONTAINED HEREIN ARE THE PROPERTY OF THE LINGLE DESIGN GROUP, INC. THEY MAY NOT BE REVISED, COPIED, REUSED, OR DISCLOSED IN ANY MANNER WITHOUT WRITTEN AUTHORIZATION FROM THE ARCHITECT.

**FIVE GUYS**  
 BURGERS and FRIES  
 425 FORE STREET  
 PORTLAND, MAINE 04101-4396

REVISIONS #	DATE	DESCRIPTION
1	12/15/2010	ISSUED FOR PERMIT

PROJECT NUMBER: 10-1033  
 DRAWN BY: SRM  
 CHECKED BY: BVE

SHEET TITLE:  
**DEMOLITION PLAN**

SHEET NUMBER:  
**D110**