

SECTION 1
3/8"=1'-0"

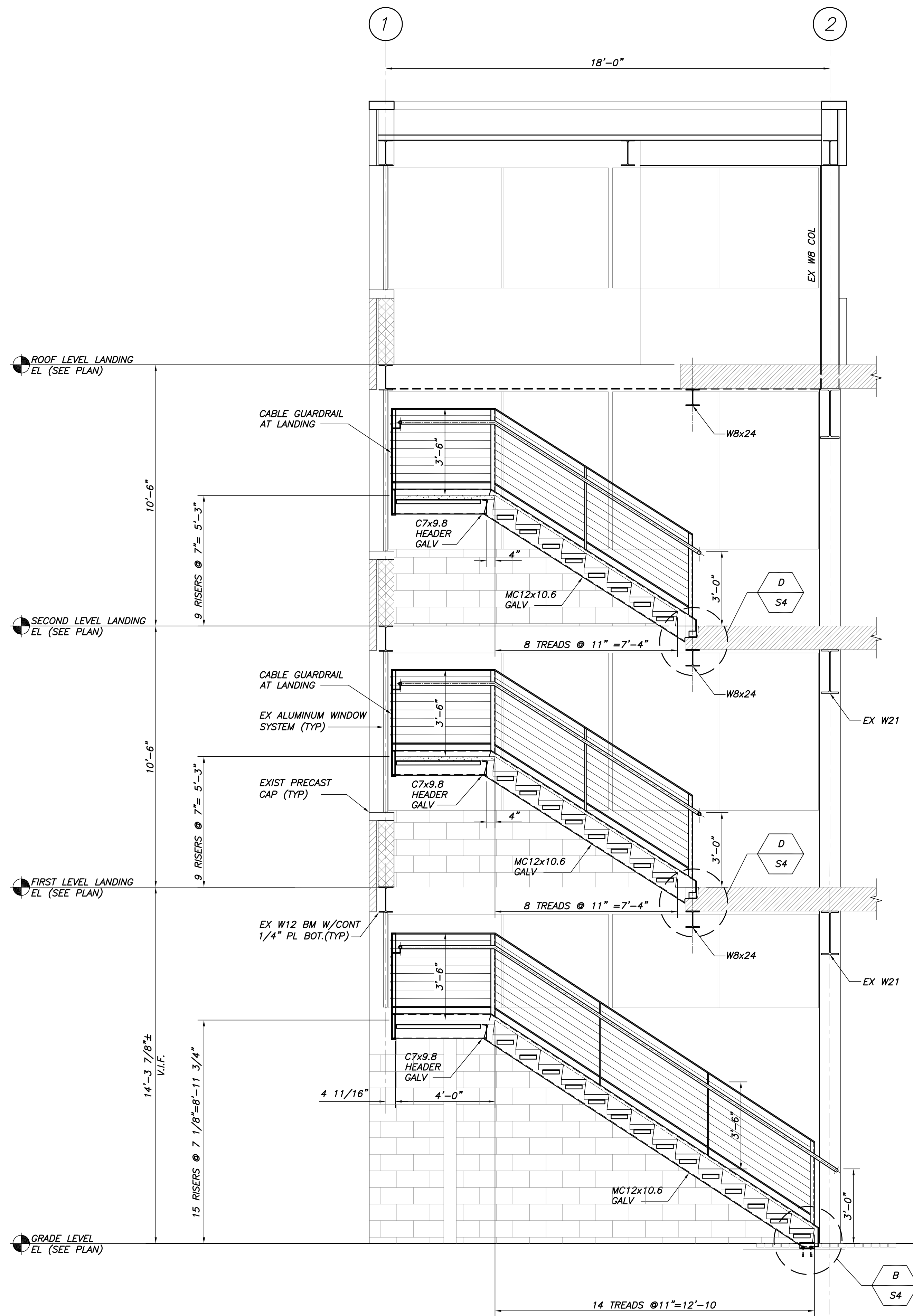

SECTION 2
3/8"=1'-0"

NOT FOR CONSTRUCTION PERMIT SET 4/1/15

THESE DWGS ARE NOT COMPLETE. DESIGN IS STILL IN PROGRESS. CONTRACTOR SHALL CARRY APPROPRIATE CONTINGENCY.

THIS DRAWING IS AN INSTRUMENT OF SERVICE AND SHALL REMAIN THE PROPERTY OF BECKER STRUCTURAL ENGINEERS INC. IT SHALL NOT BE REPRODUCED, COPIED, LENT, OR DISPOSED OF DIRECTLY OR INDIRECTLY, NOR USED FOR ANY PURPOSE OTHER THAN FOR WHICH IT IS SPECIFICALLY FURNISHED AND MUST BE RETURNED TO BECKER STRUCTURAL ENGINEERS INC. ON COMPLETION OF WORK, IF REQUESTED.

BECKER
STRUCTURAL ENGINEERS
78 York Street Portland, Maine 04101
207.879.1838 • beckerstructural.com

STATE OF MAINE
TODD M. NEAL
NO. 9408
LICENSED PROFESSIONAL ENGINEER

Appr	X
Issued For	ISSUED FOR PERMIT
Date	4/1/15
Rev No	

FORE STREET PARKING FACILITY
PORTLAND, MAINE
STAIR #2 REPLACEMENT ELEVATIONS

Designed	AMJ	Scale	AS NOTED
Drawn	RJB	Date	3/27/15
Checked	TMN	Becker Job Number	3534

S2