

MEDIUM DUTY FC MEMBRANE  
DETAIL @ EXPOSED CONCRETE

N.T.S.

NOTES:

1. REF SPECS FOR APPLICATION RATES.
2. PRIMER AND PRE-STRIPING SHALL BE APPLIED AS PER MANUFACTURERS RECOMMENDATIONS.
3. MEDIUM DUTY SHOWN SEE TYPICAL DETAIL FOR HEAVY DUTY APPLICATION ABOVE PRIMER.

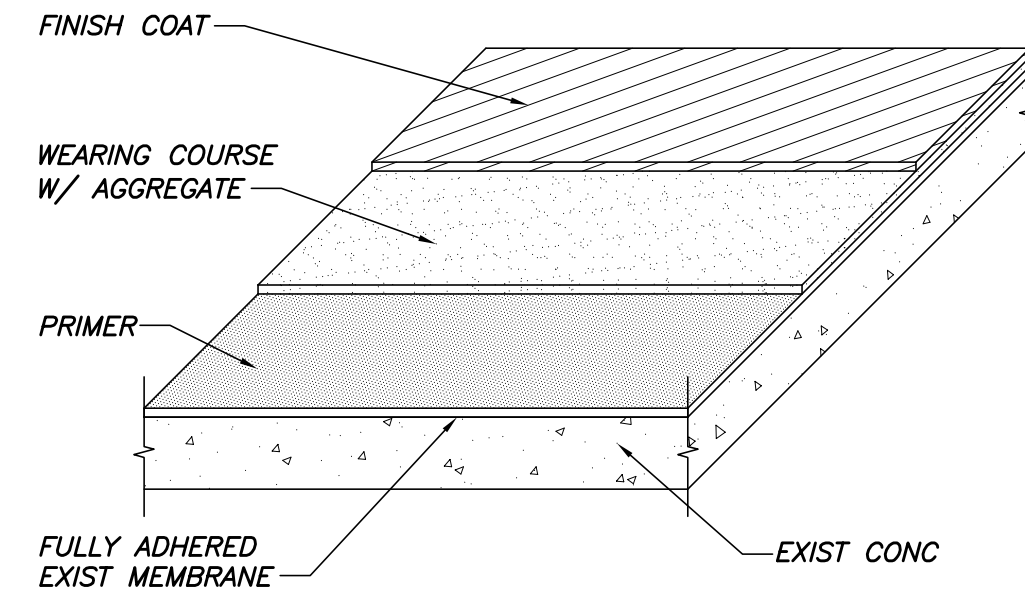

MEDIUM DUTY FC DETAIL OVER  
EXISTING MEMBRANE

N.T.S.

NOTES:

1. REF SPECS FOR APPLICATION RATES.
2. PRIMER AND PRE-STRIPING SHALL BE APPLIED AS PER MANUFACTURERS RECOMMENDATIONS.

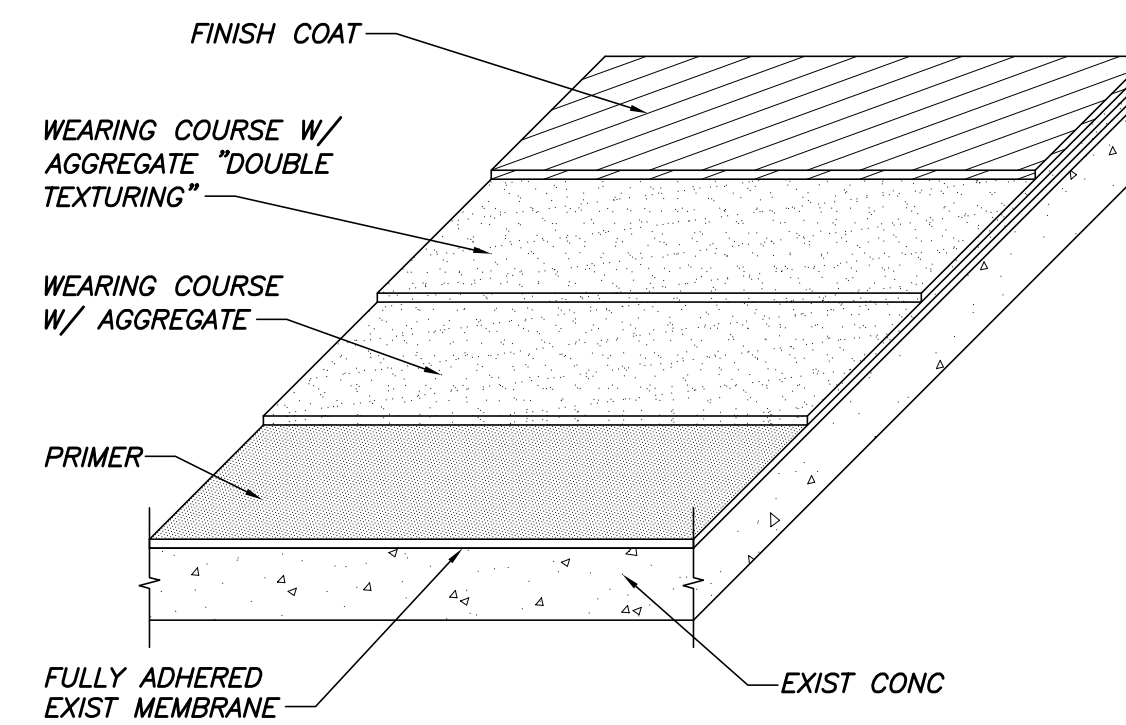

HEAVY DUTY (TURN AREA) FC DETAIL  
OVER EXISTING MEMBRANE

N.T.S.

NOTES:

1. REF SPECS FOR APPLICATION RATES.
2. PRIMER AND PRE-STRIPING SHALL BE APPLIED AS PER MANUFACTURERS RECOMMENDATIONS.

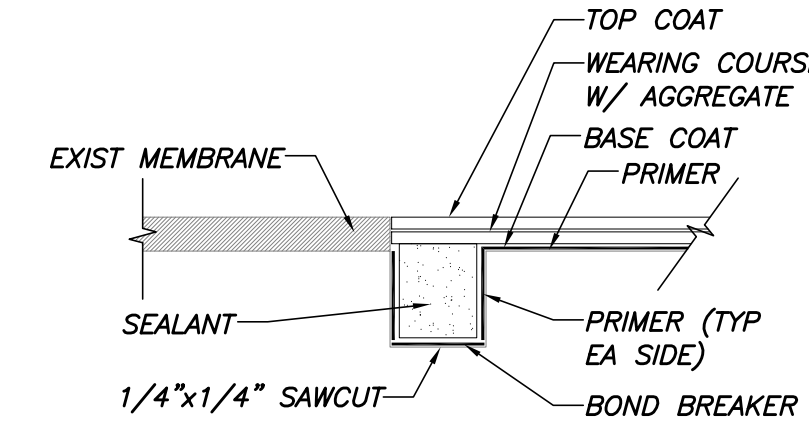

MEMBRANE TERMINATION DETAIL

N.T.S.

TYPICAL MEMBRANE DETAILS

GENERAL NOTES

1. THE NOTES ON THESE DRAWINGS ARE NOT INTENDED TO REPLACE SPECIFICATIONS. SEE SPECIFICATIONS FOR REQUIREMENTS IN ADDITION TO GENERAL NOTES. INCONSISTENCIES BETWEEN THESE DRAWINGS AND THE SPECIFICATIONS SHALL BE BROUGHT TO THE ATTENTION OF THE STRUCTURAL ENGINEER PRIOR TO PROCEEDING WITH THE AFFECTED PORTION OF THE WORK.
2. STRUCTURAL DRAWINGS SHALL BE USED IN CONJUNCTION WITH JOB SPECIFICATIONS.
3. ALL DIMENSIONS AND CONDITIONS MUST BE VERIFIED IN THE FIELD. ANY DISCREPANCIES SHALL BE BROUGHT TO THE ATTENTION OF THE ENGINEER BEFORE PROCEEDING WITH THE AFFECTED PART OF THE WORK.
4. THE REPAIRS TO THIS STRUCTURE HAVE BEEN DESIGNED TO RE-ESTABLISH THE STRUCTURAL INTEGRITY OF THE STRUCTURE AFTER THE REPAIRS ARE COMPLETE. IT IS THE CONTRACTOR'S SOLE RESPONSIBILITY TO DETERMINE PROCEDURES AND SEQUENCE TO INSURE THE SAFETY OF THE BUILDING AND ITS COMPONENTS DURING THE RESTORATION. THIS INCLUDES THE ADDITION OF NECESSARY SHORING, SHEETING, TEMPORARY BRACING, GUYS OR TIE DOWNS. SUCH MATERIAL SHALL REMAIN THE PROPERTY OF THE CONTRACTOR AFTER COMPLETION OF THE PROJECT.
5. SECTIONS AND DETAILS SHOWN ON ANY STRUCTURAL DRAWINGS SHALL BE CONSIDERED TYPICAL FOR SIMILAR CONDITIONS AS DETERMINED BY THE ENGINEER.
6. THE CONTRACTOR SHALL SUBMIT COMPLETE SHOP DRAWINGS FOR ALL PARTS OF THE WORK, INCLUDING DESCRIPTION OF SHORING, AND CONSTRUCTION METHODS AND SEQUENCING WHERE APPLICABLE. NO PERFORMANCE OF THE WORK INCLUDING, BUT NOT LIMITED TO, DEMOLITION OF EXISTING STRUCTURE, OR FABRICATION OR ERECTION OF NEW STRUCTURAL ELEMENTS, SHALL COMMENCE WITHOUT REVIEW OF THE SHOP DRAWINGS BY THE ARCHITECT AND ENGINEER. SUBMIT ONE COPY AND ONE SEPIA. COPY WILL BE REVIEWED AND SEPIA WILL BE RETURNED.
7. ALL APPLICABLE FEDERAL, STATE, AND MUNICIPAL REGULATIONS SHALL BE FOLLOWED, INCLUDING THE FEDERAL DEPARTMENT OF LABOR OCCUPATIONAL SAFETY AND HEALTH ACT.

CONCRETE NOTES

1. CONCRETE WORK SHALL CONFORM TO "BUILDING CODE REQUIREMENTS FOR REINFORCED CONCRETE (ACI 318, LATEST EDITION)," AND "SPECIFICATIONS FOR STRUCTURAL CONCRETE (ACI 301, LATEST EDITION)."
2. GENERAL CONTRACTOR, CONSTRUCTION MANAGER OR OWNER'S CLERK OF THE WORKS SHALL HAVE AVAILABLE ON SITE AT ALL TIMES A COPY OF ACI "FIELD REFERENCE MANUAL SP-15(95)".
3. CONCRETE SHALL BE CONTROLLED CONCRETE, PROPORTIONED, MIXED, AND PLACED IN THE PRESENCE OF A REPRESENTATIVE OF AN APPROVED TESTING AGENCY.
4. CONCRETE MIX DESIGN (TOPPING SLAB REPAIR): SEE REPAIR DETAILS S3.1
  - A. ADD AIR ENTERING ADMIXTURE AT MANUFACTURER'S PRESCRIBED RATE TO RESULT IN CONCRETE AT POINT OF PLACEMENT HAVING THE ABOVE NOTED AIR CONTENTS.
  - B. ADDITIONAL SLUMP MAY BE ACHIEVED BY THE ADDITION OF A MIDRANGE OR HIGH RANGE WATER REDUCING ADMIXTURE. MAXIMUM SLUMP AFTER ADDITION OF ADMIXTURE SHALL BE 8 INCHES.
5. CONCRETE SHALL NOT BE PLACED IN WATER OR ON FROZEN GROUND.
6. REINFORCING BARS SHALL CONFORM TO ASTM A615 GRADE 60 DEFORMED BARS AND SHALL BE DETAILED, FABRICATED AND PLACED IN ACCORDANCE WITH ACI 315, LATEST EDITION.
7. WELDED WIRE FABRIC SHALL CONFORM TO ASTM A-185 AND BE PROVIDED IN FLAT SHEETS.
8. FIBER REINFORCEMENT SHALL BE TYPE III SYNTHETIC VIRGIN HOMOPOLYMER POLYPROPYLENE FIBERS CONFORMING TO ASTM C1116.
9. MINIMUM CONCRETE PROTECTIVE COVERING FOR REINFORCEMENT, UNLESS NOTED OTHERWISE, SHALL BE AS FOLLOWS:
 

A) SURFACES CAST AGAINST AND PERMANENTLY IN CONTACT WITH EARTH	3.0"
B) FORMED SURFACES IN CONTACT WITH EARTH OR EXPOSED TO WEATHER	1.5"
#5 BARS, 5/8" DIAMETER WIRE, AND SMALLER	2.0"
#6 THROUGH #11 BARS	1.0"
C) SURFACES NOT IN CONTACT WITH EARTH OR EXPOSED TO WEATHER	1.5"
WALLS, SLABS, JOISTS #11 BARS AND SMALLER	
BEAMS, GIRDERS, AND COLUMNS; ALL REINFORCEMENT	
10. WELDING OF REINFORCEMENT IS NOT PERMITTED.

CONCRETE COATING NOTES

PREPARATION

1. SLAB MUST BE DRY, CLEAN, SOUND AND FREE OF CONTAMINANTS WHICH MAY INTERFERE WITH ADHESION OR PROPER CURING.
2. PREPARE SURFACE BY SANDBLASTING OR OTHER METHOD RECOMMENDED BY THE MANUFACTURER.
3. MEMBRANE INSTALLER SHALL CONFIRM SURFACE PREPARATION PRIOR TO INSTALLATION OF THE MEMBRANE. INSTALLATION OF THE MEMBRANE IMPLIES ACCEPTANCE OF SURFACE PREPARATION.

INSTALLATION

1. APPLY 2 COATS OF PENETRATING, CORROSION INHIBITING, IMPREGNATION COATING.
2. INSTALL AS PER MANUFACTURERS RECOMMENDATIONS.
  - A. APPLY PRIMER
  - B. APPLY WEARING SURFACE COAT
  - C. WEARING SURFACE COAT
    - i. 6 DRY MILS TOP COAT
    - ii. APPLY AGGREGATE
    - iii. 8 DRY MILS TOP COAT
  - D. TOTAL THICKNESS AVG 32 DRY MILS
3. CONTRACTOR TO ENSURE THAT ALL PRODUCTS USED ARE COMPATIBLE.

PRODUCT

1. SIKA FERROGARD 903 (201) 933-8800, WWW.SIKAUSA.COM
2. NEOGAURD PEDA-GARD (214) 353-1684
3. OR APPROVED EQUAL.

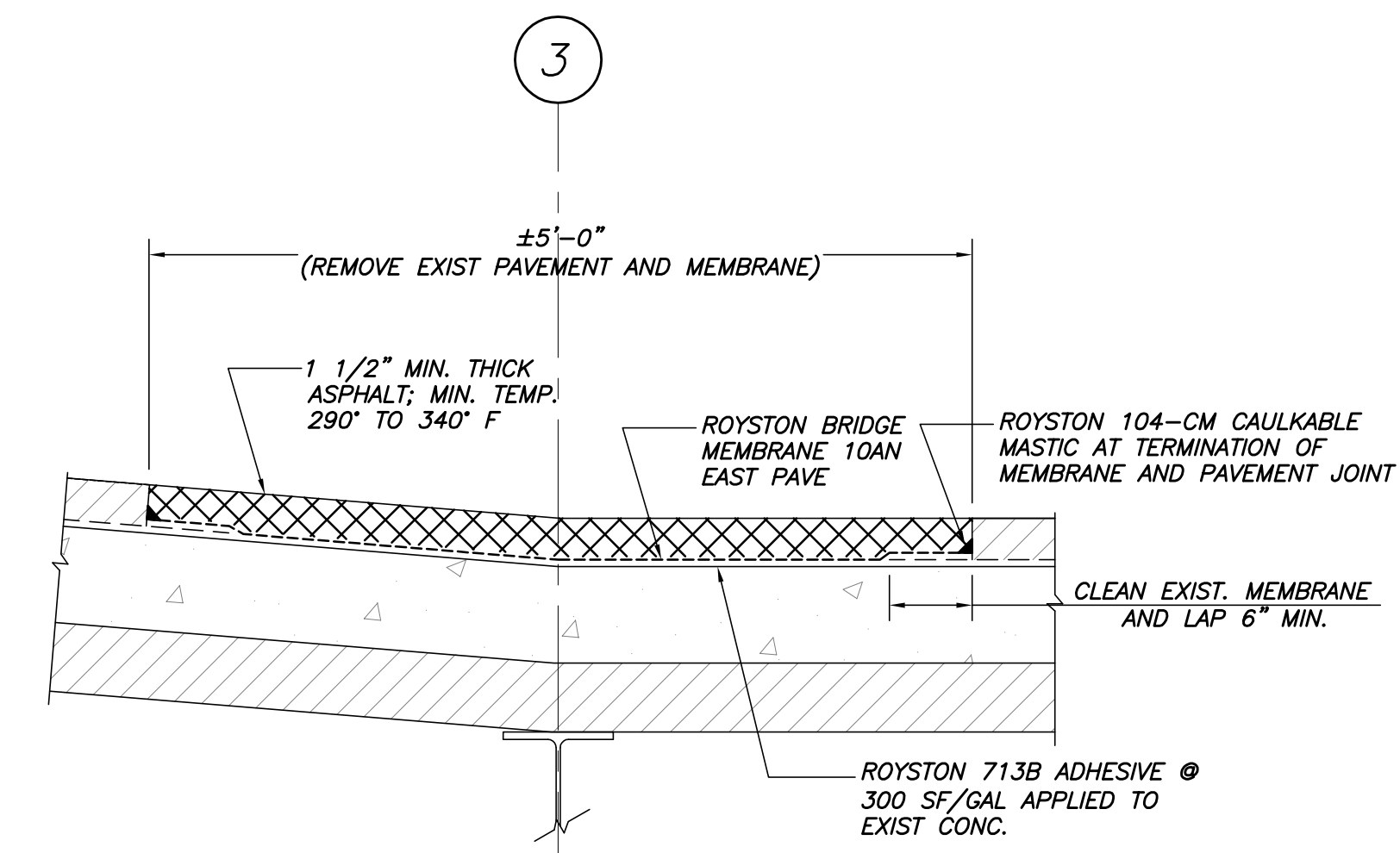

SECTION X

N.T.S.

MEMBRANE NOTES

GENERAL

1. CONTRACTOR SHALL COORDINATE A MEETING WITH OWNER, ENGINEER AND MATERIAL MANUFACTURER'S REPRESENTATIVE TO REVIEW APPLICATION, MAINTENANCE REQUIREMENTS, MATERIAL LIMITATIONS AND WARRANTY.
2. PROVIDE IN WRITING FROM MANUFACTURER THAT TRAFFIC BEARING MEMBRANE SYSTEM IS COMPATIBLE WITH EXISTING CONDITIONS.
3. ENSURE TRAFFIC STRIPING PAINT IS COMPATIBLE WITH THE SELECTED TRAFFIC BEARING MEMBRANE.
4. APPLICATOR SHALL BE APPROVED BY TRAFFIC MEMBRANE MANUFACTURER WITH A MINIMUM OF 5 YEARS OF EXPERIENCE WITH SUBMITTED MATERIAL AND APPLICATION.
5. CONTRACTOR SHALL VERIFY THAT ALL REPAIR/PATCH MATERIALS AND JOINT SEALANTS ARE COMPATIBLE WITH SEALANT MEMBRANE.
6. MATERIAL SUPPLIER SHALL PERFORM AN ADHESION TEST TO EXISTING TRAFFIC MEMBRANE AND CONCRETE SURFACES.

EXAMINATION

1. CONCRETE: VERIFY THAT THE WORK DONE UNDER OTHER SECTIONS MEETS THE FOLLOWING REQUIREMENTS:
  - A. THAT THE CONCRETE DECK SURFACE IS FREE OF RIDGES AND SHARD PROJECTIONS. IF METAL FORMS OR DECKS ARE USED, THEY SHOULD BE VENTILATED TO PERMIT ADEQUATE DRYING OF CONCRETE ON EXTERIOR EXPOSED DECK.
  - B. THAT THE CONCRETE WAS CURED FOR A MINIMUM OF 28 DAYS (MINIMUM OF 4,000 PSI COMPRESSIVE STRENGTH). WATER-CURED TREATMENT OF CONCRETE IS PREFERRED. THE USE OF CONCRETE CURING AGENTS, IF ANY, SHALL BE OF THE SODIUM SILICATE BASE ONLY; OTHERS REQUIRE WRITTEN APPROVAL BY NEOGARD®.
  - C. THAT THE CONCRETE WAS FINISHED BY A POWER OF HAND STEEL TROWEL FOLLOWED BY SOFT HARD BROOM TO OBTAIN LIGHT TEXTURE OR "SIDEWALK" FINISH.
  - D. THAT DAMAGED AREAS OF THE CONCRETE DECK BE RESTORED AS PER CONTRACT DRAWINGS.

PREPARATION

1. PROTECTION:

- A. PROTECT PLANTS, VEGETATION, VEHICLES AND PEDESTRIANS WHICH MIGHT BE AFFECTED BY COATING. USE DROP CLOTHS OR MASKING AS REQUIRED.
- B. ADHERE TO SPECIFICATIONS AND MANUFACTURER'S RECOMMENDATIONS.

2. APPLICATION:

- A. ADHERE TO SPECIFICATIONS AND MANUFACTURERS RECOMMENDATIONS ACCEPT AS NOTED IN THE SPECIFICATION.

3. CLEANING:

- A. REMOVE DEBRIS RESULTING FROM COMPLETION OF COATING OPERATION FROM THE PROJECT SITE.

4. PROTECTION:

- A. AFTER COMPLETION OF APPLICATION, DO NOT ALLOW TRAFFIC ON COATED SURFACES FOR A PERIOD OF AT LEAST 24 HOURS AT 75°F. AND 50% R.H., OR UNTIL COMPLETELY CURED.



Approved For	
Issued For	ISSUED FOR PRICING
Date	9/13/13
Rev. No	10/11/13
	ISSUED FOR PERMIT

FORE STREET PARKING FACILITY  
PORTLAND, MAINE

GENERAL NOTES AND TYP. REPAIR DTLS

Designed	AMJ	Scale	AS NOTED
Drawn	MK	Date	9/13/13
Checked	TMN	Becker Job Number	3144

S3.2

THIS DRAWING IS AN INSTRUMENT OF SERVICE AND SHALL REMAIN THE PROPERTY OF BECKER STRUCTURAL ENGINEERS INC. IT SHALL NOT BE REPRODUCED, COPIED, LENT OR DISPOSED OF DIRECTLY OR INDIRECTLY NOR USED FOR ANY PURPOSE OTHER THAN FOR WHICH IT IS SPECIFICALLY FURNISHED AND MUST BE RETURNED TO BECKER STRUCTURAL ENGINEERS INC. ON COMPLETION OF WORK, IF REQUESTED.