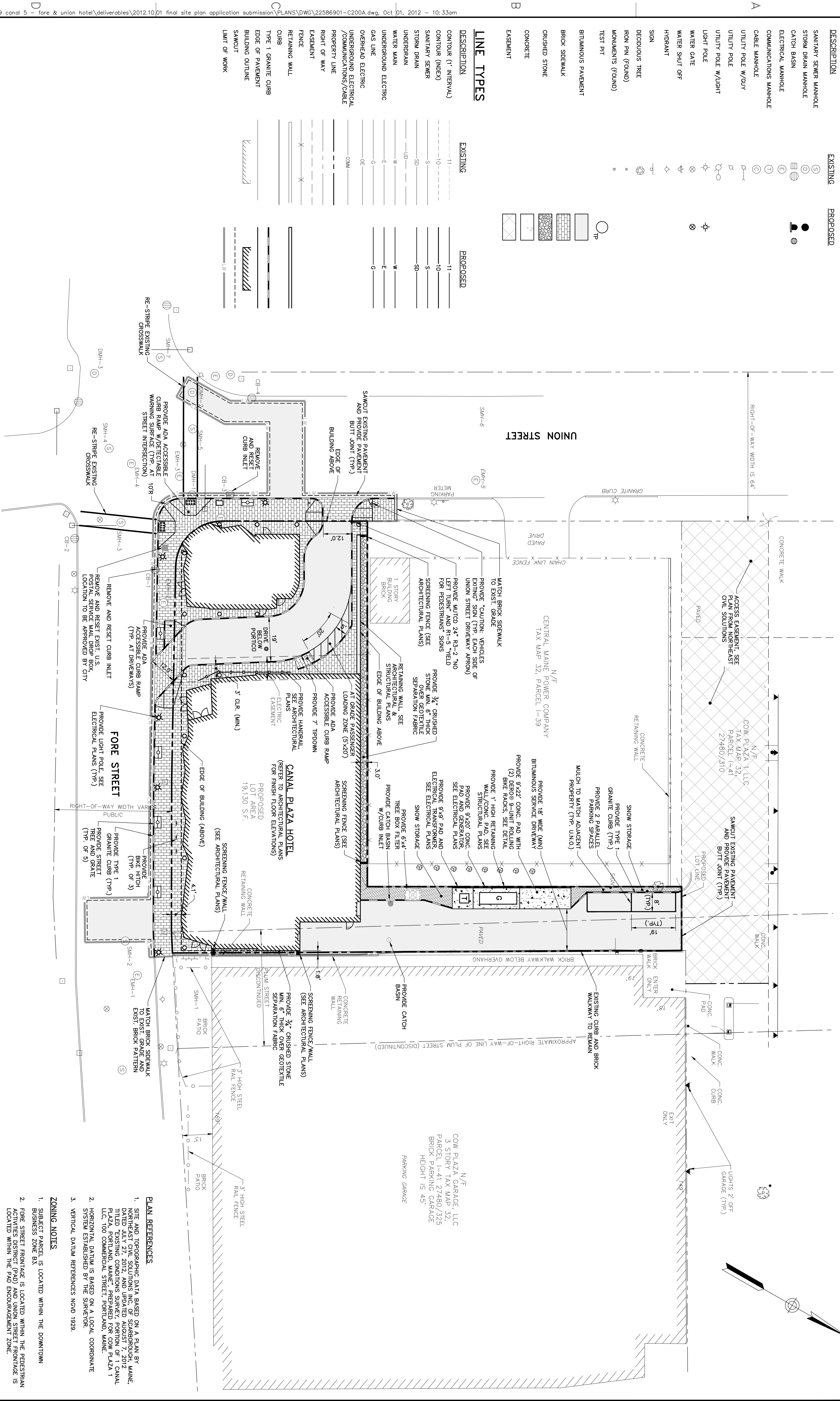

EXHIBIT-05



SYMBOLS

DESCRIPTION	EXISTING	PROPOSED
SANITARY SEWER MANHOLE	⊙	⊙
STORM DRAIN MANHOLE	⊖	⊖
CATCH BASIN	⊕	⊕
ELECTRICAL MANHOLE	⊗	⊗
COMMUNICATIONS MANHOLE	⊘	⊘
CABLE MANHOLE	⊙	⊙
UTILITY POLE W/3/4" UTILITY POLE	⊙	⊙
UTILITY POLE W/3/4" UTILITY POLE W/LIGHT	⊙	⊙
LIGHT POLE	⊙	⊙
WATER SHUT OFF	⊙	⊙
WATER GATE	⊙	⊙
HYDRANT	⊙	⊙
SIGN	⊙	⊙
DECIDUOUS TREE	⊙	⊙
IRON PIN (FOUND)	⊙	⊙
MONUMENTS (FOUND)	⊙	⊙
TEST PIT	⊙	⊙
BITUMINOUS PAVEMENT	⊙	⊙
BRICK SIDEWALK	⊙	⊙
CRUSHED STONE	⊙	⊙
CONCRETE	⊙	⊙
EASEMENT	⊙	⊙

LINE TYPES

DESCRIPTION	EXISTING	PROPOSED
CONTOUR (1' INTERVAL)	11	11
CONTOUR (INDEX)	10	10
SANITARY SEWER	S	S
STORM DRAIN	SD	SD
UNDERDRAIN	U	U
WATER MAIN	W	W
UNDERGROUND ELECTRIC	E	E
GAS LINE	G	G
OVERHEAD ELECTRIC	OE	OE
UNDERGROUND ELECTRICAL /COMMUNICATIONS/CABLE	COM	COM
PROPERTY LINE	X	X
RIGHT OF WAY	X	X
EASEMENT	X	X
RETAINING WALL	X	X
CURB	X	X
TYPE 1 GRANITE CURB	X	X
EDGE OF PAVEMENT	X	X
BUILDING OUTLINE	X	X
SAWCUT	X	X
LIMIT OF WORK	X	X

- PLAN REFERENCES**
- SITE AND TOPOGRAPHIC DATA BASED ON A PLAN BY NORTHEAST CIVIL SOLUTIONS INC. OF SCARBOROUGH, MAINE, DATED JULY 27, 2012, AND UPDATED AUGUST 7, 2012. TITLED "EXISTING CONDITIONS SURVEY, PORTION OF 1 CANAL PLAZA HOTEL, 100 COMMERCIAL STREET, PORTLAND, MAINE, LLC. 100 COMMERCIAL STREET, PORTLAND, MAINE, LLC. HORIZONTAL DATUM IS BASED ON A LOCAL COORDINATE SYSTEM ESTABLISHED BY THE SURVEYOR.
 - VERTICAL DATUM REFERENCES NVD 1929.
- ZONING NOTES**
- SUBJECT PARCEL IS LOCATED WITHIN THE DOWNTOWN BUSINESS ZONE B3.
 - FORE STREET FRONTAGE IS LOCATED WITHIN THE PEDESTRIAN ACTIVITIES DISTRICT (PAD) AND UNION STREET FRONTAGE IS LOCATED WITHIN THE PAD ENCOURAGEMENT ZONE.



PRELIMINARY - NOT FOR CONSTRUCTION

REV	DESCRIPTION	DATE
2	FINAL SITE PLAN APPLICATION SUBMISSION	9/28/2012
1	RESPONSE TO CITY REVIEW COMMENTS	9/21/2012

DESIGNED BY: MDLM CHECKED BY: DLC
 DRAWN BY: JBC 22586901-C200A.DWG

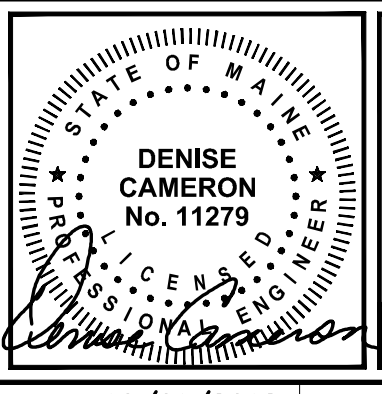

WOODARD & CURRAN

41 Hutchins Drive
 Portland, Maine 04102
 800.426.4262 | www.woodardcurran.com

COMMITMENT & INTEGRITY DRIVE RESULTS

THIS DOCUMENT IS THE PROPERTY OF WOODARD & CURRAN, INC. AND ITS CLIENT. REPRODUCTION OR MODIFICATION WITHOUT WRITTEN PERMISSION IS PROHIBITED.

C-201

COW PLAZA HOTEL, LLC
 100 COMMERCIAL STREET, SUITE 306
 PORTLAND, MAINE, C/O TIM SOLEY

CANAL PLAZA HOTEL

JOB NO.: 22586901
 DATE: OCTOBER 2012
 SCALE: 1" = 20'
 SHEET: 2 OF 9