

**PARTIAL BUILDING SECTION**

SCALE: 1/4" = 1'-0"

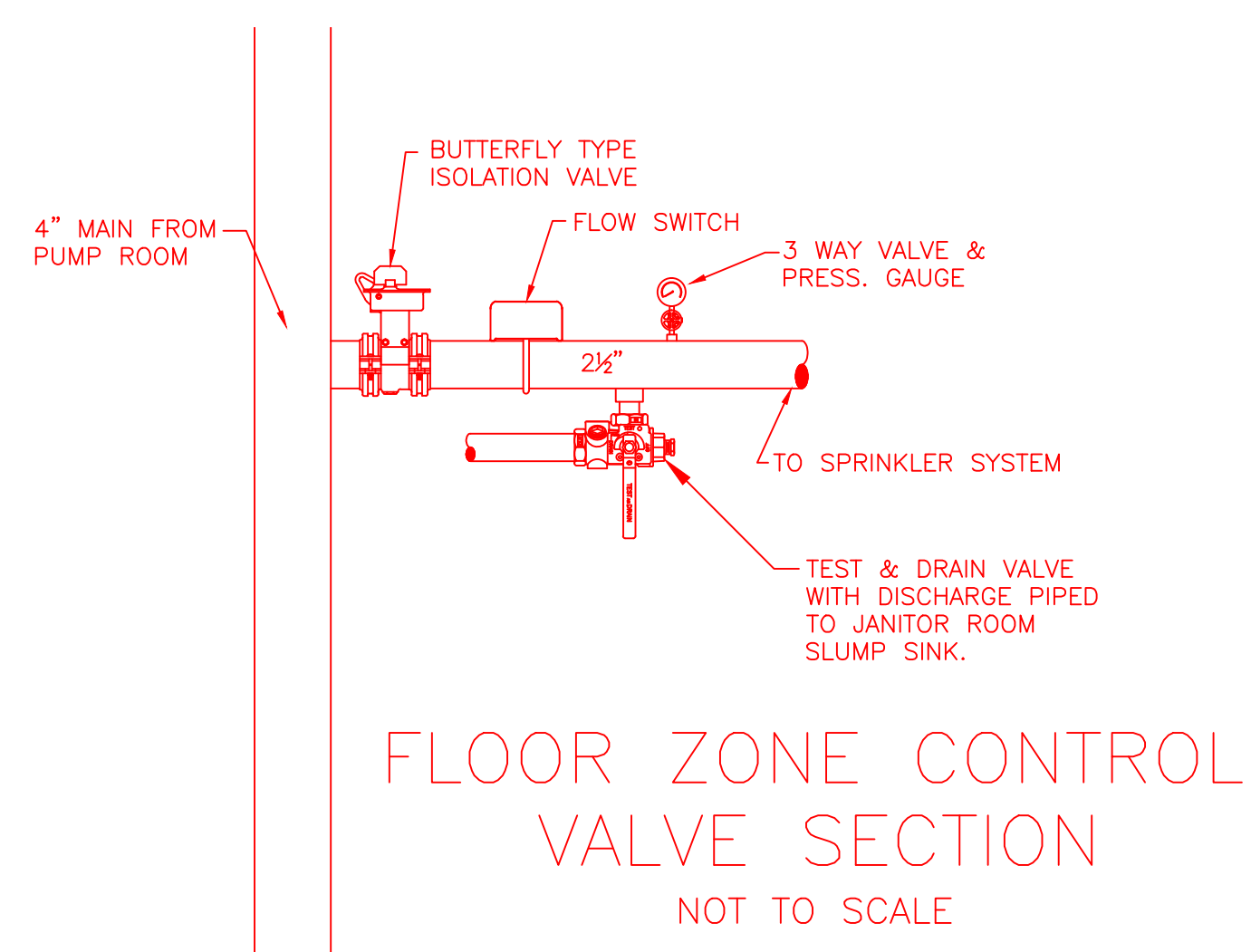

**GENERAL NOTES:**

- IT IS THE BUILDING OWNERS RESPONSIBILITY TO PROVIDE ADEQUATE HEAT FOR ALL AREAS IN THE BUILDING PROTECTED BY WET SPRINKLER SYSTEMS AND FOR ALL WATER FILLED SUPPLY PIPES, VALVES AND SYSTEM RISERS IN ALL DRY PIPE SPRINKLER SYSTEMS.
- ALL NEW PIPING IS TO BE HYDROSTATICALLY TESTED AT NOT LESS THAN 200 PSI FOR 2 HOURS, OR AT 50 PSI IN EXCESS OF THE MAXIMUM PRESSURE, WHEN THE MAXIMUM PRESSURE TO BE MAINTAINED IS IN EXCESS OF 150 PSI. (PER NFPA 13)
- WHETHER OR NOT INDICATED ON DRAWINGS, THE FOLLOWING ITEMS ARE TO BE PROVIDED:
  - SPARE HEAD CABINET WITH WRENCH (NFPA 13)
  - PROVISIONS FOR FLUSHING CONNECTIONS AND DRAINING OF ALL PIPE.
  - INSPECTORS TEST CONNECTION SHALL BE PROVIDED FOR EACH SYSTEM
  - A) FOR WET PIPE SYSTEMS SEE NFPA 13
  - WET PIPE SYSTEMS SHALL BE PROVIDED WITH A RELIEF VALVE NOT LESS THAN 1/2" IN SIZE. (NFPA 13).
- CPVC PIPING WILL BE USED ON THIS PROJECT DUE TO SUSPENDED CEILING NOT BEING REMOVED. EXISTING PIPING IS BLACK IRON AND THE ZONE CONTROL PIPING OFF THE RISERS WILL BE SCHEDULE 10 STEEL WITH GROOVED COUPLINGS AND ANVIL MECHANICAL TYPE FITTINGS.
- ALL MECHANICAL TRADES ARE TO COORDINATE THEIR WORK WITH SPRINKLER WORK AS SHOWN ON THESE PLANS.
- ALL HANGERS AND LOCATIONS ARE TO BE IN ACCORDANCE WITH N.F.P.A. 13.
- ALL SPRINKLER HEADS IN SUSPENDED CEILING TILES ARE TO BE LOCATED IN THE CENTER OF THE ACOUSTICAL CEILING PANEL.
- ALL PIPING IS TO BE PITCHED IN ACCORDANCE WITH N.F.P.A. 13.
- HYDRAULIC DATA REFERENCE POINTS: (26) (12")
- CENTER LINE OF PIPE ABOVE FINISH FLOOR 12'-0" BELOW DECK 12"
- PROTECTIVE CAPS ARE TO REMAIN ON THE SPRINKLER HEADS UNTIL AFTER CEILINGS ARE INSTALLED.
- WHERE SURFACE MOUNTED OBSTRUCTIONS EXIST DEEP ESCUTCHEON SPRINKLER HEADS WILL BE INSTALLED.
- WORK IS LIMITED TO THE WORK SHOWN ON THESE DOCUMENTS.
- WATER SUPPLY IS CITY WATER WITH AN EXISTING FIRE PUMP.
- FIRE PUMP IS A PEERLESS PUMP, MODEL 4-401-11A. RATED CAPACITY 500 GPM @ 40 PSI.

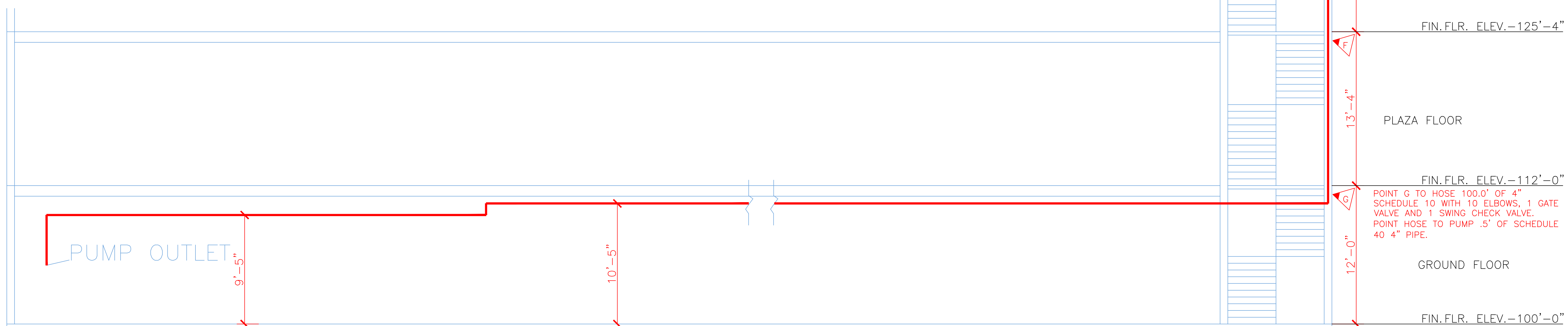

**EXISTING MAIN & STAND PIPE RISER SECTION**  
NOT TO SCALE

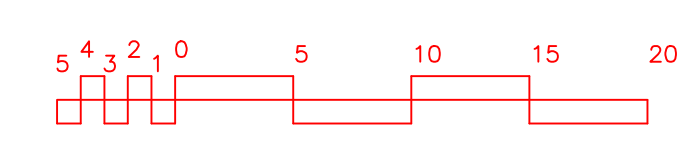

SUBMITTAL COPY

- Type of Hazard LIGHT/ORDINARY 2. Deflector Distance PER SPEC
- Pipe Type Used BLK\_SCH\_10/40 4. Sprinkler Area PER SPEC
- Type of Construction NON COMBUSTIBLE
- Maximum Spacing Allowed PER NFPA 13
- PIPE SIZING METHOD: PIPE SCHEDULE  HYDRAULICALLY CALCULATED
- ALL HANGERS AND LOCATIONS TO BE IN ACCORDANCE WITH N.F.P.A. PAMPHLET NO. 13
- HIGH DEGREE TEMPERATURE SPRINKLER HEADS TO BE INSTALLED IN ACCORDANCE WITH N.F.P.A. PAMPHLET NO. 13

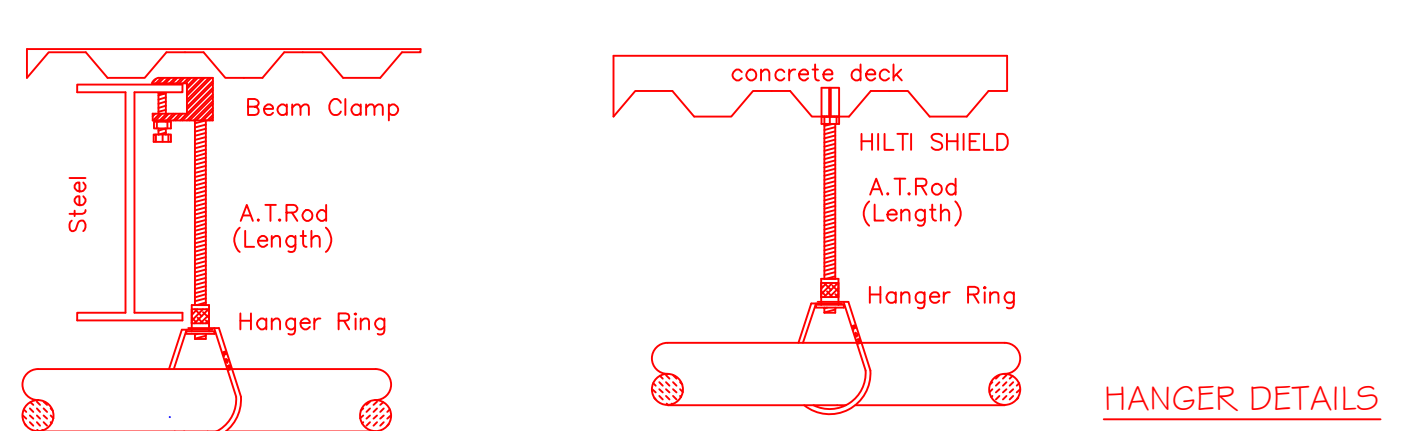

HANGERS	
ITEM	OTHERS
AS SHOWN IN DETAIL	

ABBREVIATIONS	
B	Bottom of Beam
D	Bottom of Deck
P	Bottom of Pipe
HV	Hose Valve
R & C	Ripple and Cap
NC	Not in Contact
NTS	Not to Scale
ORU	Open Bar Joints
PRV	Pressure Red Valve
RM	Road Manifold
SP	Standpipe
TSP	Top of Beam
TOP	Top of Pipe
TOS	Top of Steel
UN	Unless Otherwise Noted
CL	Centaline
NA	No Automatic Sprinklers
OTA	Open to Above

CONTRACT RESPONSIBILITIES	
ITEM	OTHERS
STREET CONN	
LOG MAN	
EXCAVATION	
FLUSHING	
WIRING	
PAINTING	
TAMPER SWITCHES	
FLOW SWITCHES	
STREET CONN	

SPRINKLER HEAD LEGEND											
SYMBOL	MAKE	MODEL	SIN	FINISH	TYPE	TEMP	NPT	ORIFICE	K-FACTOR	TOTAL	
	RELIABLE	F1FR 56	RA1414	WHITE	SEMI-REC PENDENT	155° F	1/2"	1/2"	5.6	33	1'S 0
	RELIABLE	F1FR 56	RA1414	WHITE	DEEP ESCUTCH	155° F	1/2"	1/2"	5.6	2	F.M.
	RELIABLE	GS 56	RA3415	WHITE	CONICAL	165° F	1/2"	1/2"	5.6	2	L.M.
	RELIABLE	F1FR 56	RA1414	WHITE	SEMI-REC PENDENT	155° F	3/4"	17/32"	8.0	36	I.R.1
										73	

SENT TO: DATE SENT: 02/09/16 DATE RECEIVED:

SENT TO: DATE RECEIVED:

STATE FIRE LOCAL FIRE LOCAL WATER OWNER

LICENSE# 093 442 R.M.S.# PERMIT # ????

P.O. BOX 1285 LEWISTON MAINE 04243-1285

**THREE CANAL PLAZA**  
MIDDLE STREET  
PORTLAND, MAINE 04101

CONTRACT WITH EAST BROWN COW

SYSTEM TYPE	NO.	DATE	REVISIONS
WET			
DRY			
DELUGE			
PREACTION			
ME. LIFE			
HYDRO-PRO			

SCALE AS NOTED  
DRAWN BY JJP  
CHECKED BY CDS  
DATE 02/01/2016  
TOTAL SPRKRS ON JOB 73  
SHEET# 1 of 2  
JOB# 15101