

# DISPLAY THIS CARD ON PRINCIPAL FRONTAGE OF WORK

## CITY OF PORTLAND

Please Read  
Application And  
Notes, If Any,  
Attached

### BUILDING INSPECTION

## PERMIT

Permit Number: 060069

This is to certify that OCTOBER CORPORATION R.P. Morrison Builders, Inc.has permission to Build a 9' divider wall add DAT 3 CANAL PLAZA

provided that the person or persons performing or supervising this permit shall comply with all of the provisions of the Statutes of Maine and of the Ordinances of the City of Portland regulating the construction, maintenance and use of buildings and structures, and of the application on file in this department.

Apply to Public Works for street line and grade if nature of work requires such information.

Notification of inspection must be given and written permission procured before this building or part thereof is closed or service closed-in. 4  
OUR NOTICES REQUIRED

A certificate of occupancy must be procured by owner before this building or part thereof is occupied.

#### OTHER REQUIRED APPROVALS

Fire Dept. \_\_\_\_\_

Health Dept. \_\_\_\_\_

Appeal Board \_\_\_\_\_

Other \_\_\_\_\_

Department Name \_\_\_\_\_

*Al J. August 1/19/02*  
Director - Building & Inspection Services

PENALTY FOR REMOVING THIS CARD

# BUILDING PERMIT INSPECTION PROCEDURES

**Please call 874-8703 or 874-8693 to schedule your inspections as agreed upon**

Permits expire in 6 months, if the project is not started or ceases for 6 months.

The Owner or their designee is required to notify the inspections office for the following inspections and provide adequate notice. Notice must be called in 48-72 hours in advance in order to schedule an inspection:

By initializing at each inspection time, you are agreeing that you understand the inspection procedure and additional fees from a "Stop Work Order" and "Stop Work Order Release" will be incurred if the procedure is not followed as stated below.

A Pre-construction Meeting will take place upon receipt of your building permit.

<input checked="" type="checkbox"/> <b>Footing/Building</b> Location Inspection;	Prior to pouring concrete
<input checked="" type="checkbox"/> Re-Bar Schedule Inspection:	Prior to pouring concrete
<input checked="" type="checkbox"/> <b>Foundation</b> Inspection:	Prior to placing <b>ANY</b> backfill
<input checked="" type="checkbox"/> Framing/Rough Plumbing/Electrical:	Prior to any insulating or drywalling
<input checked="" type="checkbox"/> <b>Final</b> Certificate of Occupancy:	Prior to any occupancy of the structure or use. NOTE: There is a \$75.00 fee per inspection at this point.

Certificate of Occupancy is not required for certain projects. Your inspector can advise you if your project requires a Certificate of Occupancy. **All** projects **DO** require a final inspection

☒ **If any** of the inspections do not occur, the project cannot **go** on to the next phase, **REGARDLESS OF THE NOTICE OR CIRCUMSTANCES.**

☒ **CERIFICATE OF OCCUPANICES MUST BE ISSUED AND PAID FOR, BEFORE THE SPACE MAY BE OCCUPIED**

Signature of Applicant/Designee

Date

Signature of Inspections Official

Date

CBL: 32 I 23

Building Permit #: 06-069

# City of Portland, Maine - Building or Use Permit Application

389 Congress Street, 04101 Tel: (207) 874-8703, Fax: (207) 874-8716

<b>Location of Construction:</b> 3 CANAL PLAZA		<b>Owner Name:</b> OCTOBER CORPORATION		<b>Permit No:</b> 06-0069		<b>Issue Date:</b> JAN 19 2006		<b>PERMIT ISSUED</b> 032 1073001	
<b>Business Name:</b>		<b>Contractor Name:</b> R.P. Morrison Builders, Inc.		<b>Owner Address:</b> ONE CANAL PLAZA		<b>Phone:</b>			
<b>Lessee/Buyer's Name</b>		<b>Phone:</b>		<b>Contractor Address:</b> 270 Roosevelt Trail Windham		<b>Phone:</b> 207-892-4118		<b>CITY OF PORTLAND</b>	
<b>Past Use:</b> Commercial/ Suite 601		<b>Proposed Use:</b> Commercial Suite 601 Senator Olympia Snowe's Office/ Build a 9' divider wall add Door		<b>Permit Type:</b> Alterations - Commercial		<b>Zone:</b>			
				<b>Permit Fee:</b> \$39.00		<b>Cost of Work:</b> \$2,000.00		<b>CEO District:</b> 1	
				<b>FIRE DEPT:</b> <input type="checkbox"/> Approved <input type="checkbox"/> Denied		<b>INSPECTION:</b> Use Group <i>B</i> Type: <i>213</i> <i>1/19/06</i> <i>du August</i>			
				Signature		Signature			
				Action: <input type="checkbox"/> Approved <input type="checkbox"/> Approved w/Conditions <input type="checkbox"/> Denied					
				Signature: Date:					
<b>Permit Taken By:</b> ldobson		<b>Date Applied For:</b> 01/17/2006		<b>Zoning Approval</b>					
1.  2. Building permits do not include plumbing, septic or electrical work.  3. Building permits are void if work is not started within six (6) months of the date of issuance. False information may invalidate a building permit and stop all work..				<b>Special Zone or Reviews</b>		<b>Zoning Appeal</b>		<b>Historic Preservation</b>	
				<input type="checkbox"/> Shoreland  <input type="checkbox"/> Wetland  <input type="checkbox"/> Flood Zone  <input type="checkbox"/> Subdivision  <input type="checkbox"/> Site Plan  Maj <input type="checkbox"/> Minor <input type="checkbox"/> MM <input type="checkbox"/>  Date:		<input type="checkbox"/> Variance  <input type="checkbox"/> Miscellaneous  <input type="checkbox"/> Conditional Use  <input type="checkbox"/> Interpretation  <input type="checkbox"/> Approved  <input type="checkbox"/> Denied  Date:		<input type="checkbox"/> Not in District or Landmark  <input type="checkbox"/> Does Not Require Review  <input type="checkbox"/> Requires Review  <input type="checkbox"/> Approved  <input type="checkbox"/> Approved w/Conditions  <input type="checkbox"/> Denied  Date:	

## CERTIFICATION

I hereby certify that I am the owner of record of the named property, or that the proposed work is authorized by the owner of record and that I have been authorized by the owner to make this application as his authorized agent and I agree to conform to all applicable laws of this jurisdiction. In addition, if a permit for work described in the application is issued, I certify that the code official's authorized representative shall have the authority to enter all areas covered by such permit at any reasonable hour to enforce the provision of the code(s) applicable to such permit.

SIGNATURE OF APPLICANT	ADDRESS	DATE	PHONE
RESPONSIBLE PERSON IN CHARGE OF WORK, TITLE		DATE	PHONE



# General Building Permit Application

If you or the property owner owes real estate or personal property taxes or user charges on any property within the City, payment arrangements must be made before permits of any kind are accepted.

Total Square Footage of Proposed Structure <b>EXISTING</b>			Square Footage of Lot <b>EXISTING</b>		
Tax Assessor's Chart, Block & Lot Chart#      Block#      Lot# <b>32      I      a3</b>			Owner: <b>BOULAS PROPERTY MANAGEMENT.</b>		Telephone:
Lessee/Buyer's Name (If Applicable)			Applicant name, address & telephone: <b>R. P. MORRISON BUILDERS INC. 270 ROOSEVELT TRAIL WINDHAM ME. 04062</b>		Cost Of Work: \$ <b>2000. -</b> Fee: _____ C of O Fee: \$ <b>39.00</b>
Project description: <b>BUILD A 9' DIVIDING WALL AT THE RECEPTION AREA. REKEY DOOR LOCKS.</b>					
Contractor's name, address & telephone: <b>R. P. MORRISON BUILDERS INC 892-9418 270 ROOSEVELT TRAIL WINDHAM ME. 04062</b>					
Who should we contact when the permit is ready: <b>ROLAND MORRISON</b>					
Mailing address: _____ Phone: <b>207 - 892-9418</b>					

Please submit all of the information outlined in the Commercial Application Checklist.  
Failure to do so will result in the automatic denial of your permit.

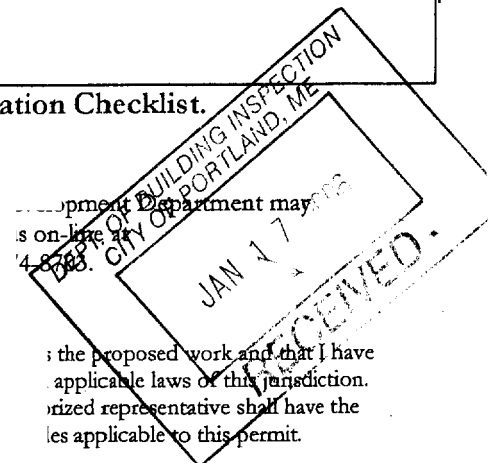

Signature of applicant: <b>[Signature]</b>	Date: <b>1-17-06</b>
--	----------------------

This is not a permit; you may not commence ANY work until the permit is issued.

3 5/8" STEEL STUDS

1/2" DRYWALL FINISH

3X6 8 SOLO CORE GROUT  
DOORS.

IN A STEEL FRAME

SAFETY GLASS WINDOWS  
WITH A THICKNESS.

SENATOR: SNAWES OFFICE  
HOME LAND SECURITY

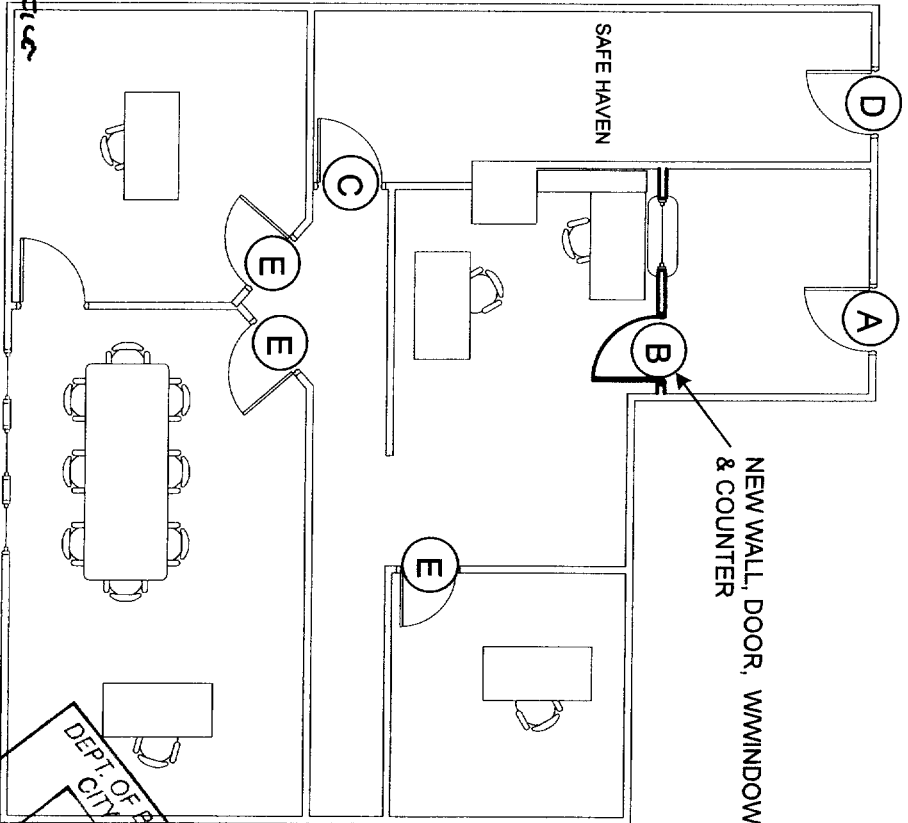

- (A) PRIMARY SUITE ENTRANCE
- (B) STAFF ENTRANCE
- (C) SAFE HAVEN DOOR
- (D) PERIMETER DOOR
- (E) INTERIOR DOOR
- (F) ALUMINUM FRAMED STORE FRONT
- (G) STAFF ENTRANCE GATE
- (H) HEAVY GLASS SUITE ENT.

SENATOR SNOWE

PORTLAND, MAINE

SIEMENS

Siemens Building Technologies, Inc.  
Security Systems Division  
201 Edison Park Drive  
Gaithersburg, MD 20878  
Tel: (301) 987-1200  
Fax: (301) 987-1227

**SIEMENS PROPRIETARY INFORMATION**  
The document contains proprietary information that has been developed by Siemens and is intended solely for the specific project named on this document. The information contained herein shall not be disclosed to any third party under any circumstance. No part of the document may be used, reproduced, stored in a retrieval system, or transmitted in any form or by any means, electronic, mechanical, photocopying or otherwise, without the prior written consent of Siemens.

REVISION:

no.	date	by	description
C	11/15/05	EJB	Added Alarm Zones
B	01/12/05	EJB	Moved IC to rear office
A	08/03/04	EJB	Added Security Signatures

drawn by ERIC B. checked by date 07/21/04  
approved by date

TITLE:

SENATOR SNOWE  
PORTLAND OFFICE  
GENERAL CONTRACTOR  
FLOOR PLAN

3 CANAL PLAZA  
SUITE 601

SCALE: 1/8" = 1'

DISCLOSURE SECURITY

DRAWING NO:

SHEET 1 OF 1