

REMOTE AREA-4 HEADS  
 CALC FILE: 4TH FLOOR AREA 4-6.WX6  
 Design Area No. WX6 - LIGHT HAZ  
 Density .10 Area 4 HEADS  
 Flow 210.9 gpm @ 74.6 psi  
 Includes 100 gpm Hose allowance

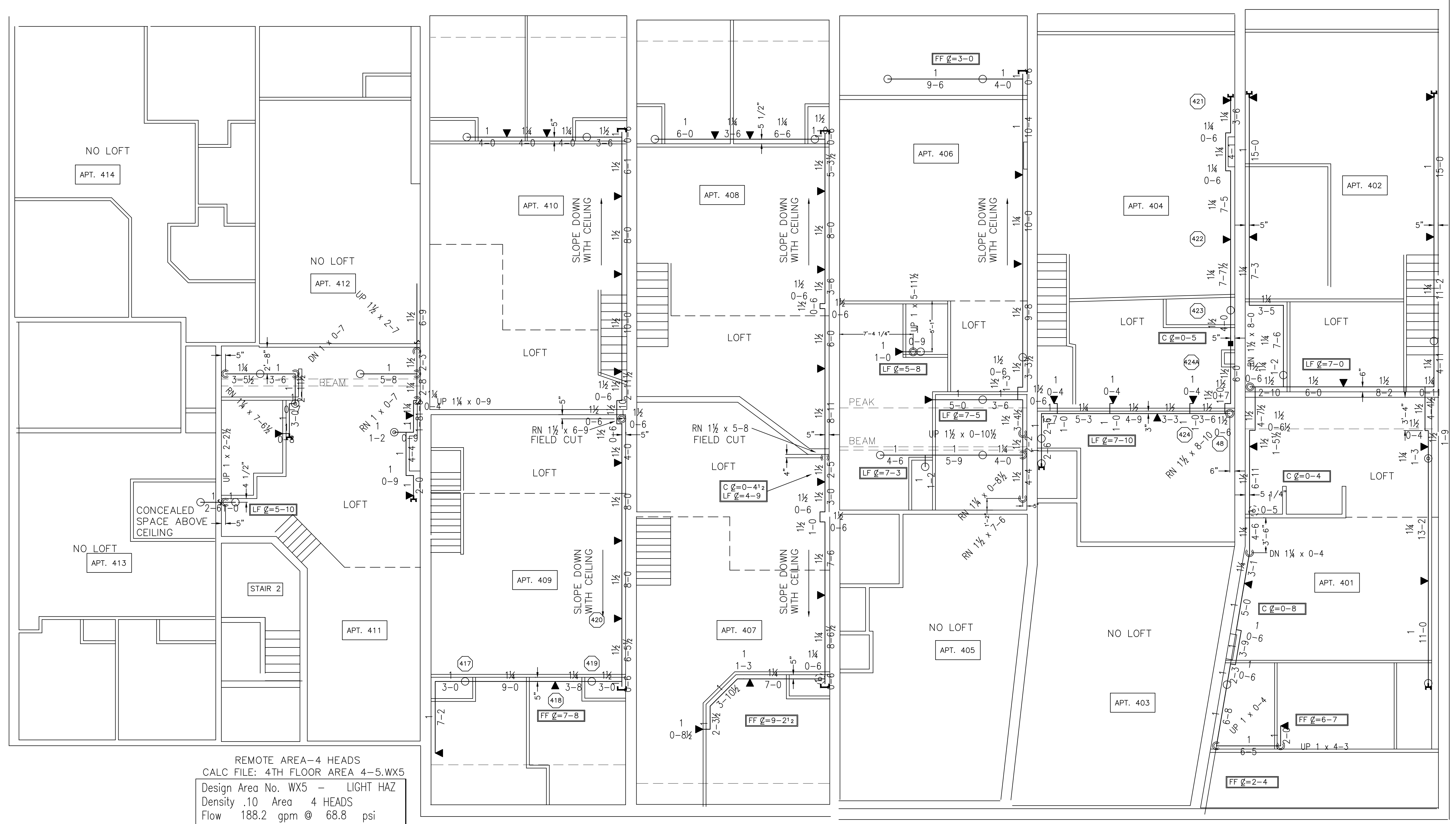
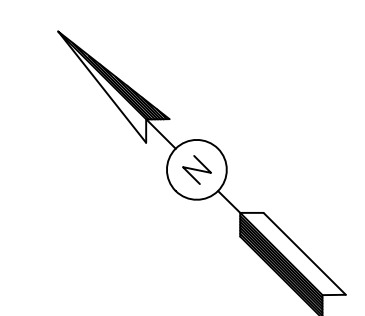

REMOTE AREA-4 HEADS  
 CALC FILE: 4TH FLOOR AREA 4-5.WX5  
 Design Area No. WX5 - LIGHT HAZ  
 Density .10 Area 4 HEADS  
 Flow 188.2 gpm @ 68.8 psi  
 Includes 100 gpm Hose allowance

4TH FLOOR LOFT LAYOUT  
 SCALE: 3/16"=1'-0"

NO PAINT MARK

**LEGEND:**

- ⊙ RECESSED PENDENT SPRINKLER ON A 1" DROP
- ⊗ CONCEALED SPACE SPRINKLER ON A BRANCHLINE
- ⊕ HEADS ABOVE AND BELOW CEILING
- ⊙ K=4.4 RESIDENTIAL HORIZONTAL SIDEWALL SPRINKLER
- ⊙ K=5.8 RESIDENTIAL HORIZONTAL SIDEWALL SPRINKLER
- RESIDENTIAL UPRIGHT SPRINKLER ON A BRANCH LINE
- ⊙ CONCEALED SPACE SPRINKLER ON A 1" SPRIG
- ↑ RISE OR DROP
- GROOVED RIGID COUPLING
- GROOVED FLEXIBLE COUPLING
- ⊙ HYDRAULIC REFERENCE POINT
- ⊙ CEILING HEIGHT
- HANGER
- FF g= X'-X" FINISHED FLOOR TO PIPE CENTERLINE
- LF g= X'-X" LOFT FLOOR TO PIPE CENTERLINE
- C g= X'-X" CEILING TO PIPE CENTERLINE
- FHV FIRE HOSE VALVE

**GENERAL NOTES:**

ALL 1" TO 2" PIPE IS TO BE SCH. 40 BLACK STEEL U/N.  
 ALL 2 1/2" TO 6" PIPE IS TO BE SCH. 10 BLACK STEEL U/N.  
 ALL THREADED PIPE FITTINGS ARE TO BE BLACK CAST IRON, CLASS 125 U/N.  
 DIMENSIONS SHOWN ON THREADED PIPE ARE CENTER TO CENTER U/N.  
 DIMENSIONS SHOWN ON GROOVED PIPE ARE "CUT" LENGTHS U/N.  
 SUFFICIENT HEAT TO PREVENT FREEZING OF THE WET PIPE SPRINKLER SYSTEM IS REQUIRED TO BE FURNISHED BY THE BUYER/OWNER.

**SYSTEM CLASSIFICATION:**

THE WET PIPE SYSTEM OF AUTOMATIC SPRINKLERS IS DESIGNED IN ACCORDANCE WITH NFPA-13, STANDARD FOR THE INSTALLATION OF SPRINKLER SYSTEMS, 2016 EDITION. OCCUPANCY IS RESIDENTIAL APARTMENTS-LIGHT HAZARD. THE SYSTEM IS HYDRAULICALLY CALCULATED TO PROVIDE A DENSITY OF 0.10 GPM PER SQUARE FOOT FOR THE MOST DEMANDING FOUR SPRINKLERS PER PARA. 11.3.1.1, WITH A HOSE ALLOWANCE OF 100 GPM.

THE STANDPIPE SYSTEM IS DESIGNED IN ACCORDANCE WITH NFPA-14, STANDARD FOR THE INSTALLATION OF STANDPIPE AND HOSE SYSTEMS, 2016 EDITION AND THE CITY OF PORTLAND FIRE DEPARTMENT RULES AND REGULATIONS. THE STANDPIPE SYSTEM IS A CLASS I MANUAL-WET SYSTEM THAT IS CONNECTED TO THE CITY WATER SUPPLY BUT REQUIRES WATER FROM A FIRE DEPARTMENT PUMPER TO BE PUMPED INTO THE FIRE DEPARTMENT CONNECTION TO SUPPLY THE SYSTEM DEMAND. THE SYSTEM IS HYDRAULICALLY CALCULATED TO PROVIDE 65 PSI AT THE TOPMOST HOSE STATION WITH A SUPPLY OF 750 GPM AT 150 PSI AT THE FIRE DEPARTMENT CONNECTION.

**SCOPE OF WORK:**

DESIGN AND INSTALL A COMBINED STANDPIPE AND WET PIPE SPRINKLER SYSTEM ON THE THIRD AND FOURTH FLOORS OF 10 EXCHANGE STREET.  
 THE BASEMENT, FIRST AND SECOND FLOORS OF THIS BUILDING ARE PROTECTED BY AN EXISTING WET PIPE SPRINKLER SYSTEM.

FIRE PROTECTION SUBCONTRACTOR: DEAN & ALLYN, INC.  
 STATE OF MAINE CONTRACTOR'S LICENSE NUMBER 262  
 EXPIRATION DATE: JUNE 30, 2017

WORKING DRAWINGS PREPARED BY:  
 THEODORE E. CLARKE  
 NICET LEVEL IV  
 CERTIFICATION #71654  
 STATE OF MAINE RMS LICENSE NUMBER 208  
 EXPIRATION DATE: JUNE 30, 2017

**DEAN & ALLYN, INC.**  
 FIRE PROTECTION - SPECIAL HAZARD  
 116 LEWISTON ROAD, GRAY, MAINE 04039  
 (207)657-5646 FAX:(207)657-5647

42 RELIABLE MODEL F1 RES 58 HSW RESIDENTIAL HORIZONTAL SIDEWALL, WHITE K=5.8, 1/2" NPT, SIN RA3533

2 RELIABLE MODEL F1 RES 49 RESIDENTIAL RECESSED PENDENT W/WHITE F1 ESCUTCHEON K=4.9, 1/2" NPT, SIN RA3516

28 VIKING VK467 FREEDOM RESIDENTIAL UPRIGHT WHITE K=4.9, 1/2" NPT, SIN VK467

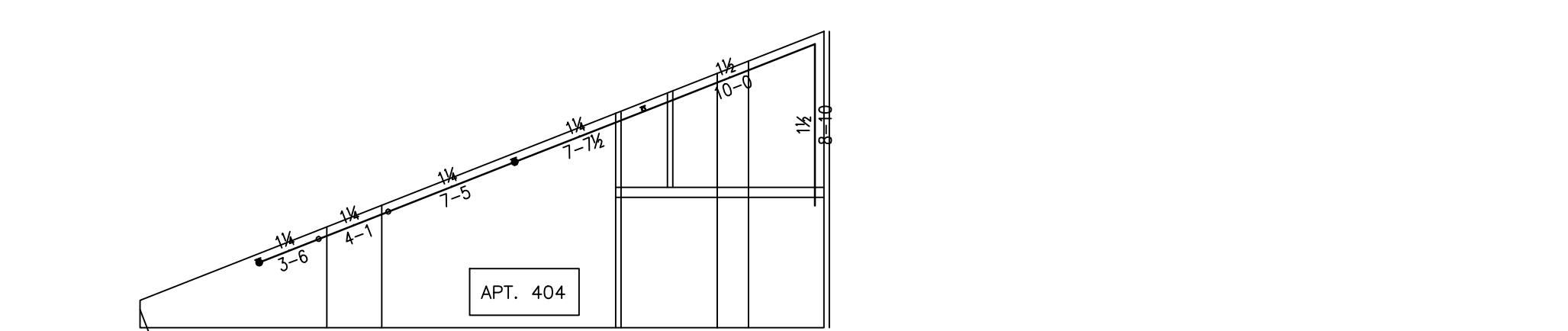
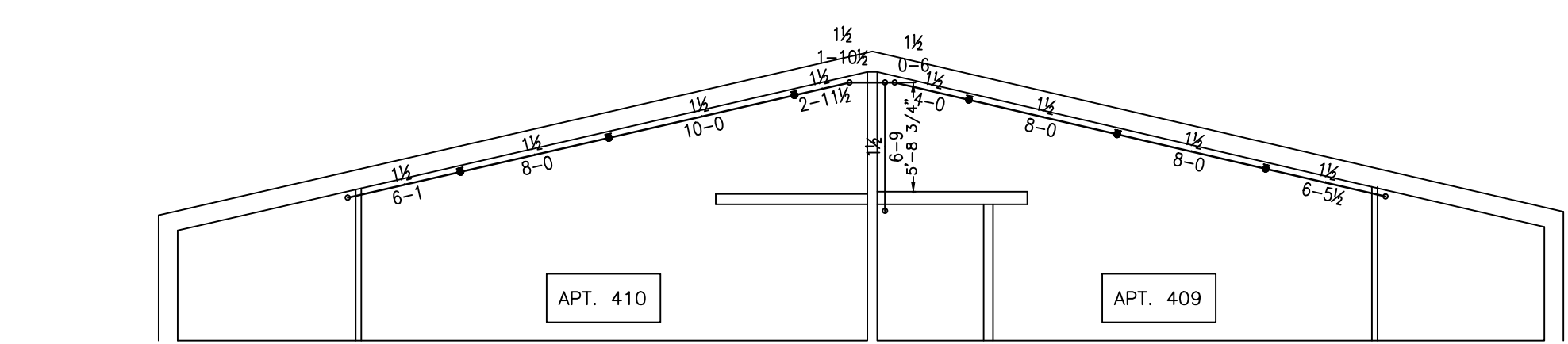
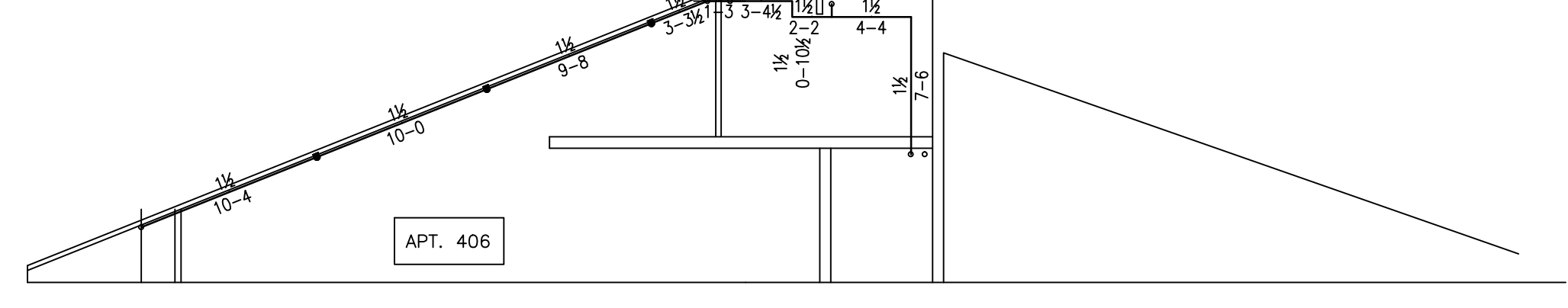
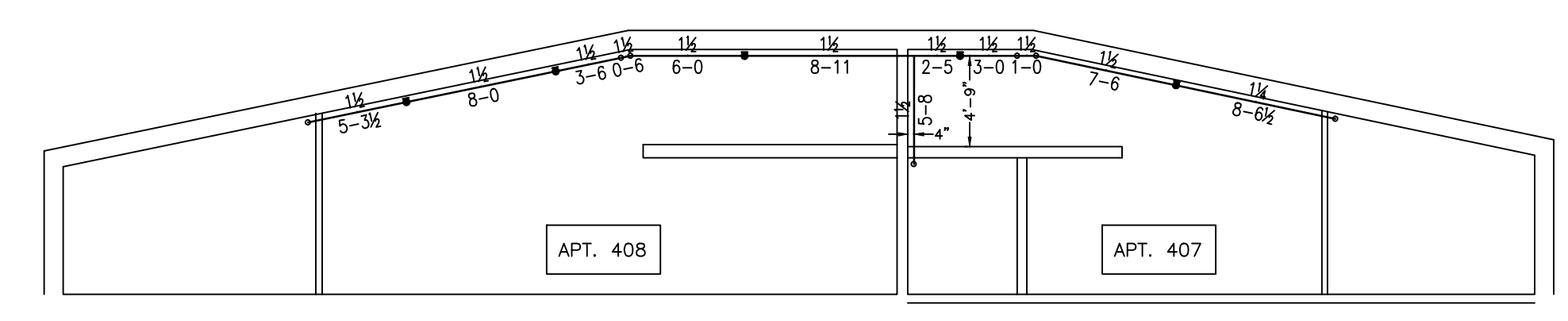
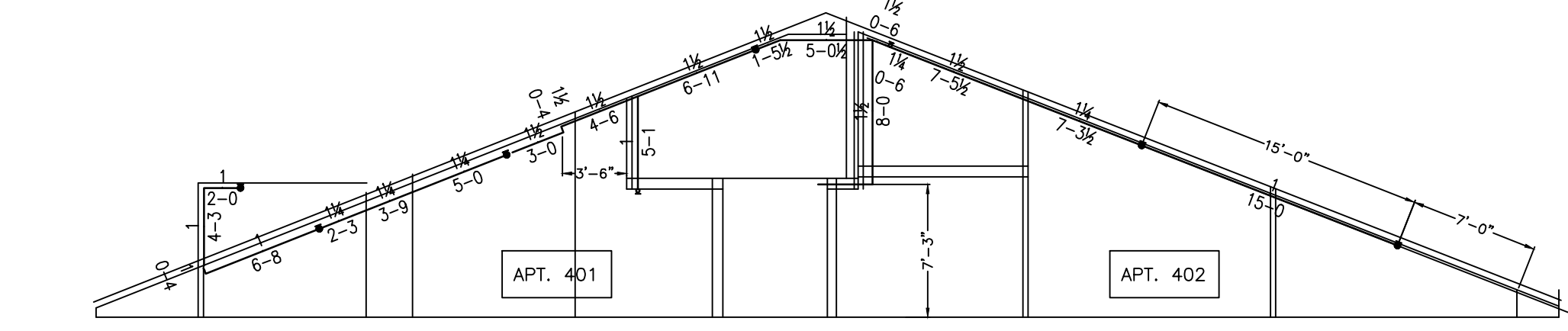
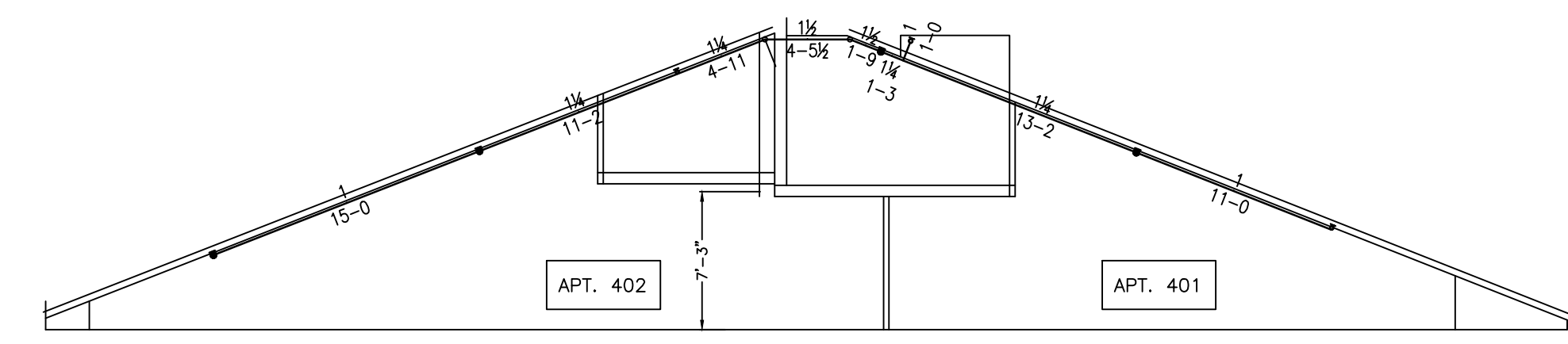

1 1/2"	1"	3/4"	1/2"	3/8"	1/4"	3/16"	1/8"	1/16"	1/32"	1/64"
SCALE 3/32"=1'-0"	SCALE 1/8"=1'-0"	SCALE 3/16"=1'-0"	SCALE 1/4"=1'-0"	SCALE 1/2"=1'-0"						
APPROVED BY		DATE	SURVEYED BY		TEC	6/15/16	DRAWING TITLE:		FOURTH FLOOR LOFT LAYOUT	
//		//	DANA A. STEWART		TEC	6/20/16	JOB:		10 EXCHANGE STREET	
//		//	NICET IV - #064544		TEC		NO. OF SPRINKLERS SHOWN ON THIS SHEET:		72	
//		//			DAS		NO. OF SPRINKLERS NOT SHOWN:		308	
//		//			AT DEAN & ALLYN, INC		CONTRACT NO.:		C161341	
//		//			SCALE 3/16"=1'-0" U/N		CONTRACT WITH:		10 EXCHANGE STREET LLC.	
//		//			SHEET NO. FP-102		865 SPRING STREET, WESTBROOK, MAINE 04092			