

Prepared For:

Consultant:

Architect:
ARCHETYPE
architects
 48 Union Wharf Portland, Maine 04101
 (207) 772-6022 ARCHETYPE@ARCHETYPEPA.COM

Project:
MARK'S SPORTS BAR
8 EXCHANGE STREET
 PORTLAND, MAINE

Revisions:
 2 23 APR 2018
 REVISED - LOWER LEVEL

Date:
 22 NOV 2017
 Scale: As indicated
LOWER LEVEL NEW
WORK PLAN

A1.00

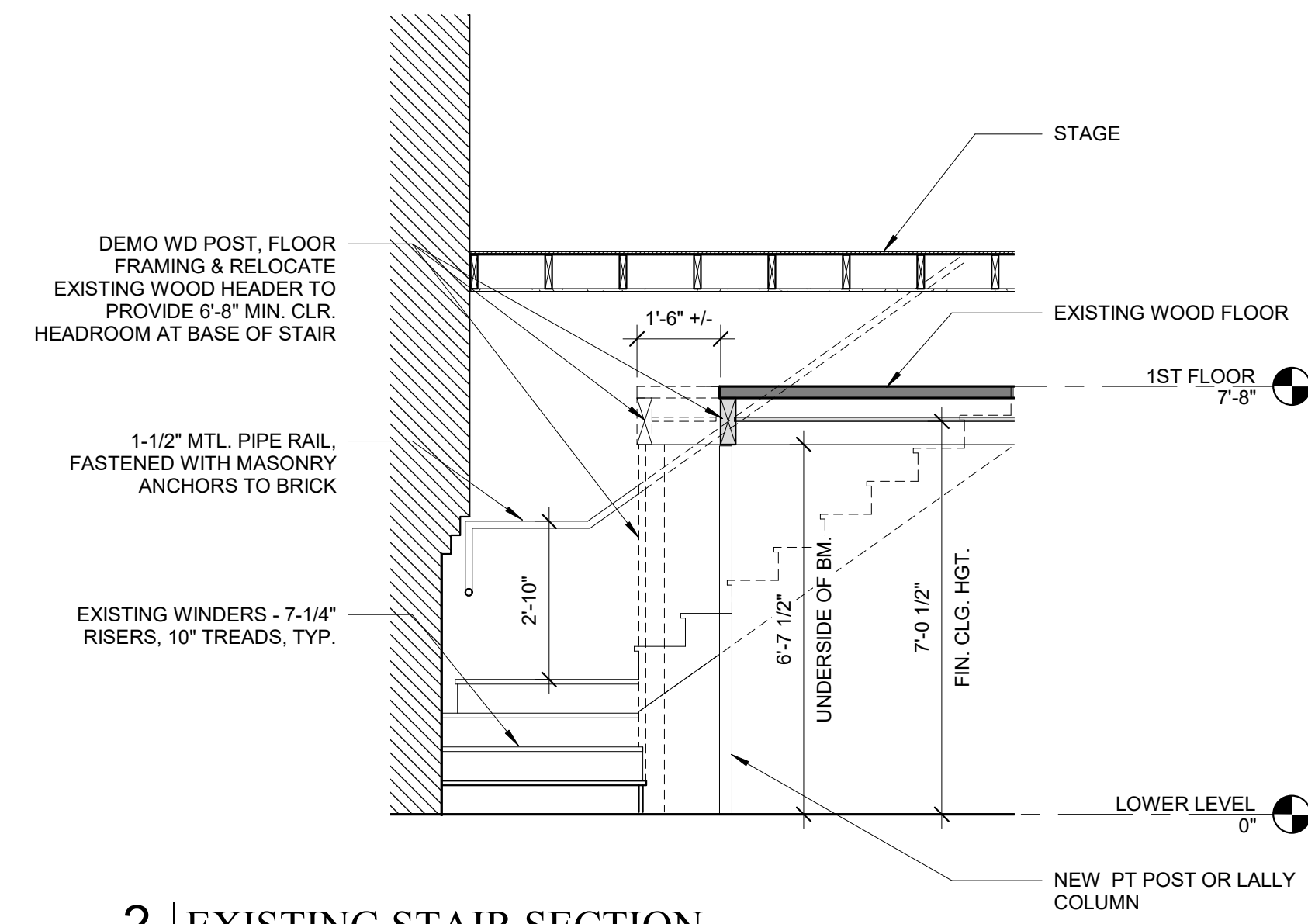

2 | EXISTING STAIR SECTION
 3/8" = 1'-0"

RELEVANT CODES
 INTERNATIONAL EXISTING BUILDING CODE 2009
 IBC 2009
 NFPA 101 2009

PRIOR USE OF LOWER LEVEL WAS GROUP B, BUSINESS.
 NEW USE IS GROUP S-2, STORAGE.

NONSEPARATED OCCUPANCY
 LOWER LEVEL AND FIRST FLOOR NOT REQUIRED TO BE SEPARATED PER IBC 2015 TABLE 508.4 BETWEEN ASSEMBLY AND S-2 OCCUPANCIES WITHIN A SPRINKLERED BUILDING.

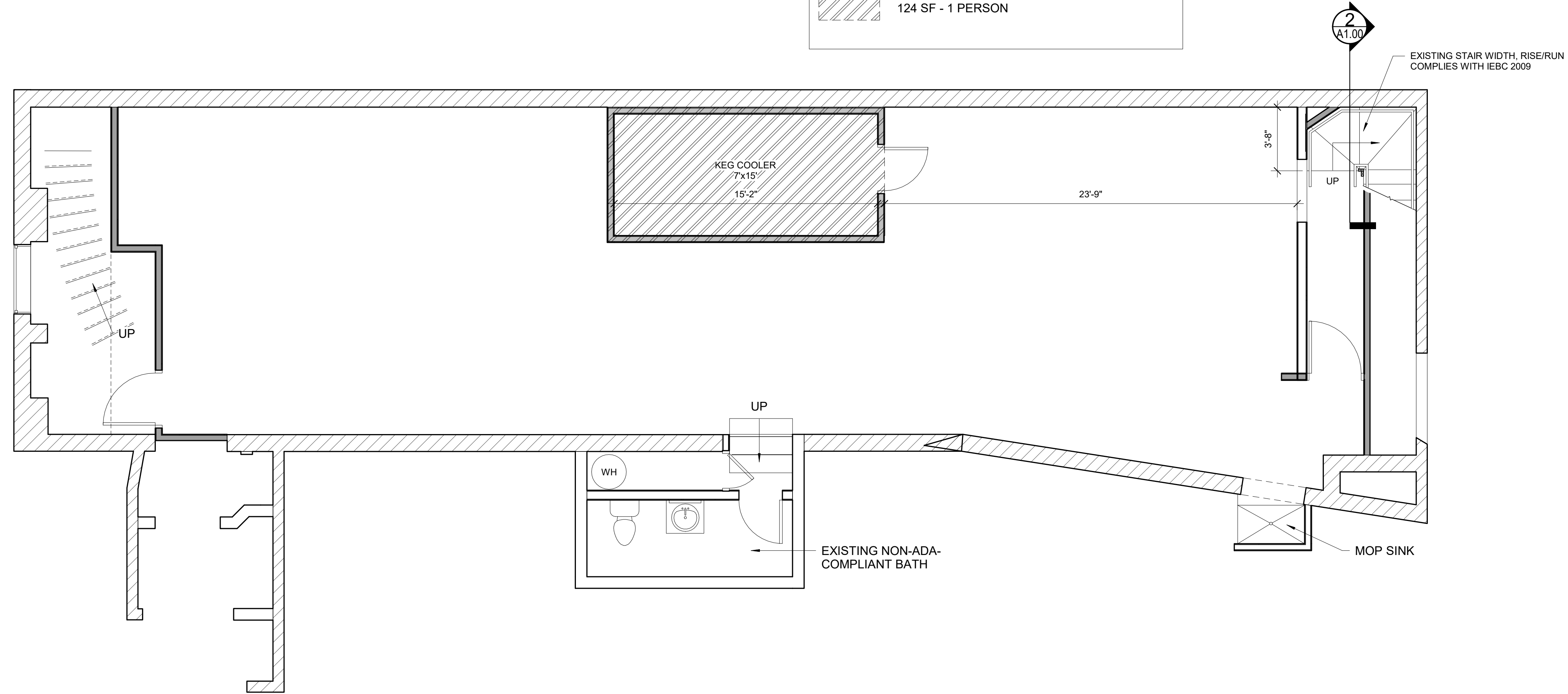
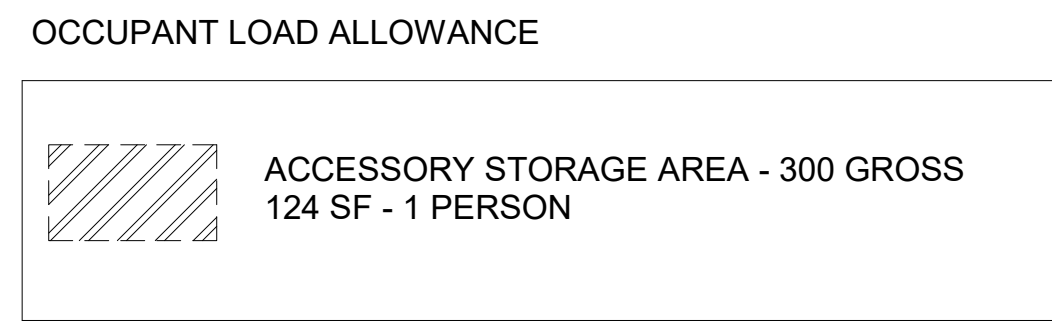

1 | LOWER LEVEL NEW
 1/4" = 1'-0"