

NEW WALL - STUD & GYP. BD.	
EXISTING CMU WALL	
EXISTING STUD WALL OR FLOOR	
EXISTING MASONRY WALL	
DEMO AND REMOVE	
EXISTING DOOR	
NEW DOOR	

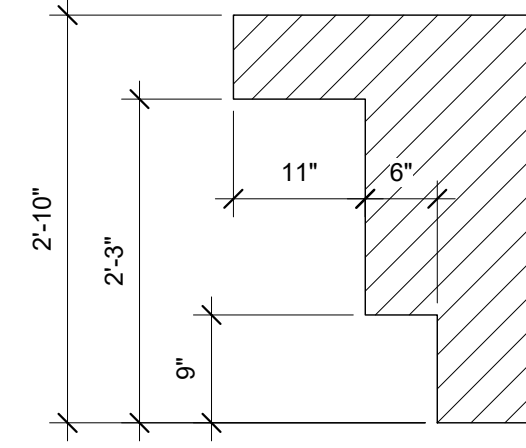

**3** ADA BAR TOP DIMENSIONS  
3/4" = 1'-0"

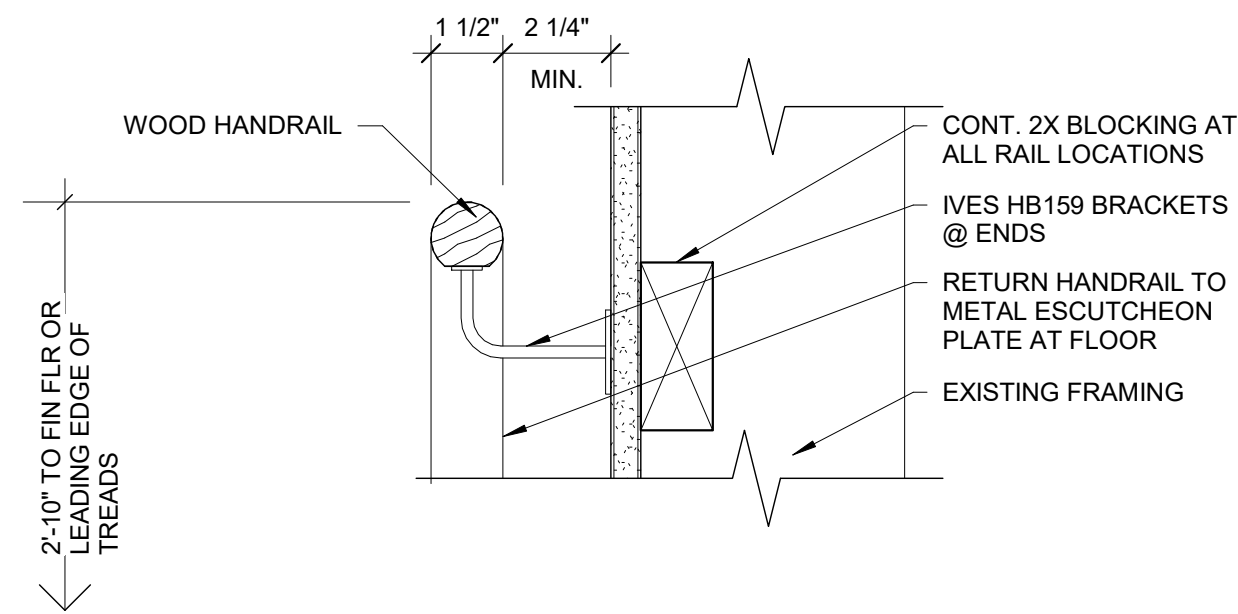

**5** STAIR - WOOD HANDRAIL DETAIL  
3" = 1'-0"

IT SHALL BE NOTED THAT A HANDRAIL IS NOT REQUIRED PER ADA 405.8 WHICH STATES THAT HANDRAILS ARE ONLY REQUIRED AT RAMP WITH RISES GREATER THAN 6 INCHES. 405.9 EXCEPTION 1 FURTHER STATES THAT EDGE PROTECTION IS NOT REQUIRED AT RAMP THAT ARE NOT REQUIRED TO HAVE HANDRAILS AND HAVE SIDES COMPLYING WITH ICC A117.1 406.3

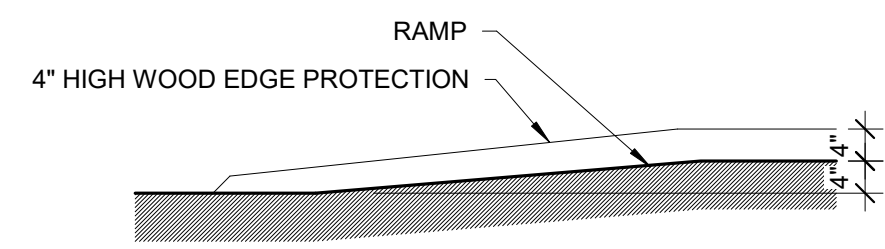

**4** TYP. LOW RISE RAMP  
1/2" = 1'-0"

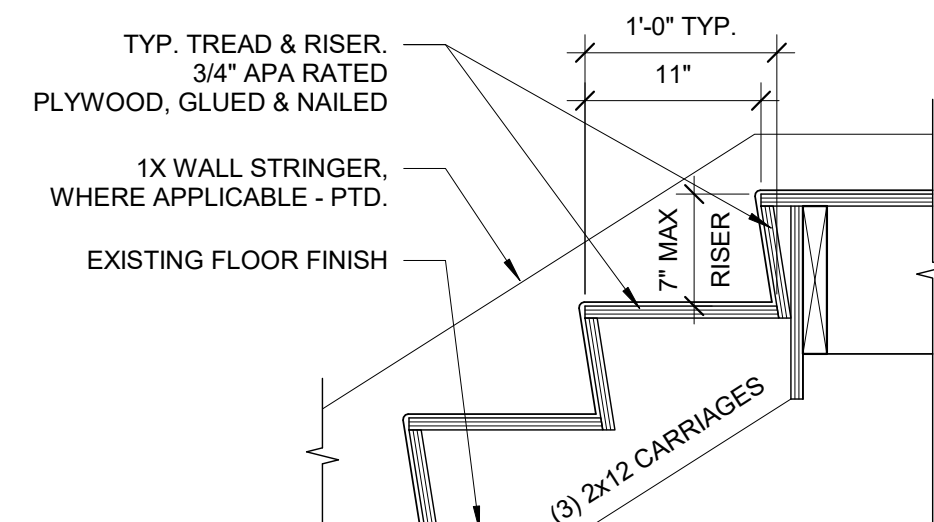

**1** TYP. STAIR DETAIL  
1" = 1'-0"

# EXCHANGE STREET

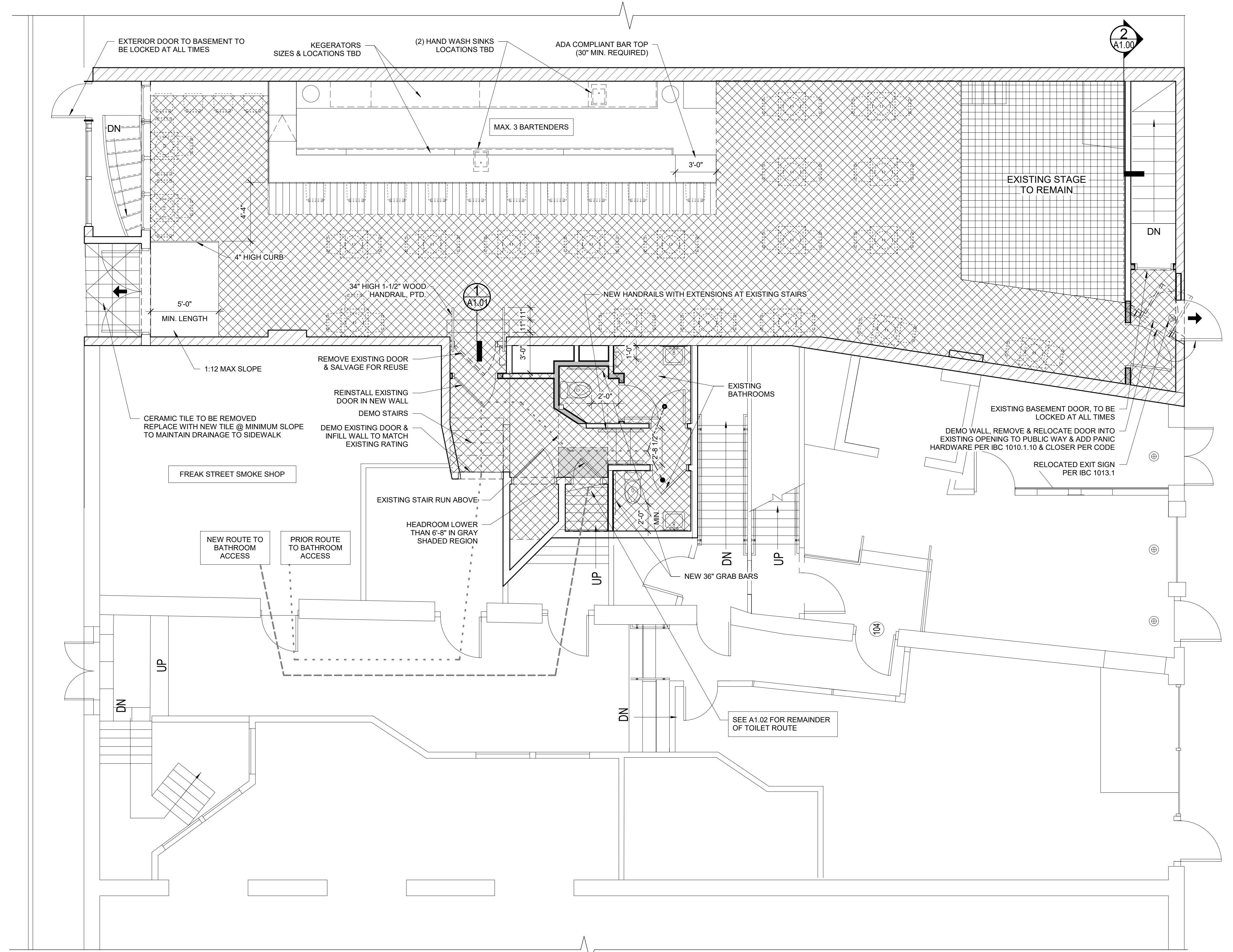

**2** 1ST FLOOR - NEW WORK PLAN  
1/4" = 1'-0"

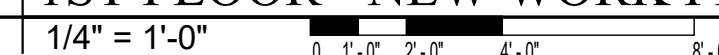

**OCCUPANT LOAD ALLOWANCES**

	OCCUPANT LOAD AT BAR SEATING - 1 SEAT/2 FEET OF BAR 33 LF - 16 PERSONS + 3 BARTENDERS - 19 PERSONS
	ASSEMBLY WITHOUT FIXED SEATS (UNCONCENTRATED) - 15 NET 1035 SF - 69 PERSONS
	STAGES & PLATFORMS - 15 NET 187 SF - 12 PERSONS

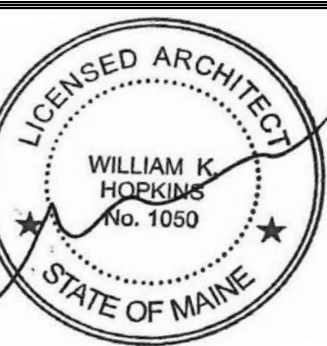

Prepared For:

Consultant:

**ARCHETYPE**  
architects  
48 Union Wharf Portland, Maine 04101  
(207) 772-6022 ARCHETYPE@ARCHETYPEPA.COM

Project:  
**MARK'S SPORTS BAR**  
**8 EXCHANGE STREET**  
PORTLAND, MAINE

Revisions:  
1 7 MAR 2018 | PLAN REVIEW  
3 9 MAY 2018 | PLAN REVIEW

Date:  
7 MAY 2018  
Scale:  
As indicated  
**FLOOR PLANS, LIFE SAFETY & DETAILS**

**A1.01**