

City of Portland, Maine - Building or Use Permit Application
 389 Congress Street, 04101 Tel: (207) 874-8703, Fax: (207) 874-8716

PERMIT ISSUED		CBL:
Permit No: 02-0728	Issue Date: JUL 11 2002	032 I012001

Location of Construction: 10 Exchange St	Owner Name: Soley Joseph L	Owner Address: Po Box 4894	Phone:
Business Name:	Contractor Name: D. Cole Jewelers	Contractor Address: 10 Exchange Street Portland	Phone: 2077725119
Lessee/Buyer's Name	Phone:	Permit Type: Signs - Permanent	Zone: B3

Past Use: Retail Jewelry Store	Proposed Use: Retail Jewelry Store	Permit Fee: \$38.00	Cost of Work: \$38.00	CEO District: 1
		FIRE DEPT: <input type="checkbox"/> Approved <input type="checkbox"/> Denied <i>N/A</i>	INSPECTION: Use Group: U Type: Sign BOCA 99	

Proposed Project Description: Erect a 2' x 4' Sidewalk Board Sign	Signature: <i>[Signature]</i>	Signature: <i>[Signature]</i>
PEDESTRIAN ACTIVITIES DISTRICT (P.A.D.)		
Action: <input type="checkbox"/> Approved <input type="checkbox"/> Approved w/Conditions <input type="checkbox"/> Denied		
Signature:		Date:

Permit Taken By: gad	Date Applied For: 07/01/2002	Zoning Approval
--------------------------------	--	------------------------

1. This permit application does not preclude the Applicant(s) from meeting applicable State and Federal Rules. 2. Building permits do not include plumbing, septic or electrical work. 3. Building permits are void if work is not started within six (6) months of the date of issuance. False information may invalidate a building permit and stop all work..	Special Zone or Reviews <input type="checkbox"/> Shoreland <input type="checkbox"/> Wetland <input type="checkbox"/> Flood Zone <input type="checkbox"/> Subdivision <input type="checkbox"/> Site Plan Maj <input type="checkbox"/> Minor <input type="checkbox"/> MIV <input type="checkbox"/> Date: <i>OK 7/19/02</i>	Zoning Appeal <input type="checkbox"/> Variance <input type="checkbox"/> Miscellaneous <input type="checkbox"/> Conditional Use <input type="checkbox"/> Interpretation <input type="checkbox"/> Approved <input type="checkbox"/> Denied Date:	Historic Preservation <input type="checkbox"/> Not in District or Landmark <input type="checkbox"/> Does Not Require Review <input type="checkbox"/> Requires Review <input type="checkbox"/> Approved <input type="checkbox"/> Approved w/Conditions <input type="checkbox"/> Denied Date:
	<i>NOT A Zoning Issue</i>		

CERTIFICATION

I hereby certify that I am the owner of record of the named property, or that the proposed work is authorized by the owner of record and that I have been authorized by the owner to make this application as his authorized agent and I agree to conform to all applicable laws of this jurisdiction. In addition, if a permit for work described in the application is issued, I certify that the code official's authorized representative shall have the authority to enter all areas covered by such permit at any reasonable hour to enforce the provision of the code(s) applicable to such permit.

SIGNATURE OF APPLICANT	ADDRESS	DATE	PHONE
RESPONSIBLE PERSON IN CHARGE OF WORK, TITLE		DATE	PHONE

DISPLAY THIS CARD ON PRINCIPAL FRONTAGE OF WORK
CITY OF PORTLAND

Please Read
Application And
Notes, If Any,
Attached

BUILDING DEPARTMENT

PERMIT

Permit Number: 020728

This is to certify that Soley Joseph L/D. Cole Jewels

has permission to Erect a 2' x 4' Sidewalk Board Sign

AT 10 Exchange St 032 I012001

provided that the person or persons, firm or corporation accepting this permit shall comply with all of the provisions of the Statutes of Maine and of the Ordinances of the City of Portland regulating the construction, maintenance and use of buildings and structures, and of the application on file in this department.

Apply to Public Works for street line

Notification of inspection must
be given and written permission procured
before this building or part thereof
is altered or closed-in.
48 HOUR NOTICE IS REQUIRED.

A certificate of occupancy must be
procured by owner before this building
or part thereof is occupied.

PERMIT

CITY OF PORTLAND, MAINE
PORTABLE SIDEWALK SIGN

_____ EXPIRES _____

Director - Building & Inspection Services

VALTY FOR REMOVING THIS CARD

THIS IS NOT A PERMIT/CONSTRUCTION MAY NOT COMMENCE UNTIL THE PERMIT IS ISSUED

02-0728

Signage Application

If you or the property owner owes real estate or personal property taxes or user charges on any property within the City, payment arrangements must be made before permits of any kind are accepted.

Location/Address of Construction: <u>10 exchange street</u>		
Total Square Footage of Proposed Structure	Square Footage of Lot	
Tax Assessor's Chart, Block & Lot Chart# <u>032</u> Block# <u>I</u> Lot# <u>012</u>	Owner:	Telephone: <u>772-5119</u>
Lessee/Buyer's Name (If Applicable)	Applicant name, address & telephone: <u>d. cole jewelers</u> <u>10 exchange st. ptld. 04101</u> <u>772-5119</u>	Total s.f. of signage <u>8</u> x 1.00 per s.f. \$ <u>8.00</u> , plus \$30.00 base fee Fee: \$ <u>38.00</u>
Current use: <u>retail jewelry store</u>		
If the location is currently vacant, what was prior use: <u>—</u>		
Approximately how long has it been vacant: <u>—</u>		
Proposed use: <u>same</u>		
Project description: <u>2' x 4' sandwich board sign</u>		
Contractor's name, address & telephone:		
Who should we contact when the permit is ready: <u>Dean O. Cole</u>		
Mailing address: <u>10 exchange st 04101 892-5248</u>		
We will contact you by phone when the permit is ready. You must come in and pick up the permit and review the requirements before starting any work, with a Plan Reviewer. A stop work order will be issued and a \$50.00 fee if any work starts before the permit is picked up. Phone:		

may be marked

IF THE REQUIRED INFORMATION IS NOT INCLUDED IN THE SUBMISSIONS THE PERMIT WILL BE DENIED AT THE DISCRETION OF THE BUILDING/PLANNING DEPARTMENT, WE MAY REQUIRE ADDITIONAL INFORMATION IN ORDER TO APPROVE THIS PERMIT.

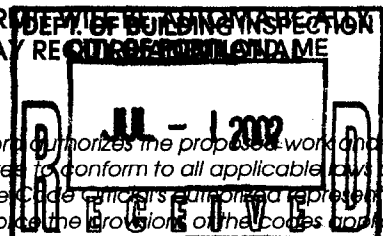

I hereby certify that I am the Owner of record of the named property, or that the owner of record has authorized the proposed work and that I have been authorized by the owner to make this application as his/her authorized agent. I agree to conform to all applicable laws of this jurisdiction. In addition, if a permit for work described in this application is issued, I certify that the Code Enforcers authorized representative shall have the authority to enter all areas covered by this permit at any reasonable hour to enforce the provisions of the codes applicable to this permit.

Signature of applicant: <u>Dean O. Cole</u>	Date: <u>July 1 2002</u>
---	--------------------------

This is NOT a permit, you may not commence ANY work until the permit is issued. If you are in a Historic District you may be subject to additional permitting and fees with the Planning Department on the 4th floor of City Hall

Room 315
8-4

SIGNAGE PRE-APPLICATION

PLEASE ANSWER ALL QUESTIONS

ADDRESS: 10 exchange street ZONE: B-3
OWNER: Dean Cole
APPLICANT: d. cole jewelers
ASSESSOR NO. _____

PLEASE CIRCLE APPROPRIATE ANSWER

SINGLE TENANT LOT? YES NO MULTI-TENANT LOT? YES NO
FREESTANDING SIGN? (ex. Pole Sign) YES NO --- DIMENSIONS 2' HEIGHT 4'
MORE THAN ONE SIGN? YES NO DIMENSIONS _____ HEIGHT _____
SIGN ATTACHED TO BLDG.? YES NO DIMENSIONS _____
MORE THAN ONE SIGN? YES NO DIMENSIONS _____
AWNING: YES NO IS AWNING BACKLIT? YES NO HEIGHT OFF SIDEWALK N/A
IS THERE ANY MESSAGE, TRADEMARK OR SYMBOL ON IT? yes

LIST ALL EXISTING SIGNAGE AND THEIR DIMENSIONS:

*** TENANT BLDG. FRONTAGE (IN FEET): 20'
*** REQUIRED INFORMATION

AREA FOR COMPUTATION

YOU SHALL PROVIDE:
A SITE SKETCH AND BUILDING SKETCH SHOWING EXACTLY WHERE EXISTING AND NEW SIGNAGE IS LOCATED MUST BE PROVIDED. SKETCHES AND/OR PICTURES OF PROPOSED ARE ALSO REQUIRED.

SIGNATURE OF APPLICANT: Dean Cole DATE: 6-5-02

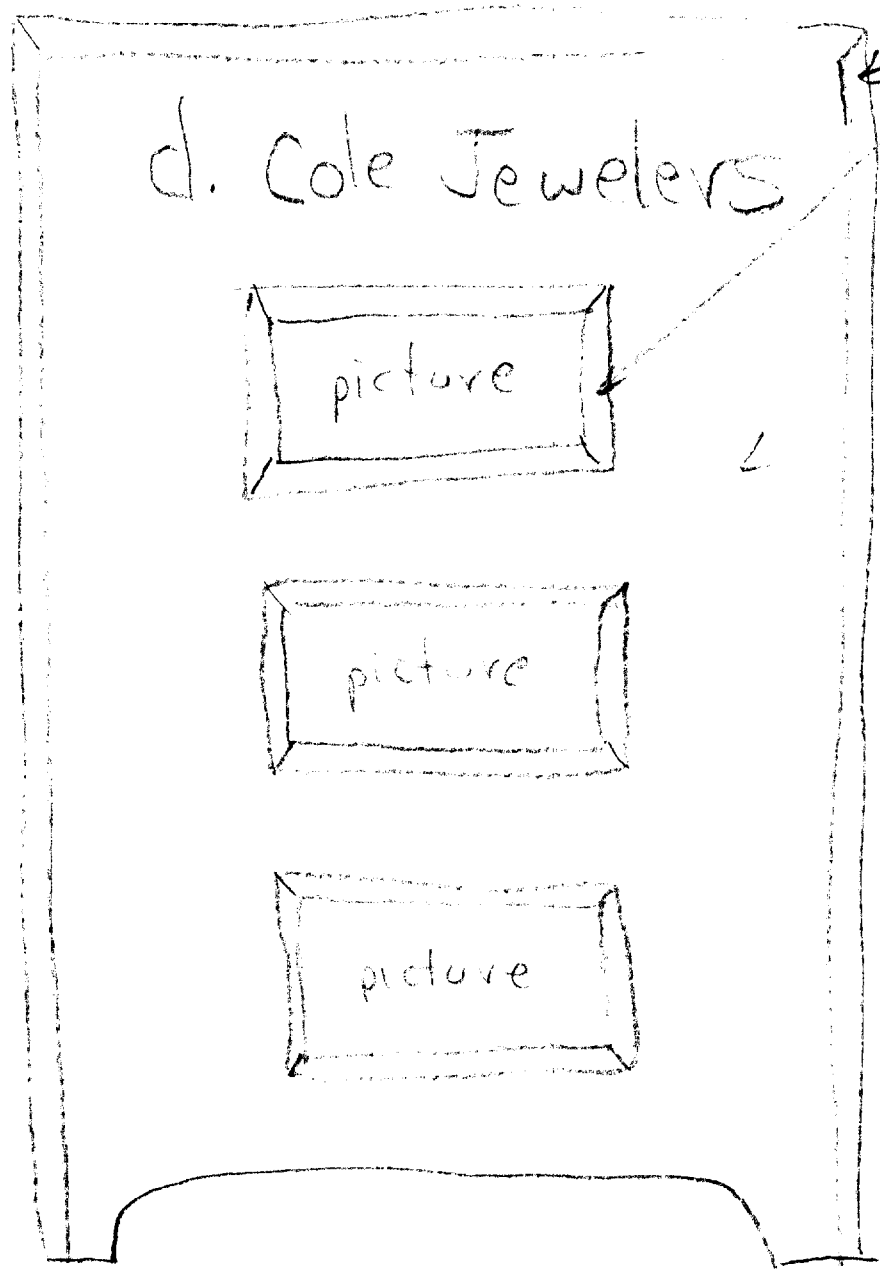

d. Cole Jewelers

picture

picture

picture

Mahogany

Painted
Brick
Red

ACORD CERTIFICATE OF LIABILITY INSURANCE

DATE (MM/DD/YY)
04/25/2002

PRODUCER (207)774-6257 FAX (207)774-2994
Clark Associates
2331 Congress Street
P O Box 3543
Portland, ME 04104

THIS CERTIFICATE IS ISSUED AS A MATTER OF INFORMATION ONLY AND CONFERS NO RIGHTS UPON THE CERTIFICATE HOLDER. THIS CERTIFICATE DOES NOT AMEND, EXTEND OR ALTER THE COVERAGE AFFORDED BY THE POLICIES BELOW.

INSURERS AFFORDING COVERAGE

INSURED **D Cole Jewelers**
Dean & Denise Cole
10 Exchange St
Portland, ME 04101

INSURER A: **Commercial Union Ins Co**
INSURER B:
INSURER C:
INSURER D:
INSURER E:

COVERAGES

THE POLICIES OF INSURANCE LISTED BELOW HAVE BEEN ISSUED TO THE INSURED NAMED ABOVE FOR THE POLICY PERIOD INDICATED. NOTWITHSTANDING ANY REQUIREMENT, TERM OR CONDITION OF ANY CONTRACT OR OTHER DOCUMENT WITH RESPECT TO WHICH THIS CERTIFICATE MAY BE ISSUED OR MAY PERTAIN, THE INSURANCE AFFORDED BY THE POLICIES DESCRIBED HEREIN IS SUBJECT TO ALL THE TERMS, EXCLUSIONS AND CONDITIONS OF SUCH POLICIES. AGGREGATE LIMITS SHOWN MAY HAVE BEEN REDUCED BY PAID CLAIMS.

INSUR LTR	TYPE OF INSURANCE	POLICY NUMBER	POLICY EFFECTIVE DATE (MM/DD/YY)	POLICY EXPIRATION DATE (MM/DD/YY)	LIMITS
A	GENERAL LIABILITY	YMLM14021 0	01/01/2002	01/01/2003	EACH OCCURRENCE \$ 1,000,000
	<input checked="" type="checkbox"/> COMMERCIAL GENERAL LIABILITY				FIRE DAMAGE (Any one fire) \$ 100,000
	<input type="checkbox"/> CLAIMS MADE <input checked="" type="checkbox"/> OCCUR				MED EXP (Any one person) \$ 5,000
					PERSONAL & ADV INJURY \$ 1,000,000
					GENERAL AGGREGATE \$ 2,000,000
					PRODUCTS - COMP/OP AGG \$ 2,000,000
	GEN'L AGGREGATE LIMIT APPLIES PER <input type="checkbox"/> POLICY <input type="checkbox"/> PRG-JECT <input type="checkbox"/> LOC				
	AUTOMOBILE LIABILITY				COMBINED SINGLE LIMIT (Per accident) \$
	<input type="checkbox"/> ANY AUTO				BODILY INJURY (Per person) \$
	<input type="checkbox"/> ALL OWNED AUTOS				BODILY INJURY (Per accident) \$
	<input type="checkbox"/> SCHEDULED AUTOS				PROPERTY DAMAGE (Per accident) \$
	<input type="checkbox"/> H-RED AUTOS				
	<input type="checkbox"/> NON-OWNED AUTOS				
	GARAGE LIABILITY				AUTO ONLY - EA ACCIDENT \$
	<input type="checkbox"/> ANY AUTO				OTHER THAN AUTO ONLY: EA ACC \$
					AGG \$
	EXCESS LIABILITY				EACH OCCURRENCE \$
	<input type="checkbox"/> OCCUR <input type="checkbox"/> CLAIMS MADE				AGGREGATE \$
	<input type="checkbox"/> DEDUCTIBLE				\$
	<input type="checkbox"/> RETENTION \$				\$
	WORKERS COMPENSATION AND EMPLOYERS' LIABILITY				WC STATUTORY LIMITS <input type="checkbox"/> OTHER \$
					E.L. EACH ACCIDENT \$
					E.L. DISEASE - EA EMPLOYEE \$
					E.L. DISEASE - POLICY LIMIT \$
	OTHER				

DESCRIPTION OF OPERATIONS/LOCATIONS/VEHICLES/EXCLUSIONS ADDED BY ENDORSEMENT/SPECIAL PROVISIONS
Sign

CERTIFICATE HOLDER

ADDITIONAL INSURED; INSURER LETTER:

CANCELLATION

City of Portland
389 Congress Street
Portland, ME 04101

SHOULD ANY OF THE ABOVE DESCRIBED POLICIES BE CANCELLED BEFORE THE EXPIRATION DATE THEREOF, THE ISSUING COMPANY WILL ENDEAVOR TO MAIL 10 DAYS WRITTEN NOTICE TO THE CERTIFICATE HOLDER NAMED TO THE LEFT, BUT FAILURE TO MAIL SUCH NOTICE SHALL IMPOSE NO OBLIGATION OR LIABILITY OF ANY KIND UPON THE COMPANY, ITS AGENTS OR REPRESENTATIVES.

AUTHORIZED REPRESENTATIVE

Dale Hudson/DRS

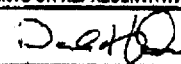

6/14/02

To whom it may concern,

D. Cole has permission from
landlord Joe Soley - Monopoly Ave.
to use any and all storage
for store front display

Thank You

Sincerely

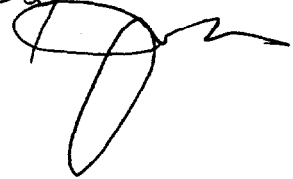

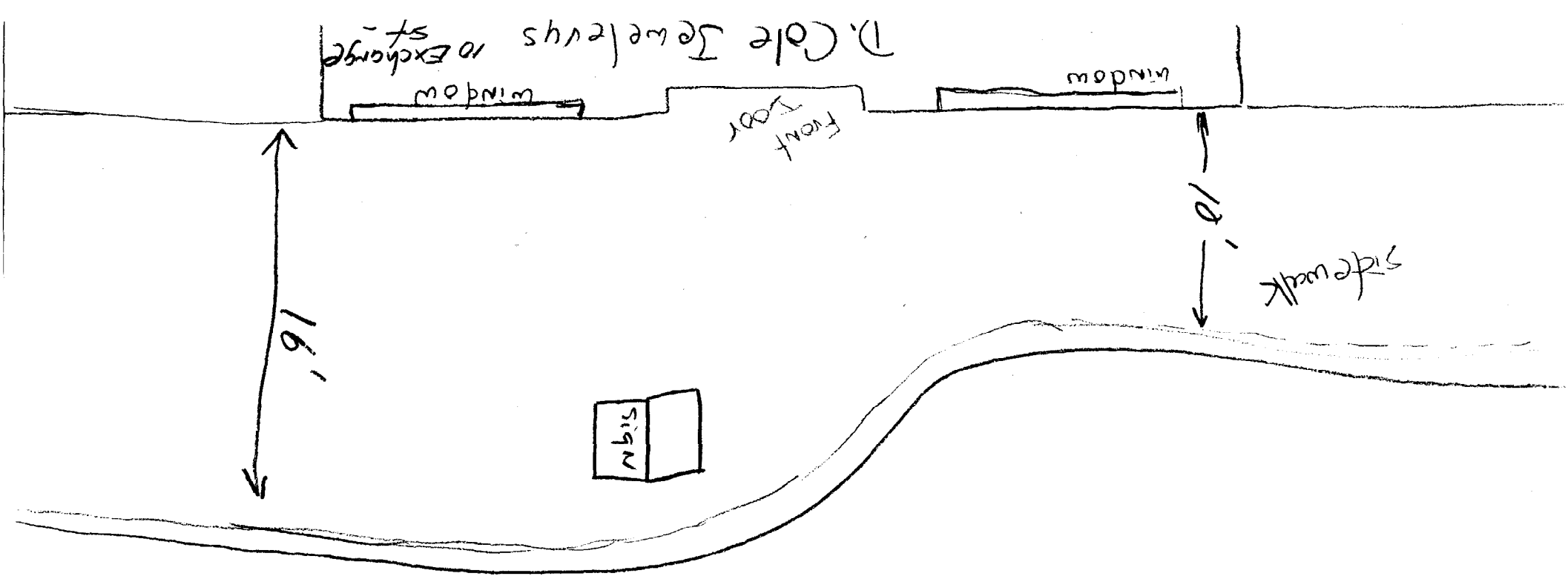

Exchange St.