

CLIENT/OWNER/TENANT

FAT FACE LTD
1-3 RIDGWAY HAVANT, PO9 1QJ
UNITED KINGDOM
CONTACT: DAVID LILLEY
TEL: 0044.2392.441100
E: DAVID.LILLEY@FATFACE.COM

DESIGNER

BOX OF FROGS LTD
2 WILLOW PARK STROKE POGES BUCKS SL2 4ES
CONTACT: SARAH MALCOM-RICHARDS
TEL: 007748609897
E: SARAH@BOXOFFROGS.WEB.COM

MEP ENGINEER

FISKAA
589 8TH AVENUE
NEW YORK, NY, 10018
CONTACT: ERIC MARTINSEN
TEL: 212.736.9600
E: EMARTINSEN@FISKAA.COM

STRUCTURAL ENGINEER

ARMOUR UNSDERFER ENGINEERING INC. P.S.
555 116TH AVE NE, SUITE 118
BELLEVUE WA 98004
CONTACT: BRIAN UNSDERFER
TEL: 425.614.0949
E: brianu@au-eng.com

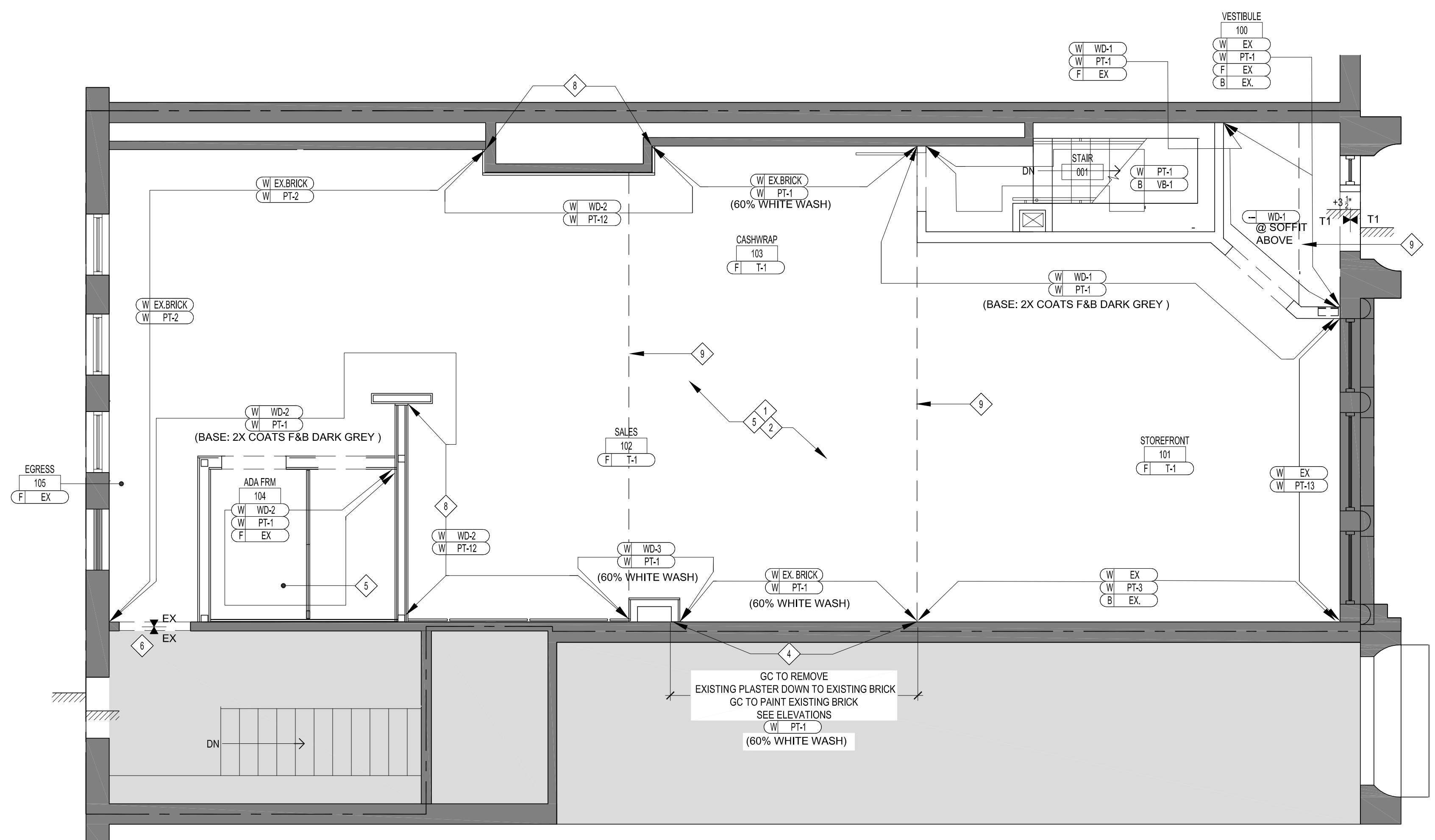

LEGEND

- INDICATES AREAS NOT IN SCOPE OF WORK.
- INDICATES EXISTING CONSTRUCTION TO REMAIN.
- INDICATES NEW AREA CARPET
- FLOOR FINISH CHANGE REFER TO SHEET A-600 FOR TRANSITION DETAIL
- INDICATES FLOOR, CEILING, WALL OR BASE
- INDICATES FINISH MATERIAL

TRANSITION SCHEDULE LEGEND

- T-1-EXISTING EXTERIOR TO EXISTING MOSIAC TILE
- T-2-VCT TO TILE
- T-3-VCT TO CARPET

FINISHES

- PAINT FINISHES**
- LOCATION: SEE PLAN DESCRIPTION: WHITE PAINT MFR: FARROW AND BALL COLOR NAME/ #: ALL WHITE
 - LOCATION: SEE PLAN DESCRIPTION: MFR: FARROW AND BALL COLOR NAME/ #: ELEPHANT'S BREATH
 - LOCATION: SEE PLAN DESCRIPTION: MFR: FARROW AND BALL COLOR NAME/ #: SHADED WHITE
 - LOCATION: SEE PLAN DESCRIPTION: X2 BASE COAT X1 TOP COAT MFR: BASE COAT - FARROW AND BALL TOP COAT - DULUX COLOR NAME/ #: BASE COAT - ALL WHITE TOP COAT - HAWAIIAN BLUE
 - LOCATION: SEE PLAN DESCRIPTION: X2 BASE COAT X1 TOP COAT MFR: BASE COAT - FARROW AND BALL TOP COAT - LITTLE GREENE COMPANY COLOR NAME/ #: BASE COAT - ALL WHITE TOP COAT - TURQUOISE BLUE
 - LOCATION: SEE PLAN DESCRIPTION: EXTERIOR GRADE PAINT MFR: RAL COLOR NAME/ #: 1013 OYSTER WHITE (TO MATCH FARROW & BALL SKIMMING STONE)
 - LOCATION: SEE PLAN DESCRIPTION: EXTERIOR GRADE PAINT MFR: RAL COLOR NAME/ #: 7016 ANTHRACITE GREY (TO MATCH FARROW & BALL RAILINGS)
 - LOCATION: SEE PLAN DESCRIPTION: MFR: DULUX COLOR NAME/ #: BLACK EMULSION
 - LOCATION: SEE PLAN DESCRIPTION: 40% WHITE WASH MFR: CROWN PAINT COLOR NAME/ #: SAIL WHITE
 - LOCATION: SEE PLAN DESCRIPTION: X2 BASE COAT X1 TOP COAT MFR: BASE COAT - FARROW AND BALL EMULSION TOP COAT - DULUX COLOR NAME/ #: BASE COAT - ALL WHITE TOP COAT - HAWAIIAN BLUE
 - LOCATION: SEE PLAN DESCRIPTION: X2 BASE COAT X1 TOP COAT MFR: BASE COAT - FARROW AND BALL EMULSION TOP COAT - DULUX COLOR NAME/ #: BASE COAT - ALL WHITE TOP COAT - TURQUOISE BLUE

- LOCATION: SEE PLAN DESCRIPTION: X2 BASE COAT X2 TOP COAT MFR: BASE COAT - FARROW AND BALL TOP COAT - FARROW AND BALL COLOR NAME/ #: BASE COAT - DARK GREY TOP COAT - OLD WHITE
- LOCATION: SEE PLAN DESCRIPTION: X2 BASE COAT X2 TOP COAT MFR: BASE COAT - FARROW AND BALL TOP COAT - FARROW AND BALL COLOR NAME/ #: BASE COAT - DARK GREY TOP COAT - SHADED WHITE

- WOOD FINISHES**
- LOCATION: SEE PLANS DESCRIPTION: FIRE TREATED BEAD AND BUTT MFR: TBD COLOR NAME/ #: TBD NOTE: TBD
 - LOCATION: SEE PLANS DESCRIPTION: FIRE RATED SAWN CUT TIMBER MFR: SOURCED BY G.C. COLOR NAME/ #: TBD NOTE: G.C. TO PROVIDE SAMPLES FOR APPROVAL
 - LOCATION: SEE PLANS DESCRIPTION: FIRE RATED RECLAIMED TIMBER MFR: LOCALLY SOURCED BY G.C. COLOR NAME/ #: TBD NOTE: G.C. TO PROVIDE SAMPLES FOR APPROVAL

- TILE FINISHES**
- LOCATION: FLOOR THROUGHOUT SALES AREA DESCRIPTION: EXISTING MOSIAC TILES MFR: --- STYLE NAME/ #: --- COLOR NAME/ #: --- SIZE: 4" CONTACT: NOTE: G.C. TO BRING TO LIKE 'NEW' CONDITION. G.C. TO PROVIDE SAMPLE FOR APPROVAL FOR TILE INFILL AS REQUIRED
 - LOCATION: BATHROOM WALLS/PANTRY DESCRIPTION: 3/8" CERAMIC TILE IN THINSET MFR: TBD STYLE NAME/ #: TBD COLOR NAME/ #: TBD SIZE: TBD CONTACT: NOTE: OR APPROVED EQUAL
 - LOCATION: BASEMENT DESCRIPTION: VCT MFR: ARMSTRONG STYLE NAME/ #: EXCELON STONETEX COLOR NAME/ #: TBD SIZE: 18"X18" CONTACT: NOTE: OR APPROVED EQUAL
 - LOCATION: RESTROOM DESCRIPTION: CERAMIC FLOOR TILE MFR: TBD STYLE NAME/ #: TBD COLOR NAME/ #: TBD SIZE: 3/8" X 12" X 12" CONTACT: NOTE: OR APPROVED EQUAL

- WALL BASE**
- LOCATION: CELLAR STOCK/PANTY/MANAGERS OFFICE DESCRIPTION: RUBBER BASE MFR: ALL STATE 4" STYLE NAME/ #: - COLOR NAME/ #: XD49 SIZE: 4" LOCATION: CELLAR RESTROOM DESCRIPTION: 6"x6" X 3/8" TILE BASE MFR: --- STYLE NAME/ #: - COLOR NAME/ #: SIZE: ---
 - LOCATION: OFFICE / SHIPPING, AND PANTRY COUNTER / MILLWORK DESCRIPTION: WHITE PLASTIC LAMINATE MFR: FORMICA STYLE NAME/ #: 7197-58 COLOR NAME/ #: DOVER WHITE NOTE: MATTE FINISH
- MILLWORK**
- LOCATION: OFFICE / SHIPPING, AND PANTRY COUNTER / MILLWORK DESCRIPTION: WHITE PLASTIC LAMINATE MFR: FORMICA STYLE NAME/ #: 7197-58 COLOR NAME/ #: DOVER WHITE NOTE: MATTE FINISH
- METAL**
- LOCATION: CEILINGS AS NOTED DESCRIPTION: TIN CEILING PANEL MFR: TBD COLOR NAME/ #: TBD NOTE: TO MATCH EXISTING TIN CEILING
 - LOCATION: 1/2" LOW IRON TEMPERED GLAZING MFR: TBD COLOR NAME/ #: TBD NOTE: ---
 - LOCATION: 1/4" TEMPERED MIRROR GLASS MFR: TBD COLOR NAME/ #: TBD NOTE: ---

KEY NOTES

- 1 SEE SHEETS A700.00-A704.00 FOR MORE INFORMATION ON WALL FINISHES.
- 2 ALL FLOOR TO HAVE A NON SLIP COEFFICIENT OF 0.6 OR HIGHER.
- 3 SEE FITTING ROOM ELEVATIONS FOR FINISHES
- 4 G.C. TO VERIFY CONDITION OF EXISTING BRICK BEYOND PLASTER IN AREAS AS NOTED.
- 5 G.C. TO PATCH AND REPAIR ALL EXISTING FINISHES NOTED TO REMAIN. G.C. TO BRING TO LIKE 'NEW' CONDITION AS REQUIRED.
- 6 NEW DOOR AND DOOR FRAME BY GC.
- 7 EXISTING DOOR & FRAME TO BE STRIPPED DOWN & REPAINTED.
- 8 ROUGH SAWN FIRE TREATED TIMBER TO BE VERTICAL, DIAGONAL AND HORIZONTAL PATTERN. SEE DETAILS FOR PATTERN
- 9 LINE OF SOFFIT ABOVE

| Issue | Date | Issue | Date |
|-------------------------------|----------|-----------------------------|----------|
| A. ISSUE FOR HISTORIC REVIEW | 07/01/15 | △ ISSUE FOR HISTORIC REVIEW | 07/16/15 |
| B. ISSUE FOR L1 REVIEW/PRELIM | 07/10/15 | △ ISSUE FOR HISTORIC REVIEW | 07/23/15 |
| PRICING | | | |
| C. ISSUE FOR DEMO PERMIT | 07/20/15 | | |
| D. ISSUE FOR PERMIT | 07/24/15 | | |

Project
FAT FACE PORTLAND
34 EXCHANGE STREET
PORTLAND, ME 04104

Drawing Title
FINISH PLAN

| Project No. | Drawn By | Date | Scale |
|-------------|----------|----------|------------|
| 5063.02 | -- | -- | 1/4"=1'-0" |
| Seal | | Floor(s) | |

Drawing No. **GROUND**
A-401.00