

A

B

C

D

A

B

C

D

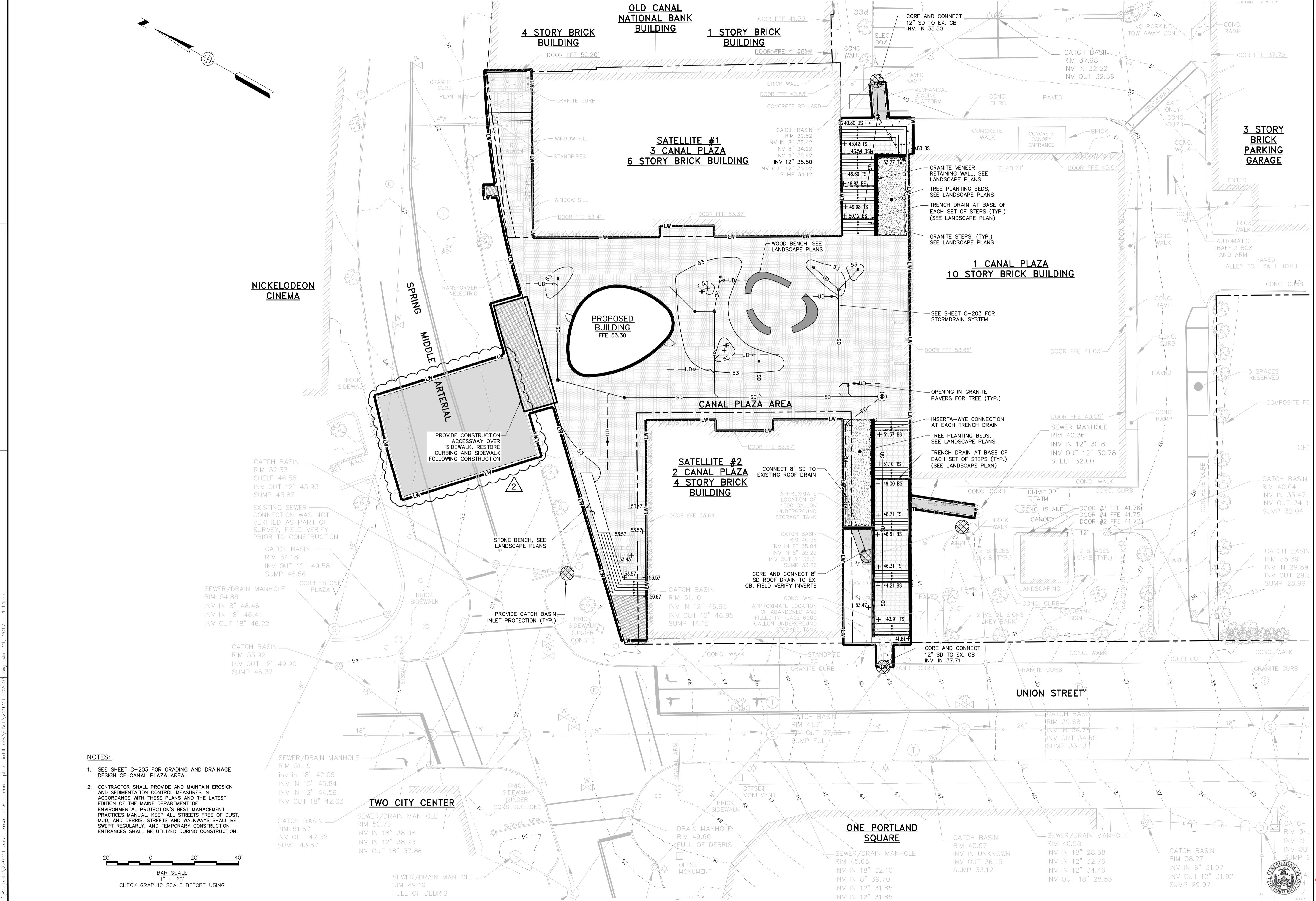

- NOTES:**
- SEE SHEET C-203 FOR GRADING AND DRAINAGE DESIGN OF CANAL PLAZA AREA.
 - CONTRACTOR SHALL PROVIDE AND MAINTAIN EROSION AND SEDIMENTATION CONTROL MEASURES IN ACCORDANCE WITH THESE PLANS AND THE LATEST EDITION OF THE MAINE DEPARTMENT OF ENVIRONMENTAL PROTECTION'S BEST MANAGEMENT PRACTICES MANUAL. KEEP ALL STREETS FREE OF DUST, MUD, AND DEBRIS. STREETS AND WALKWAYS SHALL BE SWEEPED REGULARLY, AND TEMPORARY CONSTRUCTION ENTRANCES SHALL BE UTILIZED DURING CONSTRUCTION.

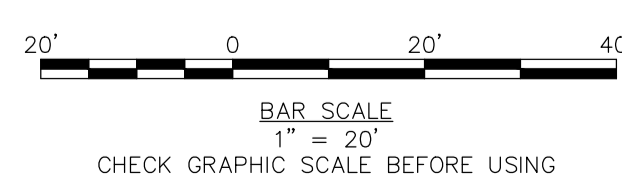

41 Hutchins Drive
Portland, Maine 04102
800.426.4262 | www.woodardcurran.com

WOODARD CURRAN

COMMITMENT & INTEGRITY DRIVE RESULTS

THIS DOCUMENT IS THE PROPERTY OF WOODARD & CURRAN, INC. AND ITS CLIENT. REPRODUCTION OR MODIFICATION WITHOUT WRITTEN PERMISSION IS PROHIBITED.

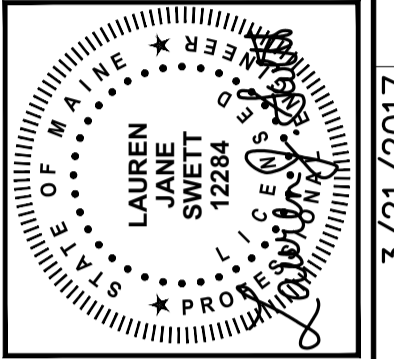

REV	DESCRIPTION	DATE	CHECKED BY: DAS
1	ADDENDUM 1	10/17/16	JBC
2	REVISED WATER SERVICE	3/21/2017	JBC

DESIGNED BY: JBC
DRAWN BY: JBC

GRADING, DRAINAGE, AND EROSION CONTROL PLAN

CANALSSTUDIO

ZERO CANAL PLAZA DEVELOPMENT

JOB NO.: 229311
DATE: SEPTEMBER 19, 2016
SCALE: 1" = 20'
SHEET: C-202

CITY OF PORTLAND
APPROVED SITE PLAN
Subject to the terms of Approval and Standard Conditions

C-202