

19. BOUNDARY SURVEY

A boundary survey of the Canal Plaza area was completed by Northeast Civil Solutions in November 2009. An updated survey for existing conditions was completed by Northeast Civil Solutions in November 2015. This survey was used as the basis for the existing conditions plan. Both survey documents are attached and have also been included as part of the plan set attached to Section 3 of this Report, but bound separately.

19.1 ATTACHMENTS

- 2009 Boundary Survey
- 2015 Existing Conditions Survey

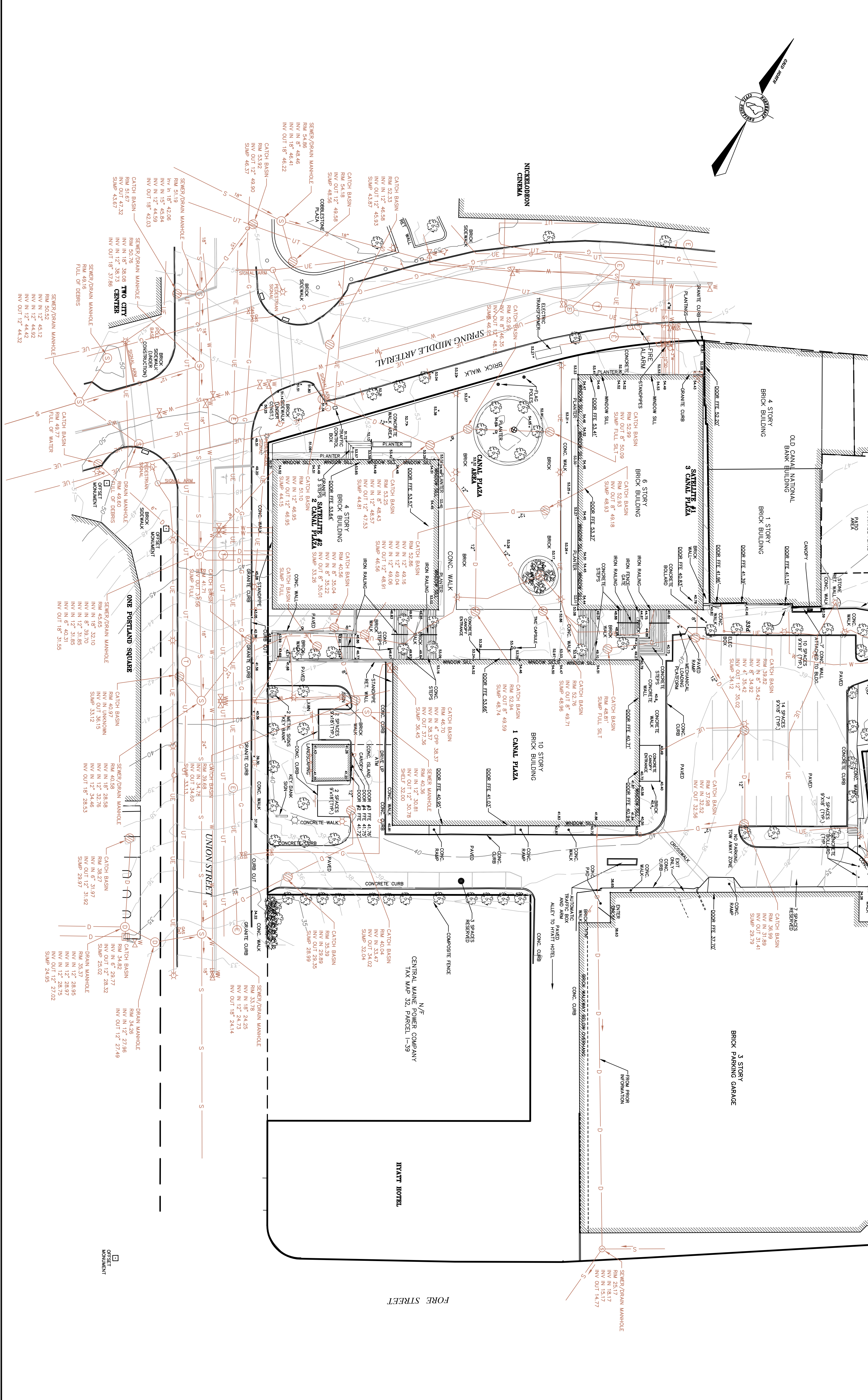
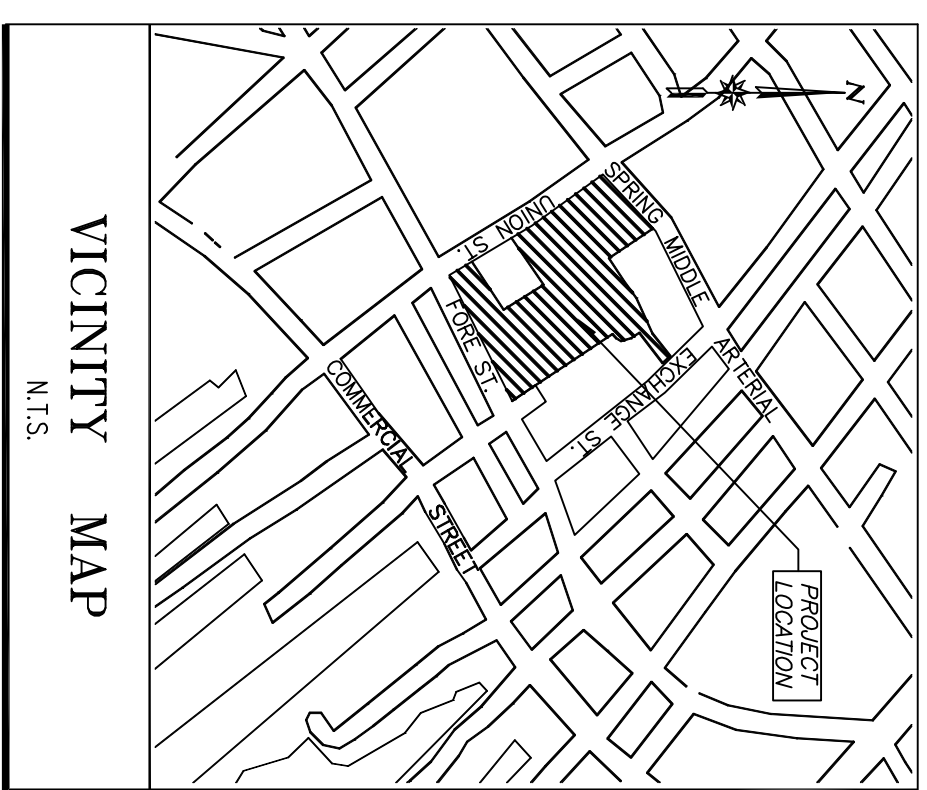

LEGEND

- FOUND MONUMENT (SIZE & TYPE AS NOTED)
- UTILITY POLE
- CUT WIRE ANCHOR
- SION
- FIRE HYDRANT
- CATCH BASIN
- WATER VALVE / SHUTOFF
- FOUND DECIDUOUS TREE
- FOUND CONFEROUS TREE
- BOUNDARY LINE
- EDGE OF PAVEMENT
- RIGHT-OF-WAY LINE
- ABUTTER LINE
- OVERHEAD UTILITY
- SEWER LINE
- DRAIN LINE
- WATER LINE
- GAS LINE
- UNDERGROUND ELECTRIC
- UNDERGROUND TELEPHONE
- SEWER MANHOLE
- TELEPHONE MANHOLE
- DRAIN MANHOLE
- ELECTRIC MANHOLE

NOTES

1. THE BEARINGS SHOWN ON THIS PLAN ARE BASED ON NAD 83 WEST ZONE.
2. THE UTILITIES SHOWN ON THIS PLAN WERE MARKED BY DIG SMART OF MAINE ON 08/17/2015 AND THEIR LOCATIONS ARE TO BE CONSIDERED APPROXIMATE. THERE MAY BE OTHER UTILITIES EXISTING THAT ARE NOT SHOWN. CONTRACTOR TO CONTACT DIG-SMART (888)DIG-SMART PRIOR TO ANY EXCAVATION WORK.
3. ELEVATIONS AND CONTOURS ARE BASED ON MVD 1927 DATUM.
4. DUE TO THE AMOUNT OF DATA AND CLARITY OF DRAWING, CONTOURS HAVE BEEN SHOWN FROM SOME AREAS AND 5' TO 10' GRADES ARE SHOWN.
5. BOUNDARY LINES SHOWN ARE BASED ON PRIOR SURVEY WORK DONE BY NORTHEAST CIVIL SOLUTIONS.
6. REFERENCE IS MADE TO THE FOLLOWING PLANS: EXISTING CONDITIONS AND CONSTRUCTION OF CANAL BY WILSON & WILSON, DATED APRIL 29, 2015, NOT RECORDED.

1	APP	1/20/15	CHANGE THE CLIENT NAME
---	-----	---------	------------------------

PROJECT: 29896-09
 DATE: NOVEMBER 20, 2015
 SCALE: 1"=30' FB # 409
 DRAWN BY: SM
 CHECKED BY: MJB
 FIELD BY: MJB / SM / MAC
 FIELD DATE: 09/2015
 DRAWING NAME: 29896-09.DWG
 PROJECT: 29896-09
 DATE: NOVEMBER 20, 2015
 SCALE: 1"=30' FB # 409
 DRAWN BY: SM
 CHECKED BY: MJB
 FIELD BY: MJB / SM / MAC
 FIELD DATE: 09/2015

CANAL PLAZA
 EAST BROWN COW DEVELOPMENT CO.
 100 COMMERCIAL STREET, PORTLAND MAINE
EAST BROWN COW DEVELOPMENT CO.
 100 COMMERCIAL STREET, PORTLAND MAINE

Northeast Civil Solutions
 SOLICITING ENGINEERING LAND PLANNING
 381 PAVNE ROAD, SCARBOROUGH, MAINE 04074
 TEL: 207.883.1000 FAX: 207.883.1001
 800.882.2221
 info@northeastcivilsolutions.com

STAMP AND SIGNATURE

M. J. BISHAM
 No. 1314
 DATE: 11-20-15