

1 2 3 4 5 6

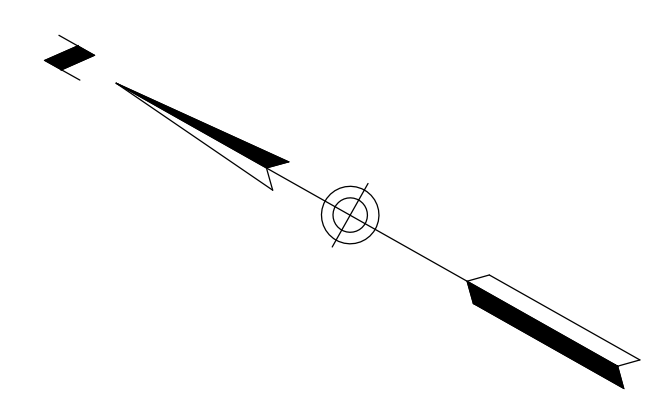

A

B

C

D

A

B

C

D

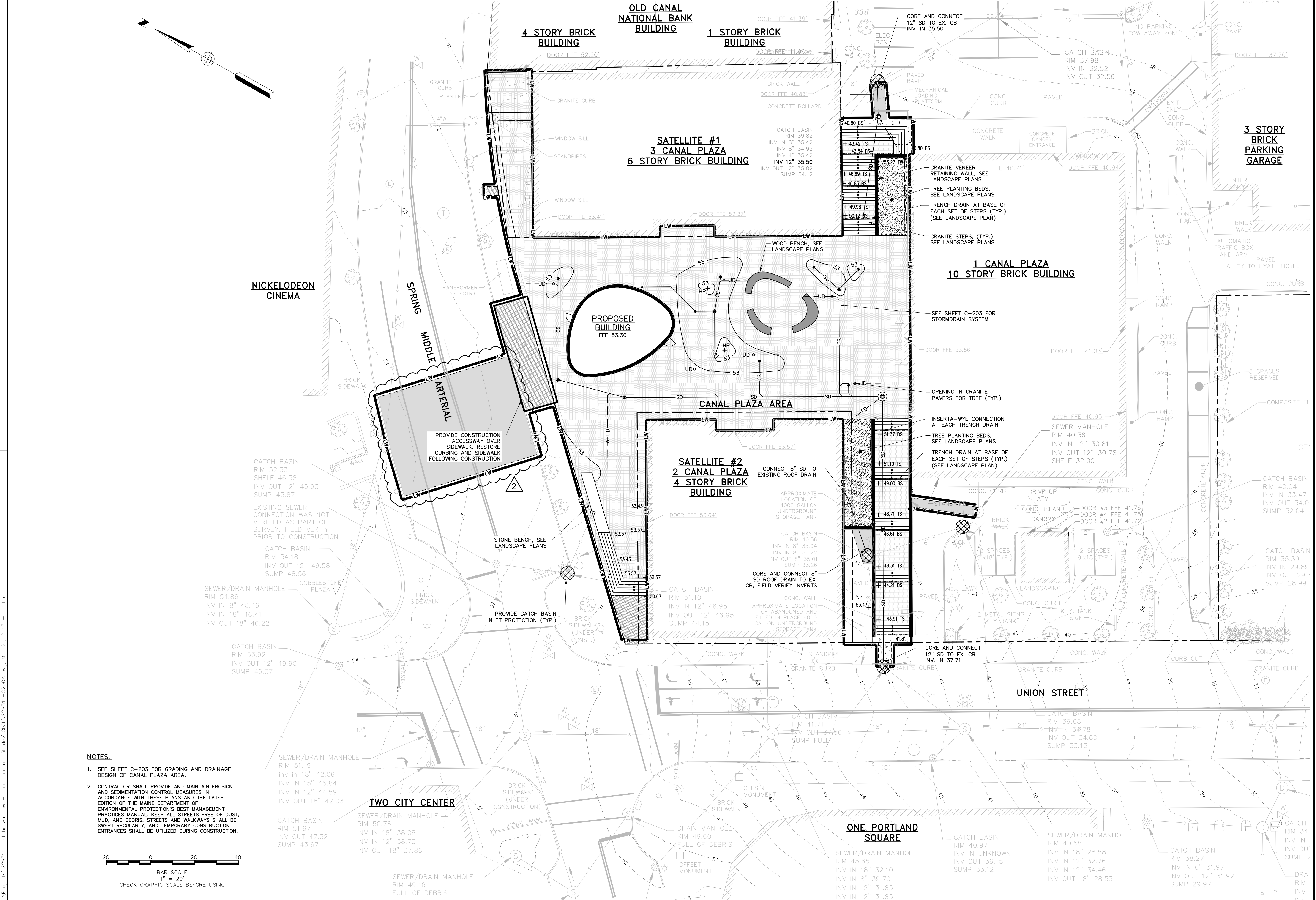

- NOTES:**
- SEE SHEET C-203 FOR GRADING AND DRAINAGE DESIGN OF CANAL PLAZA AREA.
 - CONTRACTOR SHALL PROVIDE AND MAINTAIN EROSION AND SEDIMENTATION CONTROL MEASURES IN ACCORDANCE WITH THESE PLANS AND THE LATEST EDITION OF THE MAINE DEPARTMENT OF ENVIRONMENTAL PROTECTION'S BEST MANAGEMENT PRACTICES MANUAL. KEEP ALL STREETS FREE OF DUST, MUD, AND DEBRIS. STREETS AND WALKWAYS SHALL BE SWEEPED REGULARLY, AND TEMPORARY CONSTRUCTION ENTRANCES SHALL BE UTILIZED DURING CONSTRUCTION.

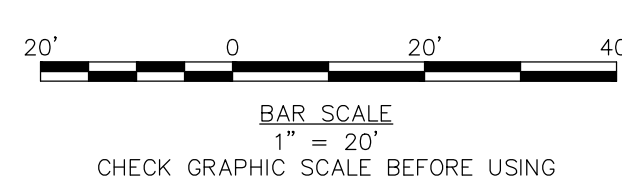

41 Hutchins Drive
Portland, Maine 04102
800.426.4262 | www.woodardcurran.com

WOODARD & CURRAN

COMMITMENT & INTEGRITY DRIVE RESULTS

THIS DOCUMENT IS THE PROPERTY OF WOODARD & CURRAN, INC. AND ITS CLIENTS. REPRODUCTION OR MODIFICATION WITHOUT WRITTEN PERMISSION IS PROHIBITED.

LAUREN JANE SNIET 12284

3/21/2017

3/21/2017

REV.	DESCRIPTION	DATE
2	REVISED WATER SERVICE	3/21/2017
1	ADDENDUM 1	10/11/16

CHECKED BY: DAS
DESIGNED BY: LJS
DRAWN BY: JBC

GRADING, DRAINAGE, AND EROSION CONTROL PLAN

CANALSTUDIO

ZERO CANAL PLAZA DEVELOPMENT

JOB NO.: 229311
DATE: SEPTEMBER 19, 2016
SCALE: 1" = 20'
SHEET: 5 OF 10

C-202

1 2 3 4 5 6