

A

B

C

D

A

B

C

D

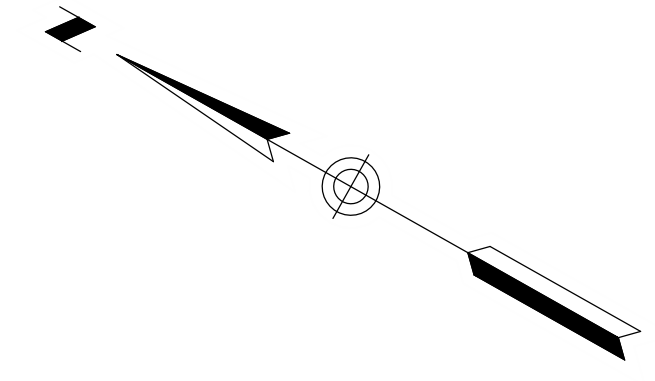
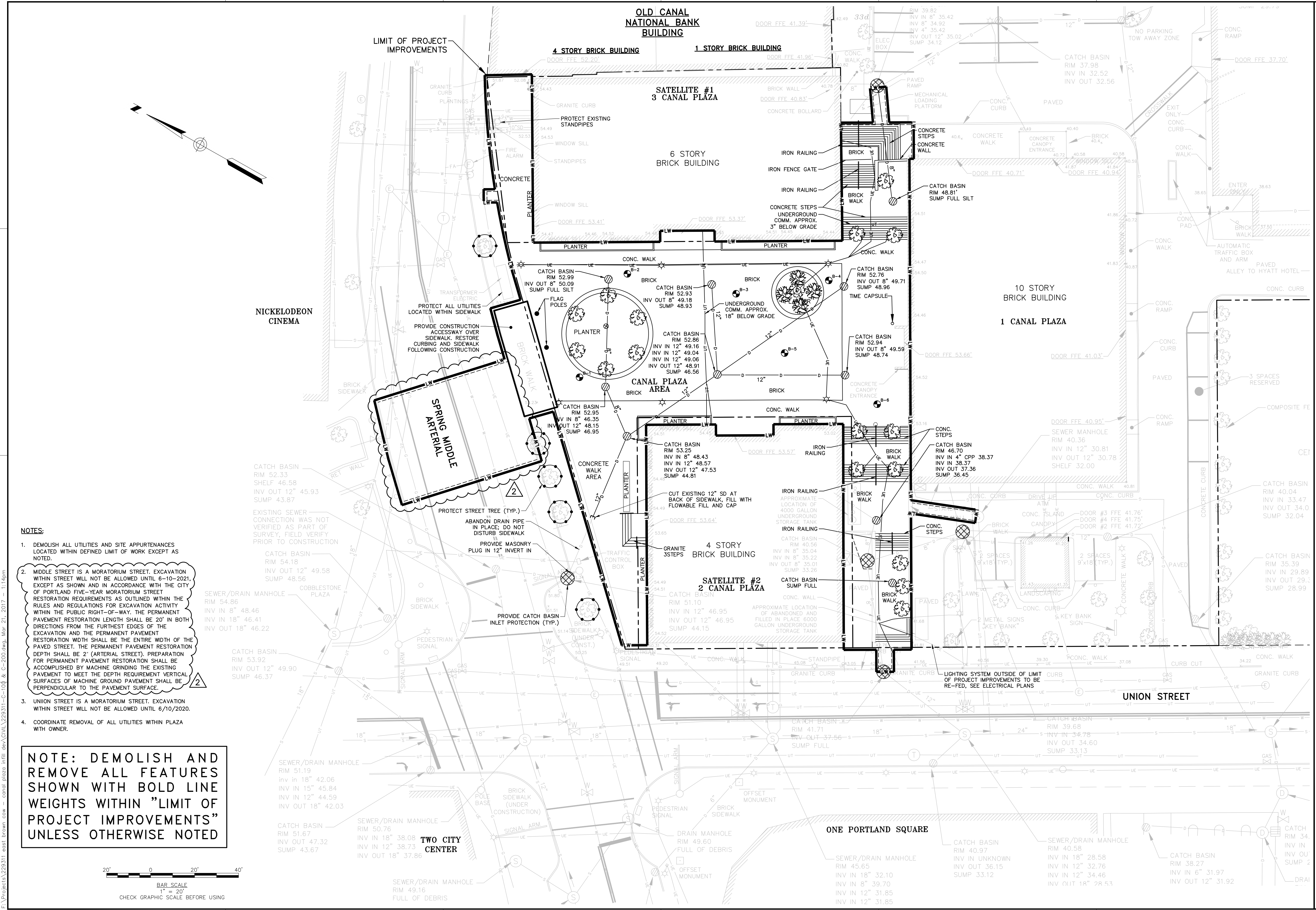

- NOTES:**
- DEMOLISH ALL UTILITIES AND SITE APPURTENANCES LOCATED WITHIN DEFINED LIMIT OF WORK EXCEPT AS NOTED.
 - MIDDLE STREET IS A MORATORIUM STREET. EXCAVATION WITHIN STREET WILL NOT BE ALLOWED UNTIL 8-10-2021, EXCEPT AS SHOWN AND IN ACCORDANCE WITH THE CITY OF PORTLAND FIVE-YEAR MORATORIUM STREET RESTORATION REQUIREMENTS AS OUTLINED WITHIN THE RULES AND REGULATIONS FOR EXCAVATION ACTIVITY WITHIN THE PUBLIC RIGHT-OF-WAY. THE PERMANENT PAVEMENT RESTORATION LENGTH SHALL BE 20' IN BOTH DIRECTIONS FROM THE FURTHEST EDGES OF THE EXCAVATION AND THE PERMANENT PAVEMENT RESTORATION WIDTH SHALL BE THE ENTIRE WIDTH OF THE PAVED STREET. THE PERMANENT PAVEMENT RESTORATION DEPTH SHALL BE 2" (ARTERIAL STREET). PREPARATION FOR PERMANENT PAVEMENT RESTORATION SHALL BE ACCOMPLISHED BY MACHINE GRINDING THE EXISTING PAVEMENT TO MEET THE DEPTH REQUIREMENT. VERTICAL SURFACES OF MACHINE GROUND PAVEMENT SHALL BE PERPENDICULAR TO THE PAVEMENT SURFACE.
 - UNION STREET IS A MORATORIUM STREET. EXCAVATION WITHIN STREET WILL NOT BE ALLOWED UNTIL 6/10/2020.
 - COORDINATE REMOVAL OF ALL UTILITIES WITHIN PLAZA WITH OWNER.

NOTE: DEMOLISH AND REMOVE ALL FEATURES SHOWN WITH BOLD LINE WEIGHTS WITHIN "LIMIT OF PROJECT IMPROVEMENTS" UNLESS OTHERWISE NOTED

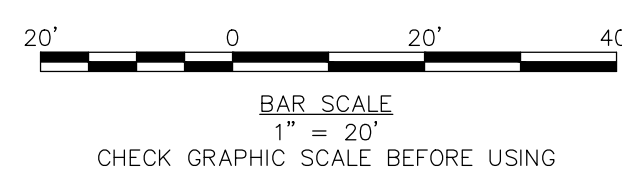

41 Hutchins Drive
Portland, Maine 04102
800.426.4262 | www.woodardcurran.com

WOODARD & CURRAN

COMMITMENT & INTEGRITY DRIVE RESULTS

THIS DOCUMENT IS THE PROPERTY OF WOODARD & CURRAN, INC. AND ITS CLIENTS. REPRODUCTION OR MODIFICATION WITHOUT WRITTEN PERMISSION IS PROHIBITED.

LAUREN JANE SNIET 12284 & 12285

3/21/2017

REVISION	DESCRIPTION	DATE	CHECKED BY: DAS
2	REVISED WATER SERVICE	3/21/2017	
1	ADDENDUM 1	10/11/16	

DESIGNED BY: LJS
DRAWN BY: JBC

SITE DEMOLITION PLAN

CANALSSTUDIO

ZERO CANAL PLAZA DEVELOPMENT

JOB NO.: 229311
DATE: SEPTEMBER 19, 2016
SCALE: 1" = 20'
SHEET: 3 OF 10

C-200