

**GAWRON  
TURGEON  
ARCHITECTS**  
29 Black Point Road  
Scarborough, ME 04074  
www.gawronturgeon.com  
Tel. 207 . 883 . 6307  
Fax. 207 . 883 . 0361

**KeyBank**  
Office Renovation  
One Canal Plaza

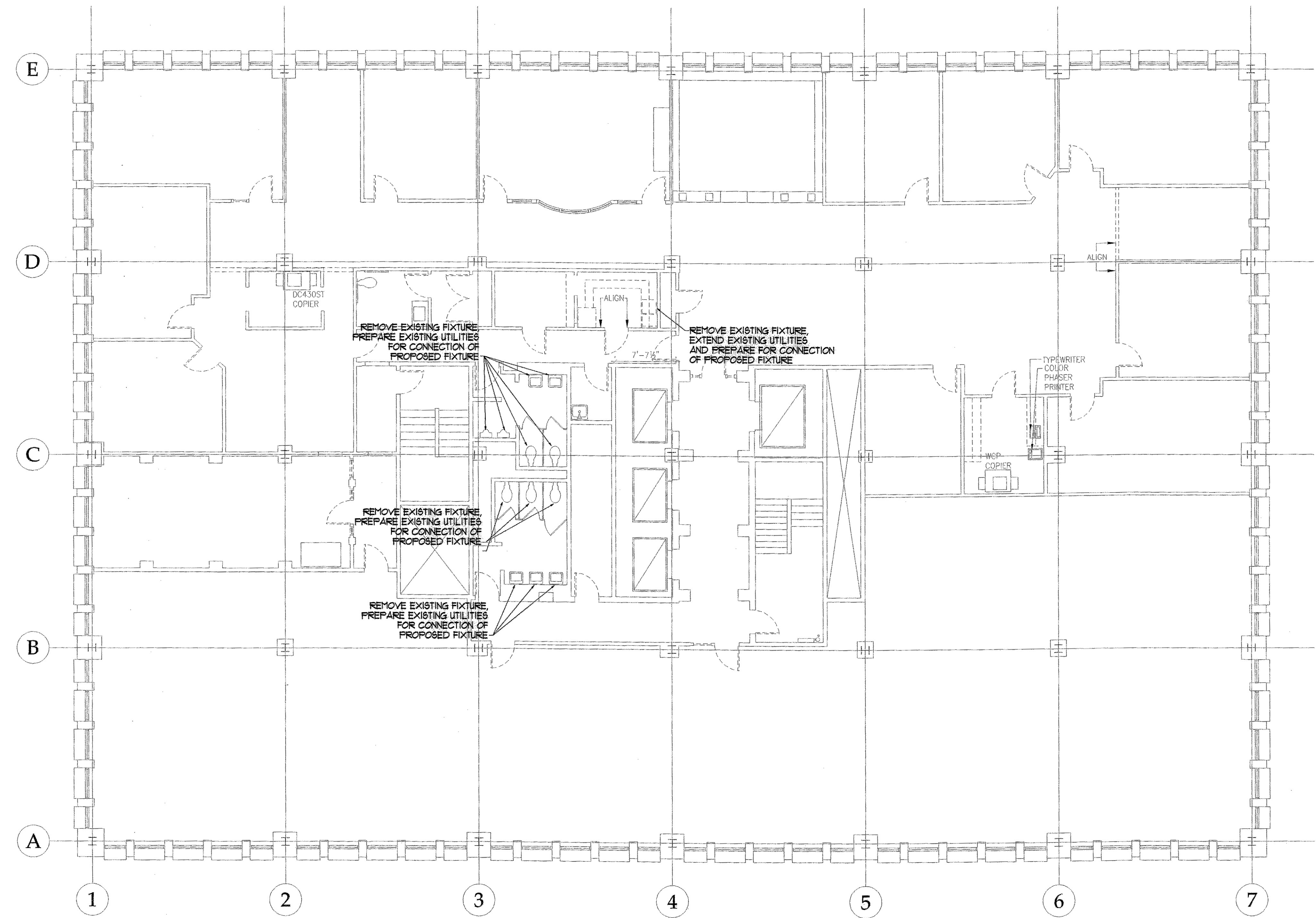

**SEVENTH FLOOR MECHANICAL DEMOLITION PLAN**  
SCALE - 1/8" = 1' - 0"

**NOTES -**

1. Fabricate and install metal splice covers for perimeter HVAC discharge plenums at windows at all areas where existing partitions are indicated to be removed. Anchor securely to existing perimeter enclosure. Match thickness and profile of existing splices.
2. Cut existing perimeter HVAC discharge plenum at windows at all areas where partition walls are being added. Install sheetmetal end were plenum meets proposed wall and seal airtight.

**REVISIONS**

#	DATE	DESCRIPTION

#	DATE	DESCRIPTION
1	08.29.07	PROGRESS RELEASE - HVAC CONSULTING

DATE:	10.22.07
PROJECT #	020807
DRAWN BY:	JMV
CHECKED BY:	SPDoel
DRAWING SCALE	AS NOTED

**SHEET TITLE**

CANAL PLAZA  
SEVENTH FLOOR  
MECHANICAL  
DEMOLITION PLAN

**M104**