

**GAWRON
TURGEON
ARCHITECTS**
29 Black Point Road
Scarborough, ME 04074
www.gawronturgeon.com
Tel. 207 . 883 . 6307
Fax. 207 . 883 . 0361

KeyBank
Office Renovation
One Canal Plaza

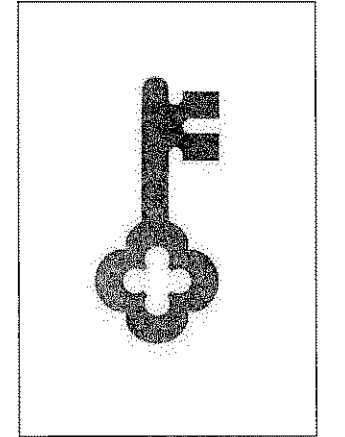

REVISIONS

#	DATE	DESCRIPTION

REVISIONS

#	DATE	DESCRIPTION
1	08.29.07	PROCESS RELEASE - RJC CONSULTING
2	10.29.07	PRICING SET RELEASE

DATE: 10.22.07

PROJECT #: 020807

DRAWN BY: LAP

CHECKED BY: MET

DRAWING SCALE: AS NOTED

SHEET TITLE

SECOND FLOOR PLAN

A101

© COPYRIGHT 1985-2006
REPRODUCTION OR RESALE OF THIS
DOCUMENT WITHOUT WRITTEN
PERMISSION OF GAWRON TURGEON
ARCHITECTS IS PROHIBITED

1. PATCH & REPAIR WALLS IN AREAS OF VALANCE REMOVAL, SINK REMOVAL, PLASTER REMOVAL.

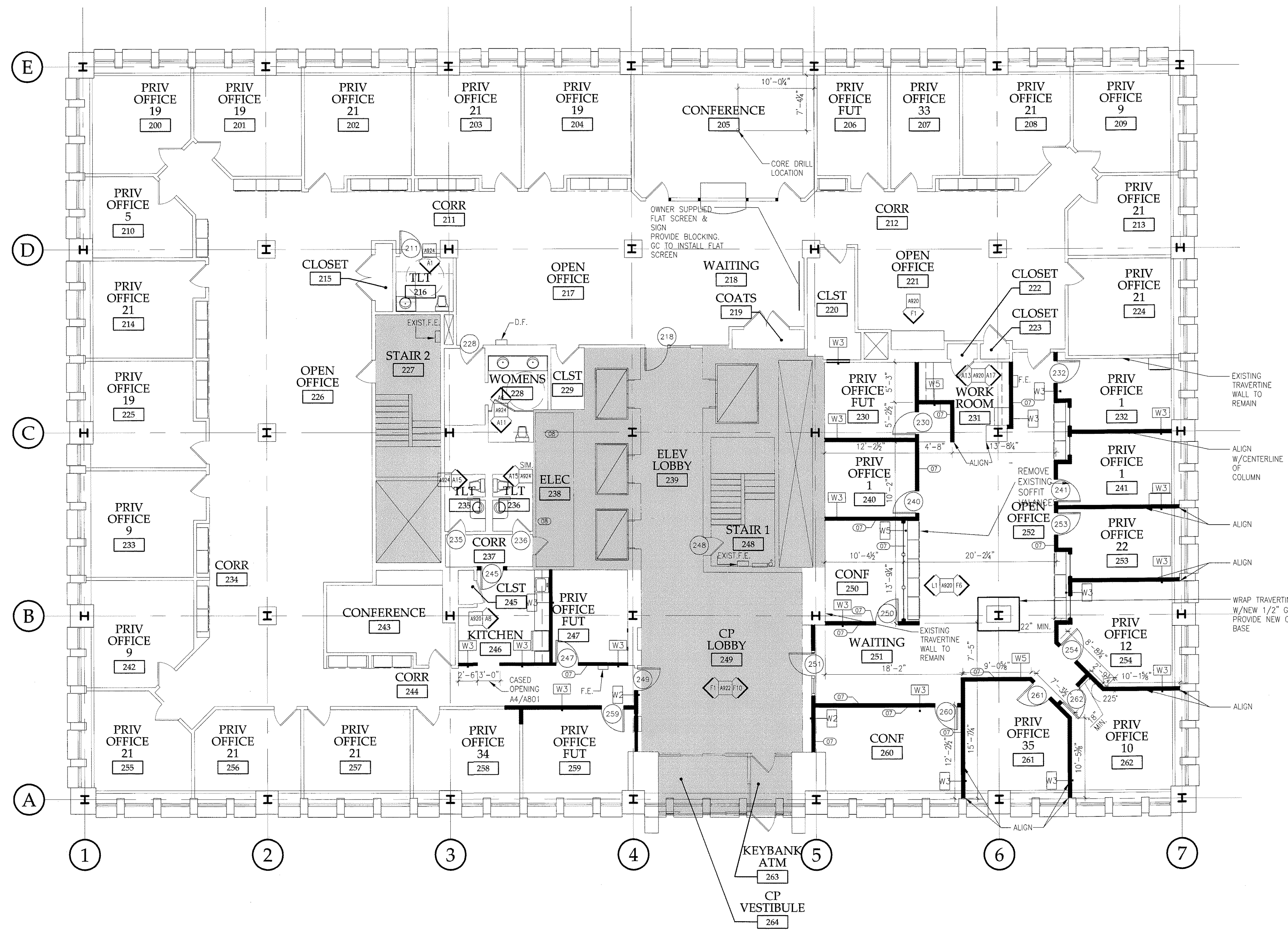

NOTE: PATCH IN CHERRY, NEW CHAIR RAIL AND FLOOR BASE AS NECESSARY DUE TO DEMOLITIONS

- (01) METAL STORAGE CAGES WITH LOCKS
- (02) HEAVY-DUTY METAL UTILITY SHELVING UNITS WITH 5 SHELVES PRODUCT, SHELVING DIRECT 1-800-500-9141 METAL POINT PLUS HEAVY DUTY STORAGE SHELVING - 14 GAUGE STEEL SHELVES CAPACITY 1200 LB. LENGTH INDICATED ON PLAN
- (03) MAIL CENTER - CONSOLE AND SORT MODULES
- (04) BASE AND WALL CABINETS WITH COUNTERTOP
- (05) NEW DOORS AND SIDELIGHT SHALL MATCH EXISTING
- (06) PATCH & REPAIR WALL & MILLWORK
- (07) CHERRY CHAIR RAIL & FLOOR BASE
- (08) PROVIDE THROUGH-PENETRATION FIRESTOP SYSTEMS AT ELECTRIC ROOM EXISTING PENETRATIONS. REFER TO 6103 FOR RATING.

A1 FLOOR PLAN

1/8"=1'-0" SECOND FLOOR



A18 PLAN NOTES

NTS