

2 CLOVER PLUMBING CONNECTION

Scale: N.T.S.

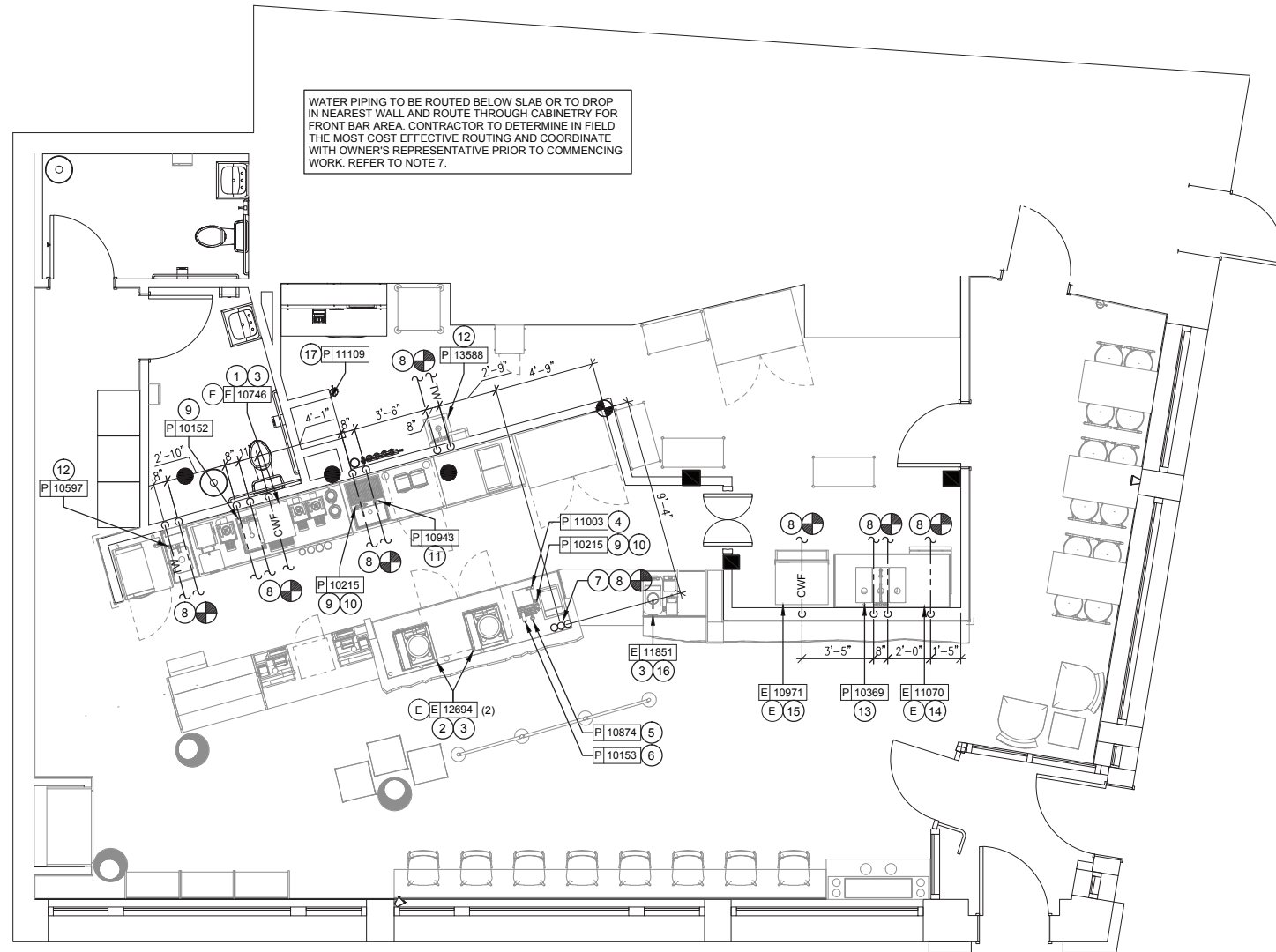

1 PLUMBING SUPPLY PLAN

Scale: 1/4" = 1'-0"



Plumbing Design Notes

- A. Furnish and install a complete and operating system. All items are not necessarily shown.
- B. Plumbing Contractor responsible for site investigation prior to start of work to reveal full scope of work.
- C. All Plumbing lines to be routed such that they are not visible to customers.
- D. Refer to manufacturer specifications for location of connections unless otherwise noted.
- E. Coordinate with Electrical Contractor for power connection to all plumbing equipment.
- F. Dimensions are to finish face unless otherwise noted.
- G. Refer to detail sheets for plumbing fittings located in casework.
- H. Cold water supply lines inside casework and bar area to be covered with 1/2" (10mm) thick self sealing, sectional closed-cell foam insulation. Refer to specifications for hot water supply line insulation requirements.
- J. Contractor shall contact water filter supplier before the time that the filter system is to be started up.
- K. Verify proper water system with water test results.

Sheet Notes

- 1. 1/2" CWF TO RELOCATED COFFEE BREWER. INSTALL SHUT-OFF IN CABINET @ 24" AFF. REDUCE TO 3/8" AT UNIT.
- 2. 1/2" CWF TO RELOCATED ESPRESSO MACHINE PUMP. SEE DETAIL PROVIDED ON SHEET P-112.
- 3. REUSE EXISTING BACKFLOW PREVENTER OR INSTALL NEW IF NONE EXISTING IF REQUIRED BY AHJ. PROVIDE ASSE 1022 BACKFLOW PREVENTER AT ESPRESSO AND COFFEE MAKERS IF NONE EXISTING.
- 4. 1/2" CW TO DIPPERWELL FAUCET. REDUCE TO 1/4" AT UNIT.
- 5. 1/2" CWF TO INSTAHOT TAP. REDUCE TO 1/4" AT UNIT.
- 6. 1/2" CWF TO WATER TOWER FAUCET LOCATED IN WATER STATION.
- 7. 3/4" CWF, CW & 1/2" HW TO DROP IN WALL. STUB-UP THRU FLOOR AT FRONT BAR AREA AND ROUTE THRU CABINetry. CONNECT TO EQUIPMENT 10153, 10215, 10874, 11003, 11851 AND 12694 (2). REFER TO NOTES 2, 3, 4, 5, 6, 8, 9, 10 AND 16. VERIFY ROUTING IN FIELD WITH GC PRIOR TO INSTALLATION. REUSE EXISTING STUB-UP THRU FLOOR IF POSSIBLE.
- 8. TIE INTO EXISTING DOMESTIC WATER SYSTEM VERIFY EXACT LOCATION, PRESSURE AND REQUIREMENTS ON SITE.
- 9. 1/2" HW & CW TO SINK.
- 10. PROVIDE A WATTS 9D ASSE 1012 BACKFLOW PREVENTER ON THE COLD AND HOT WATER LINES THAT SUPPLY THE FAUCET (10215) FOR THE BLENDER PITCHER RINSER AS REQUIRED BY CODE.
- 11. 1/2" CW TO SINK.
- 12. 1/2" TW & CW TO SINK.
- 13. 1/2" HW & CW TO FAUCET AND SPRAY AT COMPARTMENT SINK. CAULK AND SEAL BACK OF SINK TO WALL.
- 14. 3/4" HW TO RELOCATED DISHWASHER.
- 15. 1/2" CWF TO RELOCATED ICE MACHINE. REDUCE TO 3/8" AT MACHINE.
- 16. 1/2" CWF TO CLOVER BREWER. INSTALL SHUT-OFF IN CABINET. CONNECT 3/8" COMPRESSION BRAIDED STAINLESS STEEL HOSE FROM SHUT-OFF TO BREWER INLET. SEE DETAIL ON THIS SHEET.
- 17. REPLACE EXISTING WATER HEATER WITH NEW ELECTRIC WATER HEATER IN SAME LOCATION AS SPECIFIED IN THE PLUMBING FIXTURE SCHEDULE LOCATED ON SHEET P-001. RELOCATE ANY EXISTING PIPING AND ACCESSORIES ASSOCIATED WITH EXISTING WATER HEATER. EXTEND WATER PIPING AS REQUIRED.

Starbucks Coffee Company
2401 Utah Avenue South
Seattle, Washington 98134
(206) 318-1575

These Drawings and Specifications are confidential and shall remain the sole property of Starbucks Corporation. They shall not be reproduced (in whole or in part), shared with third parties or used in any manner on other projects or extensions to this project without the prior written consent of Starbucks Corporation. These drawings and specifications are intended to express Design Intent for a prototypical Starbucks store (which is subject to change at anytime) and do not reflect actual site conditions. Neither party shall have any obligation nor liability to the other (except as stated above) until a written agreement is fully executed by both parties.

Architect of Record
NORR
ARCHITECTS PLANNERS
325 N. LaSalle St. Suite 700 Chicago, IL 60654
t 312.424.2400 f 312.424.2421 www.norr.com

ENGINEER OF RECORD
William J. Alkemeyer, P.E.
353 Marshall Avenue
St. Louis, Missouri 63119
Phone (314) 772-1782
Fax (314) 772-0108
Engineering Consultant

Revision Schedule			
Rev	Date	By	Description

Project Name:
Exchange Street
Project Address:
**176 Middle Street
Portland, ME 04101**

Store #: 7408
Project #: 03196-029
Concept: NCS
Palette: HERITAGE
Issue Date: 03.25.2013
Design Manager: ERICA ZAKAMAREK
LEED® AP:
Production Designer: NORR
Checked by: JAK / SWE

Sheet Title:
Plumbing Supply Plan

Scale: 1/4" = 1'-0"

Sheet Number:
P-111