

1 ENLARGED BAR PLAN  
Scale: 1/2" = 1'-0"

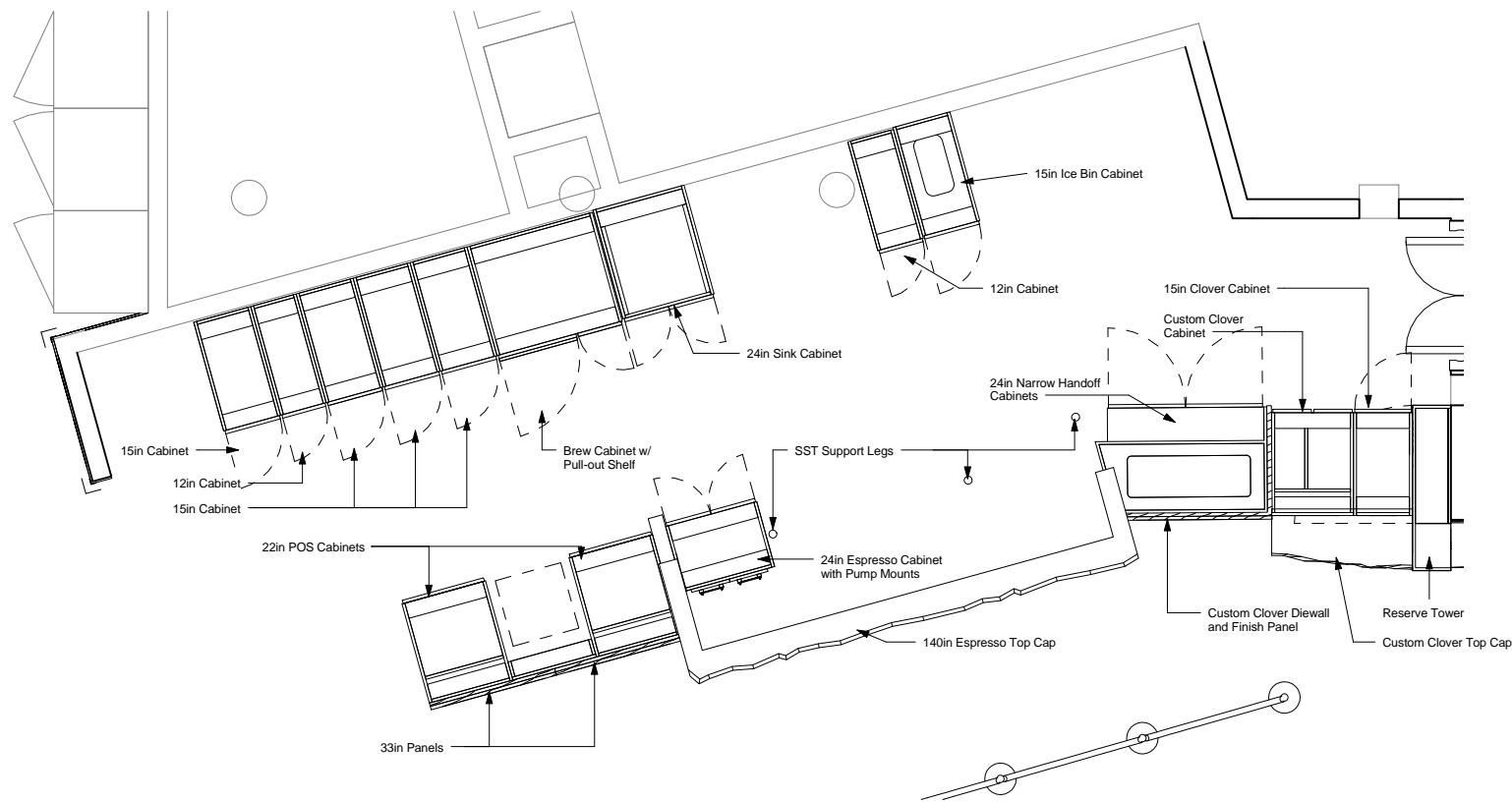

2 ENLARGED CASEWORK PLAN  
Scale: 1/2" = 1'-0"

Starbucks Coffee Company  
2401 Utah Avenue South  
Seattle, Washington 98134  
(206) 318-1575

These Drawings and Specifications are confidential and shall remain the sole property of Starbucks Corporation. They shall not be reproduced (in whole or in part), shared with third parties or used in any manner on other projects or extensions to this project without the prior written consent of Starbucks Corporation. These drawings and specifications are intended to express Design Intent for a prototypical Starbucks store (which is subject to change at anytime) and do not reflect actual site conditions. Neither party shall have any obligation nor liability to the other (except as stated above) until a written agreement is fully executed by both parties.

Architect of Record  
**NORR**  
ARCHITECTS PLANNERS  
325 N. LaSalle St. Suite 700 Chicago, IL 60654  
Phone (314) 772-1752  
Fax (314) 772-0108  
www.norr.com

ENGINEER OF RECORD  
William J. Alkemeyer, P.E.  
353 Marshall Avenue  
St. Louis, Missouri 63119  
Phone (314) 772-1752  
Fax (314) 772-0108  
Engineering Consultant

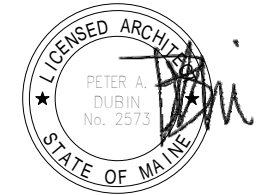

Revision Schedule			
Rev	Date	By	Description

Project Name:  
**Exchange Street**  
Project Address:  
**176 Middle Street  
Portland, ME 04101**

Store #: 7408  
Project #: 03196-029  
Concept: NCS  
Palette: HERITAGE  
Issue Date: 03.25.2013  
Design Manager: ERICA ZAKAMAREK  
LEED® AP:  
Production Designer: NORR  
Checked by: NORR

Sheet Title:  
**ENLARGED BAR PLANS**  
Scale: 1/2" = 1'-0"

Sheet Number:  
**I-401**