

4/11/2013 9:53:13 AM Y:\ME - Exchange Street_Portland\drawings\arch\2013 04 03_Exchange Street_ME_PERMIT.rvt

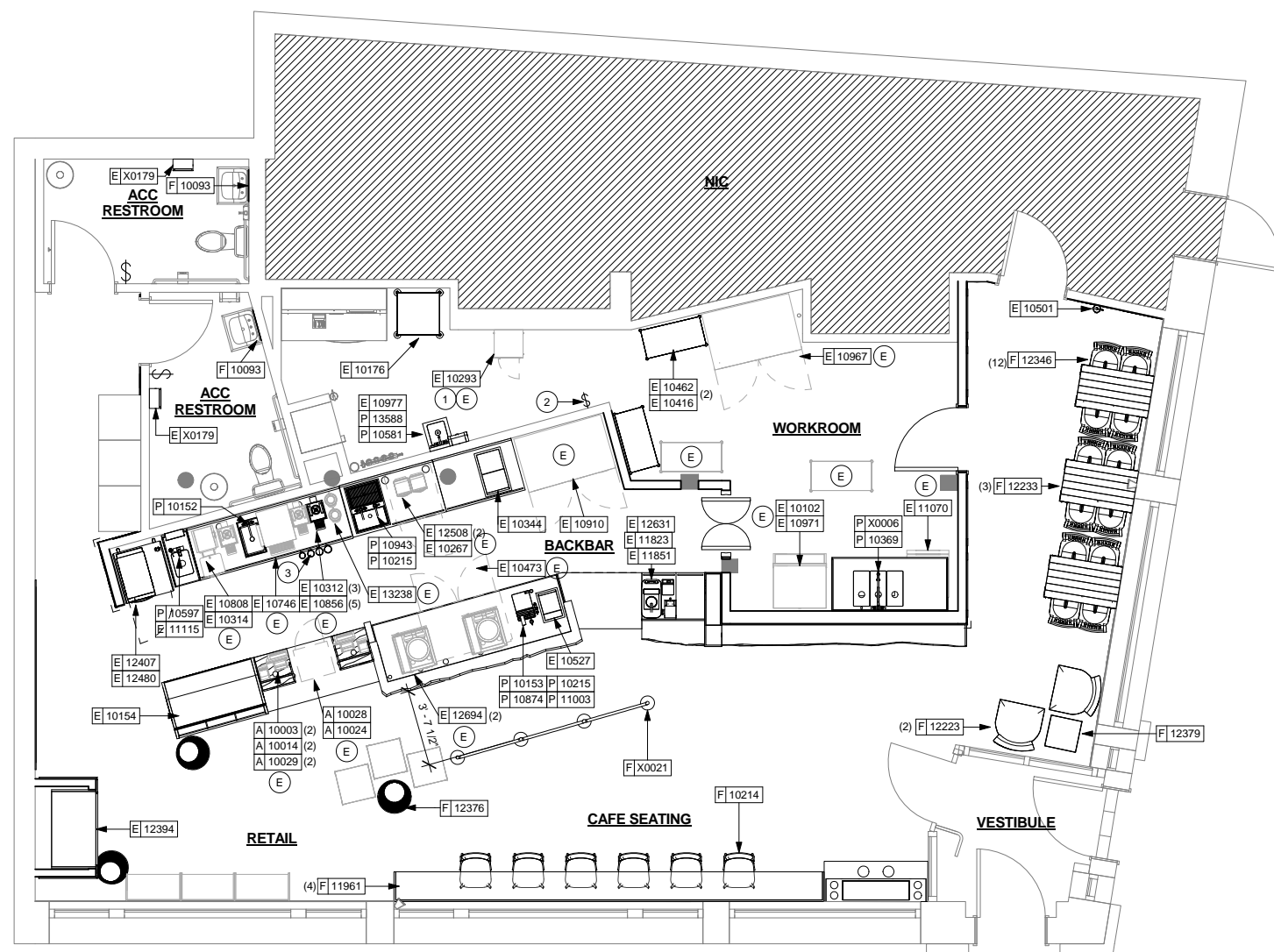

1 1ST FLOOR - FURNITURE, FIXTURES, AND EQUIPMENT PLAN
Scale: 1/4" = 1'-0"

FF AND E PLAN NOTES

- A. GENERAL CONTRACTOR TO SCHEDULE WITH LOCAL REFRIGERATION CONTRACTOR TO CONDUCT INITIAL FOOD CASE START-UP AND TESTING. FOR APPROVED CONTRACTOR, CONTACT VENDOR.
- B. THE SPACE IS SERVED BY THE MUNICIPAL WATER AND SEWER SYSTEM UNLESS OTHERWISE NOTED.
- C. ALL EQUIPMENT AND INSTALLATION WILL MEET NATIONAL SANITATION FOUNDATION STANDARDS OR EQUIVALENT.
- D. EQUIPMENT UNITS SHALL CONTAIN NO EXPOSED THREADS, EMBELLISHMENTS OR OVERHANGING EDGES THAT SERVE AS PLACES FOR ACCUMULATION OF DUST, DIRT AND DEBRIS.
- E. WARMING OVEN(S) SHOWN FOR PERMITTING PURPOSES. INSTALLATION AT STORE OPENING TO BE VERIFIED BY STARBUCKS CONSTRUCTION REPRESENTATIVE.
- F. EACH HAND WASHING SINK WILL HAVE A SINGLE SERVICE TOWEL AND SOAP DISPENSER, AND ALL HAND SINKS TO HAVE A COMBINATION FAUCET OR PREMIXING FAUCET.
- G. FOR PLUMBING FIXTURES, REFER TO THE PLUMBING DESIGN PLAN. FOR DATA DEVICE SCHEDULE, REFER TO THE ELECTRICAL DESIGN PLAN.
- H. SEE SHEET I-601 FOR SCHEDULES.

SHEET NOTES

1. SECURE LOCKERS TO WALL.
 2. LOCATION OF ALL SWITCHING.
 3. SEE ELEVATIONS FOR DISTRIBUTION OF CUP DISPENSERS.
- (E) EXISTING ITEM TO BE RELOCATED.



Starbucks Coffee Company
2401 Utah Avenue South
Seattle, Washington 98134
(206) 318-1575

These Drawings and Specifications are confidential and shall remain the sole property of Starbucks Corporation. They shall not be reproduced (in whole or in part), shared with third parties or used in any manner on other projects or extensions to this project without the prior written consent of Starbucks Corporation. These drawings and specifications are intended to express Design Intent for a prototypical Starbucks store (which is subject to change at anytime) and do not reflect actual site conditions. Neither party shall have any obligation nor liability to the other (except as stated above) until a written agreement is fully executed by both parties.

Architect of Record
NORR
ARCHITECTS PLANNERS
325 N. LaSalle St. Suite 700 Chicago, IL 60654
1 312.424.2400 | 312.424.2424 | www.norr.com

ENGINEER OF RECORD

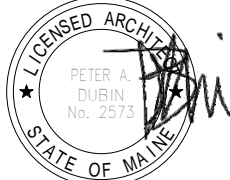
William J. Alkemeyer, P.E.
353 Marshall Avenue
St. Louis, Missouri 63119
Phone (314) 772-1782
Fax (314) 772-0108
Engineering Consultant

LICENSED ARCHITECT
PETER A. DUBIN
No. 2573
STATE OF MAINE

Revision Schedule			
Rev	Date	By	Description

Project Name:
Exchange Street
Project Address:
**176 Middle Street
Portland, ME 04101**

Store #: 7408
Project #: 03196-029
Concept: NCS
Palette: HERITAGE
Issue Date: 03.25.2013
Design Manager: ERICA ZAKAMAREK
LEED® AP:
Production Designer: NORR
Checked by: NORR

Sheet Title:
FF AND E PLAN

Scale: 1/4" = 1'-0"

Sheet Number:
I-115

