

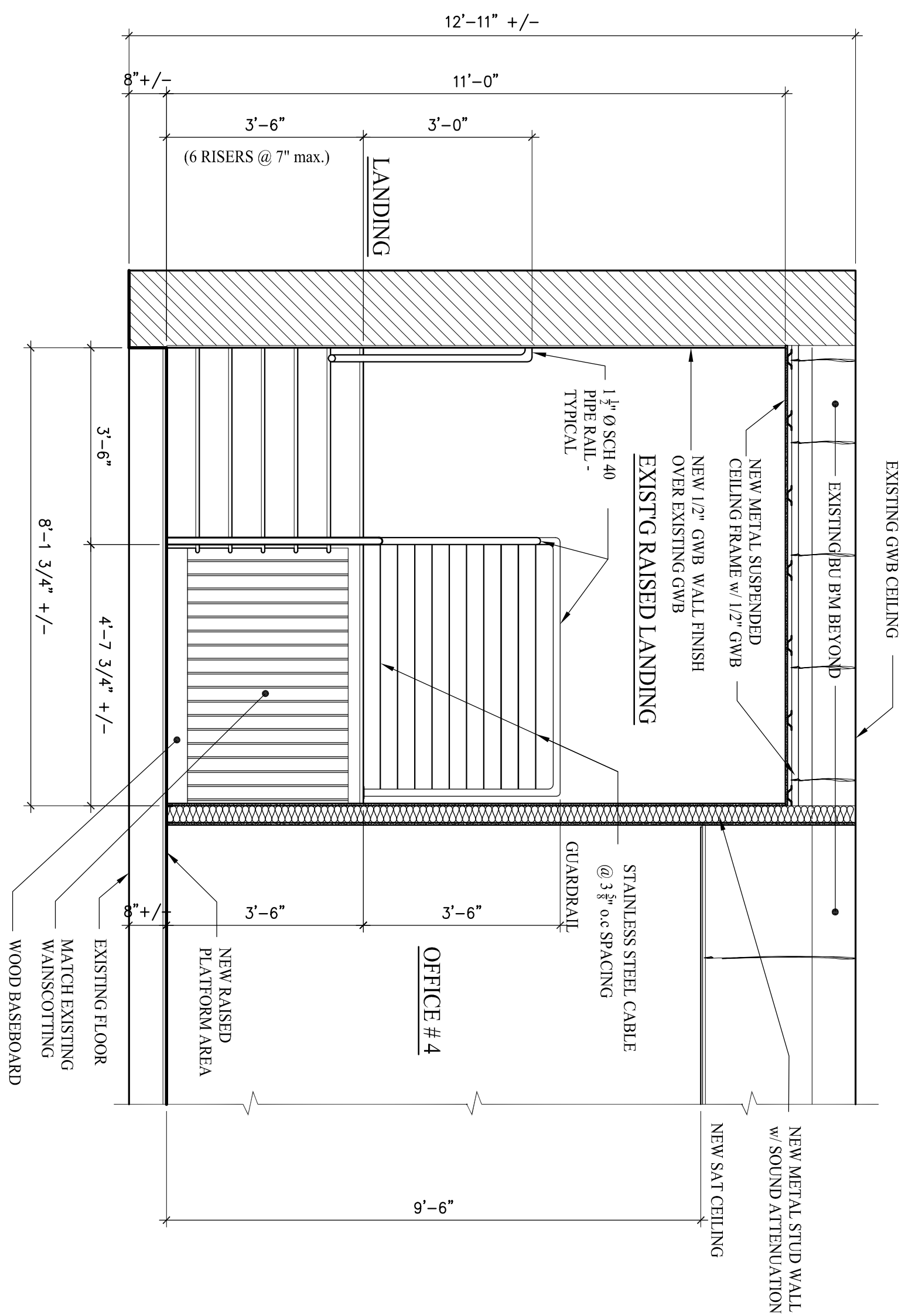

2 First Floor Plan - 1/4"
Scale: 1/4" = 1'-0"

2 ELEVATION OF PLATFORM LANDING
Scale: 1/2" = 1'-0"



1 SECTION-THRU STAIRS at REAR HALL
Scale: 1/2" = 1'-0"

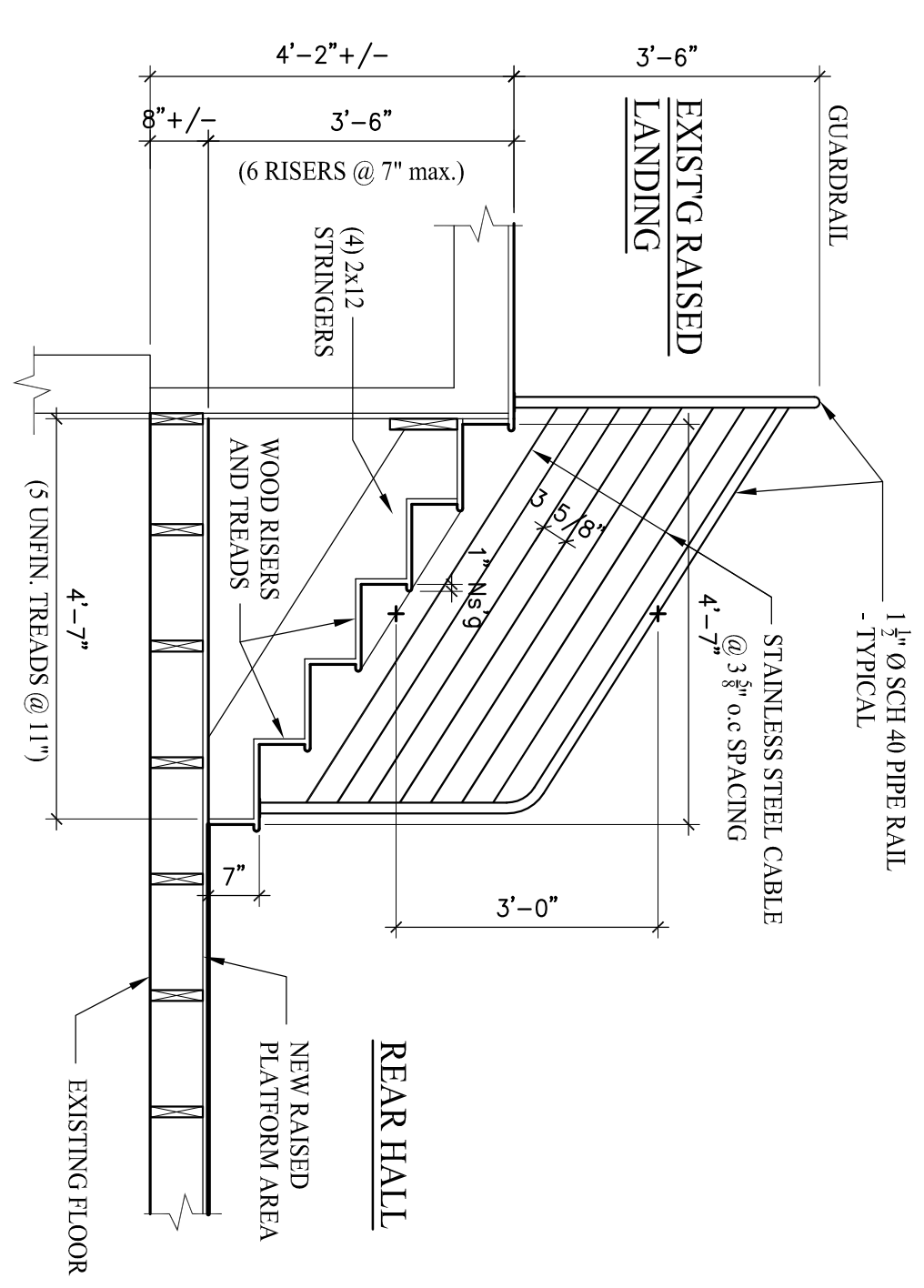

Progress Not For Construction 06-22-16

SOUND ATTENUATION	
BLANKET (SAB)	4 5/8"
CONT. 1/2" GWB (EACH SIDE) TO CEILING (UNO)	4 7/8"
METAL STUDS @ 16" O.C.	
INSULATION ANCHOR	
3 5/8" STEEL STUDS w/ 3 1/2" SAB, (1) LAYER 1/2" GWB BOTH SIDES - 4 5/8" WALL THICKNESS (NON-RATED)	1
3 5/8" STEEL STUDS w/ 3 1/2" SAB, (1) LAYER 5/8" TYPE "X" GWB BOTH SIDES - 4 7/8" WALL THICKNESS (60 MIN. RATED) UL ASSEMBLY U 423	2

INTERIOR WALL PARTITION TYPE - TYP.
SCALE: (NTS)

A1.2
sheet number
issued: 06-24-16
project no. 1601

Construction Set: 06/24/16
Machias Savings Bank
193 Middle Street, Portland, Maine
1/4" FIRST FLOOR PLAN & DETAILS

Rev No1	Date	Description	Drawn by:
7.25.16		Moved door/wall in room 107	JFD
Rev. No.	Date	Description	Drawn by:

tla inc.
creative • design • solutions
400 US Route One, Suite A South
Falmouth, ME 04105
Tel: (207) 842-6260
Fax: (207) 842-6271
1 (800) 232-2253

Joe DiDonato
2124