

**80 EXCHANGE STREET**  
**PORTLAND, MAINE**  
 OFFICE RENOVATION



CONSULTANTS:

REVISIONS:		
No.	Name	Date
1	REV 1	1/5/18

**ISSUED FOR PERMITTING**

ISSUED: 11/01/17  
 PROJECT No: 1714  
 DRAWN BY: RIP  
 CHECKED BY:  
 SHEET TITLE:  
**FOURTH FLOOR REFLECTED CEILING PLAN**

**A114**

ELECTRICAL/LIGHTING SYMBOL LEGEND			
	SURFACE MOUNTED LIGHT FIXTURE		STROBE ONLY NOTIFICATION DEVICE
	RECESSED LIGHT FIXTURE		HORN/STROBE NOTIFICATION DEVICE
	WALL MOUNTED LIGHT FIXTURE		SMOKE DETECTOR
	EXHAUST FAN/LIGHT		EXIT SIGN
	4' SURFACE MOUNTED LIGHT FIXTURE		FIRE ALARM PULL STATION
	UNDER-CABINET LIGHT FIXTURE		EMERGENCY LIGHT
	PENDANT LIGHT FIXTURE		FIRE ALARM CONTROL PANEL
	WALL MOUNTED STRIP LIGHT		
	2X2 LED TROFFER		CHILLED BEAM DIFFUSER
	LED PENDANT STRIP LIGHT		

**GENERAL CEILING NOTES:**

- EXISTING SPRINKLER PIPES TO BE RELOCATED AS REQUIRED TO FIT ABOVE CEILING HEIGHTS SHOWN ON DRAWINGS. PROVIDE NEW DROPS TO CONCEALED HEADS IN NEW OPEN OFFICE AREAS. TYP. PROVIDE NEW DROPS TO PENDANT HEADS IN TOILET ROOMS AND STORAGE ROOMS. MODIFICATIONS TO SPRINKLER SYSTEM TO BE DESIGN-BUILD BY SPRINKLER SUB-CONTRACTOR TO MEET REQUIREMENTS OF NFPA 13.
- COORDINATE ALL CEILING HEIGHTS IN THE FIELD WITH STRUCTURAL CONDITIONS, MECHANICAL, ELECTRICAL AND PLUMBING TRADES.
- SEAL ALL PENETRATIONS IN RATED WALLS AND IN FLOOR AND CEILING ASSEMBLIES WITH FIRE-STOPPING TO REDUCE THE RISK OF THE SPREAD OF FIRE AND SMOKE.
- PROVIDE FIRE ALARM SYSTEM WITH SMOKE DETECTORS, PULL STATIONS AND NOTIFICATION DEVICES IN COMPLIANCE WITH NFPA 101 AND NFPA 72.
- CONTRACTOR OR ELECTRICAL ENGINEER SHALL EVALUATE POWER SUPPLY TO BUILDING TO DETERMINE IF UPGRADES OR MODIFICATIONS ARE REQUIRED TO ACCOMMODATE NEW ELECTRICAL EQUIPMENT LOADS.
- RELOCATE AND NEW DEVICES TO BE INSTALLED PER REQUIREMENTS OF APPLICABLE CODES AND REGULATIONS. VERIFY COMPLIANCE OF EXISTING DEVICES TO REMAIN PER SAID CODES AND REGULATIONS.
- MECHANICAL, PLUMBING, AND ELECTRICAL INSTALLATIONS TO BE PROVIDED PER APPLICABLE CODES. CONTRACTOR IS TO SEEK APPLICABLE PLUMBING AND ELECTRICAL PERMITS AS REQUIRED BY AUTHORITIES HAVING JURISDICTION. OWNER TO PROVIDE, GC TO COORDINATE.
- LIGHT FIXTURES TO BE LED LUMINAIRES AT 3500 KELVIN.

**CEILING TYPES:**

- GWB GYPSUM WALL BOARD
- GWB 1-HR TYPE-X GYPSUM WALL BOARD, 1-HOUR FIRE-RATED ASSEMBLY
- EX-GWB EXISTING GYPSUM WALL BOARD
- ACT-1 ARMSTRONG ULTIMA SHIPLAP ACOUSTICAL CEILING TILE
- ACT-2 ARMSTRONG METALWORKS LINEAR SUSPENDED CEILING

**LIGHT FIXTURE TYPES:**

- A AXIS, BEAM 3 LED - LINEAR FLUSH - LENGTH AS SHOWN
- B ALPHABET, LEDRA, NU3RDT - RECESSED LED WITH MUD-IN FLANGE
- C BRUCK SUSPENDED VIA TRACK WITH Z25 LED SPOT HEADS - LENGTH AS SHOWN
- D WALL SCONCE, TBD
- E WALL SCONCE, TBD
- F WALL SCONCE, TBD
- G RECESSED LED - RATED FOR WET LOCATION, TBD
- H EXTERIOR LED WALL PACK
- J EXTERIOR LED WALL PACK
- K ADD ALTERNATE #2 - ECOSENSE TROV EXTERIOR LINEAR LED 12"
- L 4' LED RECESSED DOWNLIGHT - TBD
- M LUCE & LIGHT, SMOOTHY 2, LED RECESSED DOWNLIGHT
- N LUCE & LIGHT, SPOT 1, EXTERIOR LED SIGN LIGHT

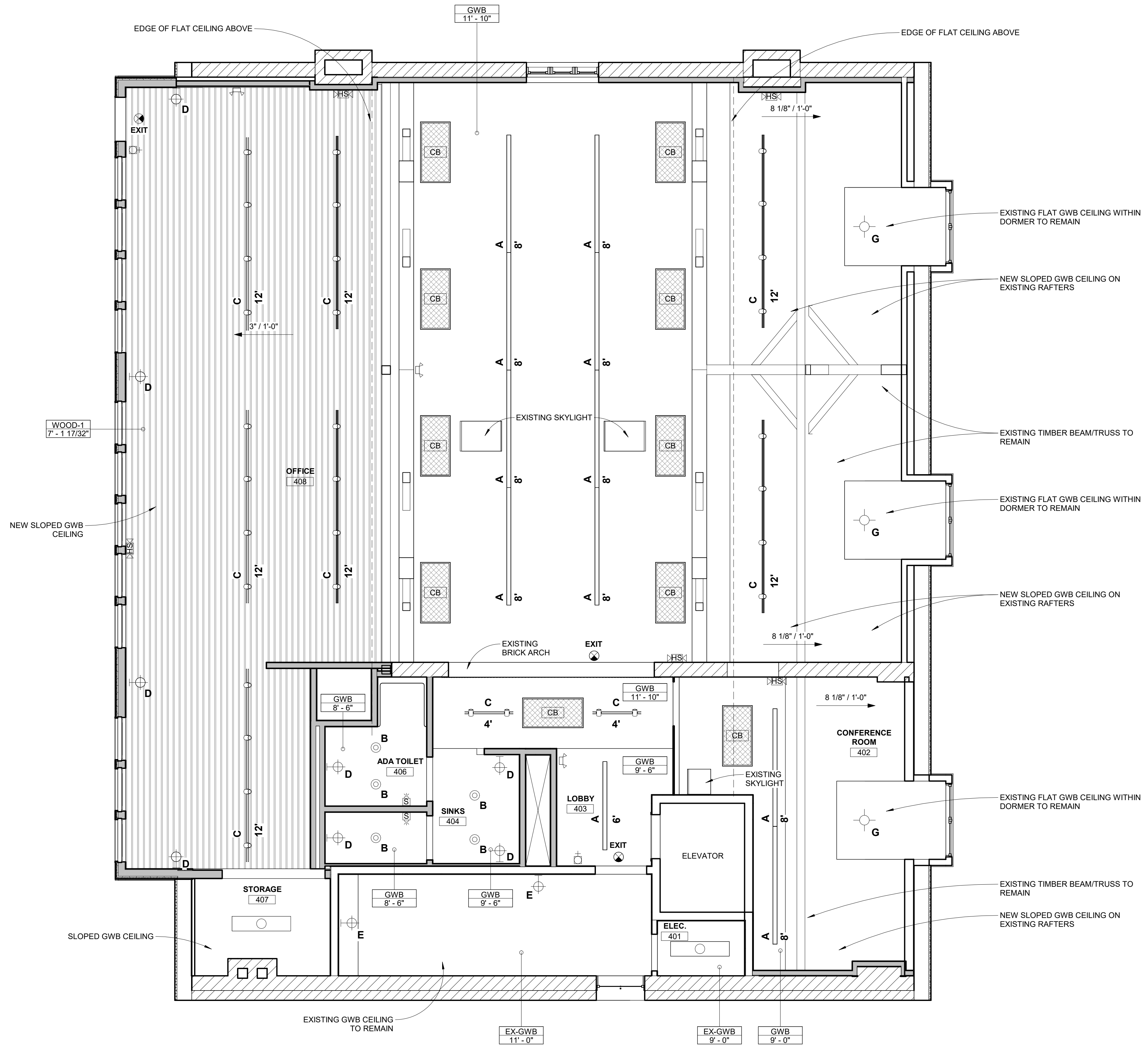

① FOURTH FLOOR REFLECTED CEILING PLAN  
 1/4" = 1'-0"