

80 EXCHANGE STREET
 PORTLAND, MAINE
 OFFICE RENOVATION



CONSULTANTS:

| REVISIONS: | | |
|------------|-------|--------|
| No. | Name | Date |
| 1 | REV 1 | 1/5/18 |

ISSUED FOR PERMITTING

ISSUED: 11/01/17
 PROJECT No: 1714
 DRAWN BY: RIP
 CHECKED BY:
 SHEET TITLE:
 SECOND FLOOR REFLECTED CEILING PLAN

A112

| ELECTRICAL/LIGHTING SYMBOL LEGEND | | | |
|-----------------------------------|----------------------------------|--|---------------------------------|
| | SURFACE MOUNTED LIGHT FIXTURE | | STROBE ONLY NOTIFICATION DEVICE |
| | RECESSED LIGHT FIXTURE | | HORN/STROBE NOTIFICATION DEVICE |
| | WALL MOUNTED LIGHT FIXTURE | | SMOKE DETECTOR |
| | EXHAUST FAN/LIGHT | | EXIT SIGN |
| | 4' SURFACE MOUNTED LIGHT FIXTURE | | FIRE ALARM PULL STATION |
| | UNDER-CABINET LIGHT FIXTURE | | EMERGENCY LIGHT |
| | PENDANT LIGHT FIXTURE | | FIRE ALARM CONTROL PANEL |
| | WALL MOUNTED STRIP LIGHT | | |
| | 2X2 LED TROFFER | | CHILLED BEAM DIFFUSER |
| | LED PENDANT STRIP LIGHT | | |

GENERAL CEILING NOTES:

- EXISTING SPRINKLER PIPES TO BE RELOCATED AS REQUIRED TO FIT ABOVE CEILING HEIGHTS SHOWN ON DRAWINGS. PROVIDE NEW DROPS TO CONCEALED HEADS IN NEW OPEN OFFICE AREAS, TYP. PROVIDE NEW DROPS TO PENDANT HEADS IN TOILET ROOMS AND STORAGE ROOMS. MODIFICATIONS TO SPRINKLER SYSTEM TO BE DESIGN-BUILD BY SPRINKLER SUB-CONTRACTOR TO MEET REQUIREMENTS OF NFPA 13.
- COORDINATE ALL CEILING HEIGHTS IN THE FIELD WITH STRUCTURAL CONDITIONS, MECHANICAL, ELECTRICAL AND PLUMBING TRADES.
- SEAL ALL PENETRATIONS IN RATED WALLS AND IN FLOOR AND CEILING ASSEMBLIES WITH FIRE-STOPPING TO REDUCE THE RISK OF THE SPREAD OF FIRE AND SMOKE.
- PROVIDE FIRE ALARM SYSTEM WITH SMOKE DETECTORS, PULL STATIONS AND NOTIFICATION DEVICES IN COMPLIANCE WITH NFPA 101 AND NFPA 72.
- CONTRACTOR OR ELECTRICAL ENGINEER SHALL EVALUATE POWER SUPPLY TO BUILDING TO DETERMINE IF UPGRADES OR MODIFICATIONS ARE REQUIRED TO ACCOMMODATE NEW ELECTRICAL EQUIPMENT LOADS.
- RELOCATED AND NEW DEVICES TO BE INSTALLED PER REQUIREMENTS OF APPLICABLE CODES AND REGULATIONS. VERIFY COMPLIANCE OF EXISTING DEVICES TO REMAIN PER SAID CODES AND REGULATIONS.
- MECHANICAL, PLUMBING, AND ELECTRICAL INSTALLATIONS TO BE PROVIDED PER APPLICABLE CODES. CONTRACTOR IS TO SEEK APPLICABLE PLUMBING AND ELECTRICAL PERMITS AS REQUIRED BY AUTHORITIES HAVING JURISDICTION. OWNER TO PROVIDE, GC TO COORDINATE.
- LIGHT FIXTURES TO BE LED LUMINAIRES AT 3500 KELVIN.

CEILING TYPES:

- GWB GYPSUM WALL BOARD
- GWB 1-HR TYPE-X GYPSUM WALL BOARD, 1-HOUR FIRE-RATED ASSEMBLY
- EX-GWB EXISTING GYPSUM WALL BOARD
- ACT-1 ARMSTRONG ULTIMA SHIPLAP ACOUSTICAL CEILING TILE
- ACT-2 ARMSTRONG METALWORKS LINEAR SUSPENDED CEILING

LIGHT FIXTURE TYPES:

- A AXIS, BEAM 3 LED - LINEAR FLUSH - LENGTH AS SHOWN
- B ALPHABET, LEDRA, NU3RDT - RECESSED LED WITH MUD-IN FLANGE
- C BRUCK SUSPENDED VIA TRACK WITH Z25 LED SPOT HEADS - LENGTH AS SHOWN
- D WALL SCENCE, TBD
- E WALL SCENCE, TBD
- F WALL SCENCE, TBD
- G RECESSED LED - RATED FOR WET LOCATION, TBD
- H EXTERIOR LED WALL PACK
- J EXTERIOR LED WALL PACK
- K **ADD ALTERNATE #2** - ECOSENSE TROV EXTERIOR LINEAR LED 12" 4" LED RECESSED DOWNLIGHT - TBD
- L LUCE & LIGHT, SMOOTHY 2, LED RECESSED DOWNLIGHT
- N LUCE & LIGHT, SPOT 1, EXTERIOR LED SIGN LIGHT

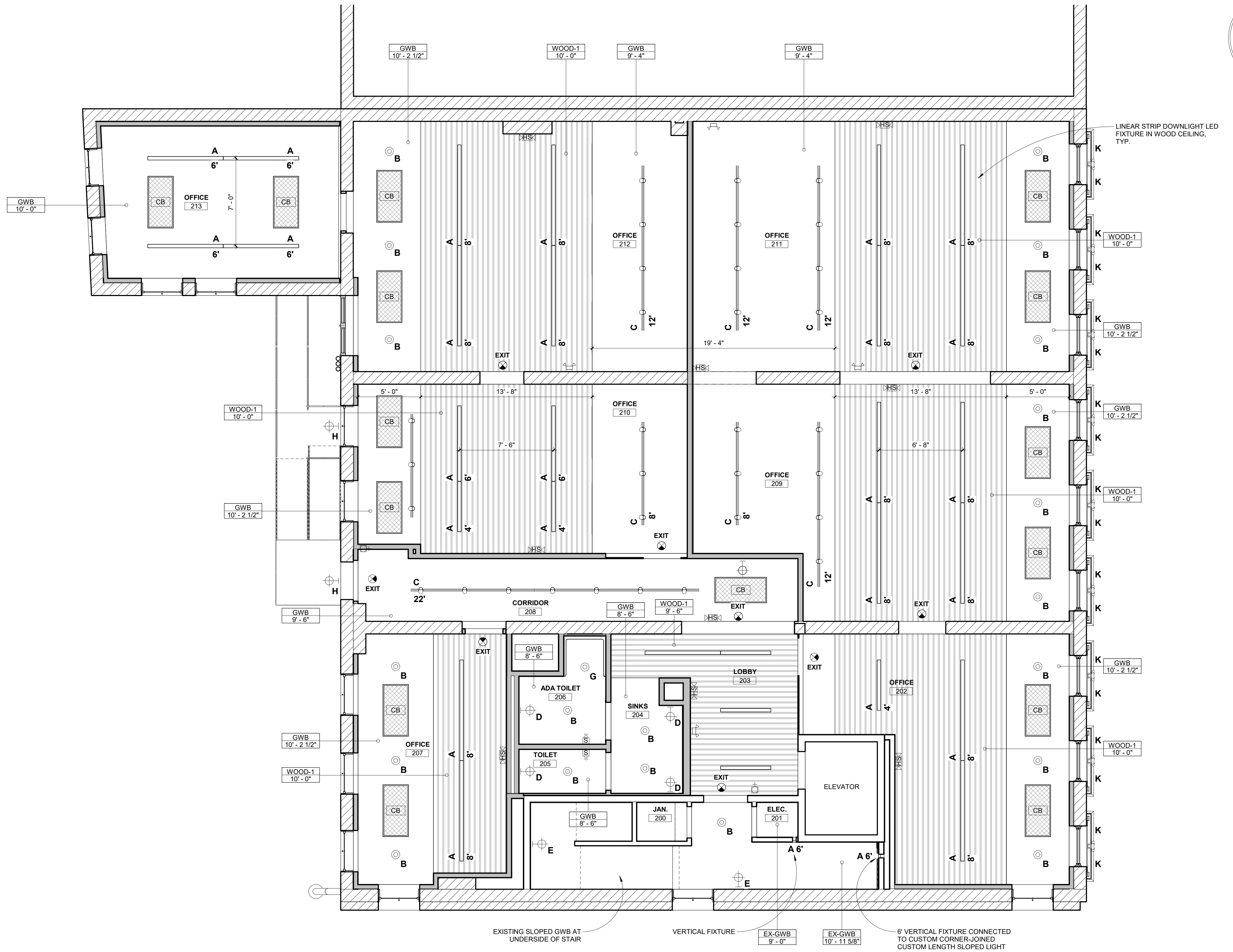

② SECOND FLOOR REFLECTED CEILING PLAN
 1/4" = 1'-0"