

**PERMIT ISSUED**

**City of Portland, Maine - Building or Use Permit Application**

389 Congress Street, 04101 Tel: (207) 874-8703, Fax: (207) 874-8716

Permit No: 03-0274	Issue Date: <b>APR 15 2003</b>	CBL: 032 H004001
-----------------------	-----------------------------------	---------------------

Location of Construction: 96 Federal St	Owner Name: City Of Portland	Owner Address: 389 Congress St <b>CITY OF PORTLAND</b>	Phone: 874-8300
Business Name:	Contractor Name:	Contractor Address:	Phone:
Lessee/Buyer's Name	Phone:	Permit Type: Outdoor Seating	Zone: <b>B3</b>

Past Use: Bagel Works, Inc/Restaurant	Proposed Use: Bagel Works, Inc/Restaurant	Permit Fee: \$75.00	Cost of Work: \$75.00	CEO District: 1
		FIRE DEPT: <input type="checkbox"/> Approved <input type="checkbox"/> Denied	INSPECTION: Use Group: <b>B</b> Type: <b>BOCA 99</b>	

**Proposed Project Description:**  
Outdoor Seating for 4 Tables and 16 Chairs for April 15-Sept. 30, 2003

Signature: \_\_\_\_\_  
Signature: 

**PEDESTRIAN ACTIVITIES DISTRICT (P.A.D.)**

Action:  Approved  Approved w/Conditions  Denied

Signature: \_\_\_\_\_ Date: \_\_\_\_\_

Permit Taken By: gad	Date Applied For: 04/02/2003	<b>Zoning Approval</b>	
-------------------------	---------------------------------	------------------------	--

<ol style="list-style-type: none"> <li>This permit application does not preclude the Applicant(s) from meeting applicable State and Federal Rules.</li> <li>Building permits do not include plumbing, septic or electrical work.</li> <li>Building permits are void if work is not started within six (6) months of the date of issuance. False information may invalidate a building permit and stop all work..</li> </ol>	<b>Special Zone or Reviews</b> <input type="checkbox"/> Shoreland <input type="checkbox"/> Wetland <input type="checkbox"/> Flood Zone <input type="checkbox"/> Subdivision <input type="checkbox"/> Site Plan  Maj <input type="checkbox"/> Minor <input type="checkbox"/> MM <input type="checkbox"/> Date: <b>OK/MS</b> <b>4/11/03</b>	<b>Zoning Appeal</b> <input type="checkbox"/> Variance <input type="checkbox"/> Miscellaneous <input type="checkbox"/> Conditional Use <input type="checkbox"/> Interpretation <input type="checkbox"/> Approved <input type="checkbox"/> Denied Date: _____	<b>Historic Preservation</b> <input type="checkbox"/> Not in District or Landmark <input type="checkbox"/> Does Not Require Review <input type="checkbox"/> Requires Review <input type="checkbox"/> Approved <input type="checkbox"/> Approved w/Conditions <input type="checkbox"/> Denied Date: _____
	<p align="center"><i>shall comply with all the given outdoor seating regulations</i></p>		

**CERTIFICATION**

I hereby certify that I am the owner of record of the named property, or that the proposed work is authorized by the owner of record and that I have been authorized by the owner to make this application as his authorized agent and I agree to conform to all applicable laws of this jurisdiction. In addition, if a permit for work described in the application is issued, I certify that the code official's authorized representative shall have the authority to enter all areas covered by such permit at any reasonable hour to enforce the provision of the code(s) applicable to such permit.

SIGNATURE OF APPLICANT	ADDRESS	DATE	PHONE
RESPONSIBLE PERSON IN CHARGE OF WORK, TITLE		DATE	PHONE

# DISPLAY THIS CARD ON PRINCIPAL FRONTAGE OF WORK CITY OF PORTLAND

Please Read Application And Notes, If Any, Attached

## BUILDING DEPARTMENT PERMIT

Permit Number: 030274

This is to certify that City Of Portland

has permission to Outdoor Seating for 4 Tables and 16 Chairs for April 15-September 2003

AT 96 Federal St / 15 Temple St. 032 H004001

provided that the person or persons, firm or corporation accepting this permit shall comply with all of the provisions of the Statutes of the State and of the Ordinances of the City of Portland regulating the construction, maintenance and use of buildings and structures, and of the application on file in this department.

Apply to Public Works for street line and grade if nature of work requires such information.

Notification of inspection must be given and when permission procured before this building or part thereof is started or closed-in. 24 HOUR NOTICE IS REQUIRED.

A certificate of occupancy must be procured by owner before this building or part thereof is occupied.

### OTHER REQUIRED APPROVALS

Fire Dept. **PERMIT ISSUED**

Health Dept. \_\_\_\_\_

Appeal Board **APR 15 2003**

Other \_\_\_\_\_  
Department Name

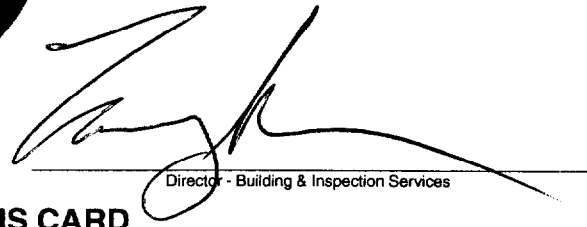

Director - Building & Inspection Services

**CITY OF PORTLAND**

**PENALTY FOR REMOVING THIS CARD**

03-0274

# Outdoor Seating Permit Application

If you or the property owner owes real estate or personal property taxes or user charges on any property within the City, payment arrangements must be made before permits of any kind are accepted.

Location/Address of Construction: 15 Temple St.

Total Square Footage of Proposed Structure \_\_\_\_\_ Square Footage of Lot 60' x 20'

Tax Assessor's Chart, Block & Lot Number Chart# <u>032</u> Block# <u>H</u> Lot# <u>004</u>	Owner: <u>Bangl Works INC.</u> <u>130 Main St.</u> <u>Keene NH</u>	Telephone#: <u>603-536-9787</u>
---	--	---------------------------------

Lessee/Buyer's Name (If Applicable) <input checked="" type="checkbox"/> <u>Pizzagalli INC.</u>	Owner's/Purchaser/Lessee Address: _____	Cost Of Work: \$ _____ Fee: <u>\$75.00</u>
--	---	--

Current use: restaurant  
 If the location is currently vacant, what was prior use: \_\_\_\_\_  
 Approximately how long has it been vacant: \_\_\_\_\_  
 Proposed use: restaurant w/ outside seating  
 Project description: outside seating  
 How many chairs 16 How many tables 4

Contractor's Name, Address & Telephone: \_\_\_\_\_  
 Applicants Name, Address & Telephone: \_\_\_\_\_  
 Who should we contact when the permit is ready: Terry Morrison - Manager  
 Telephone: 874-2425  
 If you would like the permit mailed, what mailing address should we use: 15 Temple St. Portland ME 04101

**IF THE REQUIRED INFORMATION IS NOT INCLUDED IN THE SUBMISSIONS THE PERMIT WILL BE AUTOMATICALLY DENIED.**

**AT THE DISCRETION OF THE BUILDING/PLANNING DEPARTMENT, WE MAY REQUIRE ADDITIONAL INFORMATION IN ORDER TO APPROVE THIS PERMIT.**

### Certification

I hereby certify that I am the Owner of record of the named property, or that the owner of record authorizes the proposed work and that I have been authorized by the owner to make this application as his/her authorized agent. I agree to conform to all applicable laws of this jurisdiction. In addition, if a permit for work described in this application is issued, I certify that the Code Official's authorized representative shall have the authority to enter all areas covered by this permit at any reasonable hour to enforce the provisions of the codes applicable to this permit.

Signature of applicant: 	Date: <u>4/15/03</u> 2003
---	---------------------------

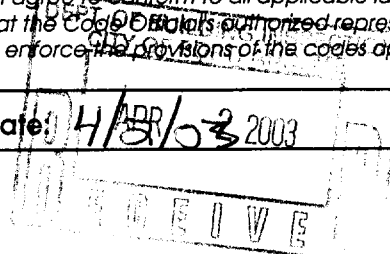



C/B/L: \_\_\_\_\_

## CONDITIONS FOR SIDEWALK OCCUPANCY PERMIT

Written consent and agreement relating to occupancy of the City of Portland sidewalk in the front, side, and or rear of the building at the stated location: 15 Temple St; in Portland, Maine, by the owner of the establishment being: Bagel Works Inc, doing business as: Cafe, hereby, to the fullest extent permitted by law, shall defend, indemnify and hold harmless the City of Portland, its officers and employees, from and against all claims, damages, losses and expenses, just or unjust, including, but not limited to costs of defense and attorney's fees, arising out of the establishment's occupancy of the sidewalk, provided that any such claims, damage, loss or expense (1) is attributable to bodily injury, sickness, disease, or death, or to injury to or destruction of tangible property including the loss of use therefrom, and (2) is caused in whole or in part by any negligent act or omission of the establishment, anyone directly or indirectly employed by it, or anyone for whose act it may be liable.

Signed and acknowledged: [Signature]  
Establishment owner

Date: 4/2/03

Date:

5/22/01

60

Front of Store

Window

Window

Window

Window

Window

60' x 20'

20'

Sidewalk

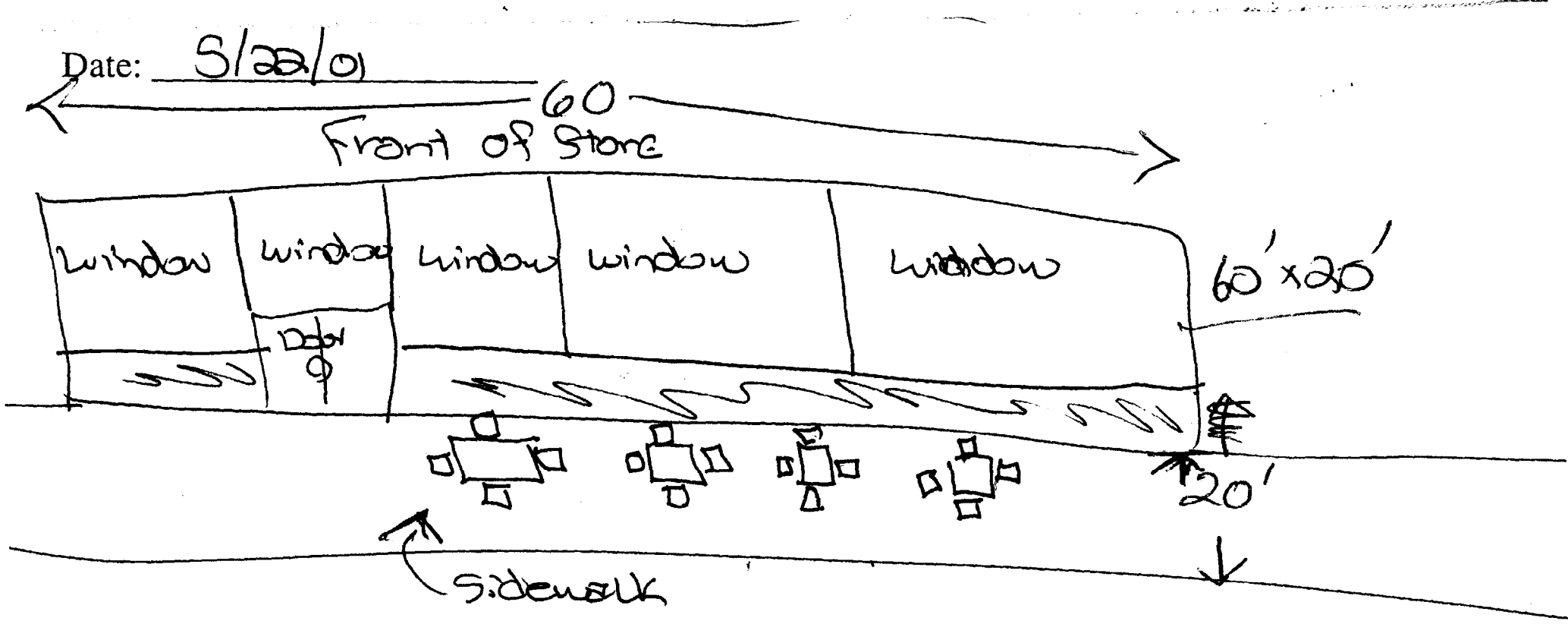

389 Congress St Portland, Maine 04101 (207) 874-8700 FAX 874-8716 TTY 874-8936



## CITY OF PORTLAND

### OUTSIDE DINING ON PRIVATE AND/OR CITY PROPERTY

Permits are required for expanding eating facilities (tables and chairs) to the outside whether it is on private and/or City Property. The fee is based on the cost of work (which in most cases would be less than \$1,000 or a fee of \$75.00). The permit after obtained is covered from April 15<sup>th</sup> thru September 30<sup>th</sup> of that same year. **This is a permit that you must renew every year prior to commencing the activity.**

The following will have to be included as part of your submissions. Please note that you will also fill out a standard building permit. We have deleted many of the unnecessary requirements that are related to a structural building permit hoping to make the process easier for the applicant.

A plot plan showing the following:

- A drawing of the lot and where the building sits on the lot along with the lot and building dimensions
- Show the dimensional setback from the sidewalk to the building
- The location of the street, and if it's a corner lot intersecting streets
- Show the sidewalk on the drawing along with its width and location of curbing
- Show the location of the table and chair placement

The tables and chairs shall be placed on the sidewalk in such a manner as to allow the free and safe passage of pedestrian traffic. If the placement of the tables and chairs creates a public safety hazard, the establishment shall comply with the request of the Municipality to relocate the chairs and tables to a more suitable location.

The establishment shall keep the sidewalk area where the tables and chairs are located neat and free from litter and debris.

The establishment shall produce and maintain public liability insurance coverage in an amount of not less than three hundred thousand (\$300,000) combine single limit for bodily injury, death and property damage. The City will be named as an additional insured thereon if the chairs and tables on City property.

**No food shall be prepared outside.** If alcohol is to be served, we need to be notified. State law requires that the area be segregated from the rest of the public. **Please contact the Licensing Department at 207-874-8557 before you commence any serving of alcohol outside.**

If the establishment is to be on City Property an indemnifying statement shall be signed by the establishment (owner). Please read the attached and sign.