

General Notes

This document and all drawings, specifications, data, design concepts, workflow processes, implementation strategies, configurations and other information contained herein are the property of Securadyme Systems. Securadyme Systems does not convey any rights to the recipient, and all reproduction or distribution of this document or its contents, except as necessary for the specific purpose contained within manufacturing, profile or scale, or realization by contractors other than Securadyme Systems. Any unauthorized use or disclosure without the prior written permission of Securadyme Systems is strictly prohibited.

LEGEND

- HEAT DETECTOR RATE OF RISE
- SMOKE DETECTOR PHOTO
- DUAL ACTION PULL STATION
- RELAY MODULE
- MONITOR MODULE
- STROBE
- HORN STROBE

FBO= FURNISHED BY OTHERS

WIRE TYPES

- A 2 COND. FPL SEE NOTES FOR AWG
- B 2 COND. #14 AWG FPL
- D 4 COND. #18 AWG FPL
- E CAT 3.5 OR 6 FOR TELCO

FIRE ALARM RISER SUBMITTAL

NO.	DATE	DESCRIPTION
REVISIONS		



NE Reg. Wilmington, MA Office
 101 Reg. St. 303-524-2516
 101 Reg. St. 303-524-2516
 Fax: 378-688-9119

NE Reg. Portland, ME Office
 100 Commercial Ave. 207-858-2827
 100 Commercial Ave. 207-858-2827
 Fax: 207-858-9044

**106 EXCHANGE ST.
 PORTLAND, ME. 04101**

FIRE ALARM RISER

Date	05/14/2014	Drawing Scale	None
Drawn By	ZAD	SSL Rep	Sam Martin
Email Address	sam.martin@securadyme.com		
Securadyme File Name	106 Exchange St.		
Securadyme Quote/Proj. No.	942408	Sheet	1 OF 1

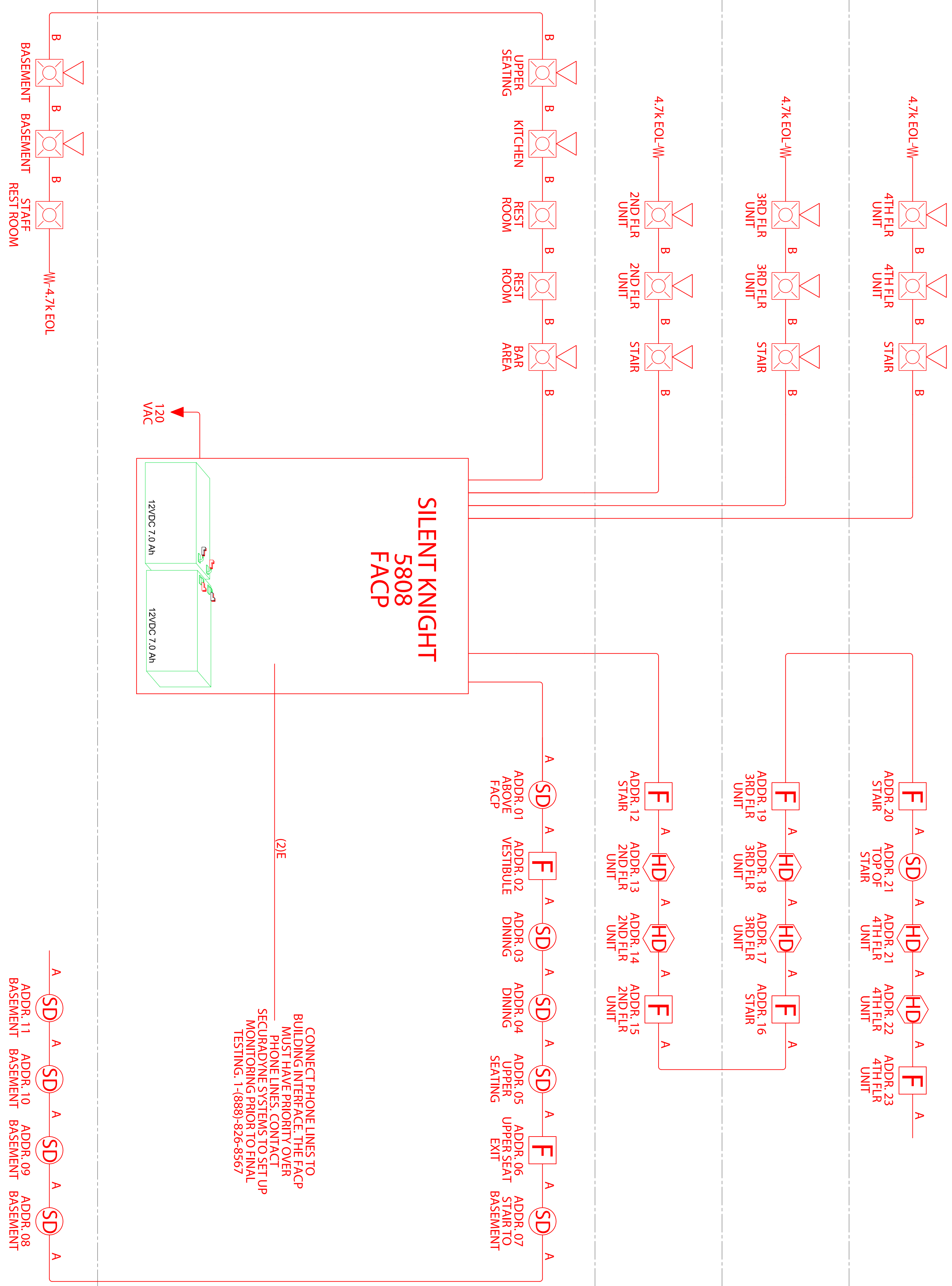

NOTES

- 1) SIC WIRE LENGTHS:
 #16 AWG UP TO 4900'
 #14 AWG UP TO 7900'
 #12 AWG UP TO 10,000'
- 2) SOUNDER BASES REQUIRE 24VDC POWER
- 3) DO NOT ENTER ANY PANEL FROM THE BOTTOM.

BASEMENT

FIRST FLOOR

SECOND FLOOR

THIRD FLOOR

FOURTH FLOOR

A

B

C

D

E

F

A

B

C

D

E

F