

May 16, 2014 submission for permit

Kepware Technologies
2nd and 4th floor Tenant Improvements
400 Congress Street, Portland, Maine 04101
Contractor/Owner: A&W Partners,
120 Exchange Street Portland ME
CBL: 032 G001001, B3 Zoning District

Area of Work Reference Plans
2nd and 4th Floor

ref 1

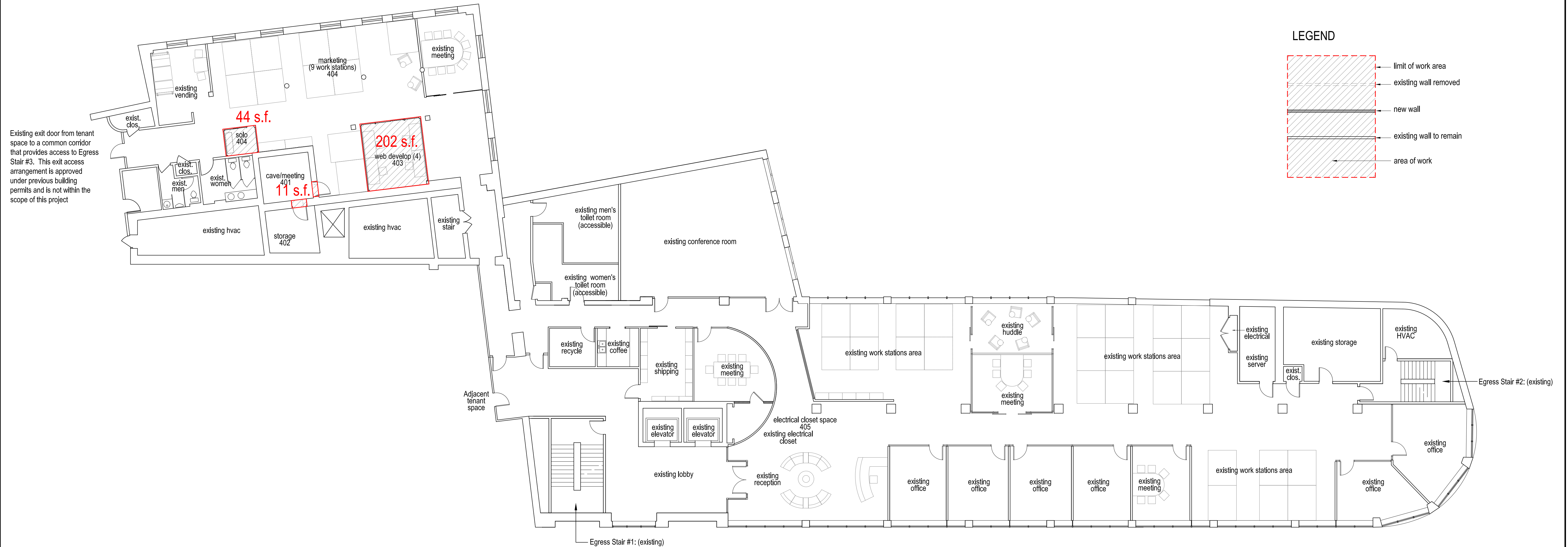

LEGEND

- limit of work area
- existing wall removed
- new wall
- existing wall to remain
- area of work

Existing exit door from tenant space to a common corridor that provides access to Egress Stair #3. This exit access arrangement is approved under previous building permits and is not within the scope of this project

24th Floor Plan Area of Work
3/32" = 1'-0"

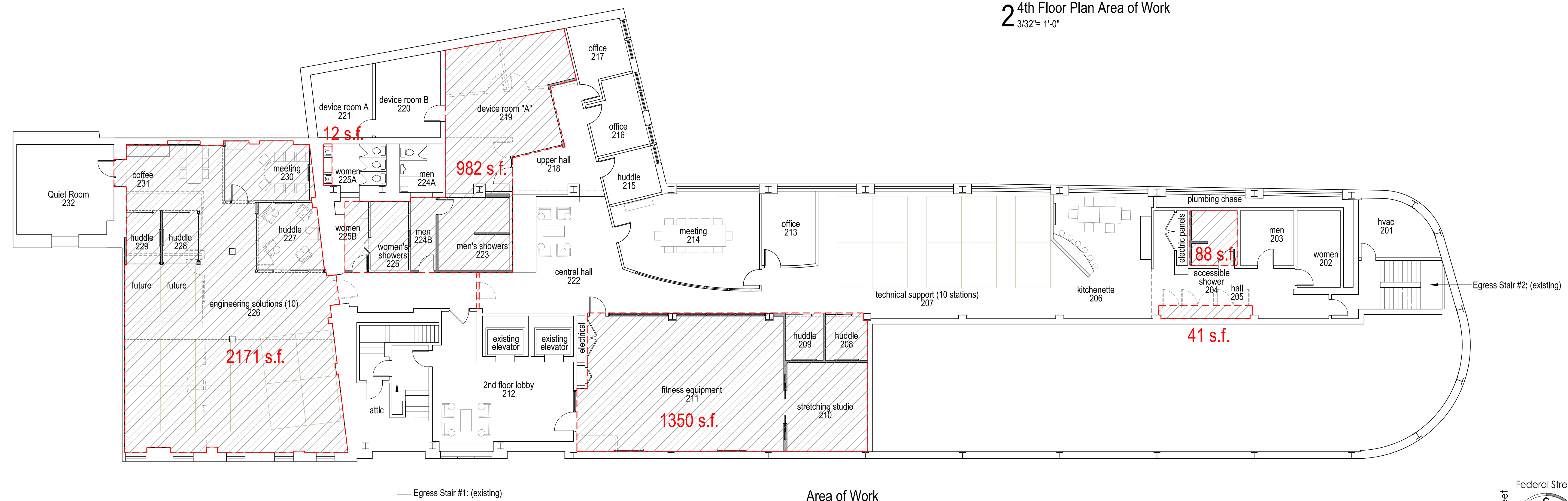

Area of Work

2nd floor	4645 s.f.
4th floor	257 s.f.
total area	4902 s.f.

1 2nd Floor Plan Area of Work
3/32" = 1'-0"

