

City of Portland, Maine - Building or Use Permit Application
 389 Congress Street, 04101 Tel: (207) 874-8703, Fax: (207) 874-8716

Permit No: 01-0685	Issue Date: 2 2001	CBL: 032 F009001
------------------------------	------------------------------	----------------------------

Location of Construction: 30 Milk St	Owner Name: Ocean Block Associates	Owner Address: 30 Market St Portland, ME	Phone: 207-774-1000
Business Name: Homeware Studio	Contractor Name: no contractor/self	Contractor Address: n/a n/a	Phone:
Lessee/Buyer's Name: Homeware Studio	Phone: n/a	Permit Type: Signs - Permanent	Zone: B-3

Past Use: Commercial / Retail	Proposed Use: Same: Signage Permit. Call Leslie at 879-9793 when ready.	Permit Fee:	Cost of Work: \$0.00	CEO District: 1
---	---	--------------------	--------------------------------	---------------------------

Proposed Project Description: Erect a 6 SqFt Wall Sign.	FIRE DEPT: <input type="checkbox"/> Approved <input type="checkbox"/> Denied	INSPECTION: Use Group: 5192094 BCC PERMIT ISSUED WITH REQUIREMENTS 1/19/07
	Signature:	Signature:
	PEDESTRIAN ACTIVITIES DISTRICT (P.A.D.):	
	Action: <input checked="" type="checkbox"/> Approved <input type="checkbox"/> Approved w/Conditions <input type="checkbox"/> Denied	
	Signature: DA	Date: 8/20/07

Permit Taken By: cjh	Date Applied For: 06/12/2001	Zoning Approval	
--------------------------------	--	------------------------	--

1. This permit application does not preclude the Applicant(s) from meeting applicable State and Federal Rules. 2. Building permits do not include plumbing, septic or electrical work. 3. Building permits are void if work is not started within six (6) months of the date of issuance. False information may invalidate a building permit and stop all work..	Special Zone or Reviews <input type="checkbox"/> Shoreland <input type="checkbox"/> Wetland <input type="checkbox"/> Flood Zone <input type="checkbox"/> Subdivision <input type="checkbox"/> Site Plan Maj <input type="checkbox"/> Minor <input type="checkbox"/> MM <input type="checkbox"/> Date: 6/14/07	Zoning Appeal <input type="checkbox"/> Variance <input type="checkbox"/> Miscellaneous <input type="checkbox"/> Conditional Use <input type="checkbox"/> Interpretation <input type="checkbox"/> Approved <input type="checkbox"/> Denied Date:	Historic Preservation <input type="checkbox"/> Not in District or Landmark <input type="checkbox"/> Does Not Require Review <input type="checkbox"/> Requires Review <input checked="" type="checkbox"/> Approved <input type="checkbox"/> Approved w/Conditions <input type="checkbox"/> Denied Date: 6/14/07
	MA 8/20/07 PERMIT ISSUED WITH REQUIREMENTS		

CERTIFICATION

I hereby certify that I am the owner of record of the named property, or that the proposed work is authorized by the owner of record and that I have been authorized by the owner to make this application as his authorized agent and I agree to conform to all applicable laws of this jurisdiction. In addition, if a permit for work described in the application is issued, I certify that the code official's authorized representative shall have the authority to enter all areas covered by such permit at any reasonable hour to enforce the provision of the code(s) applicable to such permit.

SIGNATURE OF APPLICANT	ADDRESS	DATE	PHONE
RESPONSIBLE PERSON IN CHARGE OF WORK, TITLE		DATE	PHONE

THIS IS NOT A PERMIT/CONSTRUCTION MAY NOT COMMENCE UNTIL THE PERMIT IS ISSUED

SIGNAGE APPLICATION

THIS IS NOT A PERMIT
CONSTRUCTION CANNOT NOT COMMENCE UNTIL THE PERMIT IS ISSUED

In the interest of processing your application in the quickest possible manner, please complete the Information below for a Building or Use Permit.

If you or the property owner owes real estate or personal property taxes or user charges on any property within the City, payment arrangements must be made before permits of any kind are accepted.

Location/Address of Construction: 26 Milk Street		
Total Square Footage of Proposed Structure	Square Footage of Lot	
Tax Assessor's Chart, Block & Lot Number Chart# 032 Block# F Lot# 009	Owner: Ocean Block Associates	Telephone #: 774-1000
Lessee/Buyer's Name (If Applicable) Homeware Studio	Owner's/Purchaser/Lessee Address: Leslie Vlachos 506 Chandler's Wharf Portland, Maine	Total s.f of signs $6 \frac{SF}{x}$.20 \$ 1.20, plus \$30.00 TOTALS \$ 31.20
Current use: retail	Proposed use: retail	
Project description: decorative hardware & bath accessories		
Applicants Name, Address & Telephone: ^{Mailed} X	Leslie Vlachos 506 Chandler's Wharf Portland, Maine (207) 879-9793	
Contractor's Name, Address & Telephone:	Leslie Vlachos	
Who shall we contact when the permit is ready: Telephone:	Leslie Vlachos	
If you would like it mailed, what mailing address should we use: Same as above		
		Rec'd By: CA 6/12

**THIS IS NOT A PERMIT/CONSTRUCTION MAY NOT COMMENCE UNTIL THE
PERMIT IS ISSUED**

If the property is located in a HISTORIC DISTRICT, a separate sketch is required indicating the design, dimensions, construction materials and source of illumination if any. A photograph of the building façade should be submitted, showing where each sign is to be installed.

Certification

I hereby certify that I am the Owner of record of the named property, or that the owner of record authorizes the proposed work and that I have been authorized by the owner to make this application as his/her authorized agent. I agree to conform to all applicable laws of this jurisdiction. In addition, if a permit for work described in this application is issued, I certify that the Code Official's authorized representative shall have the authority to enter all areas covered by this permit at any reasonable hour to enforce the provisions of the codes applicable to this permit.

Signature of applicant: 	Date: 6.11.01
---	---------------

Sign Permit Fee: \$30.00 plus \$0.20 per square foot.

A building permit is also required for any awning based on cost of work-\$30.00 for the first \$1,000.00 and \$6.00 for each additional \$1,000.00

**BY FILLING OUT THIS APPLICATION IS DOES NOT MEET THAT
YOU WILL BE APPROVED FOR THE AMOUNT OF SIGNAGE YOU
ARE APPLYING FOR**

**IT IS SUGGESTED THAT YOU DO NOT ORDER ANY SIGNAGE UNTIL
YOU HAVE RECEIVED YOUR SIGN PERMIT THAT HAS BEEN
SIGNED BY THE BUILDING, ZONING AND POSSIBLE HISTORICAL
OFFICIALS OF THIS OFFICE**

**THIS IS NOT A PERMIT/CONSTRUCTION MAY NOT COMMENCE UNTIL THE
PERMIT IS ISSUED**

Please check off the following indicating that you have included the below items to expedite the process of this sign application:

- "Certification of Liability" listing the City additionally insured if any portion of the sign abuts or encroaches on the public right of way, or can fall into the public right of way
- Letter of permission from the owner

A sketch plan indicating the following:

- Drawing of the property showing all dimensions of the lot
 - Location of all buildings and property setbacks from all buildings
 - Driveways and abutting streets showing street frontage and any right of ways
 - Indicate on drawing the dimensions of all buildings on the lot
 - Define in footage the frontage of your business front
 - Indicate on drawing of existing signage and dimensions of each sign
 - Indicate on drawing all proposed signage and dimension of each sign
 - Sign area height and setback of each existing and proposed freestanding sign
- Certification of flammability required for awning/canopy at time of application
- UL # required for lighted signs at the time of Final Inspection. Failure to provide this information will invalidate the Sign Permit.

The Provisions of Section 3102.0 of the City's Building Code "The BOCA National Building Code 1999 edition" shall govern the construction, alteration, repair and maintenance of outdoor signs together with the associated appurtenant and auxiliary devices in respect to structural and fire safety. In accordance to section 3102.4.4 of BOCA construction documents and owners consent is all follows; "Before any permit is issued for the erection of a sign, Construction Documents shall be filed with the code official showing the dimensions, materials and required details of construction, including loads, stresses and anchorage. The applications shall be accompanied by the written contract of the owner or lessees of the premises upon which the sign is to erected. **NO PERMIT CAN OR WILL BE ISSUED UNLESS THIS INFORMATION IS SUBMITTED AND APPROVED BY THE INSPECTIONS OFFICE.**

ELECTRICAL SIGNAGE PERMITS/RESPONSIBILITIES

All sign companies or any persons engaged in the installation, interchange or maintenance of signage in the City of Portland must have the Electrician or Electrical Contractor who provided power to the sign(s) or associated equipment apply for an electrical permit in the Inspections Office.

It is the responsibility of your company to contact your sub-contractor or the owner to inform them of this policy. Whether your company does the final connections, which requires a valid Maine Electricians License or your sub contractor provides this service; permits and inspections shall be required.

Failure to comply with this procedure may result in the denial of sign permits by this office for your company or its representation to install or interchange any future signage in the City of Portland.

SIGNAGE PRE-APPLICATION

PLEASE ANSWER ALL QUESTIONS

ADDRESS: 26 Milk Street Portland ZONE: b-3

OWNER: Ocean Block Associates

APPLICANT: Vlachos + Company LLC d/b/a Homeware Studio

ASSESSOR NO. _____

SINGLE TENANT LOT? YES ___ NO ___

MULTI TENANT LOT? YES ___ NO ___

FREESTANDING SIGN? YES NO ___ DIMENSIONS ~~24" x 36"~~

(ex. pole sign. . .)

MORE THAN ONE SIGN? YES ___ NO ___ DIMENSIONS _____

BLDG. WALL SIGN? YES NO ___ DIMENSIONS 30" x 42"

(attached to bldg)

MORE THAN ONE SIGN? YES ___ NO ___ DIMENSIONS _____

LIST ALL EXISTING SIGNAGE AND THEIR DIMENSIONS: NONE

LOT FRONTAGE (FEET): _____

BLDG FRONTAGE (FEET): _____

AWNING YES ___ NO ___ IS AWNING BACKLIT? YES ___ NO ___

HEIGHT OF AWNING: _____

IS THERE ANY COMMUNICATION, MESSAGE, TRADEMARK OR SYMBOL ON IT? _____

*** TENANT BLDG. FRONTAGE (IN FEET) 19' x 22' 38"

*** REQUIRED INFORMATION

AREA FOR COMPUTATION

A SITE SKETCH AND BUILDING SKETCH SHOWING EXACTLY WHERE EXISTING AND NEW SIGNAGE IS LOCATED MUST BE PROVIDED. SKETCHES AND/OR PICTURES OF PROPOSED ARE ALSO REQUIRED.

SIGNATURE OF APPLICANT: Levi L. Vlachos for Homeware Studio DATE: _____

Handwritten notes and calculations:
 $1260 \div 144 = 8.75$
OK
8.75

BUILDING PERMIT REPORT

DATE: 13 June 2001 ADDRESS: 30 MILK ST. CBL: 032-F-669

REASON FOR PERMIT: Signage

BUILDING OWNER: Ocean Block Assoc.

PERMIT APPLICANT: /CONTRACTOR SAO.

USE GROUP: CONSTRUCTION TYPE: CONSTRUCTION COST: PERMIT FEES: 3120

The City's Adopted Building Code (The BOCA National Building Code/1999 with City Amendments)
The City's Adopted Mechanical Code (The BOCA National Mechanical Code/1993)

CONDITION(S) OF APPROVAL

This permit is being issued with the understanding that the following conditions shall be met: 1 37

- 1. This permit does not excuse the applicant from meeting applicable State and Federal rules and laws.
2. Before concrete for foundation is placed, approvals from the Development Review Coordinator and Inspection Services must be obtained.
3. Foundation drain shall be placed around the perimeter of a foundation that consists of gravel or crushed stone containing not more than 10 percent material that passes through a No. 4 sieve.
4. Foundations anchors shall be a minimum of 1/2" in diameter, 7" into the foundation wall, minimum of 12" from corners of foundation and a maximum 6' O.C. between bolts.
5. Waterproofing and dampproofing shall be done in accordance with Section 1813.0 of the building code.
6. Precaution must be taken to protect concrete and masonry.
7. It is strongly recommended that a registered land surveyor check all foundation forms before concrete is placed.
8. Private garages located beneath habitable rooms in occupancies in Use Group R-1, R-2, R-3 or I-1 shall be separated from adjacent interior spaces by fire partitions and floor/ceiling assembly which are constructed with not less than 1-hour fire resisting rating.
9. All chimneys and vents shall be installed and maintained as per Chapter 12 of the City's Mechanical Code.
10. Sound transmission control in residential building shall be done in accordance with Chapter 12, Section 1214.0 of the City's Building Code.
11. Guardrails & Handrails: A guardrail system is a system of building components located near the open sides of elevated walking surfaces for the purpose of minimizing the possibility of an accidental fall from the walking surface to the lower level.
12. Headroom in habitable space is a minimum of 7'6".
13. Stair construction in Use Group R-3 & R-4 is a minimum of 10" tread and 7 1/2" maximum rise.
14. The minimum headroom in all parts of a stairway shall not be less than 80 inches.
15. The Minimum required width of a corridor shall be determined by the most restrictive of the criteria under section 1011.3 but not less than 36".
16. Every sleeping room below the fourth story in buildings of Use Groups R and I-1 shall have at least one operable window or exterior door approved for emergency egress or rescue.
17. Each apartment shall have access to two (2) separate, remote and approved means of egress.
18. All vertical openings shall be enclosed with construction having a fire rating of at least one (1) hour, including fire doors with self closure's.
19. The boiler shall be protected by enclosing with (1) hour fire rated construction including fire doors and ceiling, or by providing automatic extinguishment.

6/12

20. All single and multiple station smoke detectors shall be of an approved type and shall be installed in accordance with the provisions of the City's Building Code Chapter 9, Section 920.3.2 (BOCA National Building Code/1999), and NFPA 101 Chapter 18 & 19. (Smoke detectors shall be installed and maintained at the following locations):
 - In the immediate vicinity of bedrooms
 - In all bedrooms
 - In each story within a dwelling unit, including basements
21. A portable fire extinguisher shall be located as per NFPA #10. They shall bear the label of an approved agency and be of an approved type. (Section 921.0)
22. The Fire Alarm System shall be installed and maintained to NFPA #72 Standard.
23. The Sprinkler System shall be installed and maintained to NFPA #13 Standard.
24. All exit signs, lights and means of egress lighting shall be done in accordance with Chapter 10 Section & Subsections 1023.0 & 1024.0 of the City's Building Code. (The BOCA National Building Code/1999)
25. Section 25 – 135 of the Municipal Code for the City of Portland states, "No person or utility shall be granted a permit to excavate or open any street or sidewalk from the time of November 15 of each year to April 15 of the following year".
26. The builder of a facility to which Section 4594-C of the Maine State Human Rights Act Title 5 MRSA refers, shall obtain a certification from a design professional that the plans commencing construction of the facility, the builder shall submit the certification the Division of Inspection Services.
27. Ventilation and access shall meet the requirements of Chapter 12 Sections 1210.0 and 1211.0 of the City's Building Code. (Crawl spaces & attics).
28. All electrical, plumbing and HVAC permits must be obtained by Master Licensed holders of their trade. **No closing in of walls until all electrical (min. 72 hours notice) and plumbing inspections have been done.**
29. All requirements must be met before a final Certificate of Occupancy is issued.
30. All building elements shall meet the fastening schedule as per Table 2305.2 of the City's Building Code (The BOCA National Building Code/1996).
31. Ventilation of spaces within a building shall be done in accordance with the City's Mechanical code (The BOCA National Mechanical Code/1993). (Chapter M-16)
32. Please read and implement the attached Land Use Zoning report requirements.
33. Boring, cutting and notching shall be done in accordance with Sections 2305.3, 2305.3.1, 2305.4.4 and 2305.5.1 of the City's Building Code.
34. Bridging shall comply with Section 2305.16.
35. Glass and glazing shall meet the requirements of Chapter 24 of the building code. (Safety Glazing Section 2406.0)
36. All flashing shall comply with Section 1406.3.10.
- #37. All signage shall be done in accordance with Section 3102.0 signs of the City's Building Code, (The BOCA National Building Code/1999).

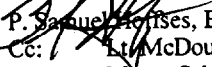
 P. Samuel, Building Inspector
 Lt. McDougall, PFD
 Marge Schmuckal, Zoning Administrator
 Michael Nugent, Inspection Service Manager

PSH 10/1/00

****This permit is herewith issued, on the basis of plans submitted and conditions placed on these plans, any deviations shall require a separate approval.**

*****THIS PERMIT HAS BEEN ISSUED WITH THE UNDERSTANDING THAT ALL THE CONDITIONS OF THE APPROVAL SHALL BE COMPLETED. THEREFORE, BEFORE THE WORK IS COMPLETED A REVISED PLAN OR STATEMENT FROM THE PERMIT HOLDER SHALL BE SUBMITTED TO THIS OFFICE SHOWING OR EXPLAINING THAT THE CONDITIONS HAVE BEEN MET. IF THIS REQUIREMENT IS NOT RECEIVED YOUR CERTIFICATE OF OCCUPANCY SHALL BE WITHHELD. (You Shall Call for Inspections)**

******ALL PLANS THAT REQUIRE A PROFESSIONAL DESIGNER'S SEAL, (AS PER SECTION 114.0 OF THE BUILDING CODE) SHALL ALSO BE PRESENTED TO THIS DIVISION ON AUTO CAD LT. 2000, DXF FORMAT OR EQUIVALENT.**

*******CERTIFICATE OF OCCUPANCY FEE \$50.00**

**OCEAN BLOCK ASSOCIATES
42 MARKET STREET
PORTLAND, ME 04101-5022
(207) 774-1000**

June 7, 2001

City of Portland and
The Historic Preservation Committee
Portland, Maine

Dear Sirs:

I have reviewed signage plans for the Homeware Studio store located at 26 Milk Street and give permission to hang the signs as shown on the attached to the building.

I can be reached at the above number if necessary. Thank you for your assistance.

Sincerely,

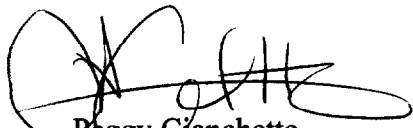
A handwritten signature in black ink, appearing to read 'Peggy Cianchette', written over a horizontal line.

Peggy Cianchette
Property Manager

ACORD CERTIFICATE OF LIABILITY INSURANCE		DATE (MM/DD/YY) 06/05/2001
PRODUCER (207)781-2784 FAX Desmond & Payne 366 US Route 1 Falmouth, ME 04105	THIS CERTIFICATE IS ISSUED AS A MATTER OF INFORMATION ONLY AND CONFERS NO RIGHTS UPON THE CERTIFICATE HOLDER. THIS CERTIFICATE DOES NOT AMEND, EXTEND OR ALTER THE COVERAGE AFFORDED BY THE POLICIES BELOW.	
INSURERS AFFORDING COVERAGE		
INSURED Homeware Studio LLC 506 Chandlers Wharf Portland, ME 04101	INSURER A: Zurich Insurance Company	
	INSURER B:	
	INSURER C:	
	INSURER D:	
	INSURER E:	

COVERAGES

THE POLICIES OF INSURANCE LISTED BELOW HAVE BEEN ISSUED TO THE INSURED NAMED ABOVE FOR THE POLICY PERIOD INDICATED. NOTWITHSTANDING ANY REQUIREMENT, TERM OR CONDITION OF ANY CONTRACT OR OTHER DOCUMENT WITH RESPECT TO WHICH THIS CERTIFICATE MAY BE ISSUED OR MAY PERTAIN, THE INSURANCE AFFORDED BY THE POLICIES DESCRIBED HEREIN IS SUBJECT TO ALL THE TERMS, EXCLUSIONS AND CONDITIONS OF SUCH POLICIES. AGGREGATE LIMITS SHOWN MAY HAVE BEEN REDUCED BY PAID CLAIMS.

LINE	TYPE OF INSURANCE	POLICY NUMBER	POLICY EFFECTIVE DATE (MM/DD/YY)	POLICY EXPIRATION DATE (MM/DD/YY)	LIMITS
A	<input checked="" type="checkbox"/> GENERAL LIABILITY <input checked="" type="checkbox"/> COMMERCIAL GENERAL LIABILITY <input type="checkbox"/> CLAIMS MADE <input checked="" type="checkbox"/> OCCUR GEN'L AGGREGATE LIMIT APPLIES PER: <input checked="" type="checkbox"/> POLICY <input type="checkbox"/> PROJECT <input type="checkbox"/> LOC	PAS37928323	02/25/2001	02/25/2002	EACH OCCURRENCE \$ 1,000,000 FIRE DAMAGE (Any one fire) \$ 1,000,000 MED EXP (Any one person) \$ 10,000 PERSONAL & ADV INJURY \$ 1,000,000 GENERAL AGGREGATE \$ 2,000,000 PRODUCTS - COMPROP AGG \$ 2,000,000
	<input type="checkbox"/> AUTOMOBILE LIABILITY <input type="checkbox"/> ANY AUTO <input type="checkbox"/> ALL OWNED AUTOS <input type="checkbox"/> SCHEDULED AUTOS <input type="checkbox"/> HIRED AUTOS <input type="checkbox"/> NON-OWNED AUTOS				COMBINED SINGLE LIMIT (Ea accident) \$ BODILY INJURY (Per person) \$ BODILY INJURY (Per accident) \$ PROPERTY DAMAGE (Per accident) \$
	<input type="checkbox"/> GARAGE LIABILITY <input type="checkbox"/> ANY AUTO				AUTO ONLY - EA ACCIDENT \$ OTHER THAN AUTO ONLY EA ACC \$ AGG \$
	<input type="checkbox"/> EXCESS LIABILITY <input type="checkbox"/> OCCUR <input type="checkbox"/> CLAIMS MADE <input type="checkbox"/> DEDUCTIBLE <input type="checkbox"/> RETENTION \$				EACH OCCURRENCE \$ AGGREGATE \$ \$ \$
	<input type="checkbox"/> WORKERS COMPENSATION AND EMPLOYERS' LIABILITY				NO STATUTORY LIMITS E.L. EACH ACCIDENT \$ E.L. DISEASE - EA EMPLOYEE \$ E.L. DISEASE - POLICY LIMIT \$
	<input type="checkbox"/> OTHER				

DESCRIPTION OF OPERATIONS/LOCATIONS/VEHICLES/EXCLUSIONS ADDED BY ENDORSEMENT/SPECIAL PROVISIONS

RE: Sign
 The certificate-holder is named as additional insured.

CERTIFICATE HOLDER <input checked="" type="checkbox"/> ADDITIONAL INSURED; INSURER LETTER	CANCELLATION
City of Portland Inspection Services 389 Congress St. Room 315 Portland, ME 04101	SHOULD ANY OF THE ABOVE DESCRIBED POLICIES BE CANCELLED BEFORE THE EXPIRATION DATE THEREOF, THE ISSUING COMPANY WILL ENDEAVOR TO MAIL <u>10</u> DAYS WRITTEN NOTICE TO THE CERTIFICATE HOLDER NAMED TO THE LEFT, BUT FAILURE TO MAIL SUCH NOTICE SHALL IMPOSE NO OBLIGATION OR LIABILITY OF ANY KIND UPON THE COMPANY, ITS AGENTS OR REPRESENTATIVES. AUTHORIZED REPRESENTATIVE <i>Michelle A. Mitchell</i>

Exchange Street

Market Street

Molly's Pub

Milk Street

sign above door at 26 Milk St.

19'

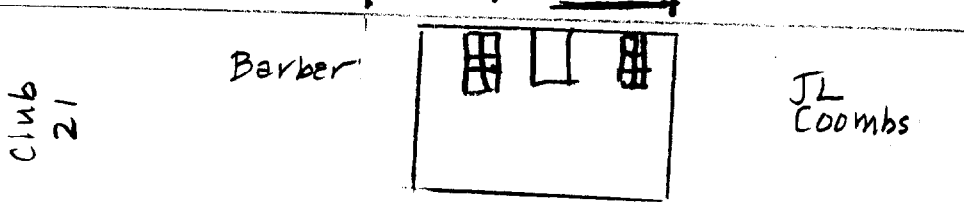

Business Frontage: 19'
Door to Curbside: 10'

Proposed sign: 30x42" rectangle,
hanging height 10 1/2',
above sidewalk (approx)

Free-standing sandwich sign

6-5-01

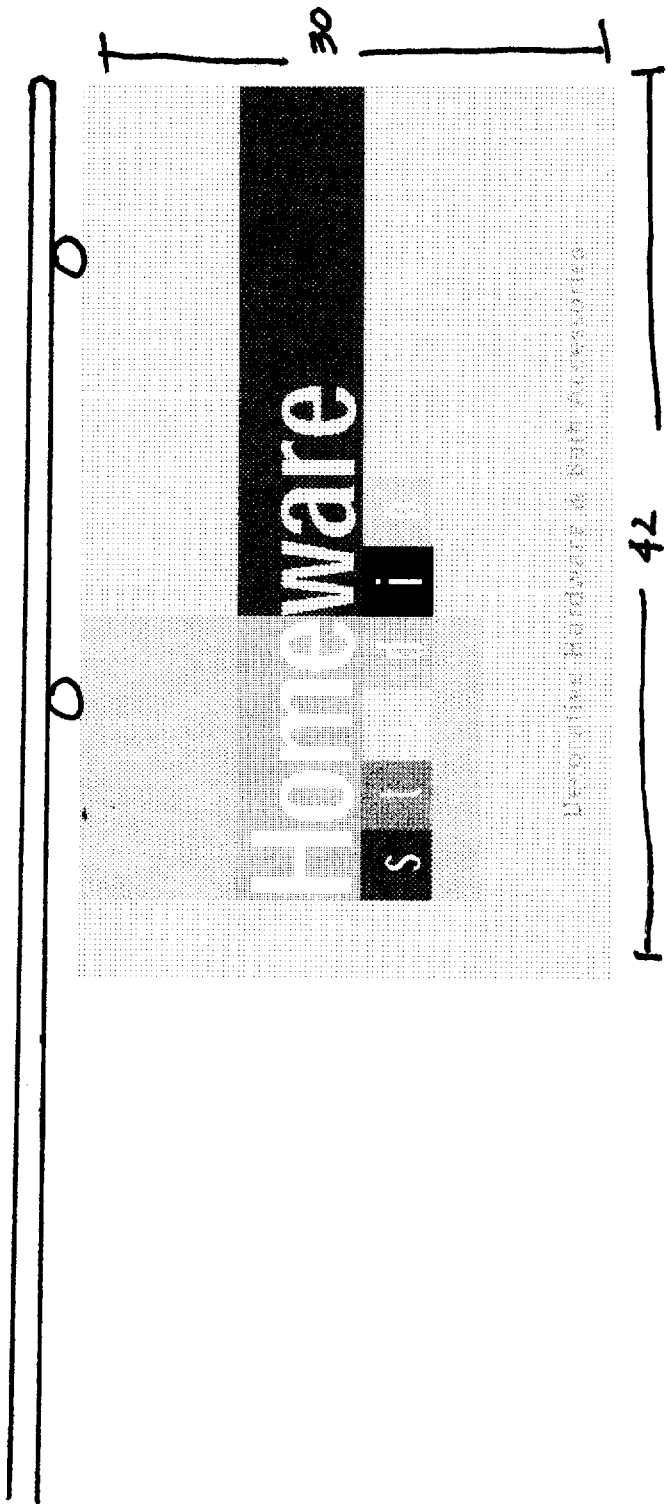

Home

S

1

d

i

o

ware

Decorative Hardware & Bath Accessories