

# DISPLAY THIS CARD ON PRINCIPAL FRONTAGE OF WORK CITY OF PORTLAND

Please Read Application And Notes, If Any, Attached

## BUILDING INSPECTION

### PERMIT

PERMIT ISSUED

Permit Number: 051411

OCT 21 2005

CITY OF PORTLAND

This is to certify that Ocean Block Associates/Dan Dostie

has permission to Move a 3'x4' sign and install new location

AT 42 Market St

032 F00100

provided that the person or persons, firm or corporation accepting this permit shall comply with all of the provisions of the Statutes of Maine and of the Ordinances of the City of Portland regulating the construction, maintenance and use of buildings and structures, and of the application on file in this department.

Apply to Public Works for street line and grade if nature of work requires such information.

Notification of inspection must be given and written permission procured before this building or part thereof is altered or occupied. **NO OTHER NOTICES REQUIRED.**

A certificate of occupancy must be procured by owner before this building or part thereof is occupied.

#### OTHER REQUIRED APPROVALS

Fire Dept. \_\_\_\_\_

Health Dept. \_\_\_\_\_

Appeal Board \_\_\_\_\_

Other \_\_\_\_\_

Department Name

*[Signature]*  
10/21/05  
Director - Building & Inspection Services

**PENALTY FOR REMOVING THIS CARD**

**City of Portland, Maine - Building or Use Permit Application**

389 Congress Street, 04101 Tel: (207) 874-8703, Fax: (207) 874-8716

Permit No: 05-1411	Issue Date: OCT 24 2005	032 F001001
-----------------------	----------------------------	-------------

<b>Location of Construction:</b> 42 Market St	<b>Owner Name:</b> Ocean Block Associates	<b>Owner Address:</b> 30 Market St	<b>Phone:</b> 772-3477
<b>Business Name:</b>	<b>Contractor Name:</b> Daniel Dostie	<b>Contractor Address:</b> 22 Milk Street Portland	<b>Phone:</b> 772-3477
<b>Lessee/Buyer's Name</b>	<b>Phone:</b>	<b>Permit Type:</b> Signs - Permanent	<b>Zone:</b> B3

<b>Past Use:</b> Retail/Shoe Store	<b>Proposed Use:</b> Retail/Jewelry Store	<b>Permit Fee:</b> \$89.00	<b>Cost of Work:</b> \$89.00	<b>CEO District:</b> 1
---------------------------------------	--	-------------------------------	---------------------------------	---------------------------

**Proposed Project Description:**  
Move a 3'x4' sign and install at new location.

<b>FIRE DEPT:</b> <input type="checkbox"/> Approved <input checked="" type="checkbox"/> Denied Signature: <i>[Signature]</i>	<b>INSPECTION:</b> Use Group: U Type: Sign IBC 2003 Signature: <i>[Signature]</i>
<b>PEDESTRIAN ACTIVITIES DISTRICT (P.A.D.)</b>	
Action: <input type="checkbox"/> Approved <input type="checkbox"/> Approved w/Conditions <input checked="" type="checkbox"/> Denied	
Signature: _____ Date: _____	

<b>Permit Taken By:</b> gad	<b>Date Applied For:</b> 09/29/2005	<b>Zoning Approval</b>	
--------------------------------	--	------------------------	--

<ol style="list-style-type: none"> <li>This permit application does not preclude the Applicant(s) from meeting applicable State and Federal Rules.</li> <li>Building permits do not include plumbing, septic or electrical work.</li> <li>Building permits are void if work is not started within six (6) months of the date of issuance. False information may invalidate a building permit and stop all work..</li> </ol>	<b>Special Zone or Reviews</b> <input type="checkbox"/> Shoreland <input type="checkbox"/> Wetland <input type="checkbox"/> Flood Zone <input type="checkbox"/> Subdivision <input type="checkbox"/> Site Plan Maj <input type="checkbox"/> Minor <input type="checkbox"/> MM <input type="checkbox"/> Date: <i>10/3/05</i>	<b>Zoning Appeal</b> <input type="checkbox"/> Variance <input type="checkbox"/> Miscellaneous <input type="checkbox"/> Conditional Use <input type="checkbox"/> Interpretation <input type="checkbox"/> Approved <input type="checkbox"/> Denied Date: _____	<b>Historic Preservation</b> yes <input type="checkbox"/> Not in District or Landmark <input type="checkbox"/> Does Not Require Review <input type="checkbox"/> Requires Review <input type="checkbox"/> Approved <input checked="" type="checkbox"/> Approved w/Conditions <input type="checkbox"/> Denied Date: <i>10/7/05</i> <i>J. Anderson</i>
---	--	---	--

**CERTIFICATION**

I hereby certify that I am the owner of record of the named property, or that the proposed work is authorized by the owner of record and that I have been authorized by the owner to make this application as his authorized agent and I agree to conform to all applicable laws of this jurisdiction. In addition, if a permit for work described in the application is issued, I certify that the code official's authorized representative shall have the authority to enter all areas covered by such permit at any reasonable hour to enforce the provision of the code(s) applicable to such permit.

SIGNATURE OF APPLICANT	ADDRESS	DATE	PHONE
RESPONSIBLE PERSON IN CHARGE OF WORK, TITLE		DATE	PHONE

**City of Portland, Maine - Building or Use Permit**

389 Congress Street, 04101 Tel: (207) 874-8703, Fax: (207) 874-8716

<b>Permit No:</b> 05-1411	<b>Date Applied For:</b> 09/29/2005	<b>CBL:</b> 032 F001001
------------------------------	--	----------------------------

<b>Location of Construction:</b> 42 Market St	<b>Owner Name:</b> Ocean Block Associates	<b>Owner Address:</b> 30 Market St	<b>Phone:</b> ( ) 772-3477
<b>Business Name:</b>	<b>Contractor Name:</b> Daniel Dostie	<b>Contractor Address:</b> 22 Milk Street Portland	<b>Phone:</b> (207) 772-3477
<b>Lessee/Buyer's Name</b>	<b>Phone:</b>	<b>Permit Type:</b> Signs - Permanent	

<b>Proposed Use:</b> Retail/Jewelry Store	<b>Proposed Project Description:</b> Move a 3'x4' sign and install at new location.
--	--

**Dept:** Historical      **Status:** Approved with Conditions      **Reviewer:** Deborah Andrews      **Approval Date:** 10/07/2005

**Note:**      **Ok to Issue:**

1) \* Sign to be hung from existing corner bracket.

**Dept:** Zoning      **Status:** Approved      **Reviewer:** Ann Machado      **Approval Date:** 10/03/2005

**Note:**      **Ok to Issue:**

**Dept:** Building      **Status:** Approved with Conditions      **Reviewer:** Tammy Munson      **Approval Date:** 10/21/2005

**Note:**      **Ok to Issue:**

1) Signage Installation to comply with Chapter 31 of the IBC 2003 building code.

# ACORD CERTIFICATE OF LIABILITY INSURANCE

DATE (MM/DD/YYYY)  
09/27/2005

**PRODUCER**  
 Bilodeau Insurance Agency  
 92 Pleasant Street  
 P. O. Box 679  
 Brunswick ME 04011

**INSURED**  
 DDAK Inc  
 DBA Dostie Jewelers  
 22 Milk St  
 Portland ME 04101

THIS CERTIFICATE IS ISSUED AS A MATTER OF INFORMATION ONLY AND CONFERS NO RIGHTS UPON THE CERTIFICATE HOLDER. THIS CERTIFICATE DOES NOT AMEND, EXTEND OR ALTER THE COVERAGE AFFORDED BY THE POLICIES BELOW.

INSURERS AFFORDING COVERAGE	NAIC #
INSURER A: Peerless Insurance	
INSURER B:	
INSURER C:	
INSURER D:	
INSURER E:	

**COVERAGES**

THE POLICIES OF INSURANCE LISTED BELOW HAVE BEEN ISSUED TO THE INSURED NAMED ABOVE FOR THE POLICY PERIOD INDICATED. NOTWITHSTANDING ANY REQUIREMENT, TERM OR CONDITION OF ANY CONTRACT OR OTHER DOCUMENT WITH RESPECT TO WHICH THIS CERTIFICATE MAY BE ISSUED OR MAY PERTAIN, THE INSURANCE AFFORDED BY THE POLICIES DESCRIBED HEREIN IS SUBJECT TO ALL THE TERMS, EXCLUSIONS AND CONDITIONS OF SUCH POLICIES. AGGREGATE LIMITS SHOWN MAY HAVE BEEN REDUCED BY PAID CLAIMS.

INSR	ADD'L LTR	TYPE OF INSURANCE	POLICY NUMBER	POLICY EFFECTIVE DATE (MM/DD/YYYY)	POLICY EXPIRATION DATE (MM/DD/YYYY)	LIMITS
A		<b>GENERAL LIABILITY</b> <input checked="" type="checkbox"/> COMMERCIAL GENERAL LIABILITY CLAIMS MADE <input checked="" type="checkbox"/> OCCUR  GEN'L AGGREGATE LIMIT APPLIES PER: POLICY <input type="checkbox"/> PRO-JECT <input type="checkbox"/> LOC <input type="checkbox"/>	BOP9000047	03/31/2005	03/31/2006	EACH OCCURRENCE \$ 1,000,000 DAMAGE TO RENTED PREMISES (Ea occurrence) \$ 50,000 MED EXP (Any one person) \$ 5,000 PERSONAL & ADV INJURY \$ 1,000,000 GENERAL AGGREGATE \$ 2,000,000 PRODUCTS - COMP/OP AGG \$ 2,000,000
		<b>AUTOMOBILE LIABILITY</b> <input type="checkbox"/> ANY AUTO <input type="checkbox"/> ALL OWNED AUTOS <input type="checkbox"/> SCHEDULED AUTOS <input type="checkbox"/> HIRED AUTOS <input type="checkbox"/> NON-OWNED AUTOS				COMBINED SINGLE LIMIT (Ea accident) \$ BODILY INJURY (Per person) \$ BODILY INJURY (Per accident) \$ PROPERTY DAMAGE (Per accident) \$
		<b>GARAGE LIABILITY</b> <input type="checkbox"/> ANY AUTO				AUTO ONLY - EA ACCIDENT \$ OTHER THAN AUTO ONLY: EA ACC \$ AGG \$
		<b>EXCESS/UMBRELLA LIABILITY</b> <input type="checkbox"/> OCCUR <input type="checkbox"/> CLAIMS MADE  DEDUCTIBLE \$ RETENTION \$				EACH OCCURRENCE \$ AGGREGATE \$ \$ \$
		<b>WORKERS COMPENSATION AND EMPLOYERS' LIABILITY</b> ANY PROPRIETOR/PARTNER/EXECUTIVE OFFICER/MEMBER EXCLUDED? If yes, describe under SPECIAL PROVISIONS below OTHER				<input type="checkbox"/> WC STATU-TORY LIMITS <input type="checkbox"/> OTH-ER E.L. EACH ACCIDENT \$ E.L. DISEASE - EA EMPLOYEE \$ E.L. DISEASE - POLICY LIMIT \$

**DESCRIPTION OF OPERATIONS/LOCATIONS/VEHICLES/EXCLUSIONS ADDED BY ENDORSEMENT/SPECIAL PROVISIONS**  
 The certificate holder is named as additional insured in respect to the Sign located at 22 Milk St, Portland, Me 04101.

**CERTIFICATE HOLDER**

City of Portland  
 389 Congress St  
  
 Portland ME 04101

**CANCELLATION**

SHOULD ANY OF THE ABOVE DESCRIBED POLICIES BE CANCELLED BEFORE THE EXPIRATION DATE THEREOF, THE ISSUING INSURER WILL ENDEAVOR TO MAIL 10 DAYS WRITTEN NOTICE TO THE CERTIFICATE HOLDER NAMED TO THE LEFT, BUT FAILURE TO DO SO SHALL IMPOSE NO OBLIGATION OR LIABILITY OF ANY KIND UPON THE INSURER, ITS AGENTS OR REPRESENTATIVES.

AUTHORIZED REPRESENTATIVE  
*Kelley Farrow*

OCEAN ASSOCIATES, LLC  
42 MARKET STREET  
PORTLAND, ME 04101-5022  
(207) 774-1000

September 27, 2005

City of Portland and  
The Historic Preservation Committee  
Portland, Maine

Dear Sirs:

I have reviewed building sign plans for the J. Dostie Jewelers store and give permission for a sign to be hung on the existing framework at 22-24 Milk Street.

I can be reached at the above number if necessary. Thank you for your assistance.

Sincerely,

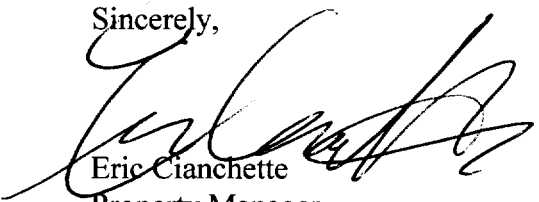

Eric Cianchette  
Property Manager

Hunter,

Sunset Signs  
721-8604

Same sign -  
New bracket -  
Same as old -

~~3/8" x 2" leg bolts w/anchors~~  
3/8" x 2" leg bolts w/anchors

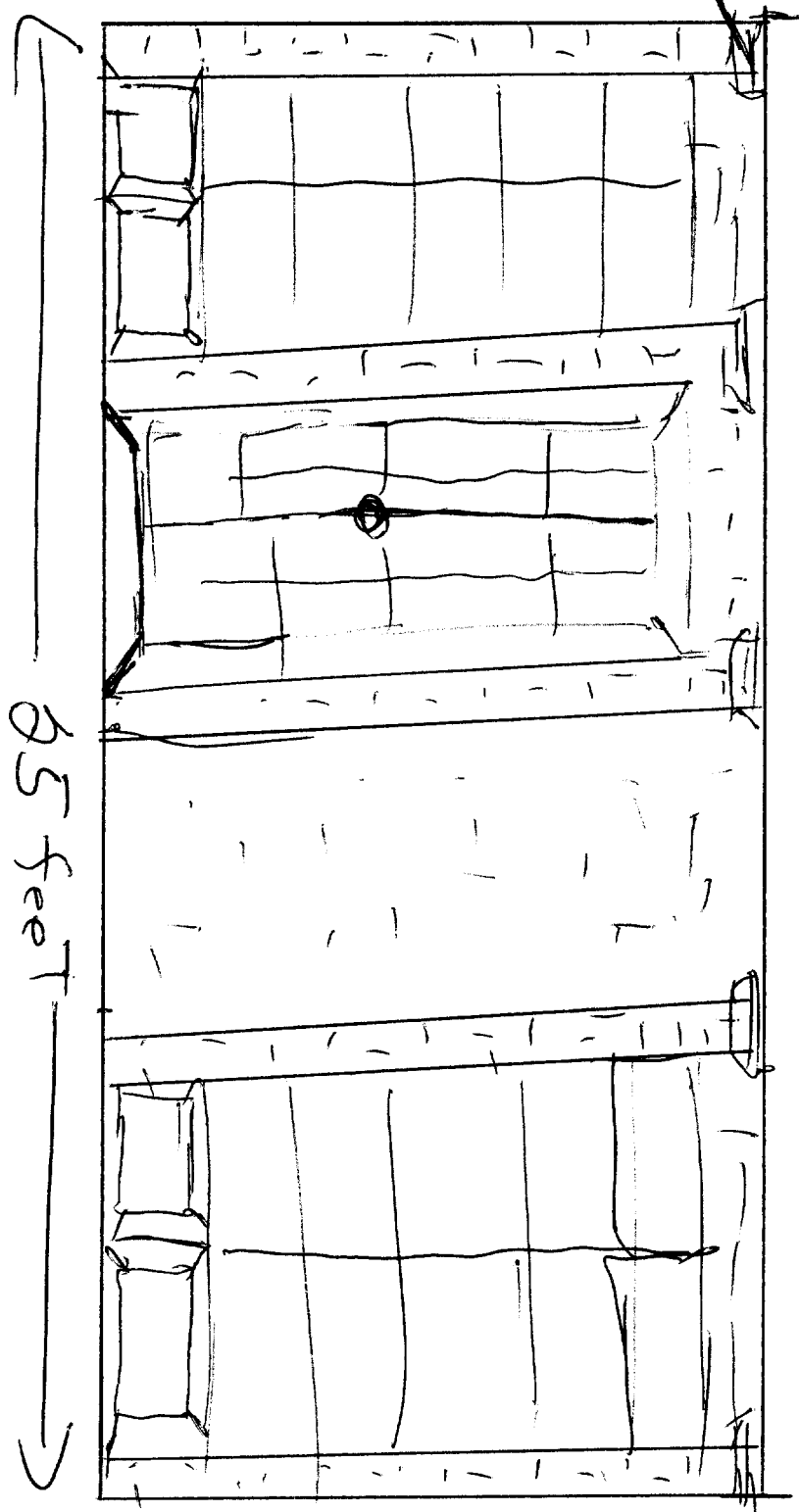
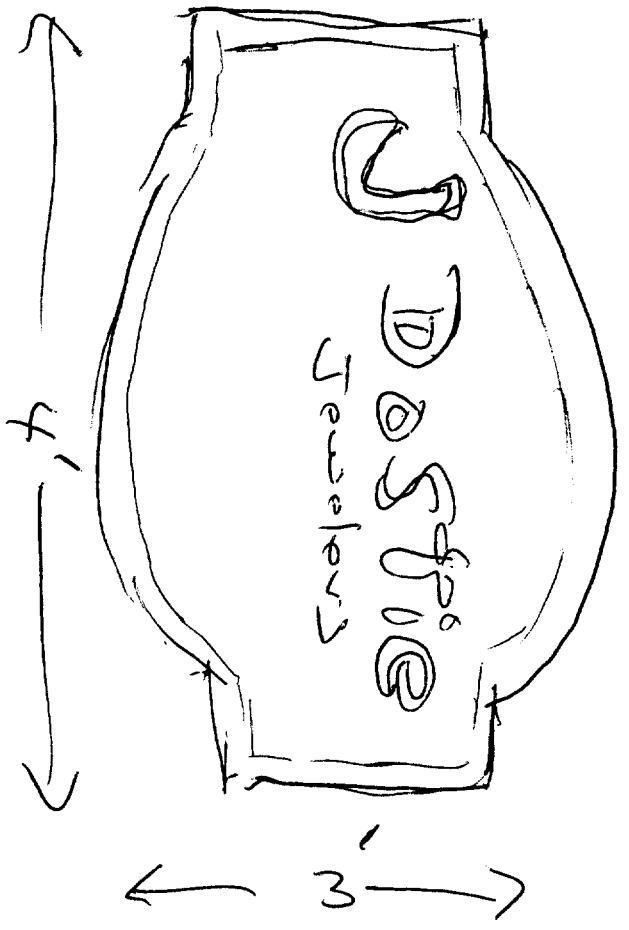

11'6"

# Signage/Awning Permit Application

If you or the property owner owes real estate or personal property taxes or user charges on any property within the City, payment arrangements must be made before permits of any kind are accepted.

Location/Address of Construction: <u>22 Milk St Portland</u>		
Total Square Footage of Proposed Structure <u>12 Square Feet</u>	Square Footage of Lot <u>275 Square Feet</u> <del>1000 Square Feet</del>	
Tax Assessor's Chart, Block & Lot Chart# <u>32</u> Block# <u>F</u> Lot# <u>001</u>	Owner:	Telephone:
Lessee/Buyer's Name (If Applicable)	Applicant name, address & telephone: <u>Daniel Dostie</u> <u>22 Milk St</u> <u>Portland, ME 04101</u> <u>207 772-3477</u>	Total s.f. of signage x \$2.00 per s.f. plus \$30.00/\$65.00 for H.D. signage = Total Fee: \$ <u>12 SF</u> Awning Fee = Cost Of Work: \$ <u>89</u> Total Fee: \$ <u>89</u>
Current use: _____		
If the location is currently vacant, what was prior use: <u>Shoe Store JL Coumbs</u>		
Approximately how long has it been vacant: <u>6 months</u>		
Proposed use: <u>Jewelry Store</u>		
Project description: <u>Move 3' x 4' Sign + install at new location</u>		
Contractor's name, address & telephone:		
Whom should we contact when the permit is ready: <u>Dan Dostie J. Dostie Jeweler</u>		
Mailing address: <u>22 Milk St Portland ME 04101</u>		
We will contact you by phone when the permit is ready. You must come in and pick up the permit and review the requirements before starting any work, with a Plan Reviewer. <b>A STOP WORK ORDER will be issued and a \$100.00 fee if any work starts before the permit is picked up.</b> PHONE:		

**IF THE REQUIRED INFORMATION IS NOT INCLUDED IN THE SUBMISSIONS THE PERMIT WILL BE AUTOMATICALLY DENIED AT THE DISCRETION OF THE BUILDING/PLANNING DEPARTMENT. WE MAY REQUIRE ADDITIONAL INFORMATION IN ORDER TO APPROVE THIS PERMIT.**

I hereby certify that I am the Owner of record of the named property, or that the owner of record authorizes the proposed work and that I have been authorized by the owner to make this application as his/her authorized agent. I agree to conform to all applicable laws of this jurisdiction. In addition, if a permit for work described in this application is issued, I certify that the Code Official's authorized representative shall have the authority to enter all areas covered by this permit at any reasonable hour to enforce the provisions of the codes applicable to this permit.

Signature of applicant:  Date: 9/27/05

**This is NOT a permit, you may not commence ANY work until the permit is issued.**

# SIGNAGE/AWNING PRE-APPLICATION QUESTIONNAIRE

PLEASE COMPLETE ALL INFORMATION

ADDRESS: 22 Milk St ZONE: \_\_\_\_\_

CBL: \_\_\_\_\_

SINGLE TENANT LOT? YES  NO \_\_\_\_\_ MULTI TENANT LOT? YES \_\_\_\_\_ NO \_\_\_\_\_  
MORE THAN ONE SIGN TOTAL WITH PROPOSED SIGN? YES \_\_\_\_\_ NO

**TENANT/ALLOCATED BUILDING SPACE FRONTAGE (FEET):**  
*drawing / picture shows 25'*  
Length: 46 feet Height: 12 feet

**INFORMATION ON PROPOSED SIGN(S):**  
FREESTANDING (e.g., pole) SIGN? YES \_\_\_\_\_ NO \_\_\_\_\_ DIMENSIONS PROPOSED: 3' x 4'  
BLDG. WALL SIGN? (attached to bldg) YES  NO \_\_\_\_\_ DIMENSIONS PROPOSED: 3' x 4'

**INFORMATION ON ALREADY EXISTING AND PERMITTED SIGN(S):**  
FREESTANDING (e.g., pole) SIGN? YES \_\_\_\_\_ NO \_\_\_\_\_ DIMENSIONS: \_\_\_\_\_  
BLDG. WALL SIGN(attached to bldg)? YES \_\_\_\_\_ NO \_\_\_\_\_ DIMENSIONS: \_\_\_\_\_  
AWNING? YES \_\_\_\_\_ NO \_\_\_\_\_ DIMENSIONS: \_\_\_\_\_  
LOT FRONTAGE (FEET): \_\_\_\_\_

**AWNING** YES \_\_\_\_\_ NO \_\_\_\_\_ IS AWNING BACKLIT? YES \_\_\_\_\_ NO \_\_\_\_\_  
HEIGHT OF AWNING: \_\_\_\_\_ LENGTH OF AWNING: \_\_\_\_\_ DEPTH: \_\_\_\_\_  
IS THERE ANY COMMUNICATION, MESSAGE, TRADEMARK OR SYMBOL ON IT? YES \_\_\_\_\_ NO \_\_\_\_\_  
IF YES, TOTAL S.F. OF PANELS WITH COMMUNICATIONS/MESSAGE/TRADEMARK/SYMBOL? \_\_\_\_\_ s.f.

**A SITE SKETCH AND BUILDING SKETCH SHOWING EXACTLY WHERE EXISTING AND NEW SIGNAGE IS LOCATED MUST BE PROVIDED. SKETCHES AND/OR PICTURES OF PROPOSED SIGNAGE ARE ALSO REQUIRED.**

SIGNATURE OF APPLICANT: \_\_\_\_\_ DATE: \_\_\_\_\_

\*\*\*\*\* FOR OFFICE USE ONLY \*\*\*\*\*  
*50 N 55 St*  
*historic district*



# CHECKLIST FOR SIGN/AWNING APPLICATION

Applicants for a sign or awning permit are required to submit the following information to the Code Enforcement Office at the time of application:

- Certificate of Liability listing the City as additional insured if any portion of the sign abuts or encroaches on any public right of way, or can fall into any public right of way. Amount must equal \$400,000.00.
- Letter of permission from the owner indicating the permissions granted and the tenant/space building frontage.
- A sketch plan of lot, indicating location of buildings, driveways, and any abutting streets or rights of way, lengths of building frontages, street frontages, and all existing setbacks. **Indicate on the plan all existing and proposed signs with their dimensions and specific locations. Be sure to include distance from the ground and building facade dimensions for any signage attached to building.**
- A sketch or photo of any proposed sign(s) indicating *content, dimensions, materials, source of illumination, and construction method, as well as specifics of installation/attachment.*
- N/A* Certificate of Flammability required for awning or canopy at time of application.
- N/A* UL# required for lighted signs at the time of Final Inspection. Failure to provide this information will invalidate the Sign Permit.
- Pre-Application Questionnaire completed and attached. Photos of existing signage attached.

**Permit Fee for signage or awning-with-signage:  
\$30.00 plus \$2.00 per square foot of sign.**

**Permit Fee for awning-without-signage is based on cost of work:  
\$30.00 for the first \$1,000.00, plus \$9.00 for each additional \$1,000.00.**

**Base Application Fee for any Historic District signage is \$65.00 instead of \$30.00**

# Sidewalk Signs

## Design, Location, and Construction Standards

### Quantity

One sign per establishment for each street frontage having a public entrance, provided that all dimension and location standards are met. When standards would not otherwise permit a sign, a sign may consist of multiple listings.

### Sign Dimensions

Single Listing: Maximum width is 24 inches or such lesser width sufficient to retain 4 ½ feet of unobstructed sidewalk width perpendicular to major flows. Maximum height is 40 inches to top of sign in place. Minimum height is 30 inches to top of sign in place.

Multiple: Maximum width is 30 inches or such lesser width sufficient to retain 4 ½ feet of unobstructed sidewalk width perpendicular to major flows. Maximum height is 40 inches to top of sign in place. Minimum height is 30 inches to top of sign in place.

### Location

Minimum distance between signs is 20 feet. Maximum distance of sign from public entrance of advertiser is 20 feet. The City may vary these distances for exceptional physical circumstances where public safety and streetscape aesthetics will be maintained. However, under no circumstances shall signs obstruct vehicular stops, benches, fire hydrants, or other street visual amenities. Signs shall be located near the curb rather than the building face.

### Materials and Graphics

All signs shall be of an A-Frame type design, shall be constructed of durable, weather-resistant materials and finish, shall have no moving parts, and shall be non-electrified. All signs shall be maintained in a clean and original appearance. Sign materials, graphics, and finish shall be of a unified design and shall be compatible with the local streetscape. All signs shall have horizontal braces spanning each side of the sign to assure rigid support. Lettering shall be legible and consistent.

### Sign Removal

All signs shall be removed when the business is closed or while any snow or ice exists on the walk within eight feet of the sign in any direction.

### Insurance

No permit shall be issued unless the applicant has posted in advance with the City a Certificate of Liability listing the City as additional insured in the amount of \$400,000.00.

### Enforcement

A sign may be removed after notice to the owner and the permit, if issued, may be revoked if the sign does not conform to the standards herein.

For a sidewalk sign permit, come to City Hall, 389 Congress Street, Room 315, with:

- \_\_\_\_\_ Certificate of Liability Insurance
- \_\_\_\_\_ Drawing of sign showing dimensions and design work
- \_\_\_\_\_ Payment of \$30.00 plus \$2.00 per s.f. of signage.
- \_\_\_\_\_ Complete application with pre-application questionnaire and checklist completed.