

CODE ANALYSIS

NFPA 101 Life Safety Code - 2015 Edition

Occupancy Classification: Assembly (2,200 sf)
Kitchens: 663 sf
Bar/Servers: 140 sf
Dining: 1,152 sf
Hazard Classification: Ordinary Hazard
Construction Type: Type III (000)
Occupant Loads: 663 SF Kitchen @ 200 sf/occupant = 4 occupants
1,152 Dining @ 15 sf/occupant = 77 occupants
Total Calculated Load: 82 Occupants

Building Uses Assembly

(Q) denotes if building is fully sprinkled
Max. Allowable Travel Distance: 200' (250')
Max. Allowable Common Path: 20/75'
Max. Dead End Corridor Length: 44'
Minimum Egress Corridor Width: 2'
Minimum Separation of exits: 0.5 diagonal (0.33)
Minimum Egress Door Width: 36"
Minimum Headroom: 7'-6" at occupied areas

Exit Lighting: Required
Emergency Lighting: Required
Fire Alarm System: Required
Fire Sprinkler System: Required (mixed occupancy)
Portable Fire Extinguishers: Required
Exit Devices/Panic Hardware: Required

Commercial Kitchen: NFPA Exhaust/Suppression Hood Required per Section 609 IFC & Chapter 9-IMC

2015 International Building Code

(Q) denotes if building is fully sprinkled

Use Group Classification: Assembly - Use Group A-2; 2,200 sf
Kitchen - 663 sf
Bar/Servers - 140 sf
Dining - 1,152 sf
Construction: Type 3B - Non-Combustible, Combustible, Unprotected
Occupant Loads: Kitchen @ 200 sf/occupant = 4 occupants
Bar/Servers @ 200 sf/occupant = 1 occupants
Total calculated load: 82 occupants

Building Limitations
Construction Type: 3B Unprotected
Maximum Height: 3 story / 75' @ A-2
Maximum Area / Floor: 28,500 sf @ A-2

Fire Resistance Ratings
Load Bearing Exterior Walls: None
Roof Construction: None
Fire Separation of Uses: 2 hours (1 hour)
Minimum Number of Exits: 2
Maximum Dead-End Corridor Length: 20'
Maximum Common Travel Path: 75'
Maximum Travel Distance: 200' (250')
Minimum Corridor Width: 44"
Minimum Ceiling Height: 7'-6"

Fire Alarm System: Required
Fire Sprinkler System: Required
Portable Fire Extinguishers: Required
Exit Lighting: Required
Emergency Lighting: Required
Commercial Kitchen: See NFPA Requirements

Building Live Loads

Dining/Kitchen: 100 psf
Lobbies: 100 psf
Corridors: 80 psf

Interior Finishes (Minimums)
Exit Enclosures: A
Corridors: A
Rooms: B

End of Analysis

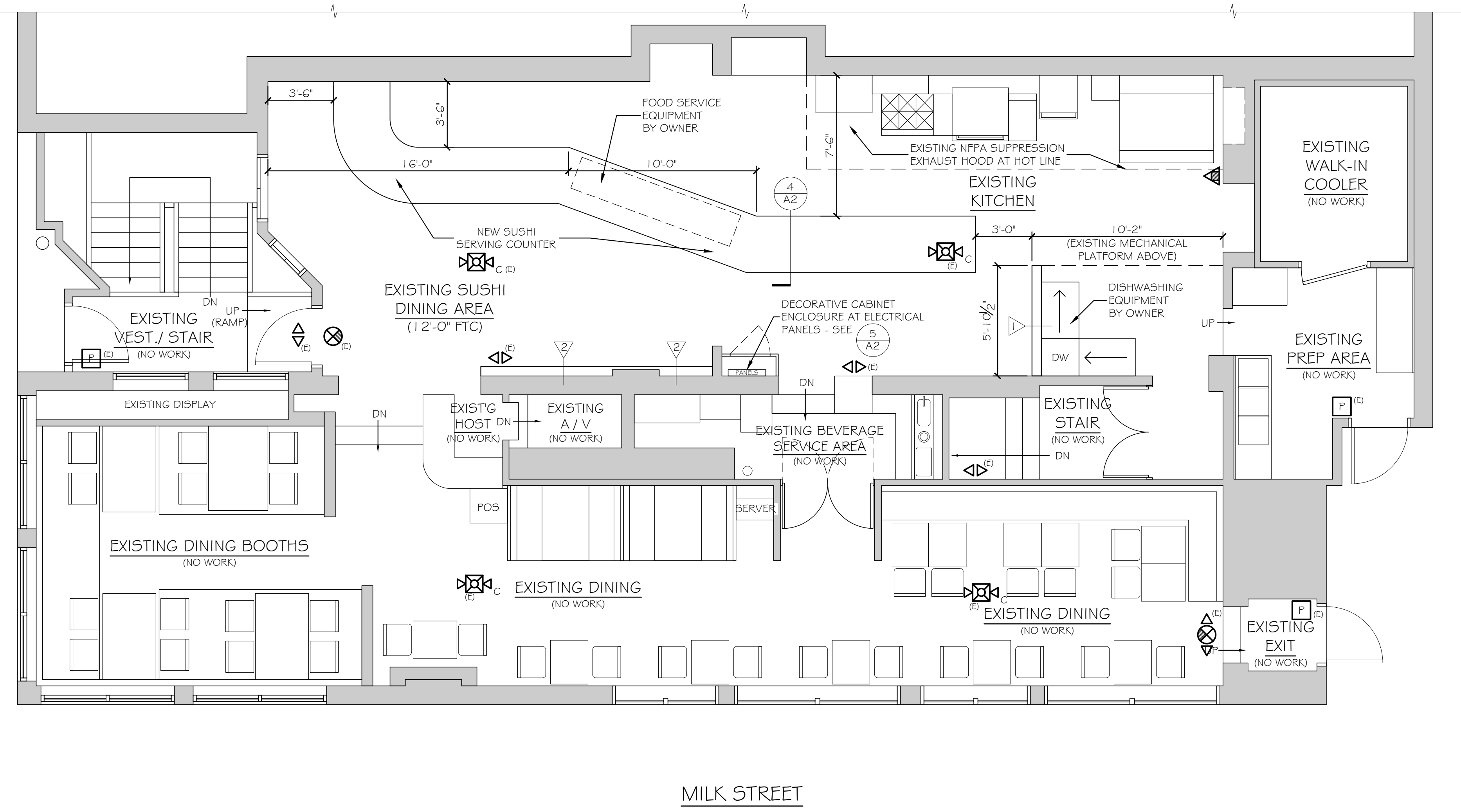

MILK STREET

EXCHANGE STREET

FIRST FLOOR PLAN

SCALE: 1/4" = 1'-0"



NFPA LEGEND	
SYMBOL	DESCRIPTION
	EXIT LIGHT
	ABC FIRE EXTINGUISHER w/ BRACKET
	EMERGENCY LIGHT
	FIRE ALARM PULL STATION
	HORN / STROBE - CEILING
	EMERGENCY / EXIT LIGHT
(E)	EXISTING

PARTITION LEGEND	
TAG	DETAIL

GENERAL NOTES	
1.	PATCH EXISTING HARD CEILING (@ 12'-0" A.F.F.) AFTER MECHANICAL WORK IS COMPLETED. PAINT ALL EXPOSED PIPES & CEILING PER OWNER.
2.	MODIFY EXISTING NFPA 13 FIRE SUPPRESSION SPRINKLER SYSTEM AS REQUIRED. SPRINKLER SYSTEM MODIFICATIONS SHALL BE REVIEWED AND APPROVED BY THE STATE OF MAINE FIRE MARSHAL AS WELL AS THE LOCAL AUTHORITY HAVING JURISDICTION. THE SPRINKLER CONTRACTOR SHALL BEAR SOLE RESPONSIBILITY FOR THE DESIGN AND INSTALLATION OF THE SYSTEM FOR OCCUPANCY.
3.	MODIFY EXISTING FIRE ALARM SYSTEM AS REQUIRED FOR COMPLIANCE WITH NFPA 101 LIFE SAFETY CODE. COORDINATE WITH SPRINKLER SYSTEM. VERIFY LOCATION OF ALARM AND NOTIFICATION PANELS WITH THE AUTHORITY HAVING JURISDICTION.
4.	REPAINT ENTIRE EXISTING SUSHI DINING AREA. COLORS SHALL BE SELECTED BY OWNER.
5.	SEE AD-1 FOR EXISTING DIMENSIONS.