

**BRONZE RESTORATION NOTES:**

REMOVE EXISTING ALUMINUM AND PLYWOOD TO HISTORIC BRONZE PROFILES. REMOVE EXG ROOFING, ADHESIVES, AND MASTICS TO SUBSTRATE. REMOVE ROOFING ACCESSORIES.

REMOVE EXISTING PAINT AND FINISH TO THE SMOOTH, BARE BRONZE SUBSTRATE.

SOLDER/PATCH EXG SCREWS HOLES WITH ALLOY MATCHING HISTORIC BRONZE PROFILES

CLEAN AND POLISH TO MATCH NEW.

EXG. ALUM. PANEL AND PLY. CLADDING TO BE REMOVED. CARE IS TO BE TAKEN THAT BRONZE PROFILES ARE NOT DAMAGED DURING DEMOLITION. REMOVE EXISTING ROOFING TO CONC. DECK.

EXG. BRONZE PROFILE TO BE CLEANED AND POLISHED

EXG. CLADDING SUBSTRUCTURE TO BE REPAIRED AND REUSED AS NECESSARY

BRONZE RECESSED FLAT HEAD MECHANICAL ATTACHMENTS, TYP.

16 GA BRONZE PLATE FACE - PROVIDE IN 5'-0" SECTIONS CENTERED ON MARQUIS ELEVATION

EXG. CLADDING SUBSTRUCTURE TO BE REPAIRED AND REUSED AS NECESSARY

BRONZE RECESSED FLAT HEAD MECHANICAL ATTACHMENTS, TYP.

EXG. BRONZE PROFILE TO BE CLEANED AND POLISHED

1/4" DIA WEEP HOLES 24" O.C., CENTER ON MARQUETTE

**6 ENTRY DETAIL - CONGRESS STREET MARQUIS**

3" = 1'-0" 0 1 1/2 3 6 12

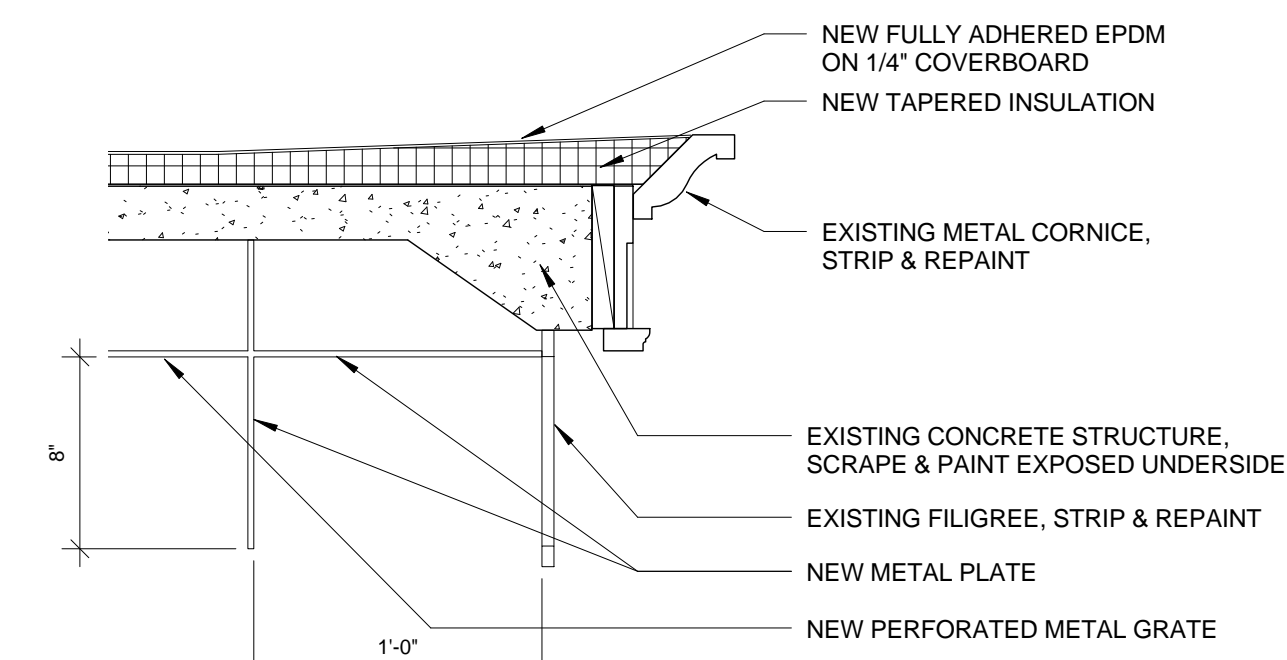
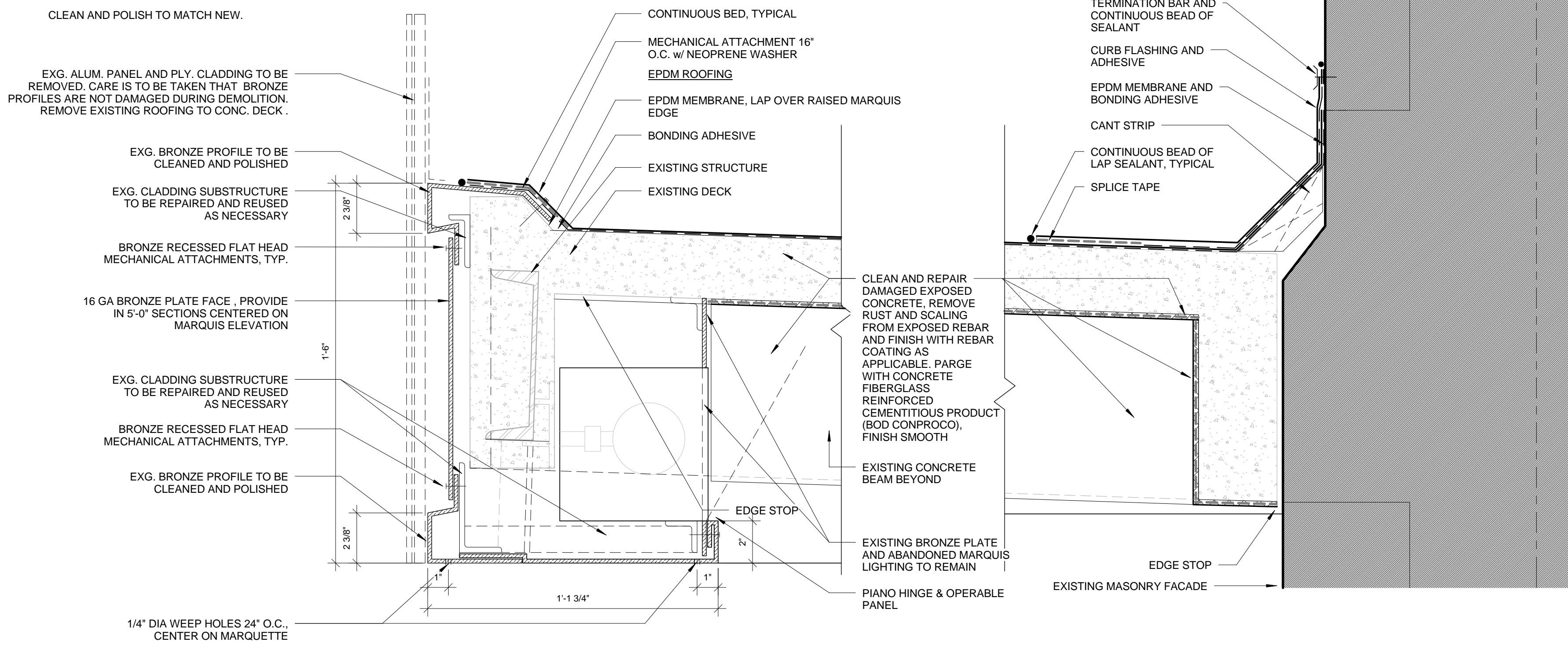

**5 CANOPY CORNICE DETAIL**

1 1/2" = 1'-0" 0 3 6 12 24

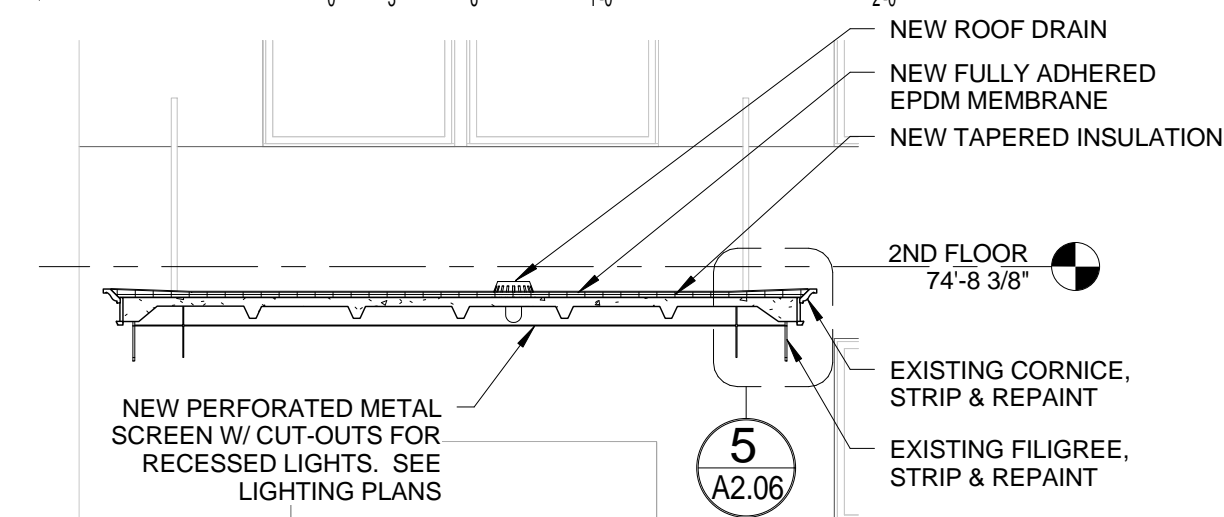

**4 SECTION 2 AT EXCHANGE STREET CANOPY**

1/4" = 1'-0" 0 1 1/2 3 4 6 8

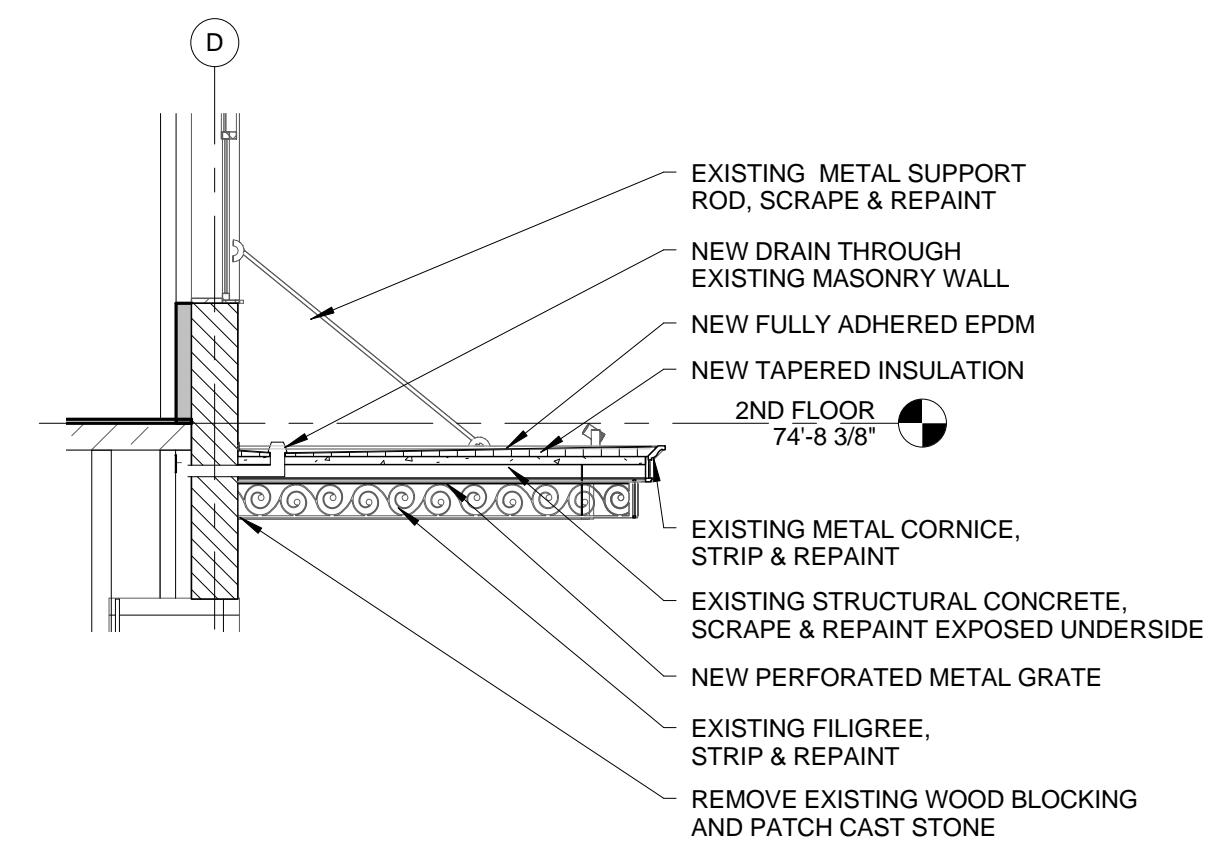

**3 SECTION 1 AT EXCHANGE STREET CANOPY**

1/4" = 1'-0" 0 1 1/2 3 4 6 8

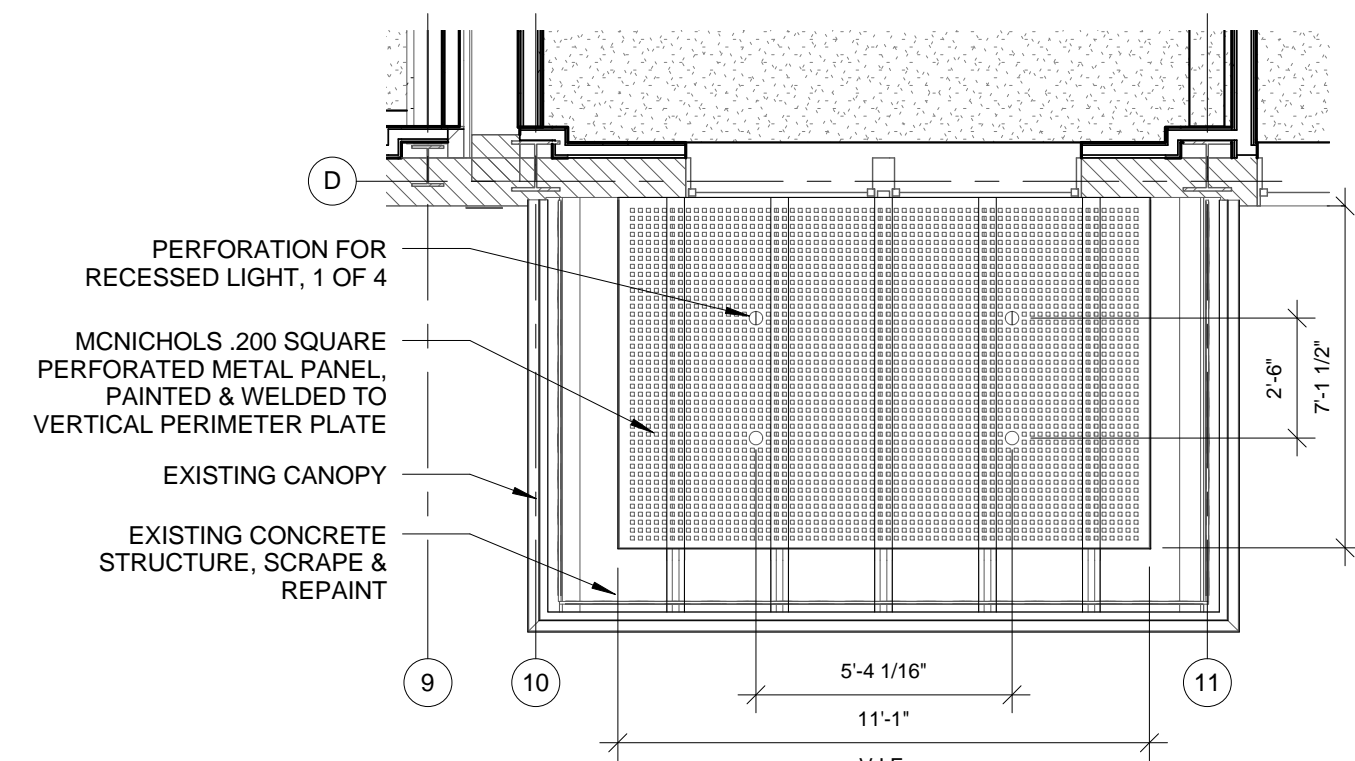

**2 EXCHANGE ST. CANOPY REFL. CLG. PLAN**

1/4" = 1'-0" 0 1 1/2 3 4 6 8

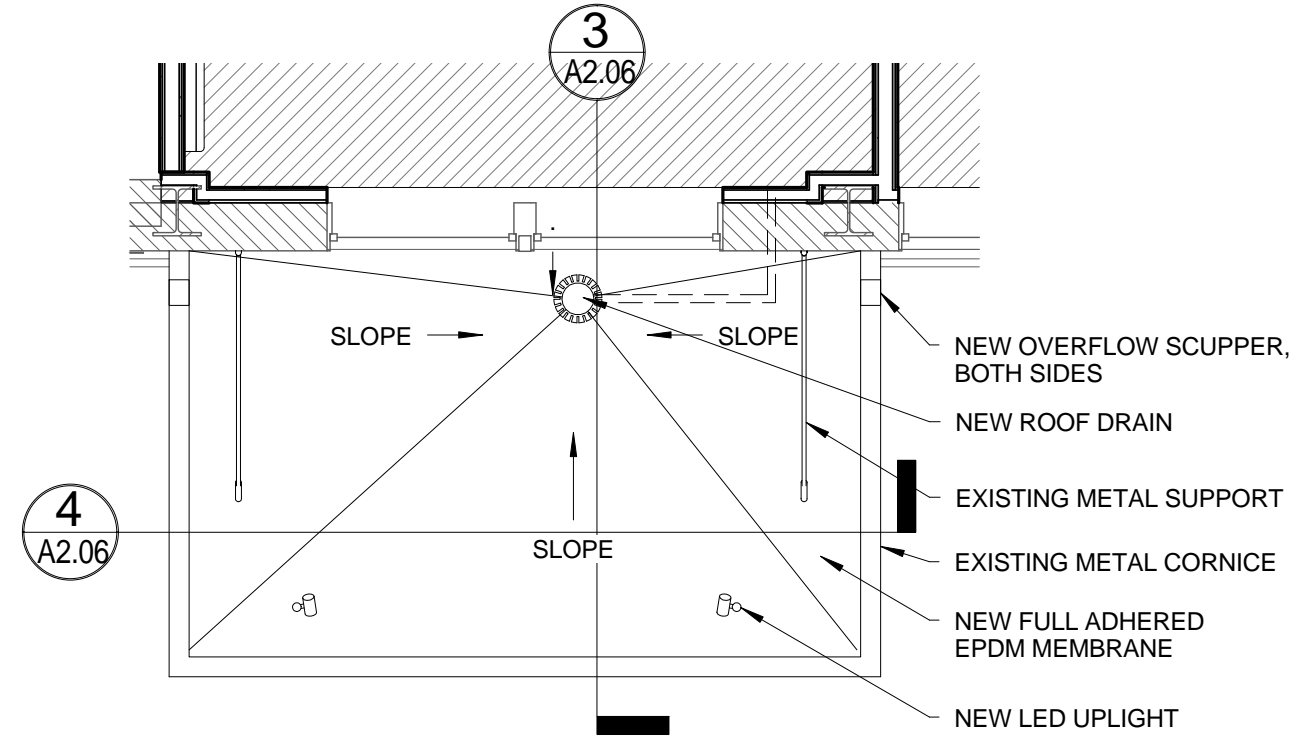

**1 EXCHANGE STREET CANOPY PLAN**

1/4" = 1'-0" 0 1 1/2 3 4 6 8

Prepared For:  
**119 Development, LLC**  
P.O. Box 7486  
Portland, ME 04112

Consultant:  
**ARCHETYPE architects**  
48 Union Wharf Portland, Maine 04101  
(207) 772-6022 Fax (207) 772-4056

Project:  
**PRESS HOTEL**  
390 CONGRESS STREET  
PORTLAND, ME 04101

Revisions:  
3 13\_10-14 Issue for Bid & Marriott Rev

Scale: As indicated  
**CANOPY DETAILS**

Date: 14 OCT 13  
**A2.06**