

**Product:** Dero Bike Hitch  
As manufactured by Dero Bike Racks

**Capacity:** 2 Bikes

**Materials:** Centerbeam: 2" schedule 40 pipe (2.375" OD)  
Ring: 1.5" OD 11 gauge tube

**Finishes:** An after fabrication hot dipped galvanized finish is standard. 250 T/GC powder coat color, a thermoplastic coating and a stainless steel option are also available.

Our powder coat finish assures a high level of adhesion and durability by following these steps:  
1. Sandblast  
2. Iron phosphate pretreatment  
3. Epoxy primer electrostatically applied  
4. Final track T/GC polyester powder coat

stainless steel 304 grade stainless steel material finished in either a high polished shine or a satin finish.

A ribbed PVC clip is also available.

**Installation Methods:** In-ground mount is embedded into concrete base. Surface mount has one 5" x 6" foot which is anchored to the ground with four anchors (included with rack).

**Wall Setbacks:** For racks set parallel to a wall:  
Minimum: 12"  
Recommended: 24"

For racks set perpendicular to a wall:  
Minimum: 35" (corner measurement)  
Recommended: 38" (4" if aisle is needed between bike and wall)

**Distance Between Racks:**  
Minimum: 24"  
Recommended: 36"

**Street Setbacks:**  
Minimum: 36"



**BIKE HITCH - SPECIFICATIONS AND SPACE USE**  
N.T.S.

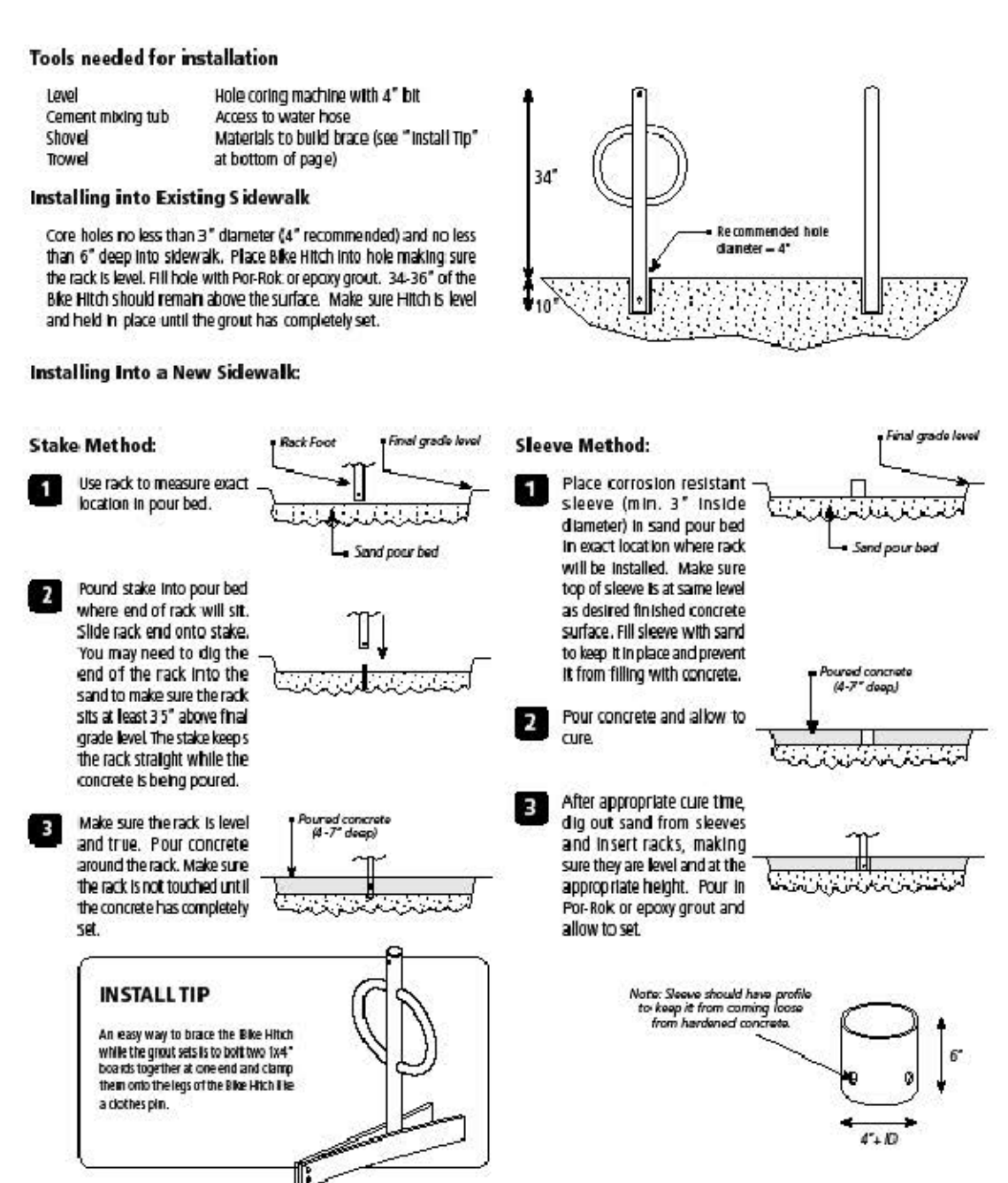

**Tools needed for installation:**  
Level, Hole cutting machine with 4" bit, Cement mixing tub, Shovel, Trowel, Access to water hose, Materials to build brace (see "Install Tip" at bottom of page)

**Installing into Existing Sidewalk:**  
Core holes no less than 3" diameter (4" recommended) and no less than 6" deep into sidewalk. Place bike hitch into hole making sure the rack is level. Fill hole with hot mix or epoxy grout. 3/4-1" of the bike hitch should remain above the surface. Make sure hitch is level and held in place until the grout has completely set.

**Installing into a New Sidewalk:**

**Stake Method:**  
1. Use rack to measure exact location in pour bed.  
2. Pound stake into pour bed where end of rack will sit. Slide rack and onto stake. You may need to dig the end of the rack into the sand to make sure the rack sits at least 1/2" above final grade level. The stake keeps the rack straight while the concrete is being poured.  
3. Make sure the rack is level and it sits. Pour concrete around the rack. Make sure the rack is not touched until the concrete has completely set.

**Sleeve Method:**  
1. Place corrosion resistant sleeve (min. 3" inside diameter) in sand pour bed in each location where rack will be installed. Make sure top of sleeve is at same level as desired finished concrete surface. Fill sleeve with sand to keep in place and prevent it from filling with concrete.  
2. Pour concrete and allow to cure.  
3. After appropriate cure time, dig out sand from sleeves and insert racks, making sure they are level and at the appropriate height. Pour in hot mix or epoxy grout and allow to set.

**INSTALL TIP:**  
An easy way to brace the bike hitch while the grout sets is to use two 1x4 boards against the concrete and clamp them into the legs of the hitch to be a temporary set.

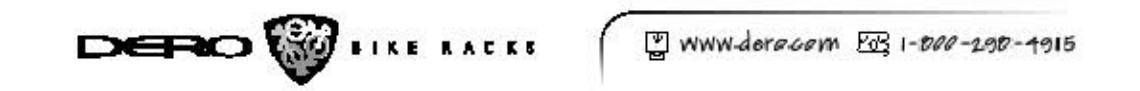

**BIKE HITCH - IN-GROUND INSTALLATION INSTRUCTIONS**  
N.T.S.

**BRICKS TO BE USED:**

**NEW CONSTRUCTION:**  
4" x 8" PINE HALL PATHWAY PAVER BRICK; MFG. BY PINE HALL BRICK CO., MADISON, NORTH CAROLINA. LACHANCE ITEM # 193623, PINE HALL PATHWAY PAVER BRICK.

**REPAIR / MAINTENANCE TO EXISTING BRICK SIDEWALKS:** VERMONT PAVER; SUPPLIED BY GAGNE AND SONS. SPECIFICATION NUMBER: "VERMONT BACKER BRICK", ITEM NUMBER # VBBB.

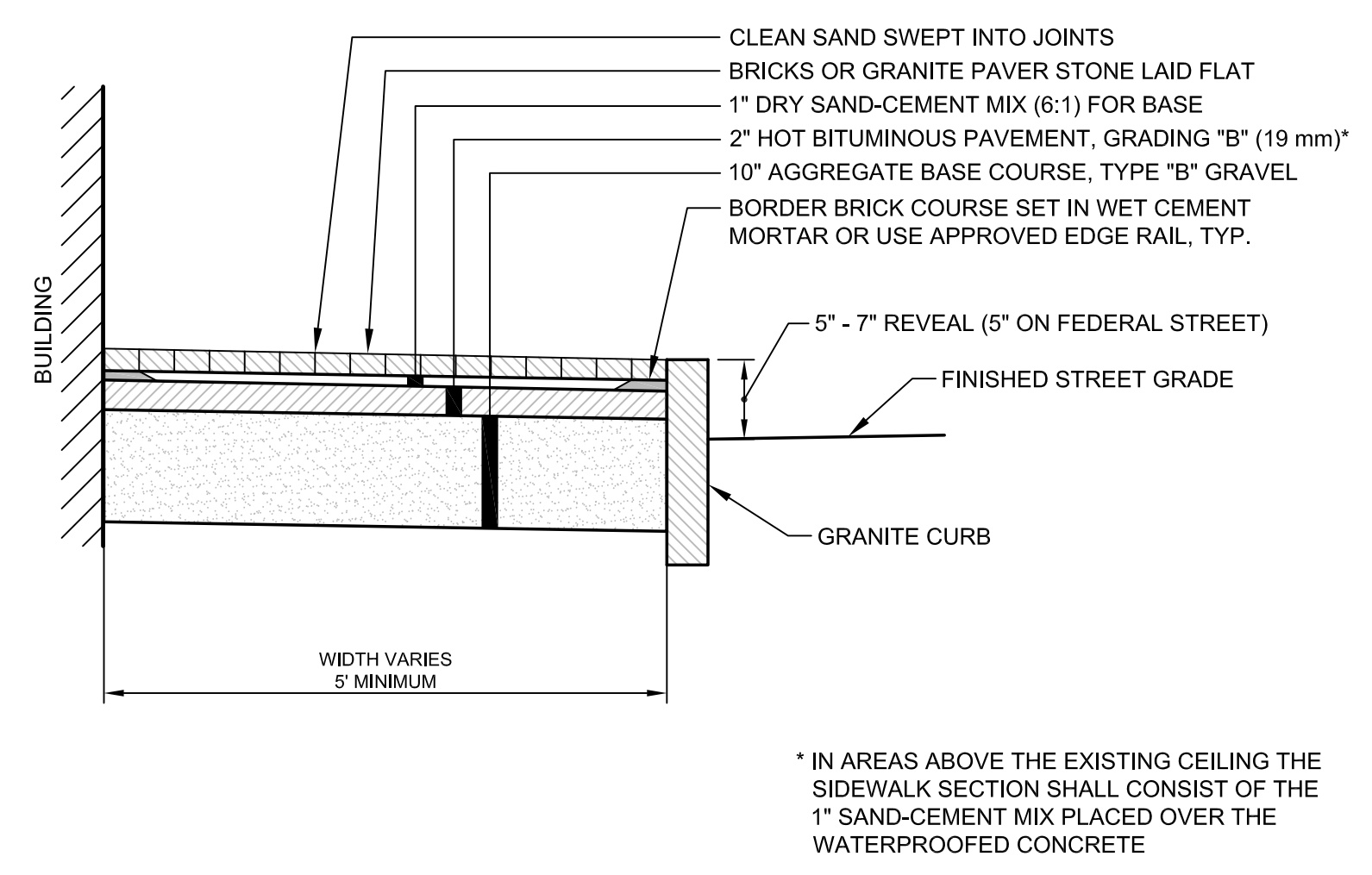

**BRICK SIDEWALK WITH BITUMINOUS BASE**  
N.T.S.

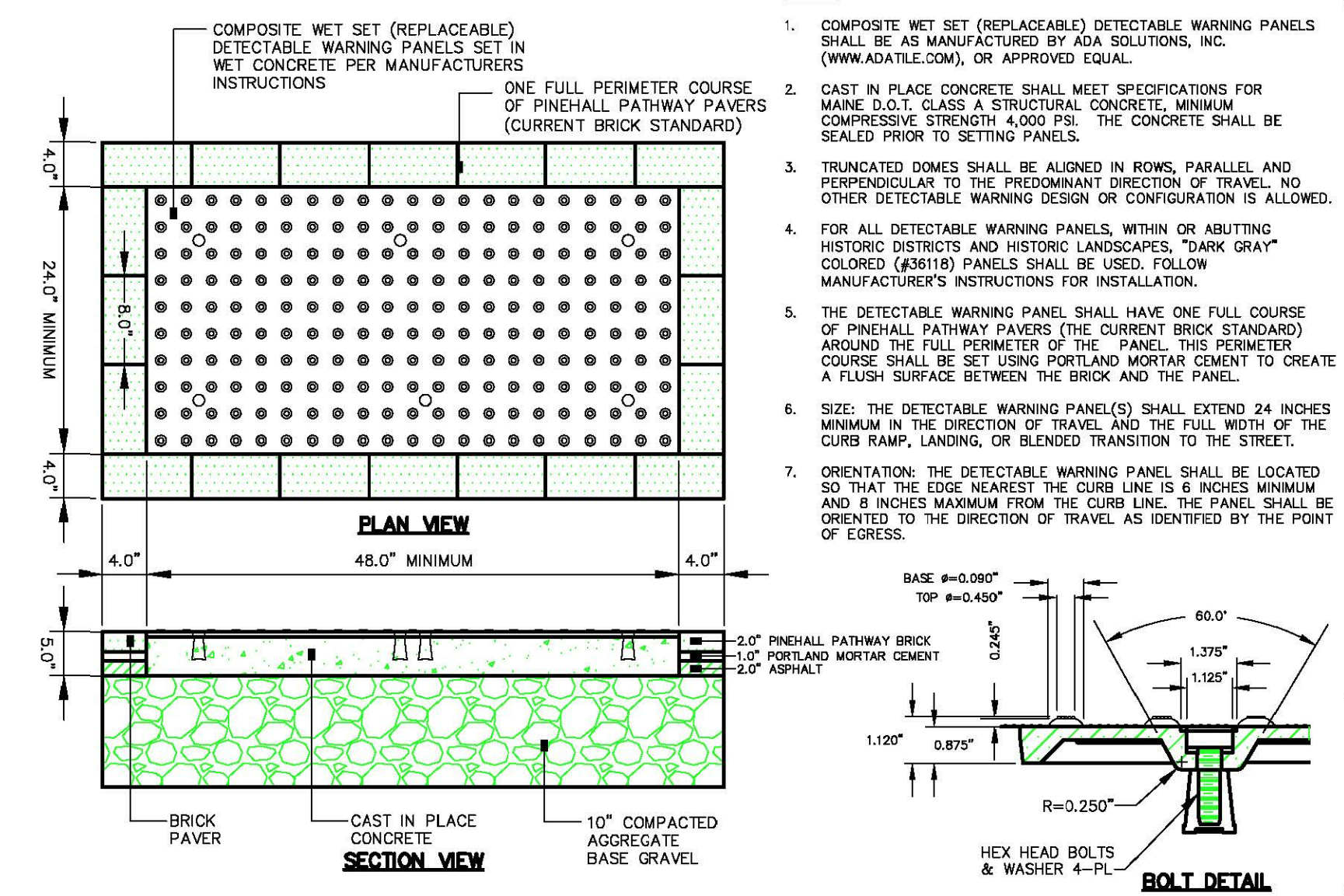

**SIDEWALK RAMP DETECTABLE WARNING PANEL (HISTORIC DISTRICTS AND LANDSCAPES)**  
N.T.S.

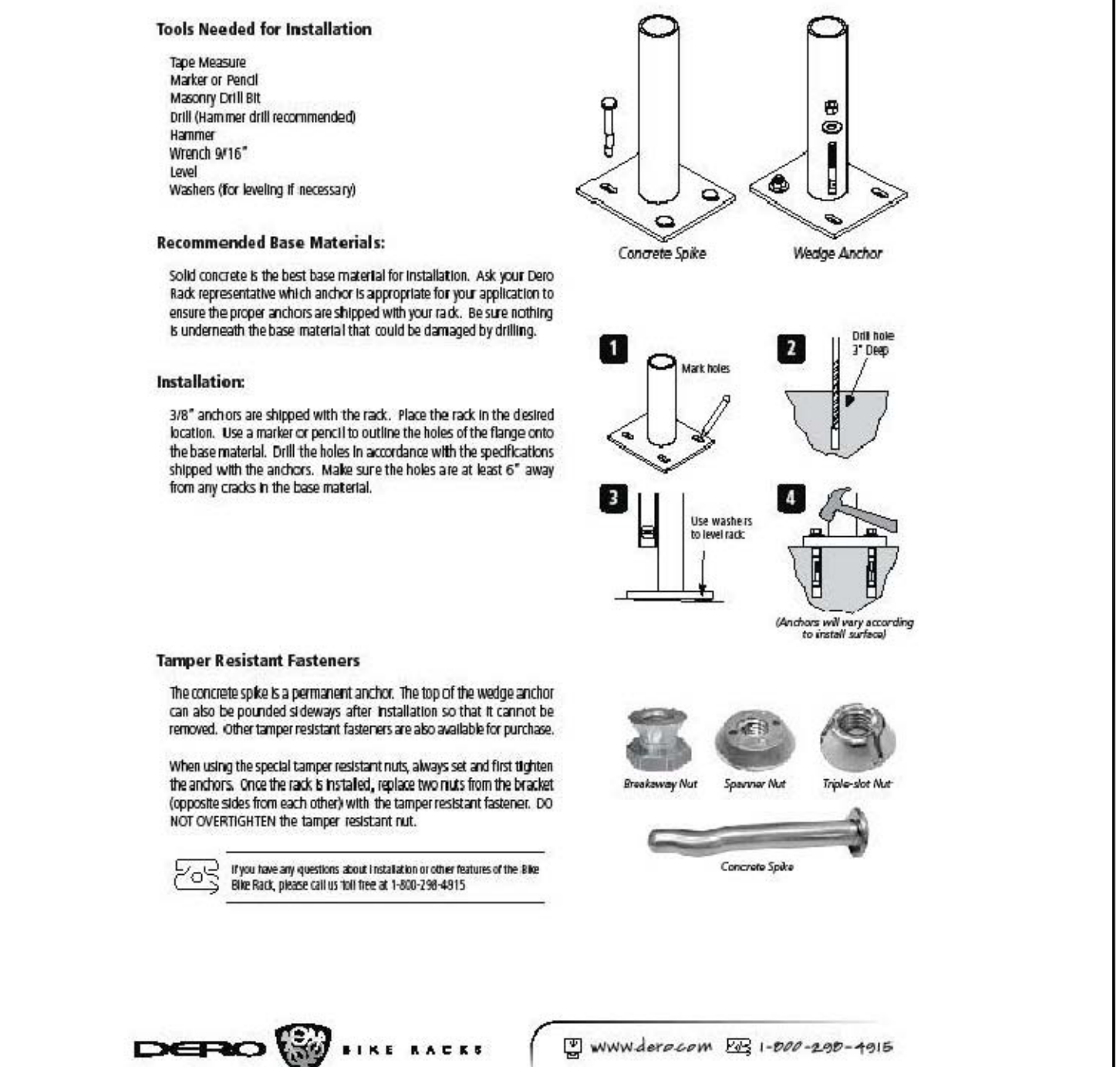

**Tools Needed for Installation:**  
Tape Measure, Marker or Pencil, Masonry Drill Bit, Drill (sumner drill recommended), Hammer, Wrench #16", Level, Washers (for leveling if necessary)

**Recommended Base Materials:**  
Solid concrete is the best base material for installation. Ask your Dero Rack representative which anchor is appropriate for your application to ensure the proper anchors are shipped with your rack. Be sure nothing is underneath the base material that could be damaged by drilling.

**Installation:**  
3/8" anchors are shipped with the rack. Place the rack in the desired location. Use a marker or pencil to outline the holes of the flange onto the base material. Drill the holes in accordance with the specifications shipped with the anchors. Make sure the holes are at least 6" away from any cracks in the base material.

**Tamper Resistant Fasteners:**  
The concrete spika is a permanent anchor. The top of the wedge anchor can also be pounded sideways after installation so that it cannot be removed. Other tamper resistant fasteners are also available for purchase. When using the special tamper resistant nuts, always set and first tighten the anchors. Once the rack is installed, tighten two nuts from the bracket (opposite sides from each other) with the tamper resistant nut. DO NOT OVERTIGHTEN the tamper resistant nut.

If you have any questions about installation in other regions of the site, please call or visit the website at 1-800-208-4915.



**BIKE HITCH - INSTALLATION INSTRUCTIONS SURFACE MOUNT**  
N.T.S.

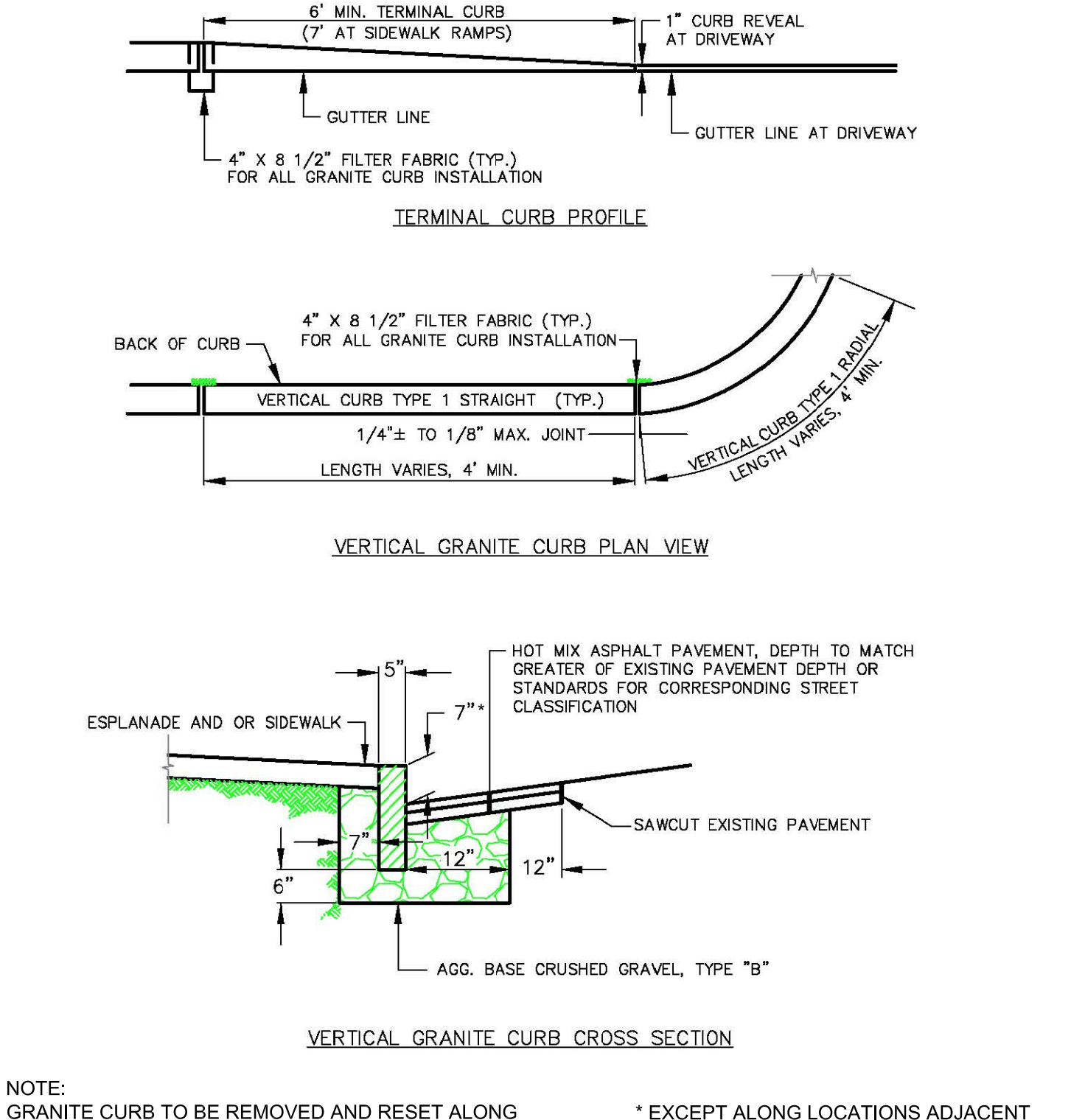

**NOTE:**  
GRANITE CURB TO BE REMOVED AND RESET ALONG ORIGINAL BUILDING LIMITS MAY MATCH EXISTING LIE. THE GRANITE STONE SITS ON A PORTION OF THE CONCRETE FOUNDATION BELOW.

\* EXCEPT ALONG LOCATIONS ADJACENT TO TREE WELLS WHERE CURB HEIGHT CAN BE REDUCED TO 5"

**VERTICAL GRANITE CURB INSTALLATION IN EXISTING STREETS**  
N.T.S.

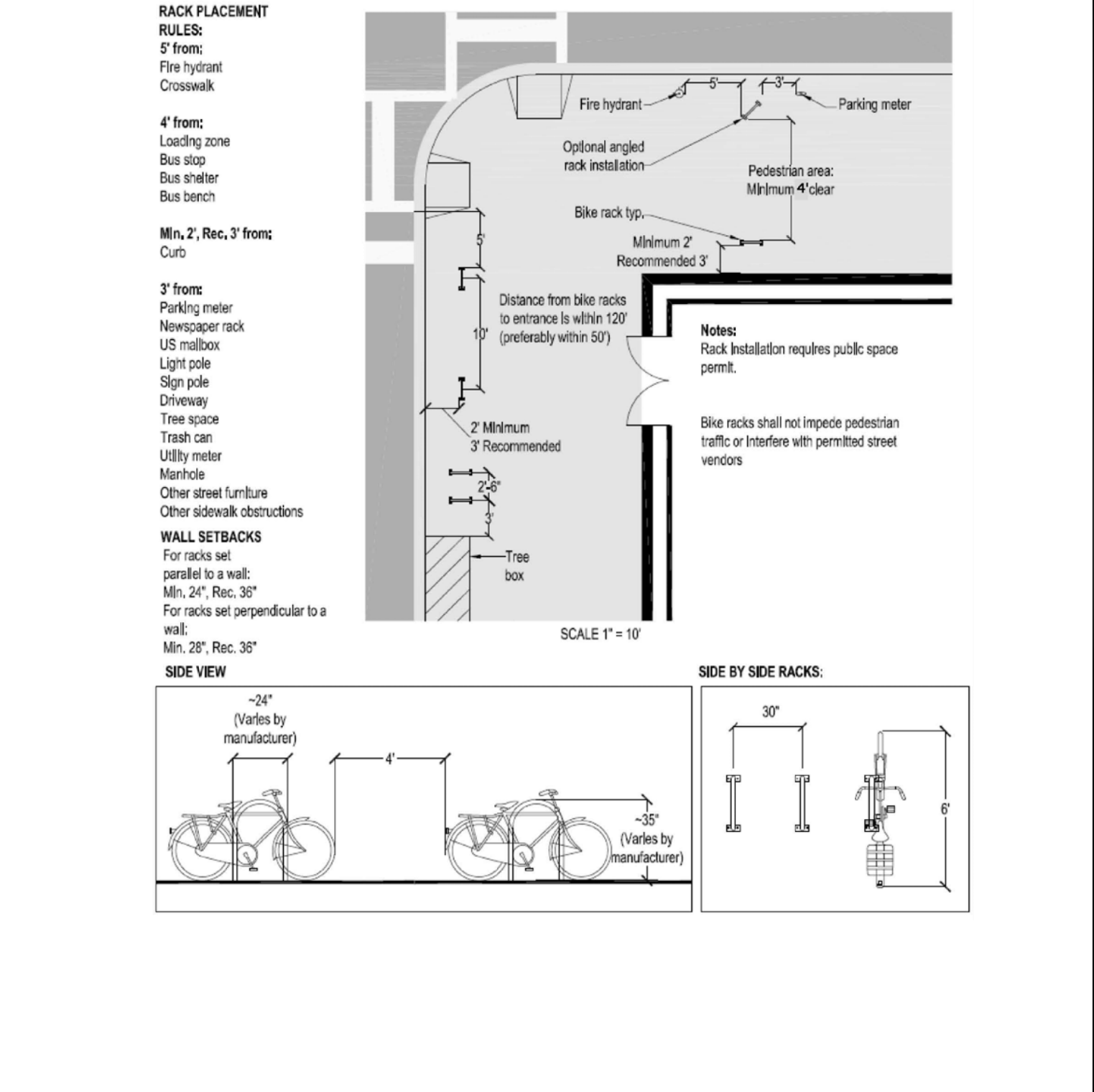

**BICYCLE PARKING RACK PLACEMENT**  
N.T.S.

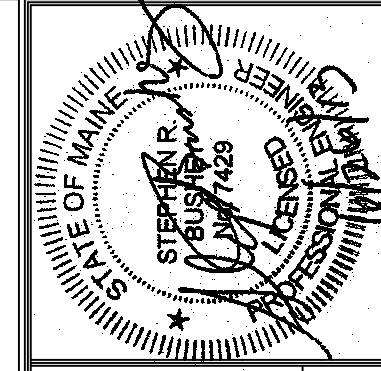

Prepared For:  
**119 Development, LLC**  
P.O. Box 7468  
Portland, ME 04112

Consultant:  
**EST ENGINEERS**  
FAY, SPOFFORD & THORNDIKE, INC.  
Since 1914  
778 MAINE ST. SUITE 400  
PORTLAND, ME 04108

Architect:  
**ARCHETYPE Architects**  
48 Union Wharf Portland, Maine 04101  
(207) 772-6022 Fax (207) 772-4056

Project:  
**Press Hotel**  
119 Exchange St.  
Portland, ME 04101

Revisions:  
10/14/13 Released for Bid  
08/29/13 Issued for 100% Design Review  
08/14/13 Issued for 60% Design Review and Pricing  
07/01/13 Issued for 30% Design Review and Pricing  
10/20/12 Final Submittal  
10/20/12 Submittal  
09/18/12 Preliminary Site Plan Application

Date: **01 JULY, 2013**  
Scale: **AS NOTED**  
**DETAILS**

**C4.01**