

**2 LOWER LEVEL - EDGE OF SLAB PLAN**  
1/8" = 1'-0"

SEE A1.01 FOR NEW WORK AND EDGE OF SLAB LEGEND AND GENERAL NEW WORK NOTES.  
SEE GN1.1 FOR GENERAL PROJECT NOTES

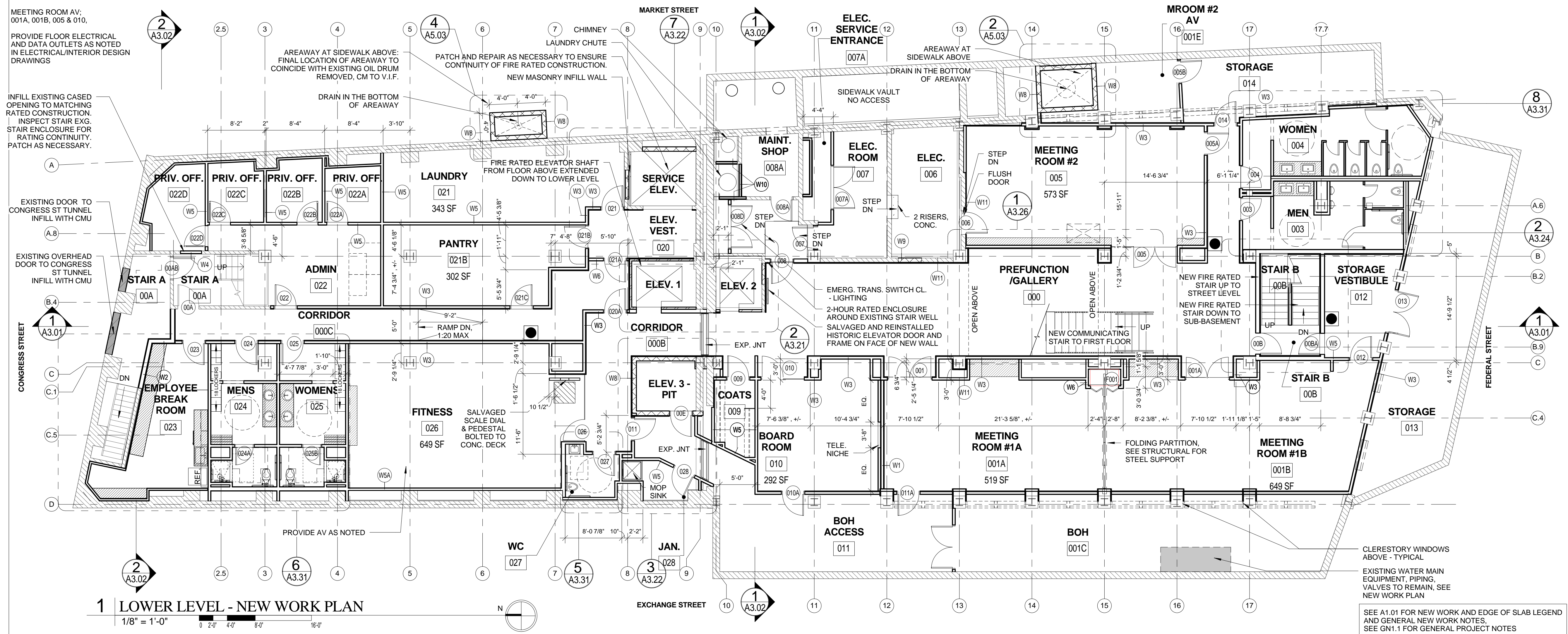

**1 LOWER LEVEL - NEW WORK PLAN**  
1/8" = 1'-0"

SEE A1.01 FOR NEW WORK AND EDGE OF SLAB LEGEND AND GENERAL NEW WORK NOTES.  
SEE GN1.1 FOR GENERAL PROJECT NOTES

MEETING ROOM AV; 001A, 001B, 005 & 010.  
PROVIDE FLOOR ELECTRICAL AND DATA OUTLETS AS NOTED IN ELECTRICAL/INTERIOR DESIGN DRAWINGS

INFILL EXISTING CASED OPENING TO MATCHING RATED CONSTRUCTION. INSPECT STAIR EXG. STAIR ENCLOSURE FOR RATING CONTINUITY. PATCH AS NECESSARY.

EXISTING DOOR TO CONGRESS ST TUNNEL INFILL WITH CMU

EXISTING OVERHEAD DOOR TO CONGRESS ST TUNNEL INFILL WITH CMU

INFILL EXISTING CASED OPENING TO MATCHING RATED CONSTRUCTION. INSPECT STAIR EXG. STAIR ENCLOSURE FOR RATING CONTINUITY. PATCH AS NECESSARY.

EXISTING DOOR TO CONGRESS ST TUNNEL INFILL WITH CMU

EXISTING OVERHEAD DOOR TO CONGRESS ST TUNNEL INFILL WITH CMU

AREAWAY AT SIDEWALK ABOVE. FINAL LOCATION OF AREAWAY TO COINCIDE WITH EXISTING OIL DRUM REMOVED, CM TO V.I.F.

PATCH AND REPAIR AS NECESSARY TO ENSURE CONTINUITY OF FIRE RATED CONSTRUCTION. NEW MASONRY INFILL WALL.

DRAIN IN THE BOTTOM OF AREAWAY

FIRE RATED ELEVATOR SHAFT FROM FLOOR ABOVE EXTENDED DOWN TO LOWER LEVEL

EMERG. TRANS. SWITCH CL. - LIGHTING

2-HOUR RATED ENCLOSURE AROUND EXISTING STAIR WELL

SALVAGED AND REINSTALLED HISTORIC ELEVATOR DOOR AND FRAME ON FACE OF NEW WALL

NEW FIRE RATED STAIR UP TO STREET LEVEL

NEW FIRE RATED STAIR DOWN TO SUB-BASEMENT

NEW COMMUNICATING STAIR TO FIRST FLOOR

FOLDING PARTITION. SEE STRUCTURAL FOR STEEL SUPPORT

CLERESTORY WINDOWS ABOVE - TYPICAL

EXISTING WATER MAIN EQUIPMENT, PIPING, VALVES TO REMAIN. SEE NEW WORK PLAN

Prepared For:  
**119 Development, LLC**  
P.O. Box 7486  
Portland, ME 04112

Consultant:  
**ARCHETYPE Architects**  
48 Union Wharf Portland, Maine 04101  
(207) 772-6022 Fax (207) 772-4056

Project:  
**PRESS HOTEL**  
390 CONGRESS STREET  
PORTLAND, ME 04101

Revisions:  
1 13.07-01 30% Marriott Submission  
2 13.09-09 60% Marriott Sub. & Pric.  
3 13.10-14 Issue for Bid & Marriott Review

Date: 14 OCT 13  
Scale: 1/8" = 1'-0"  
**LOWER LEVEL**

**A1.02**