

031-4-035

City of Portland, Maine – Building or Use Permit Application 389 Congress Street, 04101, Tel: (207) 874-8703, FAX: 874-8716

Location of Construction: 38 Union Wharf		Owner: Proprietors of Union Wharf		Phone:	Permit No: 970271
Owner Address:		Lessee/Buyer's Name:		Phone:	
Contractor Name: Proprietors of Union Wharf		Address: 36 Union Wharf P.O. Box 7467 DTS Portland, ME 04112		Phone: 772-8160	Permit Issued: PERMIT ISSUED APR - 1 1997 CITY OF PORTLAND Zone: CBE:
Past Use: Wharf		Proposed Use: Saw		COST OF WORK: \$ 5,000.00	
				PERMIT FEE: \$ 45.00	
		FIRE DEPT. <input type="checkbox"/> Approved <input type="checkbox"/> Denied		INSPECTION: Use Group: Type:	
Proposed Project Description: Install Concrete Pad (10 x 20) Yard outside storage of Gas Cylinders		Signature: <i>[Signature]</i>		Signature: <i>[Signature]</i>	
		PEDESTRIAN ACTIVITIES DISTRICT (P.A.D.)		Zoning Approval: <i>[Signature]</i>	
		Action: Approved <input type="checkbox"/> Approved with Conditions: <input type="checkbox"/> Denied <input type="checkbox"/>		Special Zone or Reviews: <input type="checkbox"/> Shoreland <input type="checkbox"/> Wetland <input type="checkbox"/> Flood Zone <input type="checkbox"/> Subdivision <input type="checkbox"/> Site Plan maj <input type="checkbox"/> minor <input type="checkbox"/> mm <input type="checkbox"/>	
Permit Taken By: <i>Mary Grezik</i>		Date Applied For: <i>27 March 1997</i>			

1. This permit application does not preclude the Applicant(s) from meeting applicable State and Federal rules.
2. Building permits do not include plumbing, septic or electrical work.
3. Building permits are void if work is not started within six (6) months of the date of issuance. False information may invalidate a building permit and stop all work..

Zoning Appeal

Variance
 Miscellaneous
 Conditional Use
 Interpretation
 Approved
 Denied

Historic Preservation

Not in District or Landmark
 Does Not Require Review
 Requires Review

Action:

Approved
 Approved with Conditions
 Denied

Date: _____

PERMIT ISSUED WITH REQUIREMENTS

CERTIFICATION

I hereby certify that I am the owner of record of the named property, or that the proposed work is authorized by the owner of record and that I have been authorized by the owner to make this application as his authorized agent and I agree to conform to all applicable laws of this jurisdiction. In addition, if a permit for work described in the application is issued, I certify that the code official's authorized representative shall have the authority to enter all areas covered by such permit at any reasonable hour to enforce the provisions of the code(s) applicable to such permit

[Signature]
SIGNATURE OF APPLICANT *Charlie Poole* ADDRESS: _____ DATE: *27 March 1997* PHONE: _____

RESPONSIBLE PERSON IN CHARGE OF WORK, TITLE _____ PHONE: _____

CEO DISTRICT

City of Portland, Maine – Building or Use Permit Application 389 Congress Street, 04101, Tel: (207) 874-8703, FAX: 874-8716

Location of Construction: 38 Union Wharf		Owner: Proprietors of Union Wharf		Phone:		Permit No: 970271	
Owner Address:		Lessee/Buyer's Name:		Phone:		BusinessName:	
Contractor Name: Proprietors of Union Wharf		Address: 36 Union Wharf P.O. Box 7467 DTS Ptld, ME 04112		Phone: 772-8160		Permit Issued: APR - 1 1997	
Past Use: Wharf		Proposed Use: Same		COST OF WORK: \$ 5,000.00		PERMIT FEE: \$ 45.00	
Proposed Project Description: Install Concrete Pad (10 x 20) Fore outside storage of Gas Cylinders		FIRE DEPT. <input checked="" type="checkbox"/> Approved <input type="checkbox"/> Denied		INSPECTION: Use Group: Type: 600496		CITY OF PORTLAND	
		Signature: <i>[Signature]</i>		Signature: <i>[Signature]</i>		Zone: CBL: <i>[Signature]</i> 031-L-035	
Permit Taken By: Mary Gresik		Date Applied For: 27 March 1997		PEDESTRIAN ACTIVITIES DISTRICT (P.A.D.)		Zoning Approval: <i>[Signature]</i>	
		Action: Approved <input type="checkbox"/> Approved with Conditions: <input type="checkbox"/> Denied <input type="checkbox"/>				Special Zone or Reviews: <input type="checkbox"/> Shoreland <input type="checkbox"/> Wetland <input type="checkbox"/> Flood Zone <input type="checkbox"/> Subdivision <input type="checkbox"/> Site Plan maj <input type="checkbox"/> minor <input type="checkbox"/> mm <input type="checkbox"/>	

1. This permit application does not preclude the Applicant(s) from meeting applicable State and Federal rules.
2. Building permits do not include plumbing, septic or electrical work.
3. Building permits are void if work is not started within six (6) months of the date of issuance. False information may invalidate a building permit and stop all work..

PERMIT ISSUED WITH REQUIREMENTS

CERTIFICATION

I hereby certify that I am the owner of record of the named property, or that the proposed work is authorized by the owner of record and that I have been authorized by the owner to make this application as his authorized agent and I agree to conform to all applicable laws of this jurisdiction. In addition, if a permit for work described in the application is issued, I certify that the code official's authorized representative shall have the authority to enter all areas covered by such permit at any reasonable hour to enforce the provisions of the code(s) applicable to such permit

SIGNATURE OF APPLICANT: *Charlie Poole* ADDRESS: DATE: 27 March 1997 PHONE:

RESPONSIBLE PERSON IN CHARGE OF WORK, TITLE PHONE:

White-Permit Desk Green-Assessor's Canary-D.P.W. Pink-Public File Ivory Card-Inspector

Zoning Appeal

Variance
 Miscellaneous
 Conditional Use
 Interpretation
 Approved
 Denied

Historic Preservation

Not in District or Landmark
 Does Not Require Review
 Requires Review

Action:

Approved
 Approved with Conditions
 Denied

Date: *3/31/97*

[Signature]

CEO DISTRICT **2**
A. Rowell

PROPRIETORS OF UNION WHARF

36 UNION WHARF - P.O. BOX 7467 DTS

PORTLAND, MAINE 04112

MARCH 27, 1997

CITY OF PORTLAND
INSPECTIONS DEPT.
PORTLAND, MAINE 04101

DEAR INSPECTIONS:

THE PROPRIETORS OF UNION WHARF WOULD LIKE TO APPLY FOR 2 BUILDING PERMITS. PLEASE LET ME KNOW IF YOU HAVE ANY QUESTIONS OR NEED OTHER INFORMATION. THANK YOU.

PERMIT #1

ON SITE PLAN, SEE BUILDING #38. ON THE SOUTH END WE WOULD LIKE TO BUILD A 10' X 20' CEMENT PAD FOR OUTSIDE STORAGE OF CYLINDERS THAT WE SUPPLY TO TANKERS THAT ARE IN PORT. WE SERVE THEM THROUGH OUR COMPANY, BROWN SHIP CHANDLERY, INC..

THE PAD WOULD BE 10" THICK AND HAVE 2 LAYERS OF #5 REBAR ON 6" SQ., THE CONCRETE WOULD BE 4000 PSI MIX. THERE WILL BE A BROOM FINISH TO THE SURFACE. THERE WILL BE A CHAINLINK FENCE ON THREE SIDES AND A WEATHER SHED ROOF ON TOP. THERE WILL NOT BE ANY WALLS EXCEPT FOR THE BACK OF #38 WHERE THIS IS TO BE BUILT.

ACCESS TO THIS AREA IS THROUGH JERSEY BARRICADES. THIS SITE IS NOT RIGHT ON OUR MAIN ROADWAY, YOU MUST TURN IN OFF THE ROADWAY TO ACCESS THE FENCED PAD.

PERMIT #2

ON THE SITE PLAN, SEE BUILDING #48. ON THE NORTH WALL INSIDE THE PORTLAND PILOTS WAREHOUSE, WE WOULD LIKE TO REACTIVATE AND PLACE A BATHROOM MEASURING 8' X 10'. THE SEWER LINE AND WATER WERE PLACED THERE WHEN THE BUILDING WAS BUILT.

THE CONSTRUCTION WILL BE: 2X4 WALLS, 16" OC., WALLS WILL BE SHEETROCKED AND PAINTED. THERE WILL BE A TOILET AND SINK AND A LIGHT. THERE WILL NOT BE ANY WINDOWS. ACCESS TO THIS BATHROOM WILL BE FROM WITHIN THE WAREHOUSE ONLY. THIS ROOM HAS 3 MEANS OF EGRESS.

THANK YOU.

SINCERELY,

CHARLES A. POOLE
VICE PRESIDENT

PROPRIETORS OF UNION WHARF
36 UNION WHARF - P.O. BOX 7467 DTS
PORTLAND, MAINE 04112

JOB _____
SHEET NO. _____ OF _____
CALCULATED BY _____ DATE _____
CHECKED BY _____ DATE _____
SCALE _____

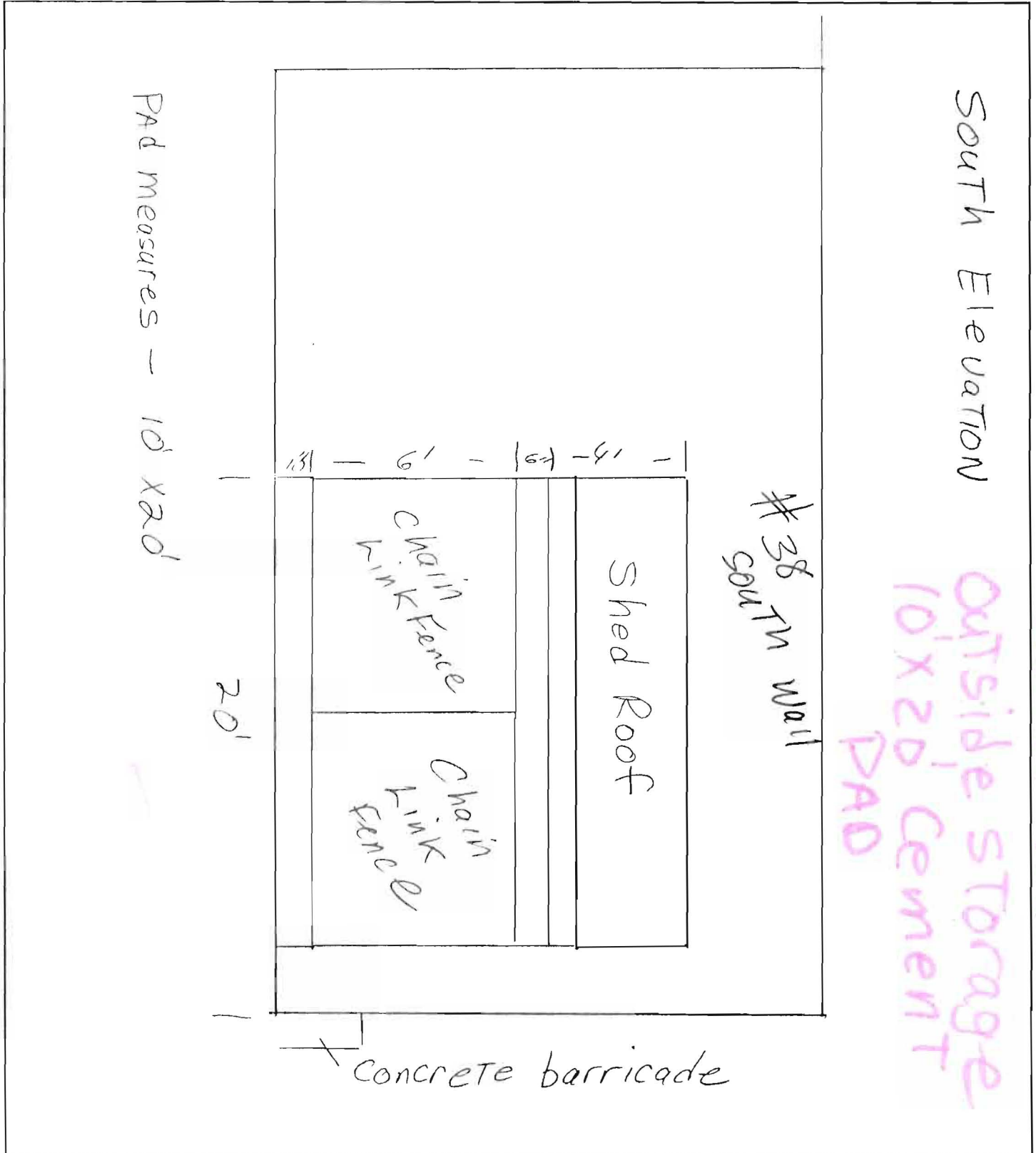

PROPRIETORS OF UNION WHARF
36 UNION WHARF - P.O. BOX 7467 DTS
PORTLAND, MAINE 04112

JOB _____
SHEET NO. _____ OF _____
CALCULATED BY _____ DATE _____
CHECKED BY _____ DATE _____
SCALE _____

Ariel View:

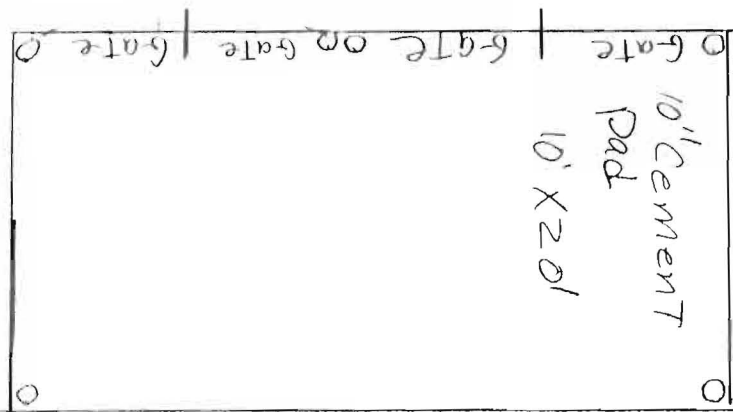

Barricade
Barricade

Permit #1
Outside Storage
10' x 20' cement
Pad

Building #38

Union Wharf Roadway

West side

commercial st. 

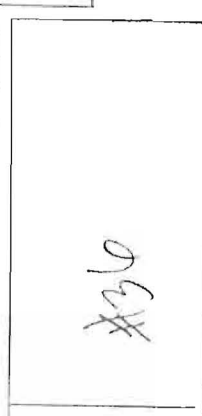
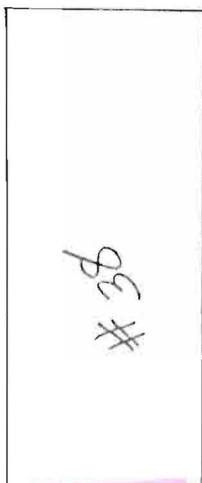
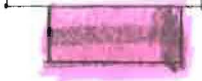
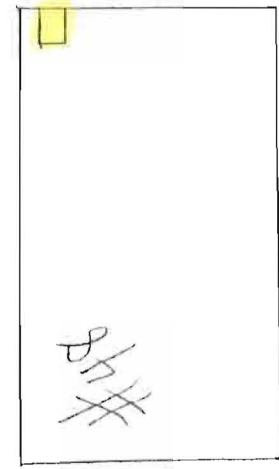

 TO Harbor

EAST side



= site for 10'x20' cement Pad

= site for 8'x10' Bathroom

~~site for 10'~~

~~site for 8'~~



PROPRIETORS OF UNION WHARF
 36 UNION WHARF - P.O. BOX 7467 DTS
 PORTLAND, MAINE 04112

JOB _____
 SHEET NO. _____
 CALCULATED BY _____
 CHECKED BY _____
 SCALE _____

FIRE CODE PERMIT REPORT

DATE: 3/21/13 ADDRESS: 18000 SW 10th St

PERMIT TO: Removal of LP tanks

OWNER/CONTRACTOR: S. Green

APPROVED 7/11/13 DENIED _____

CONDITIONS OF APPROVAL/DENIAL

1. The boiler or furnace shall be protected by enclosing with one hour fire rated construction including fire doors and ceiling or by providing automatic extinguishment and smoke protected enclosure. Sprinkler piping serving not more than six sprinklers may be connected to a domestic water supply system having a capacity sufficient to provide a 0.15 gpm, per square foot of floor throughout the entire area. An indicating shut-off valve shall be installed in an accessible location between the sprinkler and the connection to the domestic water supply. Minimum pipe size shall be 3/4 inch copper or 1 inch steel. Maximum coverage area of a residential sprinkler is 144 square feet per sprinkler.
2. All required Fire Alarm Systems shall have the capability of "Zone Disconnect" via switches or key pad program provided the method is approved by the Fire Prevention Bureau.
3. All remote annunciators shall have a visible "trouble" indicator along with the Fire Alarm "Zone" indicators.
4. Any Master Box connected to the Municipal Fire Alarm System shall have a supervised Municipal Disconnect Switch.
5. All Master Box locations shall be approved by the Fire Department Director of Communications. A Master Box shall be located so that the center of the box is five feet above finished floor.
6. All Master Box locations are required to have a locked box (knoxbox).
7. A fire alarm acceptance report shall be submitted to the Portland Fire Department.
8. All underground tank removal(s) and/or installation(s) shall be done in accordance with the Department of Environmental Regulations (Chapter 691).
9. No cutting of tanks on site. Cutting of tanks is to be done at an approved tank disposal site.
10. Fire Dispatcher must be at least 48 hours in advance of removal and/or transportation of tanks.
11. All above ground L/P storage tanks shall be located in accordance with NFPA 58 Standards.
12. Any tank located near the path of vehicle movement shall be protected with appropriate permanent barricades.

13. All piping shall be protected from possible mechanical damage and vandalism.
14. A 4" storz fire department connection is required.
15. Any new sprinkler construction over six sprinkler heads needs to have State Fire Marshal approval.
16. Any renovations of sprinkler systems over 20 sprinkler heads needs to have State Fire Marshal approval.
17. A sprinkler performance test shall be submitted to the Portland Fire Department after completion of sprinkler work.
18. State Fire Marshal approval is required for this project.

Lt. G. McDougall
Lt. G. McDougall
Fire Prevention Officer
City of Portland