

GUEST BATH DETAIL

EXISTING

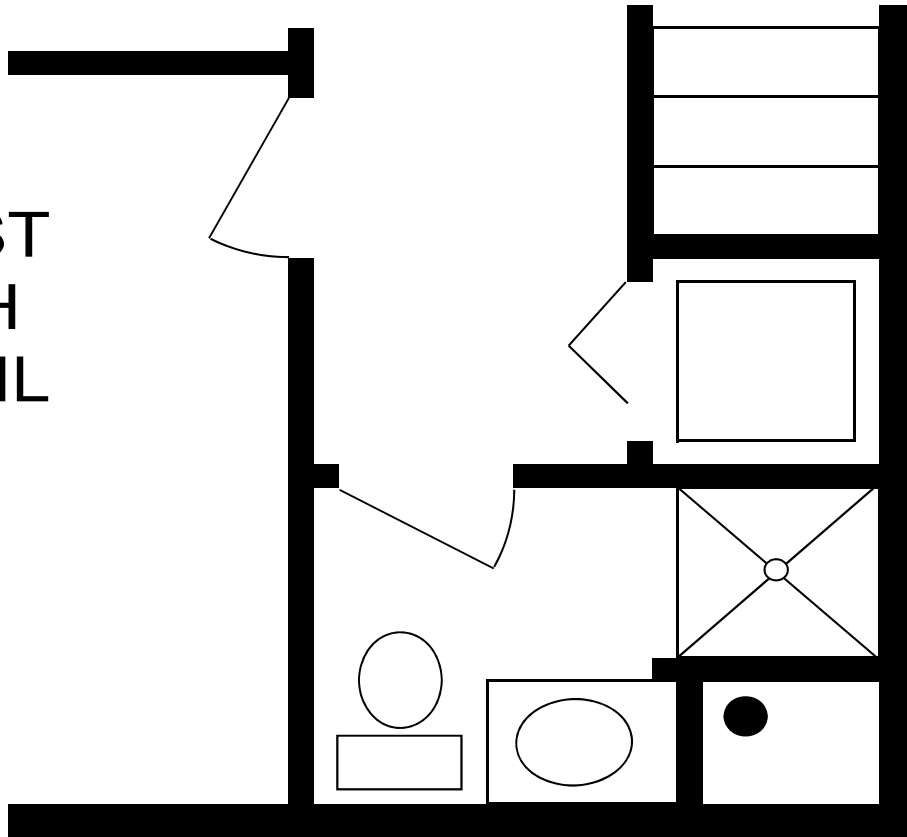

PROPOSED

- 2'6" TUB FRAMED INTO EXISTING BEDROOM SPACE
- TILE AROUND TUB/SHOWER
- 42" VANITY
- MOVE TOILET TO EXISTING SHOWER ALCOVE
- MOVE BATH DOOR WALL OUT TO OTHER SIDE OF WASHER DRYER DOOR
- HARDWOOD IN BATHROOM

