

PORTLAND PIER

LINE BASED ON POINTS #42 AND #43 ON ARMY CORPS FEDERAL PROJECT CHANNEL NAVIGATION POINTS

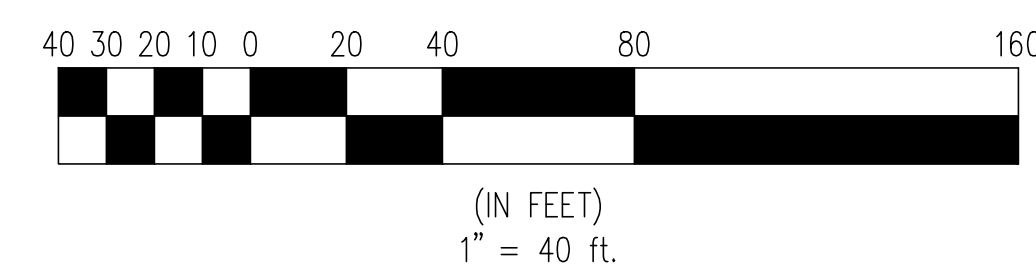
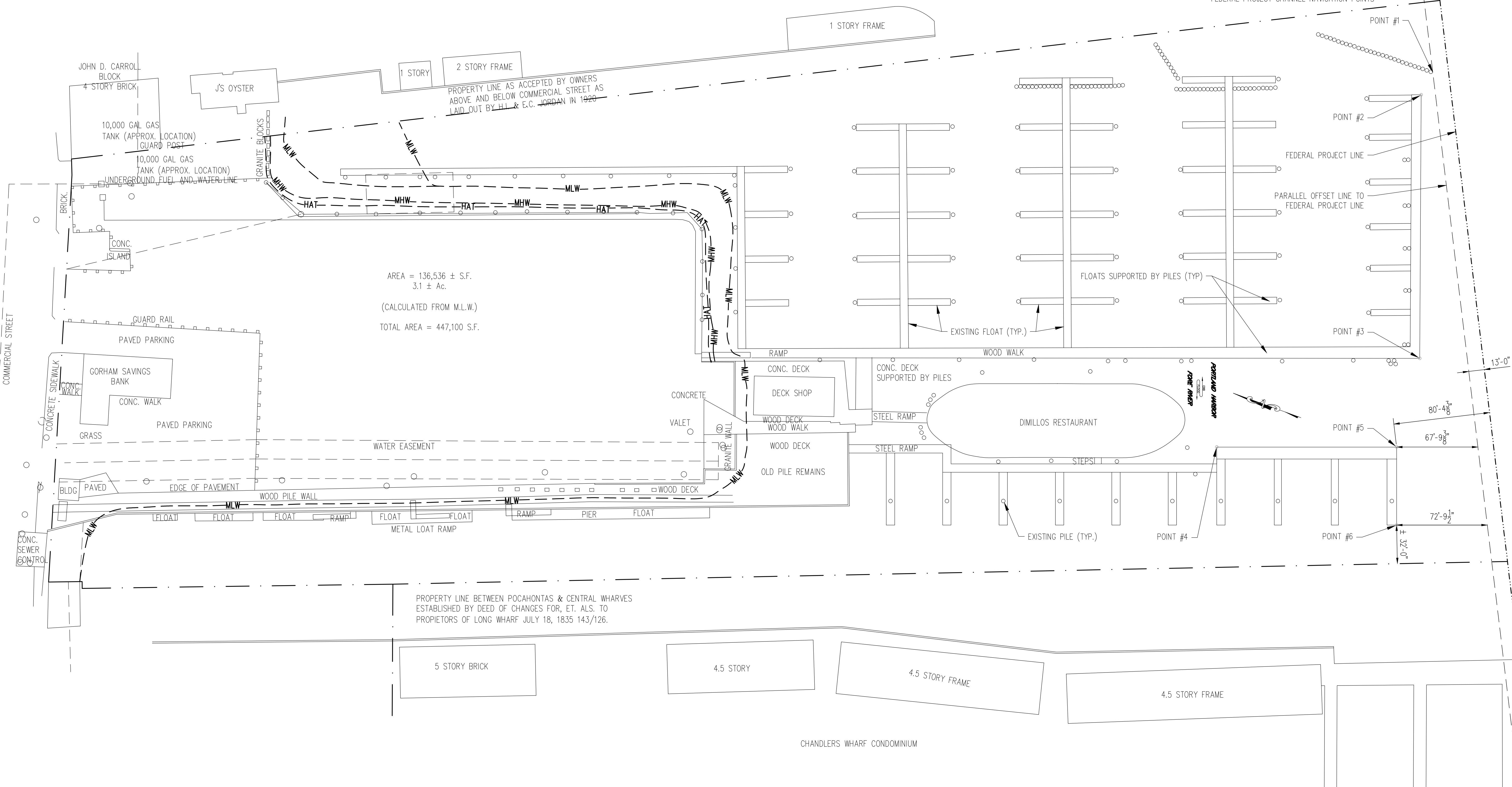

LEGEND

APPROX PROPERTY LINE ———

HIGH ANNUAL TIDE LINE ———

MEAN HIGH WATER LINE ———

MEAN LOW WATER LINE ———

EXISTING PILES ○

NEW PILES ●

HAT ———

MHW ———

MLW ———

POINT TABLE

POINT #	NORTHING	EASTING
#1	299119.02	2930978.85
#2	299114.85	2930958.04
#3	298980.63	2930784.33
#4	299053.87	2930633.12
#5	298950.28	2930714.23
#6	298909.12	2930665.49
#42	298568.38	2930444.91
#43	301513.71	2933399.92

FOR PERMITTING PURPOSES ONLY

CITY OF PORTLAND
PORTLAND, MAINE

DIMILLO'S FLOAT EXTENSION
EXISTING SITE PLAN

TEC ASSOCIATES CONSULTING ENGINEERS
46 SAWYER STREET SOUTH PORTLAND, MAINE 04106

SCALE AS SHOWN DATE 1 MAY 2014

JOB NUMBER 1326-1 DRAWN BY NJR DESIGNED BY SFD DRAWING NO. 1 OF 3