

DISPLAY THIS CARD ON PRINCIPAL FRONTAGE OF WORK



# CITY OF PORTLAND BUILDING PERMIT

This is to certify that FLATBREAD WHARF, LLC

Located At 70 COMMERCIAL ST

Job ID: 2012-01-3083-ALTCOMM

CBL: 030- D-003-001

has permission to Remove existing roofing layers & Replace with new insulation and EPDM  
provided that the person or persons, firm or corporation accepting this permit shall comply with all of the provisions of  
the Statues of Maine and of the Ordinances of the City of Portland regulating the construction, maintenance and use of  
the buildings and structures, and of the application on file in the department.

Notification of inspection and written permission procured  
before this building or part thereof is lathed or otherwise  
closed-in. 48 HOUR NOTICE IS REQUIRED.

A final inspection must be completed by owner  
before this building or part thereof is occupied. If a  
certificate of occupancy is required, it must be

\_\_\_\_\_  
**Fire Prevention Officer**

*[Signature]*  
\_\_\_\_\_  
**Code Enforcement Officer / Plan Reviewer**

THIS CARD MUST BE POSTED ON THE STREET SIDE OF THE PROPERTY  
PENALTY FOR REMOVING THIS CARD

**City of Portland, Maine - Building or Use Permit Application**

389 Congress Street, 04101 Tel: (207) 874-8703, FAX: (207) 8716

Job No: 2012-01-3083-ALTCOMM	Date Applied: 1/11/2012	CBL: 030- D-003-001	
Location of Construction: 70 COMMERCIAL ST (72)	Owner Name: FLATBREAD WHARF, LLC	Owner Address: 7 MARKET SQ  AMESBURY, MA 01913	Phone:
Business Name: Flatbreads	Contractor Name: Lambert Roofing, Inc. - Jim Rousseau	Contractor Address: 265 Winter St., Haverhill, MA 01830	Phone: 978-374-9224
Lessee/Buyer's Name:	Phone:	Permit Type: BLDG - Building	Zone: WCZ
Past Use: Restaurant - Flatbreads	Proposed Use: Same - Restaurant - Flatbreads- replace roof	Cost of Work: 41000.00	CEO District:
		Fire Dept: <input checked="" type="checkbox"/> Approved <input type="checkbox"/> Denied <input type="checkbox"/> N/A	Inspection: Use Group: A-2 Type: N/A DBC-2019
		Signature: <i>[Signature]</i> (58)	Signature: <i>[Signature]</i>
Proposed Project Description: roof removal & replace		Pedestrian Activities District (P.A.D.)  2/2/12	
Permit Taken By:		<b>Zoning Approval</b>	

<p>1. This permit application does not preclude the Applicant(s) from meeting applicable State and Federal Rules.</p> <p>2. Building Permits do not include plumbing, septic or electrical work.</p> <p>3. Building permits are void if work is not started within six (6) months of the date of issuance. False informatin may invalidate a building permit and stop all work.</p>	<p><b>Special Zone or Reviews</b></p> <p><input type="checkbox"/> Shoreland</p> <p><input type="checkbox"/> Wetlands</p> <p><input type="checkbox"/> Flood Zone</p> <p><input type="checkbox"/> Subdivision</p> <p><input type="checkbox"/> Site Plan</p> <p><input type="checkbox"/> Maj <input type="checkbox"/> Min <input type="checkbox"/> MM</p> <p>Date: OK 11/3/12 <i>ARM</i></p>	<p><b>Zoning Appeal</b></p> <p><input type="checkbox"/> Variance</p> <p><input type="checkbox"/> Miscellaneous</p> <p><input type="checkbox"/> Conditional Use</p> <p><input type="checkbox"/> Interpretation</p> <p><input type="checkbox"/> Approved</p> <p><input type="checkbox"/> Denied</p> <p>Date:</p>	<p><b>Historic Preservation</b></p> <p><input checked="" type="checkbox"/> Not in Dist or Landmark</p> <p><input type="checkbox"/> Does not Require Review</p> <p><input type="checkbox"/> Requires Review</p> <p><input type="checkbox"/> Approved</p> <p><input type="checkbox"/> Approved w/Conditions</p> <p><input type="checkbox"/> Denied</p> <p>Date: <i>ARM</i></p>
	<b>CERTIFICATION</b>		

I hereby certify that I am the owner of record of the named property, or that the proposed work is authorized by the owner of record and that I have been authorized by the owner to make this application as his authorized agent and I agree to conform to all applicable laws of this jurisdiction. In addition, if a permit for work described in the application is issued, I certify that the code official's authorized representative shall have the authority to enter all areas covered by such permit at any reasonable hour to enforce the provision of the code(s) applicable to such permit.

SIGNATURE OF APPLICANT	ADDRESS	DATE	PHONE
RESPONSIBLE PERSON IN CHARGE OF WORK, TITLE		DATE	PHONE

## BUILDING PERMIT INSPECTION PROCEDURES

Please call 874-8703 or 874-8693 (ONLY)

or email: [buildinginspections@portlandmaine.gov](mailto:buildinginspections@portlandmaine.gov)

With the issuance of this permit, the owner, builder or their designee is required to provide adequate notice to the city of Portland Inspections Services for the following inspections. Appointments must be requested 48 to 72 hours in advance of the required inspection. The inspection date will need to be confirmed by this office.

- **Please read the conditions of approval that is attached to this permit!! Contact this office if you have any questions.**
- **Permits expire in 6 months. If the project is not started or ceases for 6 months.**
- **If the inspection requirements are not followed as stated below additional fees may be incurred due to the issuance of a "Stop Work Order" and subsequent release to continue.**

Close In Elec/Plmb/Frame prior to insulate or gyp

Final Inspection

The project cannot move to the next phase prior to the required inspection and approval to continue, REGARDLESS OF THE NOTICE OF CIRCUMSTANCES.

IF THE PERMIT REQUIRES A CERTIFICATE OF OCCUPANCY, IT MUST BE PAID FOR AND ISSUED TO THE OWNER OR DESIGNEE BEFORE THE SPACE MAY BE OCCUPIED.



# PORTLAND MAINE

*Strengthening a Remarkable City, Building a Community for Life • [www.portlandmaine.gov](http://www.portlandmaine.gov)*

Director of Planning and Urban Development  
Penny St. Louis

Job ID: 2012-01-3083-ALTCOMM

Located At: 70 COMMERCIAL  
ST

CBL: 030- D-003-001

## **Conditions of Approval:**

### **Building**

1. Application approval based upon information provided by applicant. Any deviation from approved plans requires separate review and approval prior to work.

WCL

2012 01 30 83

66



# General Building Permit Application

If you or the property owner owes real estate or personal property taxes or user charges on any property within the City, payment arrangements must be made before permits of any kind are accepted.

Location/Address of Construction: <u>72 COMMERCIAL ST PORTLAND MAINE 04101</u>		
Total Square Footage of Proposed Structure/Area <u>5000 S.F R E ROOF PROJECT</u>		Square Footage of Lot
Tax Assessor's Chart, Block & Lot Chart#      Block#      Lot# <u>030      D      003</u>	Applicant * <u>must be owner, Lessee or Buyer</u> * Name Address City, State & Zip	Telephone:
Lessee/DBA (If Applicable) <u>Flatbread.</u>	Owner (if different from Applicant) Name <u>Flatbread Mkt LLC</u> Address <u>7 Market Sq.</u> City, State & Zip <u>Amesbury MA 01913</u>	Cost Of Work: \$ <u>41,000.00</u> C of O Fee: \$ <u>430-</u> Total Fee: \$ <u>430-</u>
Current legal use (i.e. single family) <u>RESTAURANT/RETAIL</u> If vacant, what was the previous use? _____ Proposed Specific use: _____ Is property part of a subdivision? _____ If yes, please name _____ Project description: <u>ROOF REMOVAL AND REPLACE SEE ATTACHED FOR EXISTING &amp; NEW ROOF COMPOSITION.</u>		
Contractor's name: <u>LAMBERT ROOFING INC</u> Address: <u>265 WINTER ST</u> City, State & Zip: <u>HAVERHILL MA. 01830</u> Telephone: <u>978 374 9224</u> Who should we contact when the permit is ready: <u>JIM ROUSSEAU</u> Telephone: <u>978-230-1349</u> Mailing address: <u>SAME AS ABOVE</u>		

By mail

Please submit all of the information outlined on the applicable Checklist. Failure to do so will result in the automatic denial of your permit.

In order to be sure the City fully understands the full scope of the project, the Planning and Development Department may request additional information prior to the issuance of a permit. For further information or to download copies of this form and other applications visit the Inspections Division on-line at [www.portlandmaine.gov](http://www.portlandmaine.gov), or stop by the Inspections Division office, room 315 City Hall or call 874-8703.

I hereby certify that I am the Owner of record of the named property, or that the owner of record authorizes the proposed work and that I have been authorized by the owner to make this application as his/her authorized agent. I agree to conform to all applicable laws of this jurisdiction. In addition, if a permit for work described in this application is issued, I certify that the Code Official's authorized representative shall have the authority to enter all areas covered by this permit at any reasonable hour to enforce the provisions of the codes applicable to this permit.

Signature: J. Rousseau Estimator Date: 1/6/12 RECEIVED

This is not a permit; you may not commence ANY work until the permit is issued. JAN 11 2012

Dept. of Building Inspections  
City of Portland Maine

TGLRC INC. LAMBERT ROOFING CO.  
IN BUSINESS SINCE 1932

265 WINTER ST. HAVERHILL, MA (978) 374-9224  
(FAX) 521-5791 OR VIA E-MAIL  
LAMBERTROOFING@AOL.COM OR VISIT US ON THE  
WEB@ WWW.LAMBERTROOFING.NET

LETTER OF TRANSMITTAL

DATE: JANUARY 6, 2011

ATTENTION: LANNIE

RE: FLAT BREAD REROOF PROJECT  
72 Commercial St  
Portland Maine 04101

TO: Portland City Hall Planning and Development Dept.  
Inspection Division Room 315  
389 Congress St  
Portland Maine 04101

WE ARE SENDING YOU THE FOLLOWING ITEMS:

1. General Building permit filled out as pertaining to re roof project
2. Signed proposal and Scope of work
3. Roof drawing and dumpster location
4. Cross section of existing roof and new roof
5. Existing roof top photos

Please call with any questions and concerns:

Sincerely

Jim Rousseau

Estimator/PM

TGLRC

August 16, 2006



# Our Proof is on Your Roof!

## **T.G.L.R.C**

265 Winter St Haverhill MA 01830  
Phone 978-374-9224  
Fax 978-521-5791

December 1, 2011

**RE: Roof Installation (not to exceed 5000 S.F)**  
**Flat-bread Company**  
**72 Commercial St.**  
**Portland Maine 04101-4749**

**TO: Joni Jackman**  
**603-502-7604**

**Lambert Roofing Inc. proposes the following:**

### **Roof Installation REVISED ALTERNATE #3**

- Remove existing EPDM rubber roofs to expose original tar and gravel wood deck  
Note: Damaged rotted decking replaced at the rate of \$2.95 per square foot

### **Supply and Install the Following:**

- 1-one layer of 3" Polyisocyanurate (R-value 18.1) mechanically fastened over existing tar and gravel using screws and plates per manufactures specifications.
- Install fully adhered PVC White rubber roof system per manufactures specifications and details complete with a 15 Year Manufactures Warranty
- Flashing for 3 roof drains and 2 overflow scuppers per manufactures specifications and details
- Flashing for roof top penetrations per manufactures specifications and details, 3 ea Hot stack furnace flues ,4 ea VTR plumbing vents, 5 ea 5'X5' HVAC unit, 3 ea 3'X3' EF
- New .040 Kynar finish aluminum drip edge (in standard colors) to entire perimeter edge.

**TOTAL JOB COST.....FORTY ONE THOUSAND DOLLARS \$41,000.00**

**Job to be completed January 2012 weather permitting as discussed**

**General Exclusions:** siding, fascia metals and wood Conduit/lighting fixtures beneath roof deck, ponding water, winter conditions, snow shoveling, weather delays, rotten/damaged decking, prevailing wages, union labor, asbestos, Police details, parking permits/fees. **Notes:** Any additional work beyond the above scope of work will be done at a rate of \$65.00 per man per hour for roofing plus materials. Lambert Roofing requires access next to building for trucks, and crane. We may withdraw this proposal if not accepted within (30) days. **Payment:** 1/3 Deposit /1/3 50% completion /Balance due upon completion

Date: 12/23/11

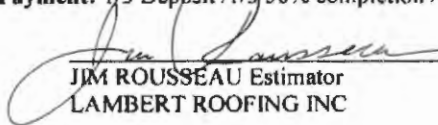
  
JIM ROUSSEAU Estimator  
LAMBERT ROOFING INC

**Acceptance:** The above prices, specifications and conditions are satisfactory and are hereby accepted. You are authorized to do the work as specified. Payments will be made as outlined above.

Date: 12/23/11

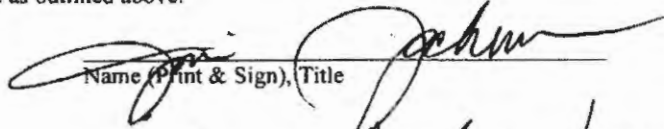
  
Name (Print & Sign), Title

*Pls let me know before hand when work will be started.  
Thanks!*



72: COMMERCIAL S

LOWER NIC

UPPER NIC

5000 S.F AREA TO BE RODDED

DUMPSTER LOCATION

Imagery Date: 5/16/2010 1997

43°39'25.93" N 70°14'59.56" W elev 5 ft

© 2011 Google

© 2011 Europa Technologies

Google earth

Eye all 190 ft



**TGLRC INC. DBA  
LAMBERT ROOFING  
COMPANIES, INC.**

265 Winter Street  
Haverhill, MA 01832  
(978) 374-9224 - Lawrence, MA (978) 687-7339  
Fax # (978) 521-5791

PORTLAND MAINE  
72 COMMERCIAL ST  
JOB FLATBREARDS

SHEET NO. \_\_\_\_\_ OF \_\_\_\_\_  
CALCULATED BY \_\_\_\_\_ DATE 1/6/12  
CHECKED BY \_\_\_\_\_ DATE \_\_\_\_\_  
SCALE NTS

## EXISTING ROOF COMPOSITION

→ EXISTING ROOF TO BE REMOVED TO EXPOSE ORIGINAL TAR & GRAVEL ROOF,

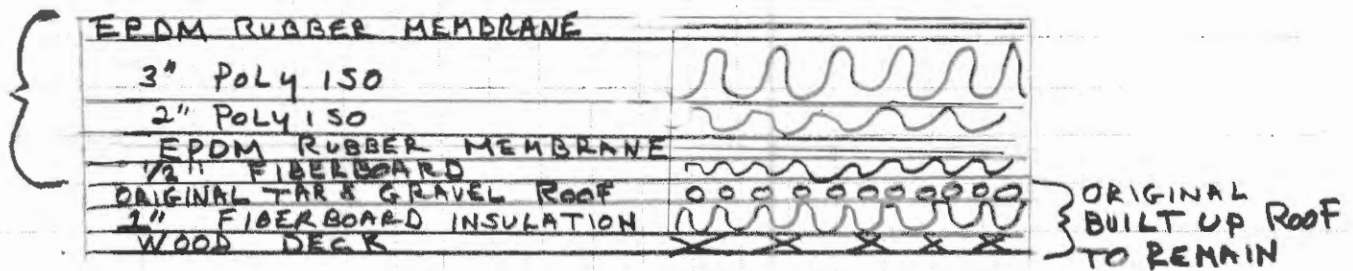

## NEW ROOF COMPOSITION

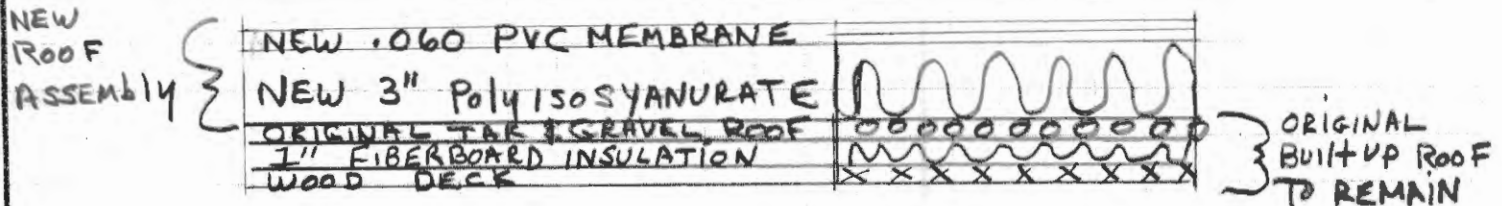

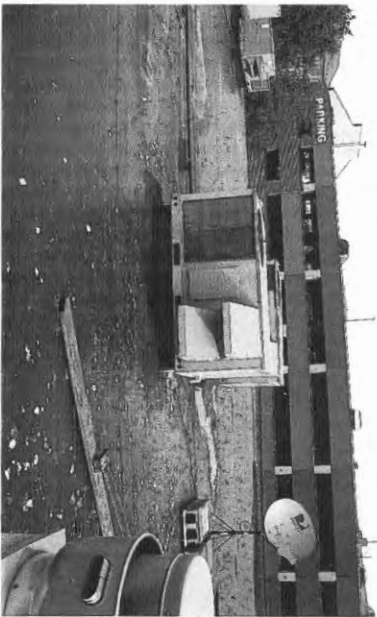



# CITY OF PORTLAND, MAINE

Department of Building Inspections

## Original Receipt

Jan 11 2012

Received from T-NAC Inc.

Location of Work 20-23 Colburn Blvd

Cost of Construction \$ \_\_\_\_\_ Building Fee: \_\_\_\_\_

Permit Fee \$ \_\_\_\_\_ Site Fee: \_\_\_\_\_

Certificate of Occupancy Fee: \_\_\_\_\_

Total: \_\_\_\_\_

Building (IL)  Plumbing (I5) \_\_\_\_\_ Electrical (I2) \_\_\_\_\_ Site Plan (U2) \_\_\_\_\_

Other \_\_\_\_\_

CBL: 030-2-03

Check #: 14402 Total Collected \$ 420.00

**No work is to be started until permit issued.  
Please keep original receipt for your records.**

Taken by: [Signature]

WHITE - Applicant's Copy  
YELLOW - Office Copy  
PINK - Permit Copy