

GENERAL NOTES:

- The notes on the drawings are not intended to replace specifications. In addition to general notes. See specifications for requirements.
- Structural drawings shall be used in conjunction with job specifications and architectural, mechanical, electrical, plumbing, and site drawings. Consult, openings, chases, inserts, reglets, sleeves, depressions, and other details not shown on structural drawings.
- All dimensions and conditions must be verified in the field. Any discrepancies shall be brought to the attention of the engineer before proceeding with the affected part of the work.
- Do not scale plans.
- Sections and details shown on any structural drawings shall be considered typical for similar conditions.
- All proprietary products shall be installed in accordance with the manufacturers written instructions.
- The structure is designed to be self supporting and stable after the erection is complete. It is the contractor's sole responsibility to determine erection procedures and sequencing to ensure the safety of the building and its components during erection. This includes the addition of necessary shoring, sheeting temporary bracing, guys or tie-downs. Such material shall remain the property of the contractor after completion of the project.
- All applicable federal, state, and municipal regulations shall be followed, including the federal department of labor occupational safety and health act.

STRUCTURAL STEEL NOTES:

- Structural steel fabrication, erection, and connection design shall conform to AISC "Specification for the design, fabrication, and erection of structural steel"—Ninth edition.
- Structural steel:
 - Structural steel shall conform to ASTM A-36.
 - Structural tubing shall conform to ASTM A-500 GR-B
 - Structural pipe shall conform to ASTM A-53, grade B
- Field connections shall be bolted using 3/4" diameter ASTM A325 high strength bolts except where field welding is indicated on the drawings.
- All welding shall conform to AWS D1.1—Latest edition. Welding electrodes shall be E70XX.
- Structural Steel Primer Paint. TNEPEC 10-99 Alkyd rust inhibitive primer, 2.0 to 3.5 mils dry thickness, or approved alternate.
- Structural Steel Top Coat for steel permanently exposed to view. TNEPEC series 2 TNEPEC-GLOSS Enamel, 3.0 to 5.0 mils dry thickness, or approved alternate.

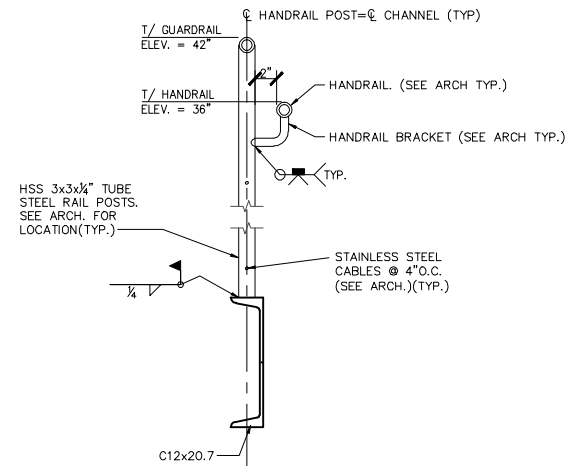

TYPICAL HANDRAIL/GUARD SECTION
1/8" = 1'-0" (SEE ARCH FOR ADD'L INFO.)

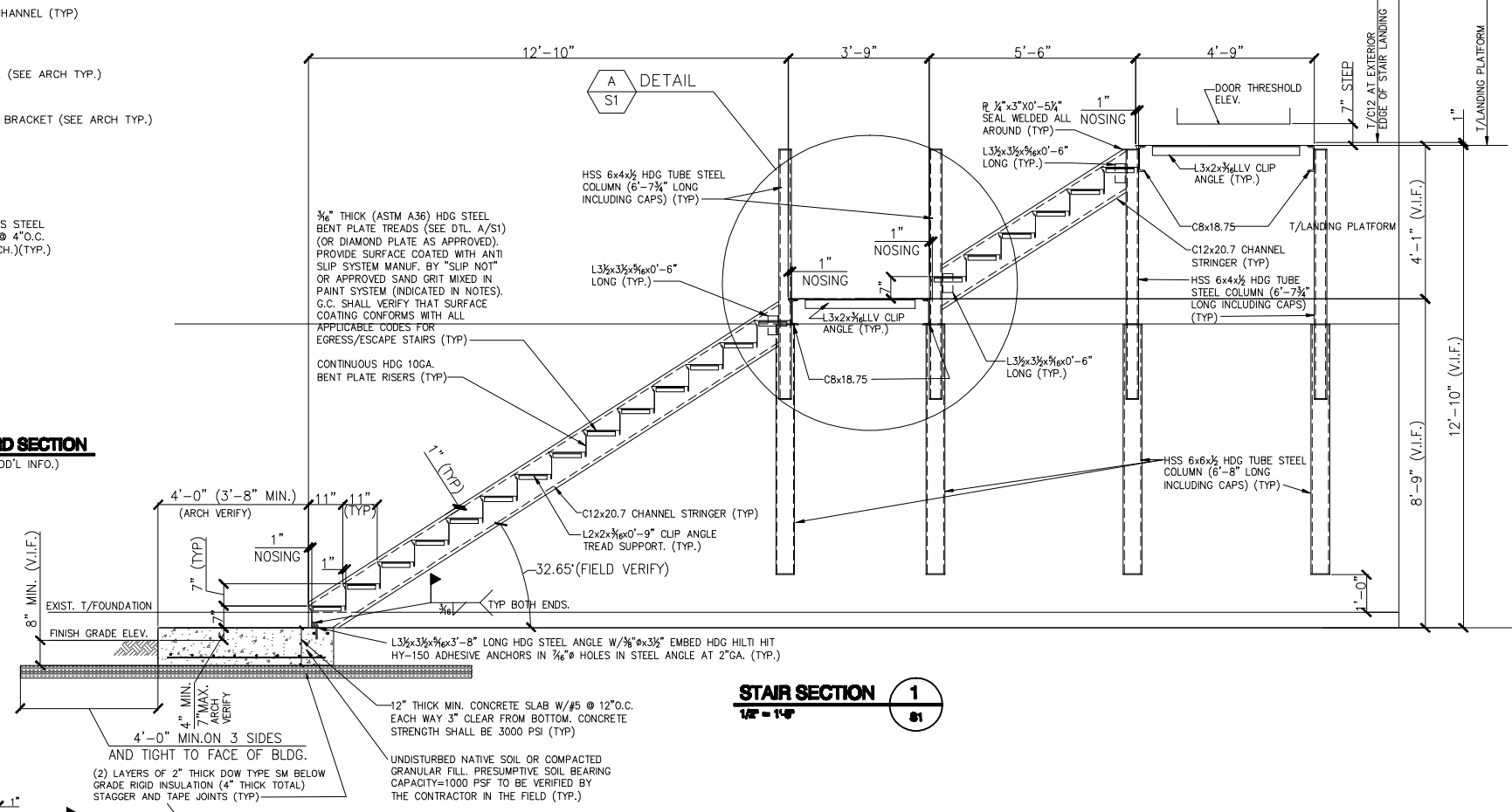
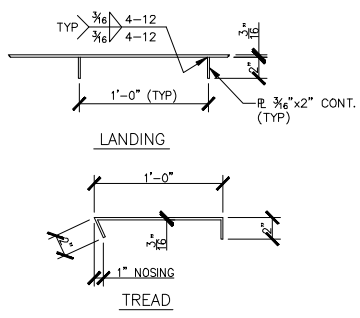

STAIR SECTION 1
1/8" = 1'-0"

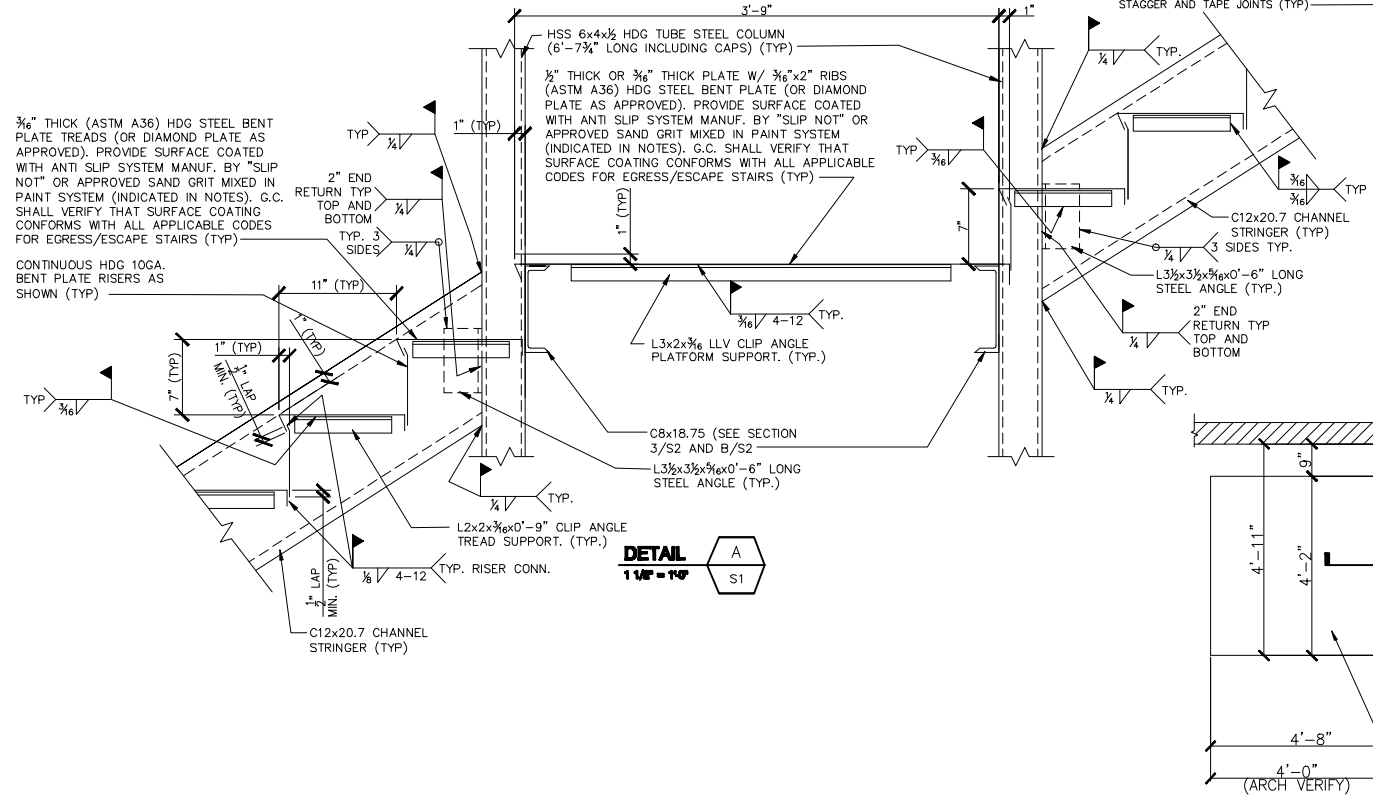

DETAIL A S1
1/8" = 1'-0"

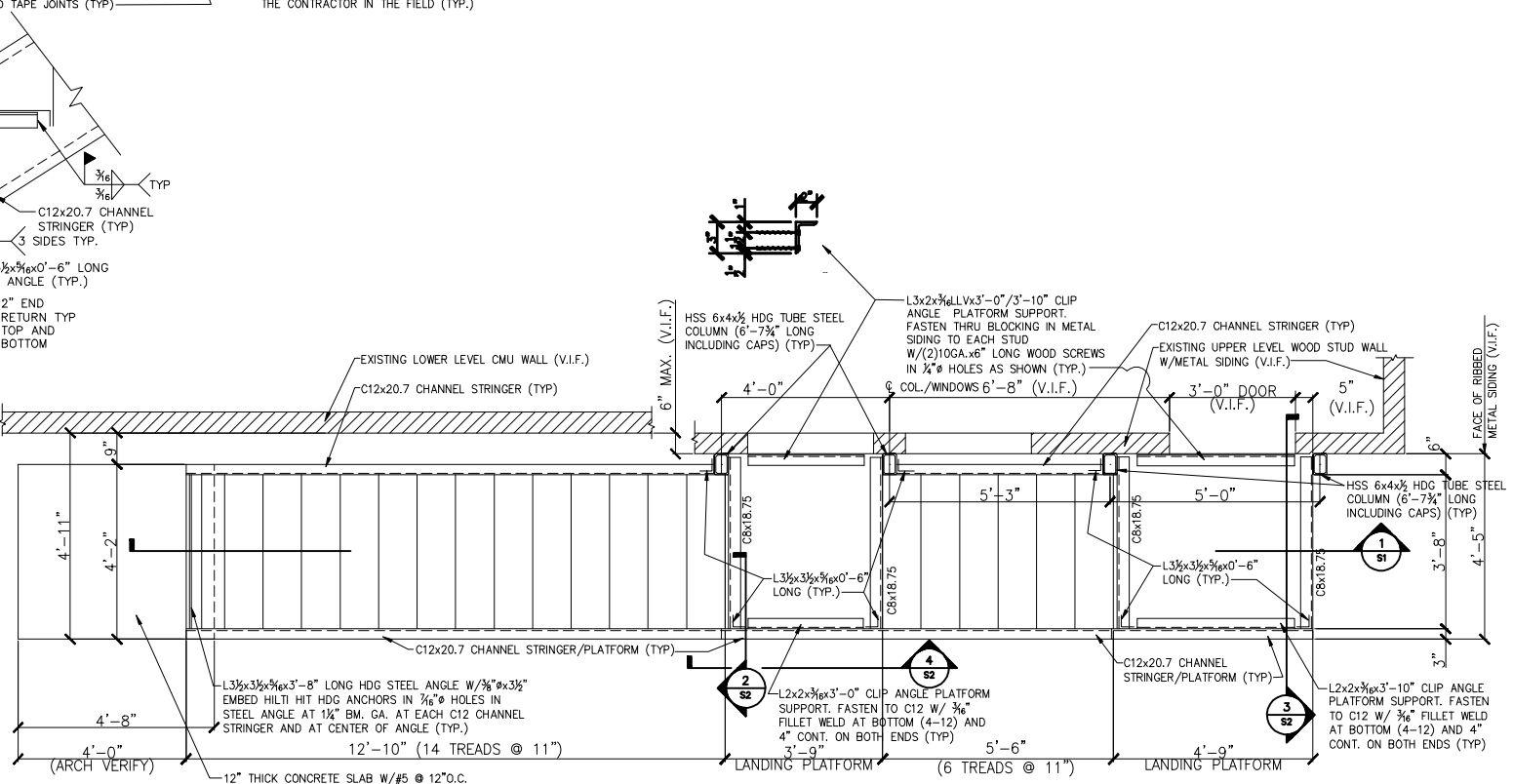

ALTERNATE STRUCTURAL STEEL FRAMING PLAN
1/8" = 1'-0"

- NOTES:
- SEE GENERAL NOTES AND STRUCTURAL STEEL NOTES ON DWG S1
 - G.C. SHALL VERIFY ALL DIMENSIONS, ELEVATIONS AND EXISTING CONDITIONS IN THE FIELD PRIOR TO PROCEEDING WITH EFFECTED PORTION OF THE WORK.
 - STRUCTURAL STEEL STAIR HAS BEEN DESIGNED TO CONFORM WITH THE STRUCTURAL PORTION OF THE CODE ONLY. G.C. SHALL COORDINATE WITH ARCHITECTURAL DRAWINGS INCLUDING BUT NOT LIMITED TO LIFE SAFETY, FIRE, EGRESS, ADA, HISTORIC AND LOCAL CODE REQUIREMENTS.

THESE DRAWINGS HAVE BEEN DEVELOPED BY L&L STRUCTURAL ENGINEERING SERVICES, INC. FOR THE TITLED SET ONLY. THE DRAWINGS ARE THE SOLE PROPERTY OF L&L ENGINEERING SERVICES, INC. AND THEY SHALL NOT BE USED, LEANT, COPIED OR ALTERED WITHOUT THE WRITTEN CONSENT OF L&L STRUCTURAL ENGINEERING SERVICES, INC.

L & L STRUCTURAL ENGINEERING SERVICES, INC.
SIX Q STREET
SOUTH PORTLAND, MAINE 04106
PHONE: (207) 767-4830
FAX: (207) 799-5432

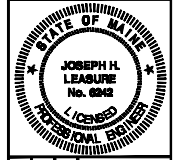

rev.	date	description	designed by	drawn by	checked by	scale	plot date	project #
1	7-8-10	STAR SUPPORT COLUMNS	JHL	JHL	JHL	AS NOTED	7-9-10	2010-082

RI-RA IRISH PUB
PORTLAND, MAINE

FRAMING PLAN, SECTIONS AND DETAILS

S1