

2 | THIRD FLOOR LIFE SAFETY PLAN
SCALE: 3/32"=1'-0"

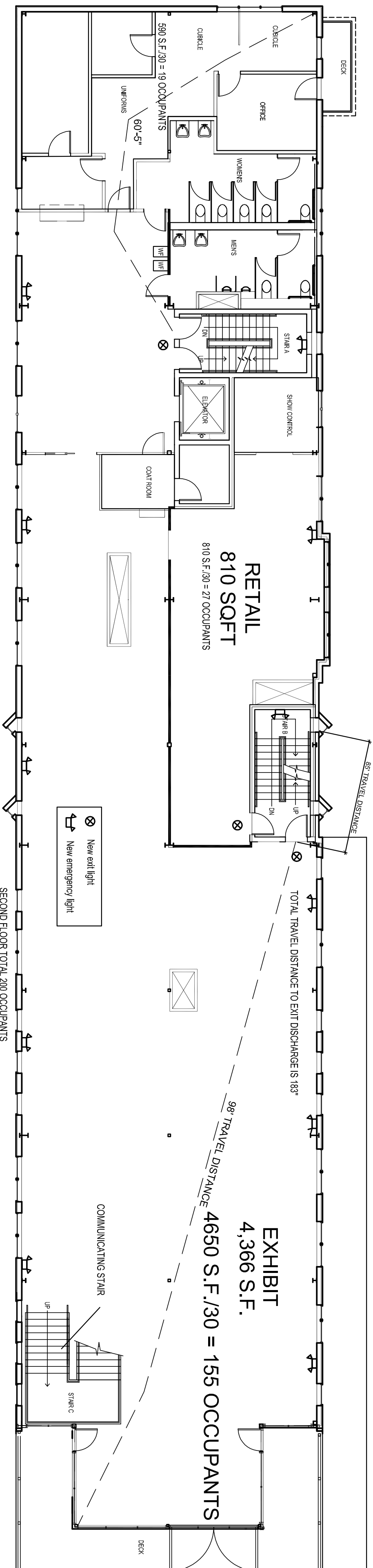

1 | SECOND FLOOR LIFE SAFETY PLAN
SCALE: 3/32"=1'-0"

CODE ANALYSIS IBC 2009, NFPA 101 2009

ASSEMBLY OCCUPANCY A-3	IBC T503
CONSTRUCTION TYPE 5A IBC, V-111 NFPA PROTECTED/COMBUSTIBLE MATERIALS	
1 HOUR RATED FLOOR, FRAME, AND ROOF	
1 HOUR STAIR RATING	
ALLOWABLE HGT AND AREA	
2 STORIES + 1 STORY W/ SPRINKLER	NFPA T12.1.6
11,500 X 3-34,500 SF ALLOWED	IBC 1028.7
BUILDING IS CURRENTLY SPRINKLERED PER NFPA 13	
2 LEVELS ABOVE LED, V-111 ANY ASSEMBLY	
TRAVEL DISTANCE IN SPRINKLED A-3 NO GREATER THAN 250'	IBC 1008.1.10
PANIC AND FIRE EXIT HARDWARE	
A- OCCUPANT LOAD OF 50 OR MORE- NO LOCK UNLESS PANIC HARDWARE OR FIRE EXIT HARDWARE. DOORS TO SWING DIRECTION OF EGRESS	IBC 803.9
INTERIOR FINISHES - IN SPRINKLED EXIT ENCLOSURES AND PASSAGES & CORRIDORS - FLAME SPREAD INDEX B ROOMS AND ENCLOSURES - INDEX C	NFPA 8.6
COMMUNICATING STAIRS CAN FOLLOW NFPA 101 8.6 ACCORDING TO NFPA 101 SECTION 12.3	NFPA 12.3
COMMUNICATING STAIRS ALLOWED IF:	
-IF CONNECTS NO MORE THAN 3 STORIES	
-NEXT TO LOWEST IS STREET LEVEL	
-ENTIRE AREA OF COMMUNICATING SPACE IS OPEN AND UNOBSTRUCTED	NFPA 9.7
-1 HR SEPARATION FROM REMAINDER OF BUILDING	NFPA 8.5
-UNLESS SPRINKLED IN ACCORDANCE WITH NFPA 101 SECTION 9.7 AND HAS A SMOKE BARRIER IN ACCORDANCE WITH NFPA 101 8.5	
3" PER OCCUPANT FOR STAIRS	IBC 1005.1
EGRESS WIDTH = 88"	
88"/3 = 293 OCCUPANTS PER STORY	IBC 2012
MUSEUM NET 30 PER SF. OCCUPANCY	
SECOND FLOOR OCCUPANCY TOTAL = 200	
THIRD FLOOR OCCUPANCY TOTAL = 200	
TOTAL OCCUPANCY = 400	

DRAWING LIST

- A1.00 - LIFE SAFETY PLANS
- A1.01 - EXISTING & DEMO PLANS
- A1.02 - FLOOR PLANS & ELEVATIONS & DOOR SCHEDULE
- A1.03 - FLOOR FINISH PLANS & RCPS
- A4.01 - DETAILS
- A4.02 - NEW COMMUNICATING STAIR DETAILS
- A4.03 - STAIR DETAILS

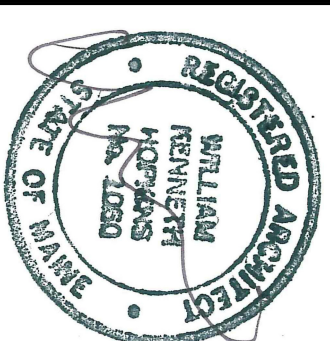

Prepared For:
MAINE WHARF LLC
72 COMMERCIAL STREET
PORTLAND, ME 04101

Consultant:

Architect:
ARCHETYPE
48 Union Wharf Portland, Maine 04101
(207) 772-6022 Fax (207) 772-4056

Project:
BUILDING A - MAINE WHARF
INTERIOR FIT-UP
PORTLAND SCIENCE CENTER
MAINE WHARF,
PORTLAND ME

Revisions:

Scale:
3/32" = 1'-0"

Date:
5-13-2015

LIFE SAFETY PLANS

A1.00