

NOTE: Additional hanging angles provided for hoods 12' and longer.
PLAN VIEW - Hood #6 (RANGE / COMBI/ PIZZA)
 14' 5.00" LONG 6630ND-2-PSP-F

LIGHTING FOR ACPSP Job # 1934403 - Hood #6
 INPUT: 120V AC, 1 Phase, 50/60Hz, 3.5 Watts per light.
 TO CONTROL LIGHTS WITH HOOD LIGHT SWITCH, WIRE PER HOOD ELECTRICAL CONTROL PANEL SCHEMATIC.
 TO CONTROL LIGHTS WITH BUILDING LIGHT SWITCH, WIRE BLACK AND WHITE WIRE TO A 120VAC SERVICE.
 END TO END ACPSPS REQUIRE 120VAC FIELD WIRING FROM J-BOX TO J-BOX. REPLACE LIGHTS WITH LED LIGHTS ONLY.

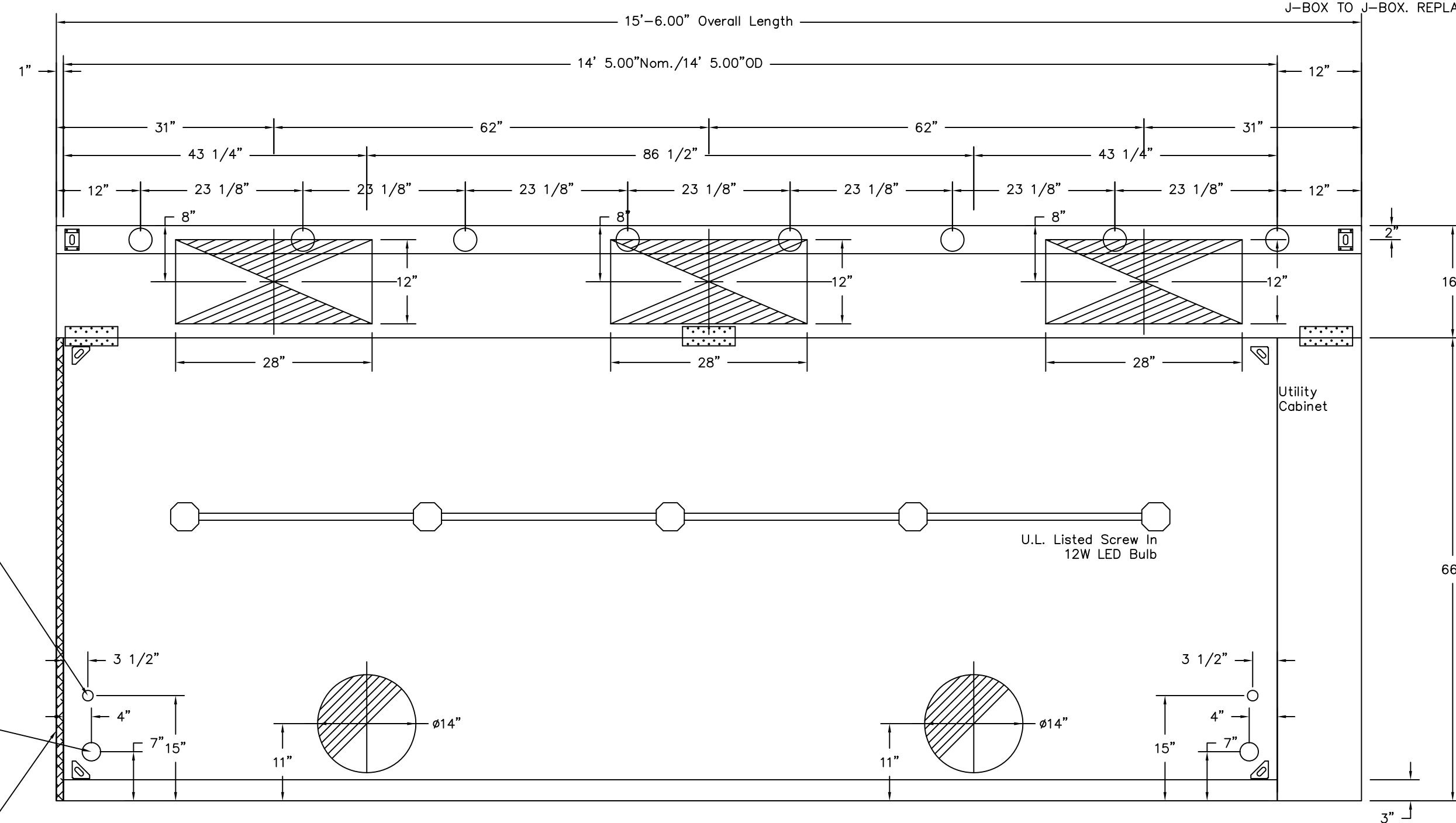

3/4" I.P.S. (N.P.T.) HOT WATER CONNECTION STUBS ARE PREFIT BY FACTORY. BOTH ENDS

1.5" I.P.S. DRAIN DROP ENGINEER IS RESPONSIBLE FOR DRAIN LINE DESIGN BEYOND THE HOOD. DRAIN LINE MUST BE INSTALLED PER LOCAL CODES. DRAIN LINE MUST BE SLOPED (MINIMUM 1/4" INCH PER FOOT). AVOID ANY UNNECESSARY 90 DEGREE TURNS. IF COMBINED WITH OTHER DRAIN LINES, THEN PIPE SIZE SHOULD BE INCREASED ACCORDINGLY. P-TRAPS SHOULD NOT BE USED IN THE GREASE DRAIN LINE AND HEAT TAPE MUST BE USED WHERE DRAIN LINE IS RUN IN ENVIRONMENTS THAT WOULD SOLIDIFY GREASE. SIZE BUILDING GREASE INTERCEPTOR ACCORDINGLY. BOTH ENDS

1" LAYER OF INSULATION FACTORY INSTALLED IN 1.00" END STANDOFF MEETS 0" REQUIREMENTS CLEARANCE TO COMBUSTIBLE SURFACES.

EXHAUST HOOD ITEM # 45A

SCREW IN 12W LED BULB. INCANDESCENT LIGHT FIXTURE-HIGH TEMP ASSEMBLY, 2700K-3500K. INCLUDES CLEAR THERMAL AND SHOCK RESISTANT GLOBE

FIELD WRAPPER 18.00" HIGH (SEE HOOD OPTIONS TABLE)

ATTACHING PLATES SUPPLY RISER WITH VOLUME DAMPER

23.5% OPEN STAINLESS STEEL PERFORATED PANEL

30" NOM.

80" AFF TYP.

EQUIPMENT BY OTHERS

EXHAUST RISER

HANGING ANGLE

20" CAPTRATE SOLO FILTER WITH HOOK

3" INTERNAL STANDOFF

IT IS THE RESPONSIBILITY OF THE ARCHITECT/OWNER TO ENSURE THAT THE HOOD CLEARANCE FROM LIMITED-COMBUSTIBLE AND COMBUSTIBLE MATERIALS IS IN COMPLIANCE WITH LOCAL CODE REQUIREMENTS.

1.5" I.P.S. FINAL DRAIN DROP LOCATION ALL NECESSARY FITTINGS FROM THE VENTILATOR TO THE BUILDING WASTE LINE(S), I.E. FLOOR SINKS, AIR GAPS, OR OTHER DEVICES REQUIRED BY THE GOVERNING CODES, BY OTHERS.

ENGINEER IS RESPONSIBLE FOR DRAIN LINE DESIGN BEYOND THE HOOD. DRAIN LINE MUST BE INSTALLED PER LOCAL CODES. DRAIN LINE MUST BE SLOPED (MINIMUM 1/4" INCH PER FOOT). AVOID ANY UNNECESSARY 90 DEGREE TURNS. IF COMBINED WITH OTHER DRAIN LINES, THEN PIPE SIZE SHOULD BE INCREASED ACCORDINGLY. P-TRAPS SHOULD NOT BE USED IN THE GREASE DRAIN LINE AND HEAT TAPE MUST BE USED WHERE DRAIN LINE IS RUN IN ENVIRONMENTS THAT WOULD SOLIDIFY GREASE.

LEFT AND RIGHT VERTICAL END PANELS WITH ADJUSTABLE LEGS

SECTION VIEW - MODEL 6630ND-2-PSP-F
 HOODS - #5 (RANGE / COMBI/ CONV), #6 (RANGE / COMBI/ PIZZA)

REVISIONS	
DESCRIPTION	DATE

MAINE OFFICE
 www.captiveaia.com
 PO Box 66, 179 South Rd., Topshfield, ME, 04480 PHONE: (207) 796-2590 FAX: (919) 227-5946 EMAIL: reg21@captiveaia.com

Maine Wharf Restaurant
 PORTLAND, ME

DATE: 12/18/2013
 DWG.#: 1934403
 DRAWN BY: BFC-21
 SCALE: 3/4" = 1'-0"
 MASTER DRAWING

SHEET NO. 6