

ELITE AIRWAYS TENANT FITOUT  
TENANT FITOUT  
50 PORTLAND PIER | THIRD FLOOR  
ATLANTIC NATIONAL TRUST, LLC



DEXTROUS  
CREATIVE

PORTLAND, ME 04102  
TRACIE REED, ARCHITECT  
NCARB, AIA, LEED AP BD+C  
traciereed@dextrouscreative.com  
207.409.0459 (cell)

JIM HANLEY | BUILDING  
REPRESENTATIVE  
ATLANTIC NATIONAL TRUST, LLC  
jhanley@atlanticonationaltrust.com  
207.553.2000 x 208 (O)  
207.328.0298 (C)

IAN MCCracken | GENERAL  
CONTRACTOR  
LANDRY FRENCH CONSTRUCTION  
imccracken@landryfrenchconstruction.com  
207.730.5566 x 110 (O)  
207.400.6500 (C)

KARA KITCHEN | LEASEHOLD  
REPRESENTATIVE  
ELITE AIRWAYS  
kara@eliteairways.net  
207.842.6400 (C)

No.	Description	Date

TEL/DATA

Project number	15-06
Date	04.13.15
Drawn by	Author
Checked by	Checker

TN-1.1

Scale 1/4" = 1'-0"

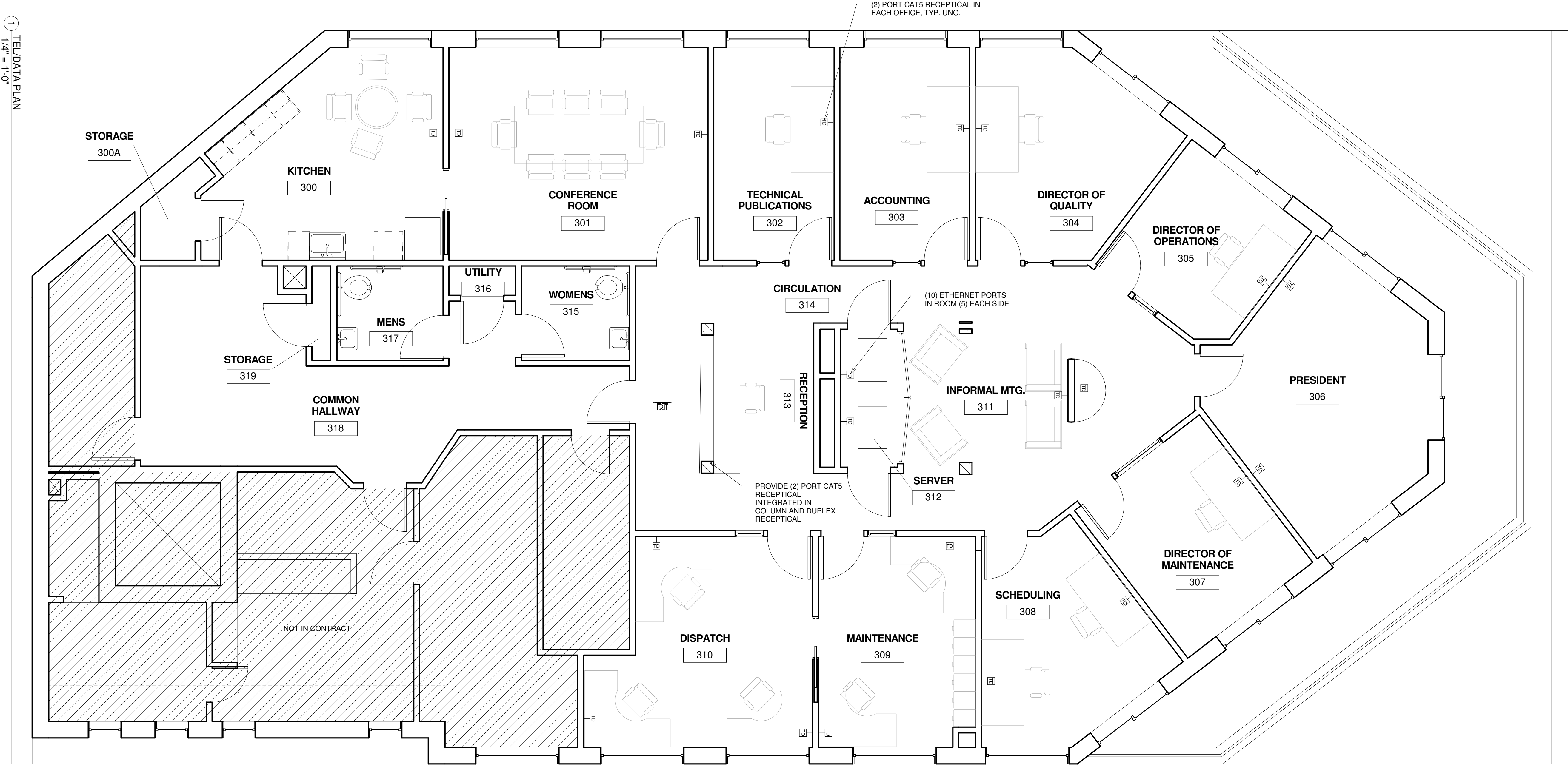
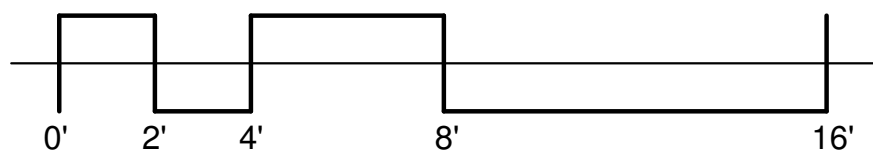

GENERAL NOTES

- 1) ASSUME TWO ETHERNET PORTS IN EACH OFFICE, TYP. UNO. EXCEPTIONS - DISPATCH (6), MAINTENANCE (4), SCHEDULING (4), PRESIDENT (4), SERVER (10)
- 2) PROVIDE FLOOR RECEPTICAL IN ADMINISTRATION AREA UNDER DESK
- 3) PROVIDE FLOOR RECEPTICAL IN CONFERENCE ROOM AND (2) ETHERNET OUTLETS

TEL/DATA PLAN  
1/4" = 1'-0"