

1 LIFE SAFETY PLAN
1/4" = 1'-0"

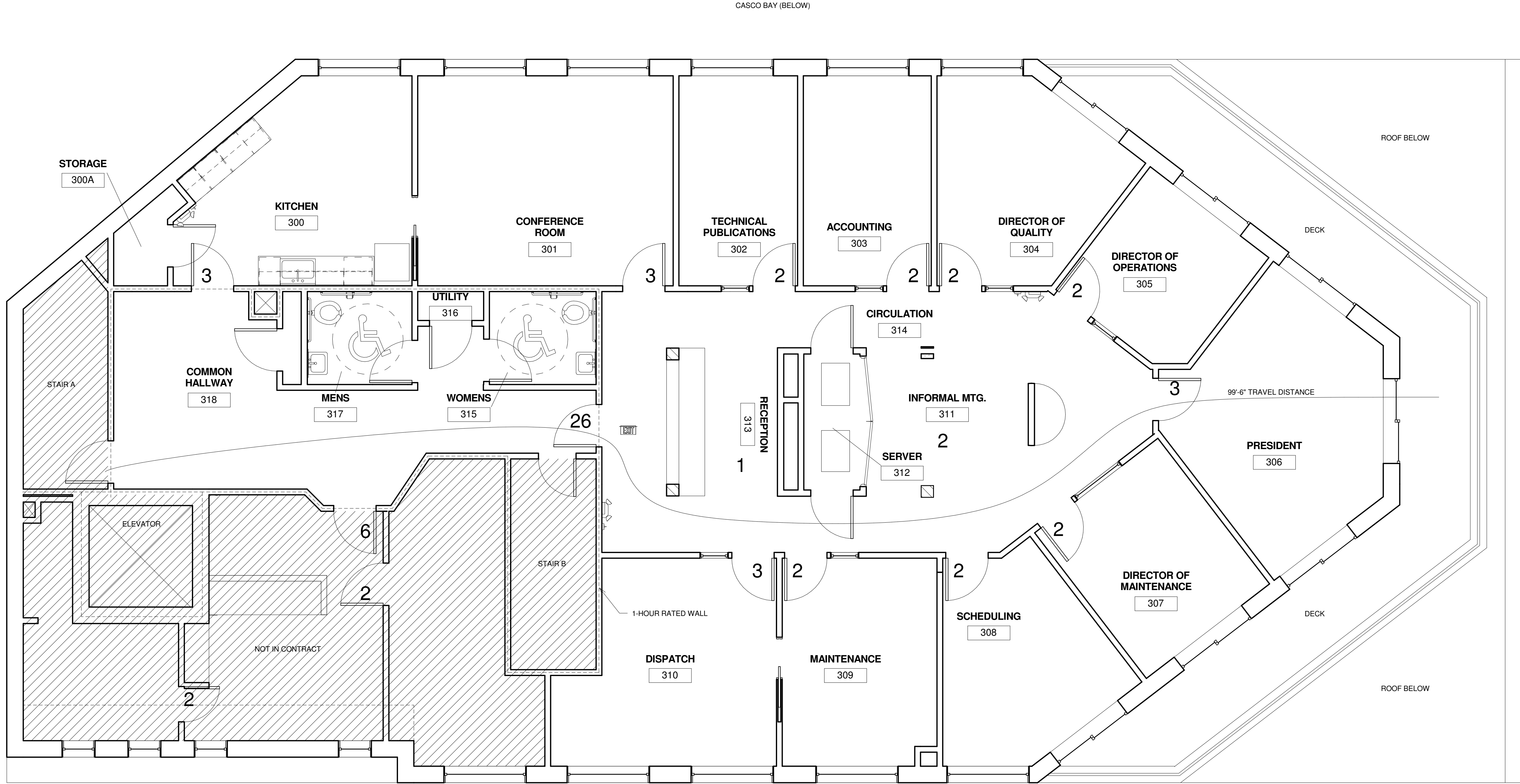

- EMERGENCY LIGHT
- HORN/STROBE
- PULL STATION
- 2 NUMBER OF EXISTING PEOPLE IN ROOM PER LOADING
- 1-HOUR RATED WALL

LIFE SAFETY LEGEND
1/4" = 1'-0"

LIFE SAFETY NOTES
1) RETAIN/SALVAGE AND REUTILIZE HORN/STROBES, AND EMERGENCY LIGHTS WHERE POSSIBLE.

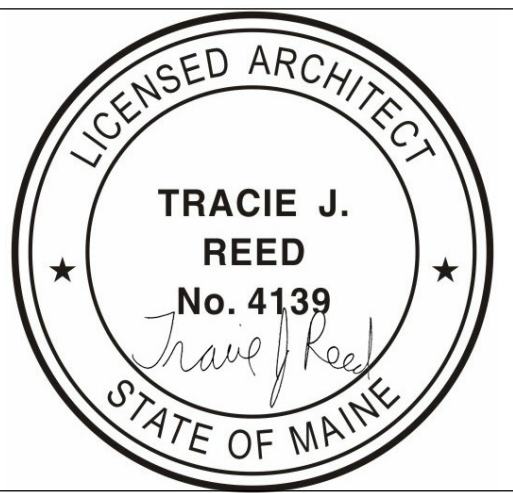
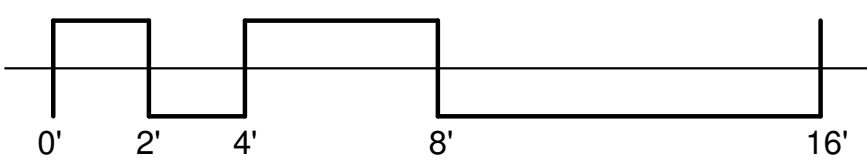

ELITE AIRWAYS TENANT FITOUT
TENANT FITOUT
50 PORTLAND PIER | THIRD FLOOR
ATLANTIC NATIONAL TRUST, LLC



DEXTROUS
CREATIVE
PORTLAND, ME 04102
TRACIE REED, ARCHITECT
NCARB, AIA, LEED AP BD+C
traciereed@dextrouscreative.com
207.409.0459 (cell)

JIM HANLEY | BUILDING
REPRESENTATIVE
ATLANTIC NATIONAL TRUST, LLC
jhanley@atlanticonationaltrust.com
207.553.2000 x 208 (O)
207.328.0298 (C)

IAN MCCracken | GENERAL
CONTRACTOR
LANDRY FRENCH CONSTRUCTION
imccracken@landryfrenchconstruction.com
207.730.5566 x 110 (O)
207.400.6500 (C)

KARA KITCHEN | LEASEHOLD
REPRESENTATIVE
ELITE AIRWAYS
kara@eliteairways.net
207.642.6400 (C)

No.	Description	Date

LIFE SAFETY
PLAN

Project number	15-06
Date	04.13.15
Drawn by	Author
Checked by	Checker

LS-1.1

Scale 1/4" = 1'-0"