

ELITE AIRWAYS TENANT FITOUT
TENANT FITOUT
50 PORTLAND PIER | THIRD FLOOR
ATLANTIC NATIONAL TRUST, LLC



DEXTROUS
CREATIVE

PORTLAND, ME 04102
TRACIE REED, ARCHITECT
NCARB, AIA, LEED AP BD+C
traciereed@dextrouscreative.com
207.409.0459 (cell)

JIM HANLEY | BUILDING
REPRESENTATIVE
ATLANTIC NATIONAL TRUST, LLC
jhanley@atlanticonationaltrust.com
207.553.2000 x 208 (O)
207.328.0298 (C)

IAN MCCrackEN | GENERAL
CONTRACTOR
LANDRY FRENCH CONSTRUCTION
imccracken@landryfrenchconstruction.com
207.730.5566 x 110 (O)
207.400.6500 (C)

KARA KITCHEN | LEASEHOLD
REPRESENTATIVE
ELITE AIRWAYS
kara@eliteairways.net
207.642.6400 (C)

No.	Description	Date

FLOOR
PATTERN
PLAN

Project number 15-06
Date 04.13.15
Drawn by Author
Checked by Checker

A-1.4

Scale 1/4" = 1'-0"

1 FLOOR PATTERN PLAN
1/4" = 1'-0"

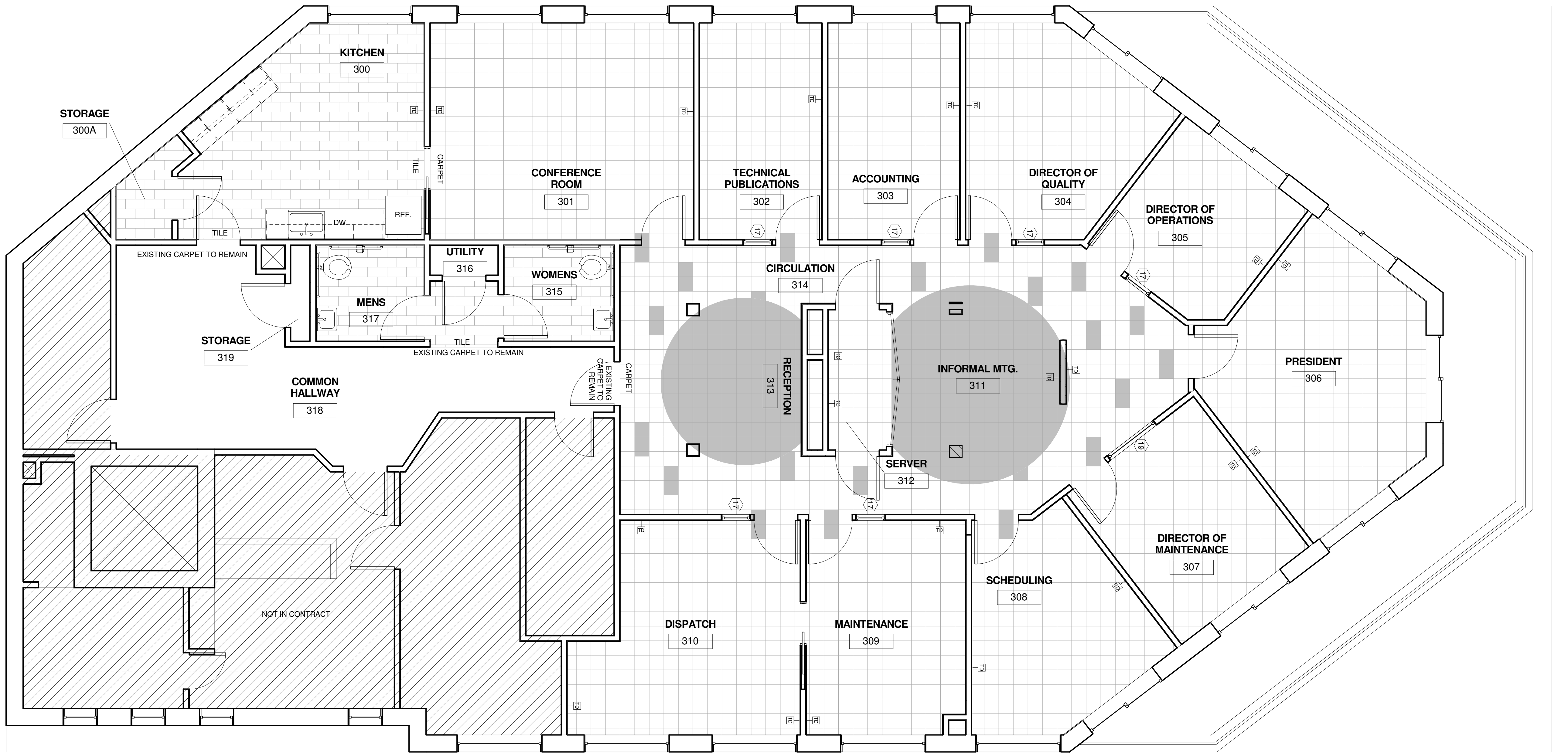

GENERAL FLOOR NOTES

1) PROVIDE ADA-COMPLIANT TRANSITION STRIPS AT THE BOUNDARY OF ALL FLOORING TRANSITIONS, TYP.

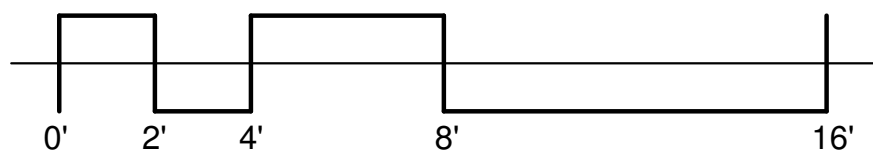

4/13/2015 9:51:32 PM