

DISPLAY THIS CARD ON PRINCIPAL FRONTAGE OF WORK

**CITY OF PORTLAND****BUILDING INSPECTION****PERMIT**

Permit Number: 081242

Please Read  
Application And  
Notes, If Any,  
Attached

This is to certify that HONECK & O'TOOLE REALTY PARTNERSHIP/CRM Constructi  
has permission to Commercial/Residential Condos - ammend permit # 08-1143 to repair an additional 2 pilings as previously appro  
AT 50 PORTLAND PIER CBL 030-B007001

provided that the person or persons, firm or corporation accepting this permit shall comply with all of the provisions of the Statutes of Maine and of the Ordinances of the City of Portland regulating the construction, maintenance and use of buildings and structures, and of the application on file in this department.

Apply to Public Works for street line and grade if nature of work requires such information.

Notification of inspection must be given and written permission procured before this building or part thereof is lathed or otherwise closed-in. 24 HOUR NOTICE IS REQUIRED.

A certificate of occupancy must be procured by owner before this building or part thereof is occupied.

<b>PERMIT ISSUED</b>	
OCT 15 2008	
<b>CITY OF PORTLAND</b>	
Department Name	

OTHER REQUIRED APPROVALS

Fire Dept. \_\_\_\_\_

Health Dept. \_\_\_\_\_

Appeal Board \_\_\_\_\_

Other \_\_\_\_\_

*Janne Bonke* 10/3/08  
Director - Building & Inspection Services

**PENALTY FOR REMOVING THIS CARD****SCANNED**



# CITY OF PORTLAND, MAINE

Department of Building Inspections

## Original Receipt

Oct 3

20 08

Received from

CRM Construction

Location of Work

50 Portland Pier

Cost of Construction

\$ 14,000

Building Fee:

Permit Fee

\$ 160.00

Site Fee:

Certificate of Occupancy Fee:

Total:

160.00

Building (IL)

X

Plumbing (IS)

Electrical (I2)

Site Plan (U2)

Other

CBL:

30-B-7

Check #:

11043

Total Collected \$

160.00

**No work is to be started until permit issued.**

If permit is Withdrawn or Denied, amount of the Refund is based on \$20.00 or 20% of the fee, (whichever is greater)

In order to receive a refund, you MUST present the Original Receipt.

Taken by:

JMB

WHITE - Applicant's Copy

YELLOW - Office Copy

PINK - Permit Copy

**City of Portland, Maine - Building or Use Permit Application**

389 Congress Street, 04101 Tel: (207) 874-8703, Fax: (207) 874-8716

<b>Permit No:</b> 08-1242		<b>Issue Date:</b> 10/03/2008		<b>CBL:</b> 030 B007001	
<b>Location of Construction:</b> 50 PORTLAND PIER		<b>Owner Name:</b> HONECK & O'TOOLE REALTY P		<b>Owner Address:</b> FIFTY PORTLAND PIER #1	
<b>Business Name:</b>		<b>Contractor Name:</b> CRM Construction, Services, Inc.		<b>Contractor Address:</b> 94 Washington Street Auburn	
<b>Lessee/Buyer's Name</b>		<b>Phone:</b>		<b>Permit Type:</b> Alterations - Commercial	
<b>Past Use:</b> Commercial/Residential Condos		<b>Proposed Use:</b> Commercial/Residential Condos - ammend permit # 08-1143 to repair an additional 2 pilings as previously approved		<b>Permit Fee:</b> \$160.00	
				<b>Cost of Work:</b> \$14,000.00	
				<b>CEO District:</b> 1	
<b>Proposed Project Description:</b> Commercial/Residential Condos - ammend permit # 08-1143 to repair an additional 2 pilings as previously approved		<b>FIRE DEPT:</b> <input type="checkbox"/> Approved <input type="checkbox"/> Denied N/A		<b>INSPECTION:</b> Use Group: Piling Repair Type: JMB 10/3/08	
		<b>Signature:</b>		<b>Signature:</b>	
		<b>PEDESTRIAN ACTIVITIES DISTRICT (P.A.D.)</b>			
		<b>Action:</b> <input type="checkbox"/> Approved <input type="checkbox"/> Approved w/Conditions <input type="checkbox"/> Denied			
		<b>Signature:</b> <b>Date:</b>			
<b>Permit Taken By:</b> jmb		<b>Date Applied For:</b> 10/03/2008		<b>Zoning Approval</b>	

1. This permit application does not preclude the Applicant(s) from meeting applicable State and Federal Rules.
2. Building permits do not include plumbing, septic or electrical work.
3. Building permits are void if work is not started within six (6) months of the date of issuance. False information may invalidate a building permit and stop all work..

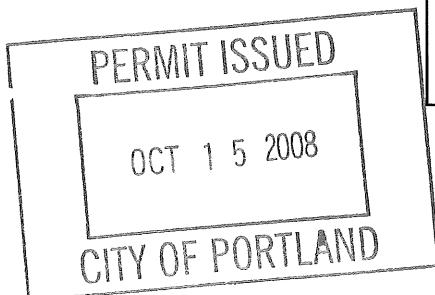

<b>Special Zone or Reviews</b> <input type="checkbox"/> Shoreland <input type="checkbox"/> Wetland <input type="checkbox"/> Flood Zone <input type="checkbox"/> Subdivision <input type="checkbox"/> Site Plan Maj <input checked="" type="checkbox"/> Minor <input type="checkbox"/> MM <input type="checkbox"/> Date: JMB	<b>Zoning Appeal</b> <input type="checkbox"/> Variance <input type="checkbox"/> Miscellaneous <input type="checkbox"/> Conditional Use <input type="checkbox"/> Interpretation <input type="checkbox"/> Approved <input type="checkbox"/> Denied # 08-1143 Date:	<b>Historic Preservation</b> <input checked="" type="checkbox"/> Not in District or Landmark <input type="checkbox"/> Does Not Require Review <input type="checkbox"/> Requires Review <input type="checkbox"/> Approved <input type="checkbox"/> Approved w/Conditions <input type="checkbox"/> Denied Date: JMB
--	--	--

**CERTIFICATION**

I hereby certify that I am the owner of record of the named property, or that the proposed work is authorized by the owner of record and that I have been authorized by the owner to make this application as his authorized agent and I agree to conform to all applicable laws of this jurisdiction. In addition, if a permit for work described in the application is issued, I certify that the code official's authorized representative shall have the authority to enter all areas covered by such permit at any reasonable hour to enforce the provision of the code(s) applicable to such permit.

SIGNATURE OF APPLICANT

ADDRESS

DATE

PHONE

RESPONSIBLE PERSON IN CHARGE OF WORK, TITLE

DATE

PHONE



# General Building Permit Application

If you or the property owner owes real estate or personal property taxes or user charges on any property within the City, payment arrangements must be made before permits of any kind are accepted.

Location/Address of Construction: <u>50 Portland Pier</u>		
Total Square Footage of Proposed Structure/Area	Square Footage of Lot	Number of Stories
Tax Assessor's Chart, Block & Lot Chart#      Block#      Lot# <u>36</u> <u>B</u> <u>7</u>	Applicant * <u>must be owner, Lessee or Buyer</u> * Name <u>50 Portland Pier Assoc</u> Address <u>50 Portland Pier</u> City, State & Zip <u>Portland ME</u>	Telephone: <u>650-7860</u>
Lessee/DBA (If Applicable)	Owner (if different from Applicant) Name Address <u>Same</u> City, State & Zip	Cost Of Work: \$ <u>14,000.00</u> C of O Fee: \$ _____ Total Fee: \$ _____
Current legal use (i.e. single family) <u>Commercial/condos</u> Number of Residential Units _____ If vacant, what was the previous use? _____ Proposed Specific use: _____ Is property part of a subdivision? <u>no</u> If yes, please name _____ Project description: <u>Repair two piers as previously permitted.</u> <u>concrete</u>		
Contractor's name: <u>C.R.M. Construction</u> Address: <u>94 Washington St</u> City, State & Zip <u>Auburn Maine 04210</u> Telephone: <u>650-7860</u> Who should we contact when the permit is ready: <u>Bob Marin</u> Telephone: <u>Same</u> Mailing address: <u>94 Washington St North Auburn ME</u>		

Please submit all of the information outlined on the applicable Checklist. Failure to do so will result in the automatic denial of your permit.

In order to be sure the City fully understands the full scope of the project, the Planning and Development Department may request additional information prior to the issuance of a permit. For further information or to download copies of this form and other applications visit the Inspections Division on-line at [www.portlandmaine.gov](http://www.portlandmaine.gov), or stop by the Inspections Division office, room 315 City Hall or call 874-8703.

I hereby certify that I am the Owner of record of the named property, or that the owner of record authorizes the proposed work and that I have been authorized by the owner to make this application as his/her authorized agent. I agree to conform to all applicable laws of this jurisdiction. In addition, if a permit for work described in this application is issued, I certify that the Code Official's authorized representative shall have the authority to enter all areas covered by this permit at any reasonable hour to enforce the provisions of the codes applicable to this permit.

Signature: [Signature]

Date: 10-3-03

This is not a permit; you may not commence ANY work until the permit is issued

OCT 2 2003

**City of Portland, Maine - Building or Use Permit**

389 Congress Street, 04101 Tel: (207) 874-8703, Fax: (207) 874-8716

<b>Permit No:</b> 08-1242		<b>Date Applied For:</b> 10/03/2008	<b>CBL:</b> 030 B007001
<b>Location of Construction:</b> 50 PORTLAND PIER	<b>Owner Name:</b> HONECK & O'TOOLE REALTY P	<b>Owner Address:</b> FIFTY PORTLAND PIER #1	<b>Phone:</b>
<b>Business Name:</b>	<b>Contractor Name:</b> CRM Construction, Services, Inc.	<b>Contractor Address:</b> 94 Washington Street Auburn	<b>Phone</b> (207) 650-7860
<b>Lessee/Buyer's Name</b>	<b>Phone:</b>	<b>Permit Type:</b> Alterations - Commercial	
<b>Proposed Use:</b> Commercial/Residential Condos - ammend permit # 08-1143 to repair an additional 2 pilings as previously approved		<b>Proposed Project Description:</b> Commercial/Residential Condos - ammend permit # 08-1143 to repair an additional 2 pilings as previously approved	
<b>Dept:</b> Zoning <b>Status:</b> Approved with Conditions <b>Reviewer:</b> Jeanine Bourke <b>Approval Date:</b> 10/03/2008 <b>Note:</b> <b>Ok to Issue:</b> <input checked="" type="checkbox"/> 1) All previous conditions apply			
<b>Dept:</b> Building <b>Status:</b> Approved with Conditions <b>Reviewer:</b> Jeanine Bourke <b>Approval Date:</b> 10/03/2008 <b>Note:</b> <b>Ok to Issue:</b> <input checked="" type="checkbox"/> 1) All previous conditions apply			

COMMERCIAL

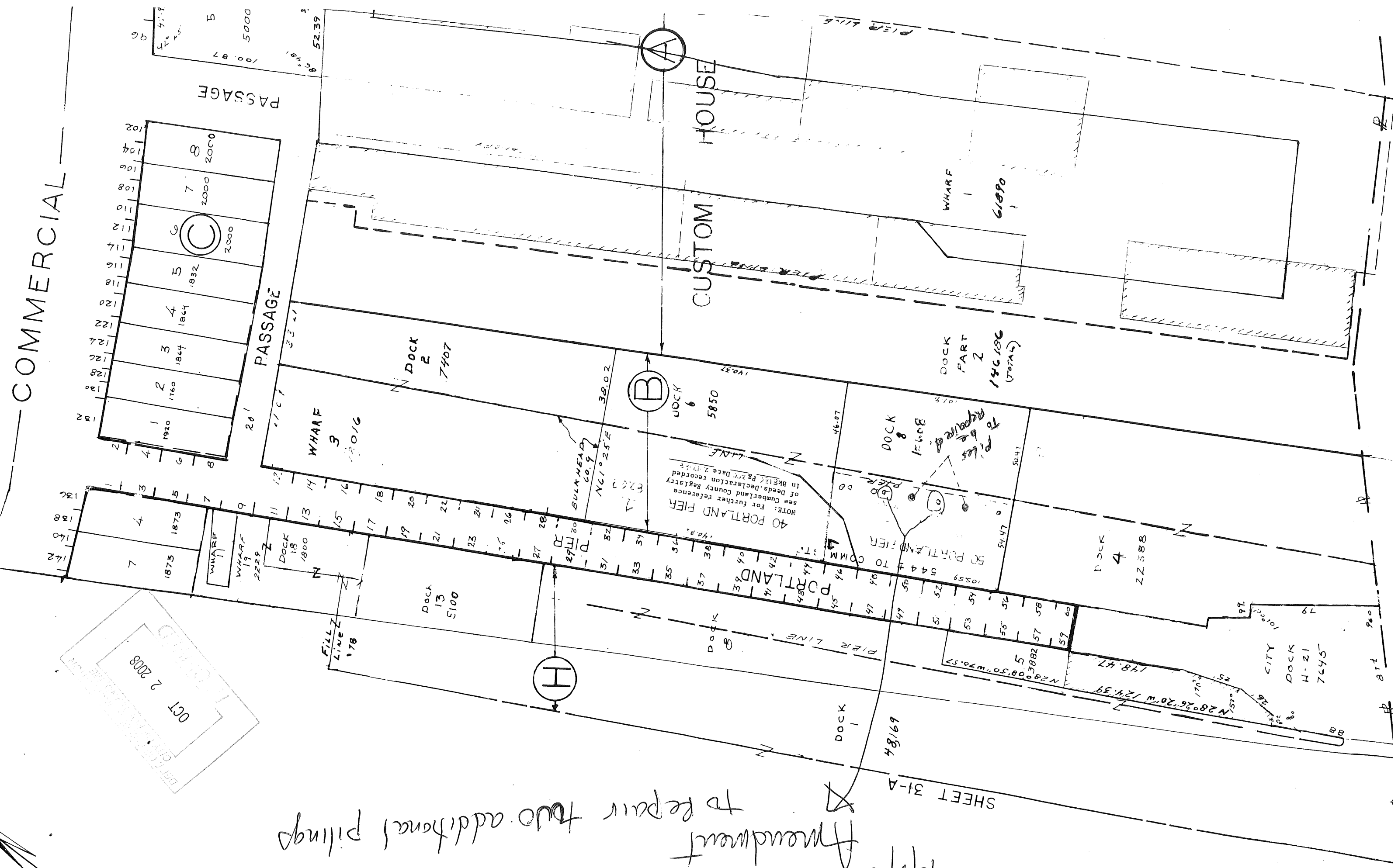

PASSAGE

PASSAGE

HOUSE

CUSTOM

DOCK PART 2

146,186 (TOTAL)

DOCK 8

Piles to be repaired & replaced

DOCK 4

22,388

CITY DOCK

H-21 7645-

NOTE: For further reference see Cumberland County Registry of Deeds, Declaration recorded in BK 184 Pg 200 Date 2-17-48

40 PORTLAND PIER

50 PORTLAND PIER

544 TO COMM

10559

51

52

53

54

55

56

57

58

59

60

61

62

63

64

65

66

67

68

69

70

71

72

73

74

75

76

77

78

79

80

81

82

83

84

85

86

87

88

89

90

91

92

93

94

95

96

97

98

99

100

101

102

103

104

105

106

107

108

109

110

111

112

113

114

115

116

117

118

119

120

121

122

123

124

125

126

127

128

129

130

131

132

133

134

135

136

137

138

139

140

141

142

143

144

145

146

147

148

149

150

151

152

153

154

155

156

157

158

159

160

161

162

163

164

165

166

167

168

169

170

171

172

173

174

175

176

177

178

179

180

181

182

183

184

185

186

187

188

189

190

191

192

193

194

195

196

197

198

199

200

201

202

203

204

205

206

207

208

209

210

211

212

213

214

215

216

217

218

219

220

221

222

223

224

225

226

227

228

229

230

231

232

233

234

235

236

237

238

239

240

241

242

243

244

245

246

247

248

249

250

251

252

253

254

255

256

257

258

259

260

261

262

263

264

265

266

267

268

269

270

271

272

273

274

275

276

277

278

279

280

281

282

283

284

285

286

287

288

289

290

291

292

293

294

295

296

297

298

299

300

301

302

303

304

305

306

307

308

309

310

311

312

313

314

315

316

317

318

319

320

321

322

323

324

325

326

327

328

329

330

331

332

333

334

335

336

337

338

339

340

341

342

343

344

345

346

347

348

349

350

351

352

353

354

355