

**POWER PLAN LEGEND**

- ▼ TEL/DATA OUTLET  
ONE PHONE/ONE DATA
- ⊕ DUPLEX OUTLET
- ⊕<sub>D</sub> DEDICATED DUPLEX OUTLET
- ⊕<sub>Q</sub> QUAD OUTLET
- WIREMOLD

**NOTES:**

1. CONFIRM THAT ALL EXISTING POWER AND DATA ARE IN WORKING ORDER.
2. FIELD VERIFY HEIGHT AND LOCATIONS OF DUPLEX OUTLETS & TEL/DATA.
3. COORDINATE ALL POWER AND DATA LOCATIONS WITH TENANT'S EQUIPMENT.
4. COORDINATE ALL POWER TO RELOCATED SECURITY SYSTEM.
5. GENERAL CONTRACTOR TO COORDINATE WITH CLIENT'S VENDOR REGARDING RELOCATED PHONE SYSTEMS.
6. ALL EXISTING POWER/DATA OUTLETS TO REMAIN UNLESS OTHERWISE INDICATED BY TENANT.

**LIGHTING LEGEND**

- A 2X2 FINELITE HPR-A LED WITH ROUND CENTER OPTIC
- B 6" INTERIOR RECESSED LED DOWNLIGHT WITH DIMMING BALLAST
- C DECORATIVE PENDANT - FORECAST LIGHTING F1937-36 WITH RESIN PANEL (NOT USED)

CEILING TILE-SEE FINISH SCHEDULE

**LIGHTING LEGEND:**

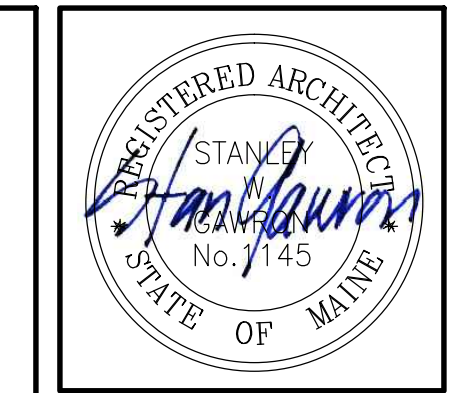
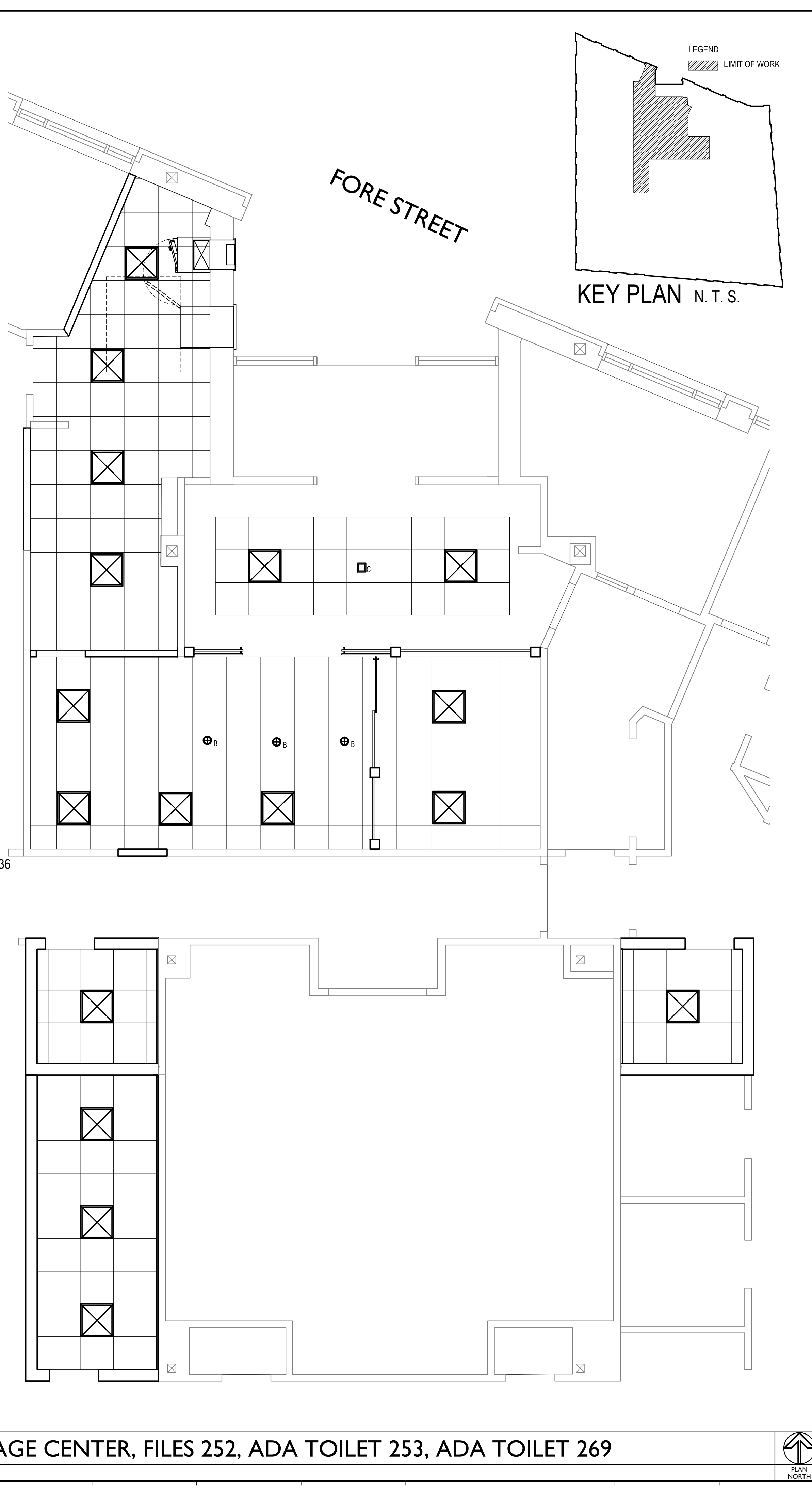

**Gawron Turgeon ARCHITECTS**  
 29 Black Point Road  
 Scarborough, Maine 04074  
 www.gawronturjeon.com  
 207-883-6307 or 207-883-0361 fax

**PEOPLES UNITED BANK**  
 350 FORE STREET,  
 PORTLAND MAINE

REVISIONS		
#	DATE	DESCRIPTION

DATE:	8.26.15
PROJECT #:	030415
DRAWN BY:	JME
CHECKED BY:	MET
DRAWING SCALE:	AS NOTED

**SHEET TITLE**  
 ENLARGED  
 POWER PLAN  
 REFLECTED CEILING  
 PLAN

**A301**

© COPYRIGHT 1985-2013  
 REPRODUCTION OR USE OF THIS  
 DOCUMENT WITHOUT WRITTEN  
 PERMISSION OF GAWRON TURGEON  
 ARCHITECTS IS PROHIBITED.