

INTERIOR FINISH LEGEND				
EXISTING CONDITIONS				
030311				
PEOPLES UNITED BANK - PORTLAND				
CODE	MATERIAL	MANUFACTURER	PRODUCT, STYLE AND COLOR	FINISH
C1	CARPET	EXISTING	BLUE-GRAY	-
C2	CARPET	EXISTING	CREAM	-
C3	CARPET	EXISTING	BLUE/GREEN	-
C4	CARPET	EXISTING	GREY/BLUE, TEXTURED	-
EM1	ENTRY MAT	EXISTING	-	-
T1	TILE	EXISTING	GRANITE TILE	UNPOLISHED
T2	TILE	EXISTING	GRAY TILE	-
T3	TILE	EXISTING	2x2 FLOOR TILE	-
T4	TILE	EXISTING	4x4 WALL TILE	-
R1	RESILIENT	EXISTING	LINOLEUM	-
R2	RESILIENT	EXISTING	LINOLEUM	-
P1	PAINT	EXISTING	CREAM	-
P2	PAINT	EXISTING	GREEN	-
P3	PAINT	EXISTING	DARK RED	-
P4	PAINT	-	-	-
P5	PAINT	-	-	-
P6	PAINT	-	-	-
P7	PAINT	-	-	-
P8	PAINT	-	-	-
G1	GROUT	-	-	-
G2	GROUT	-	-	-
VCT1	VINYL COMPOSITE TILE	-	-	-
VCT2	VINYL COMPOSITE TILE	-	-	-
VCB1	VINYL COVE BASE	-	-	-
PL1	PLASTIC LAMINATE	-	-	-
PL2	PLASTIC LAMINATE	-	-	-
PL3	PLASTIC LAMINATE	-	-	-
SS1	SOLID SURFACE	-	-	-
SS2	SOLID SURFACE	-	-	-
WP1	WALL PROTECTION	EXISTING	GRANITE	-

ABBREVIATIONS	
C	CARPET
G	GROUT
N/A	NOT APPLICABLE
P	PAINT
PL	PLASTIC LAMINATE
R	RESILIENT/ RUBBER/ RUBBER TREAD
SF	SQUARE FEET
SS	SOLID SURFACE/ NATURAL STONE
WP	WALL PROTECTION
T	TILE
TBS	TO BE SELECTED
VCB	VINYL COVE BASE
VCT	VINYL COMPOSITE TILE
VSB	VINYL STRAIGHT BASE
WC	WALL COVERING (VINYL/ PAPER)
WCB	WALL COVERING BORDER (VINYL/ PAPER)
WD	WOOD
EM	ENTRY MAT

REMARKS/NOTES	
1.	ALL TRIM TO BE PAINTED P1.
2.	ALL CEILINGS TO BE PAINTED CEILING BRIGHT WHITE FLAT FINISH.
3.	REFER TO INTERIOR ELEVATIONS & DETAILS FOR ACCENT WALL COLORS.
4.	ALL WOOD BASE TO BE WATER BORN STAIN VARNISH.
5.	PROVIDE JOHNSONITE RUBBER TREAD/ RISER SYSTEM AT STAIR 1 (V1BMTX).
6.	USE G1 GROUT WITH TILES T1 AND T4 AND USE G2 GROUT WITH T2 AND T3 TILES.
7.	PAINT HANDRAIL AND ANY EXPOSED STEEL AT STAIR 1 P4.
8.	PAINT THE EXPOSED DECK AND THE BAR JOISTS AT THE CLERESTORY LOCATION CEILING BRIGHT WHITE - FLAT FINISH.
9.	PAINT ALL EXPOSED ELECTRICAL CONDUIT AT CLERESTORY CEILING BRIGHT WHITE - FLAT FINISH.
10.	TILE GROUT TO BE COMPATIBLE WITH IN SLAB RADIANT HEAT AT PERIMETER LOCATIONS.

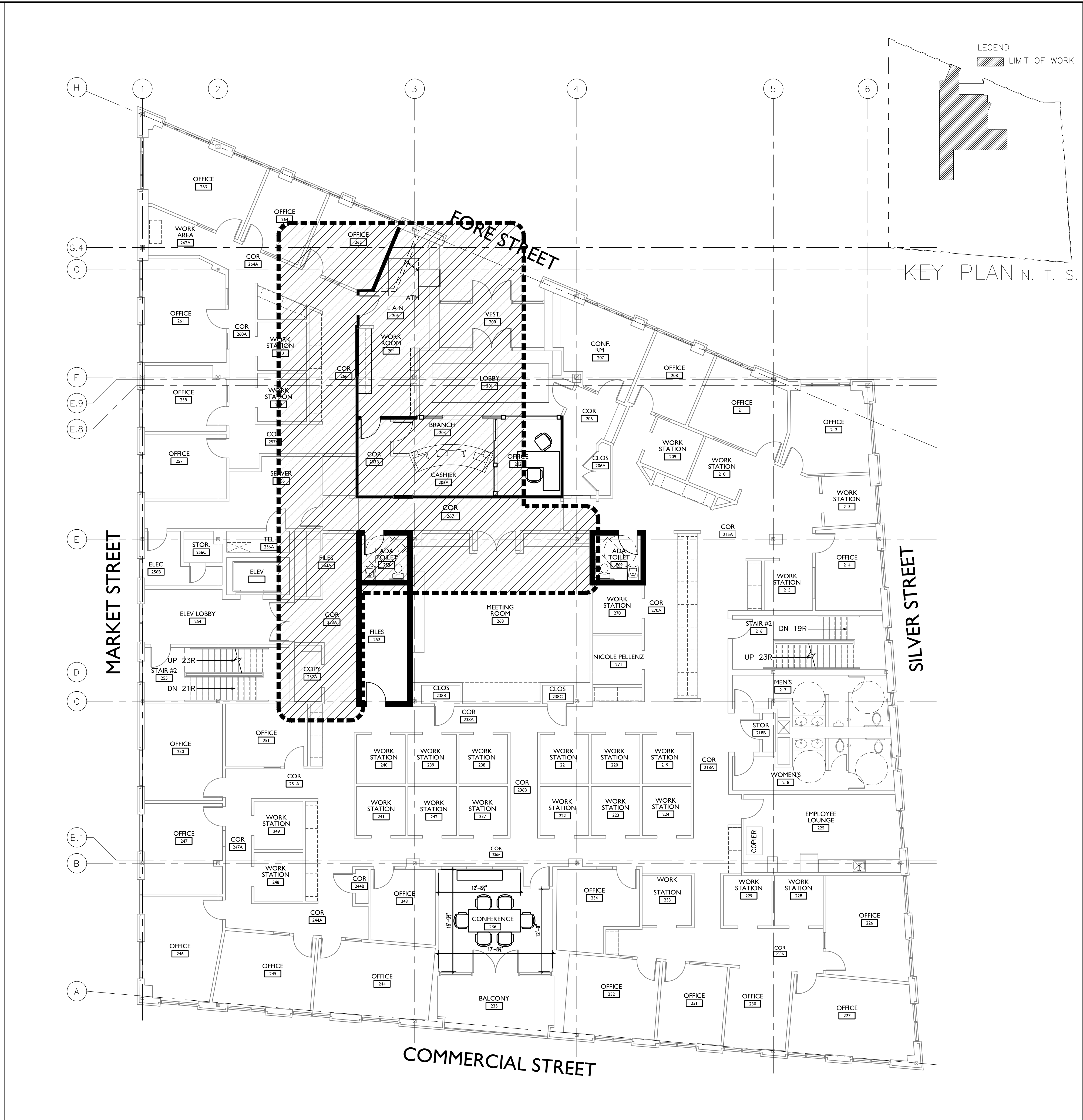

AI FINISH LEGEND
NTS

A9 SECOND FLOOR PLAN
1/8"=1'-0"



PEOPLES UNITED BANK
350 FORE STREET,
PORTLAND MAINE

REVISIONS		
#	DATE	DESCRIPTION

DATE:	3.26.15
PROJECT #:	030415
DRAWN BY:	JME
CHECKED BY:	MET
DRAWING SCALE:	AS NOTED

SHEET TITLE
SECOND FLOOR PLAN
FINISH
LEGEND

A100