

REVIEW SET: August 21, 2015

INTERIOR FINISH LEGEND				
EXISTING CONDITIONS				
030311				
PEOPLES UNITED BANK - PORTLAND				
CODE	MATERIAL	MANUFACTURER	PRODUCT, STYLE AND COLOR	FINISH
C1	CARPET	EXISTING	BLUE-GRAY	-
C2	CARPET	EXISTING	CREAM	-
C3	CARPET	EXISTING	BLUE/GREEN	-
C4	CARPET	EXISTING	GREY/BLUE, TEXTURED	-
EM1	ENTRY MAT	EXISTING	-	-
T1	TILE	EXISTING	GRANITE TILE	UNPOLISHED
T2	TILE	EXISTING	GRAY TILE	-
T3	TILE	EXISTING	2x2 FLOOR TILE	-
T4	TILE	EXISTING	4x4 WALL TILE	-
R1	RESILIENT	EXISTING	LINOLEUM	-
R2	RESILIENT	EXISTING	LINOLEUM	-
P1	PAINT	EXISTING	CREAM	-
P2	PAINT	EXISTING	GREEN	-
P3	PAINT	EXISTING	DARK RED	-
P4	PAINT	-	-	-
P5	PAINT	-	-	-
P6	PAINT	-	-	-
P7	PAINT	-	-	-
P8	PAINT	-	-	-
G1	GROUT	-	-	-
G2	GROUT	-	-	-
VCT1	VINYL COMPOSITE TILE	-	-	-
VCT2	VINYL COMPOSITE TILE	-	-	-
VCB1	VINYL COVE BASE	-	-	-
PL1	PLASTIC LAMINATE	-	-	-
PL2	PLASTIC LAMINATE	-	-	-
PL3	PLASTIC LAMINATE	-	-	-
SS1	SOLID SURFACE	-	-	-
SS2	SOLID SURFACE	-	-	-
WP1	WALL PROTECTION	EXISTING	GRANITE	-

ABBREVIATIONS	
C	CARPET
G	GROUT
N/A	NOT APPLICABLE
P	PAINT
PL	PLASTIC LAMINATE
R	RESILIENT/ RUBBER/ RUBBER TREAD
SF	SQUARE FEET
SS	SOLID SURFACE/ NATURAL STONE
WP	WALL PROTECTION
T	TILE
TBS	TO BE SELECTED
VCB	VINYL COVE BASE
VCT	VINYL COMPOSITE TILE
VSB	VINYL STRAIGHT BASE
WC	WALL COVERING (VINYL/ PAPER)
WCB	WALL COVERING BORDER (VINYL/ PAPER)
WD	WOOD
EM	ENTRY MAT

REMARKS/NOTES	
1.	ALL TRIM TO BE PAINTED P1.
2.	ALL CEILINGS TO BE PAINTED CEILING BRIGHT WHITE FLAT FINISH.
3.	REFER TO INTERIOR ELEVATIONS & DETAILS FOR ACCENT WALL COLORS.
4.	ALL WOOD BASE TO BE WATER BORN STAIN VARNISH.
5.	PROVIDE JOHNSONITE RUBBER TREAD/RISER SYSTEM AT STAIR 1 (V1BMTX).
6.	USE G1 GROUT WITH TILES T1 AND T4 AND USE G2 GROUT WITH T2 AND T3 TILES.
7.	PAINT HANDRAIL AND ANY EXPOSED STEEL AT STAIR 1 P4.
8.	PAINT THE EXPOSED DECK AND THE BAR JOISTS AT THE CLERESTORY LOCATION CEILING BRIGHT WHITE - FLAT FINISH.
9.	PAINT ALL EXPOSED ELECTRICAL CONDUIT AT CLERESTORY CEILING BRIGHT WHITE - FLAT FINISH.
10.	TILE GROUT TO BE COMPATIBLE WITH IN SLAB RADIANT HEAT AT PERIMETER LOCATIONS.

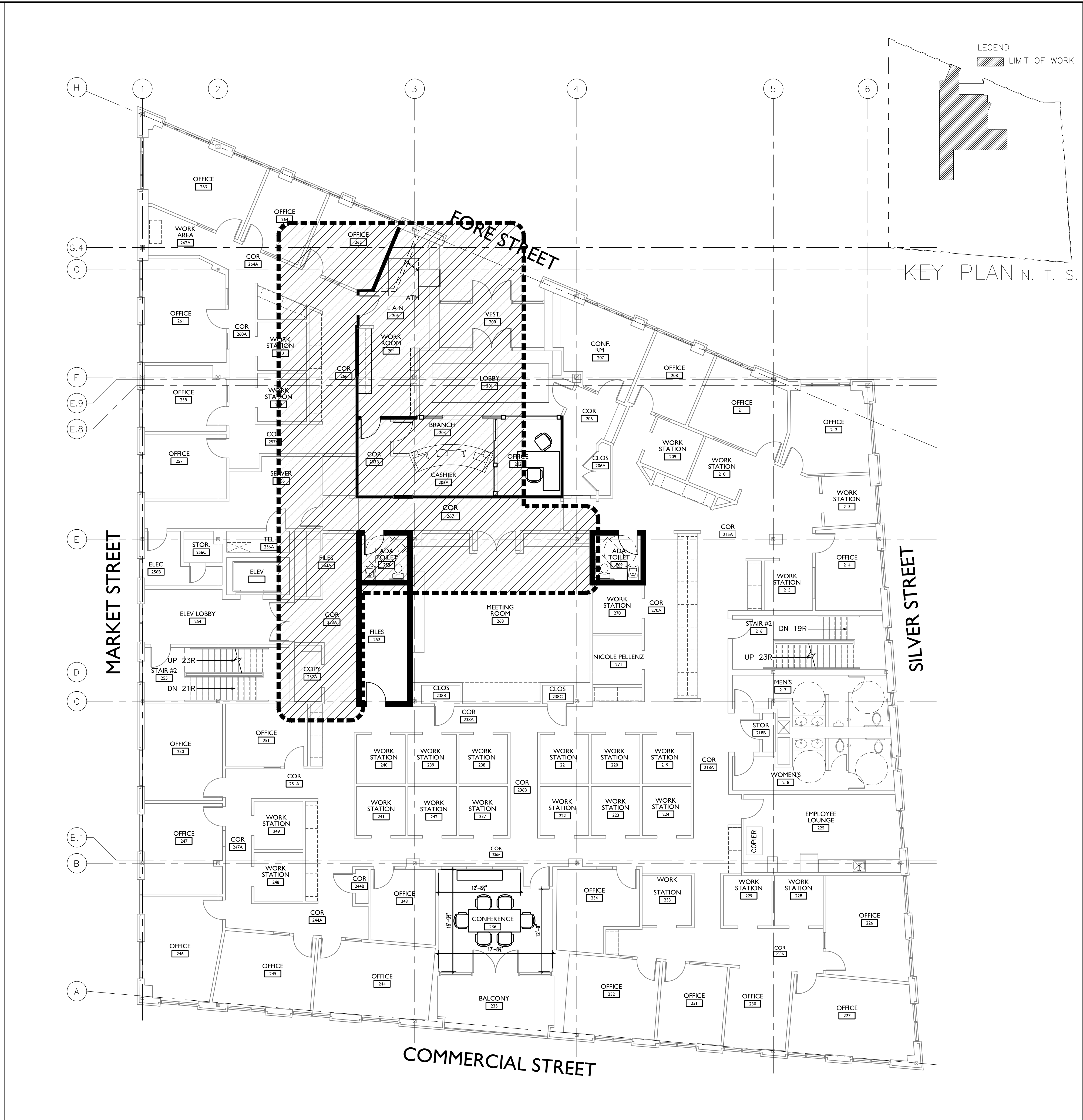

AI FINISH LEGEND

A9 SECOND FLOOR PLAN

Gawron Turgeon ARCHITECTS
 29 Black Point Road
 Scarborough, Maine 04074
 www.gawronturjeon.com
 207-883-6307 or 207-883-0361 fax

PEOPLES UNITED BANK
 • 350 FORE STREET,
 PORTLAND MAINE

REVISIONS		
#	DATE	DESCRIPTION

DATE:	3.26.15
PROJECT #:	030415
DRAWN BY:	JME
CHECKED BY:	MET
DRAWING SCALE:	AS NOTED

SHEET TITLE
 SECOND FLOOR PLAN
 FINISH LEGEND

A100

© COPYRIGHT 1985-2013
 REPRODUCTION OR USE OF THIS
 DOCUMENT WITHOUT WRITTEN
 PERMISSION OF GAWRON TURGEON
 ARCHITECTS IS PROHIBITED.