

3
2
1
0
SCALE
1"=1'

4
3
2
1
0
SCALE
3/4"=1'

6'
3'
2'
1'
0
SCALE
1/2"=1'

12
8
4
2
0
SCALE
1/4"=1'

20
10
5
0
SCALE
1/8"=1'

40
20
10
0
SCALE
1/16"=1'

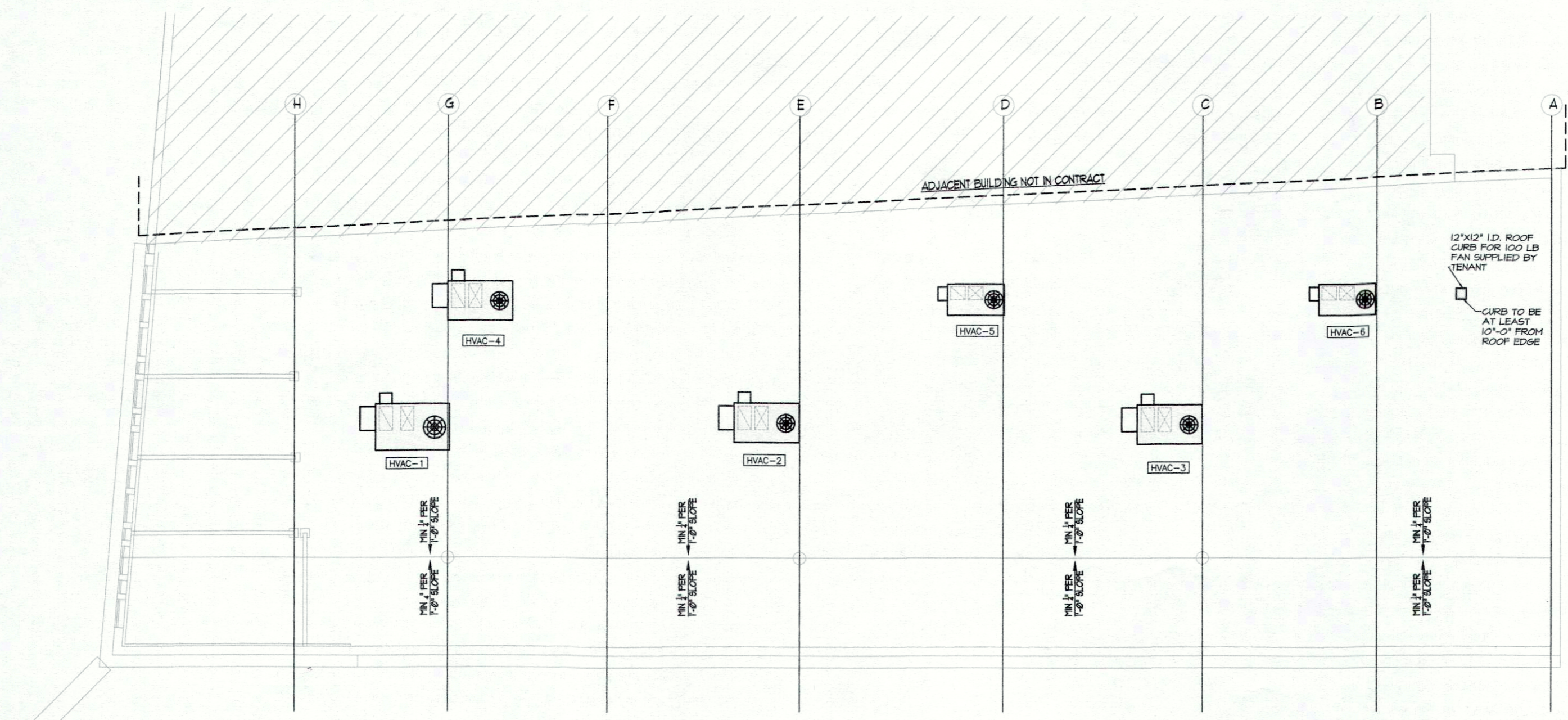

1 ROOF MECHANICAL PLAN
SCALE: 1/8" = 1'-0"

HVAC UNIT SCHEDULE																
TAG	MANUFACTURER AND MODEL	NOMINAL SIZE	CFM	COOLING			HEATING				ELECTRIC			WEIGHT	REMARKS	
				TYPE	REFRIGERANT	TOTAL	IEER	FUEL	INPUT	STAGES	EFFICIENCY	POWER	MCA			MOP
HVAC-1	TRANE YCH120F3RLA	10 TONS	4,000	DX	410A	120 MBH	13.0	NAT. GAS	180 MBH	2	80%	208/60/3	46.1	60	1,243 LB5	WITH FACTORY ROOF CURB, ECONOMIZER, POWERED RELIEF, RETURN & SUPPLY AIR SMOKE DETECTOR, THROUGH-THE-CURB ELECTRIC AND GAS, FACTORY POWER DISCONNECT
HVAC-2	TRANE YCH102F3RLA	8.5 TONS	3,600	DX	410A	102 MBH	14.0	NAT. GAS	120 MBH	1	80%	208/60/3	42.2	50	1,251 LB5	WITH FACTORY ROOF CURB, ECONOMIZER, POWERED RELIEF, RETURN & SUPPLY AIR SMOKE DETECTOR, THROUGH-THE-CURB ELECTRIC AND GAS, FACTORY POWER DISCONNECT
HVAC-3	TRANE YCH012F3RLA	7.5 TONS	3,000	DX	410A	93 MBH	14.0	NAT. GAS	120 MBH	1	80%	208/60/3	42.4	50	1,251 LB5	WITH FACTORY ROOF CURB, ECONOMIZER, POWERED RELIEF, RETURN & SUPPLY AIR SMOKE DETECTOR, THROUGH-THE-CURB ELECTRIC AND GAS, FACTORY POWER DISCONNECT & IISV PLUG
HVAC-4	TRANE YCH012F3RLA	7.5 TONS	3,000	DX	410A	93 MBH	14.0	NAT. GAS	120 MBH	1	80%	208/60/3	42.4	50	1,251 LB5	WITH FACTORY ROOF CURB, ECONOMIZER, POWERED RELIEF, RETURN & SUPPLY AIR SMOKE DETECTOR, THROUGH-THE-CURB ELECTRIC AND GAS, FACTORY POWER DISCONNECT
																EXISTING, RELOCATED UNIT WITH ECONOMIZER- PROVIDE NEW FACTORY ROOF CURB
																EXISTING, RELOCATED UNIT WITH ECONOMIZER- PROVIDE NEW FACTORY ROOF CURB

FAN SCHEDULE								
TAG	MANUFACTURER & MODEL	TYPE	CFM	ESP	ELECTRIC		REMARKS	REMARKS
					POWER	FLA		

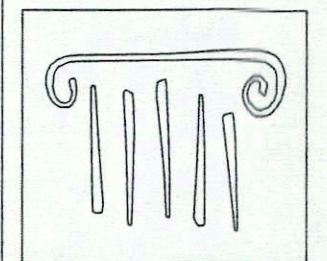

PORT CITY ARCHITECTURE

65 NEWBURY STREET
PORTLAND, ME 04101
207.761.9000
207.761.2010
info@portcityarch.com



CONSULTANTS

Swiftcurrent Engineering Services Inc.
10 Forest Fall Drive - unit 4B
Yarmouth, Maine 04096
(207) 847-9280
contact: Tim Matthews, P.E.
tim@swiftcurrenteng.com

Mechanical Systems Engineers
10 Forest Fall Drive - suite 10
Yarmouth, Maine 04096
(207) 846-9441
contact: Kurt Magnusson, P.E.
kurt@mechanicalsystemseng.com

PERMIT SET
10-21-16

NOT FOR
CONSTRUCTION

NEWPORT
DEVELOPMENT
ASSOCIATES

164 Middle St
Portland, Maine

#	DATE	DESCRIPTION

DATE ISSUED: OCTOBER 21, 2016
PROJECT NUMBER: 16207
DRAWING SCALE: AS NOTED

MECHANICAL ROOF PLAN & SCHEDULES

DRAWN BY: **KFM**
CHECKED BY: **KFM**
M1.0